



safer roads for everyone

**Land North of Keresforth Road, Dodworth,  
Barnsley**

**Section 278 Highway Works**

**Road Safety Audit Combined Stage 1 & 2**

**on behalf of Barnsley MBC**

**TMS Client –  
Local Transport Projects for Keepmoat Homes**

**TMS Reference No: 19328**

**Date: 28<sup>th</sup> July 2025**

**Revision: 0**



## 1. Project Details

|                         |  |
|-------------------------|--|
| <b>Report Title:</b>    | Land North of Keresforth Road, Dodworth, Barnsley<br>Section 278 Highway Works<br>Road Safety Audit Combined Stage 1 & 2 |
| <b>Author</b>           | Darren Newbold   |
| <b>Document Ref No:</b> | TMS Ref No: 19328  |
| <b>Revision</b>         | 0  |
| <b>Prepared by:</b>     | TMS Consultancy  |
| <b>On behalf of:</b>    | Barnsley MBC (Overseeing Organisation)   |
| <b>TMS Client</b>       | Local Transport Projects for Keepmoat Homes  |

## Document Control Sheet

| Issue No | Revision | Audit Team | Completion Date | TMS Issue Date |
|----------|----------|------------|-----------------|----------------|
| 1        | 0        | DN/NR      | 28/07/2025      | 28/07/2025     |

## 2. Introduction

2.1 This report describes a combined Stage 1 and 2 Road Safety Audit carried out on the Section 278 & Section 38 highway works associated with a residential development on land off Keresforth Road, Dodworth, Barnsley. This combined RSA1&2 report supersedes TMS 18507, previously carried out in Jun 2024.

2.2 The audit team members were as follows:

### **Audit Team Leader**

Darren Newbold – MSc, BSc (Hons), MCIHT, MSoRSA  
National Highways Approved RSA Certificate of Competency  
Principal Engineer, TMS Consultancy

### **Audit Team Member**

Neal Roderick - BEng (Hons), PGCE, MCIHT, MSoRSA  
National Highways Approved RSA Certificate of Competency  
Engineer / Road Safety Auditor, TMS Consultancy

2.3 The audit comprised an examination of the documents listed in **Appendix A**. The Road Safety Audit was undertaken in accordance with the Audit Brief supplied by Annabel Carrick, Local Transport Projects Ltd.

2.4 The site was visited by the Audit Team on 4th June 2024 between 12.45pm and 1.15pm. The weather was cloudy and damp. Traffic flows were moderate. No pedestrian or cycle flows were observed.

2.5 The terms of reference of the Road Safety Audit are as described in GG 119 Revision 2. The team has examined and reported only on the road safety implications of the scheme as presented and has not examined or verified the compliance of the design to any other criteria.

2.6 All of the problems described in this report are considered by the audit team to require action in order to improve the safety of the scheme and minimise collision occurrence.

2.7 A scheme drawing is included in **Appendix B**, where the locations of specific problems are referenced. A location plan of the scheme is also included in this Appendix.

## 2.8 Scheme Description

The scheme consists of a proposed upgrade of the existing priority junction onto Keresforth Road (Wood End Court) to provide access to housing development (circa 200 dwellings). The private drive to Wood End Court will be accessed via the new development road. Footways will be provided on both sides of the development access road.

Keresforth Road is subject to a 30mph speed limit and is street lit.

## 2.9 Road Safety Audit Response Report

Following the completion of the road safety audit, the design team should prepare a road safety audit response report in collaboration with the Overseeing Organisation.

The response report should incorporate the following:

- **Decision Log** spreadsheet, where each Problem and Recommendation in the Safety Audit report is reiterated
- In the Decision Log, a response should be provided by the Design Team and Overseeing Organisation for each problem raised in the RSA report, together with an agreed action

Further information is provided in **GG 119 Sections 4.11 to 4.19** and **Appendix F** (where a road safety audit response report template is available).

The response report should be produced and finalised within *one month* of the issue of the RSA report. A copy of the response report should be issued to the Safety Audit Team for information.

### 3. Items resulting from the Combined Stage 1 & 2 Road Safety Audit

#### 3.1 PROBLEM

Location: Keresforth Road j/w site access road

Summary: Poor carriageway condition may increase the risk of braking, skid and loss of control type vehicle collisions

The existing carriageway condition on Keresforth Road at the proposed site access junction is poor, with patches from previous works and some surface cracks. This may result in differential skid resistance across the junction. The development will introduce a significant number of braking and turning manoeuvres into the site and as such the poor carriageway condition may increase the risk of braking, skid and loss of control type vehicle collisions.



#### RECOMMENDATION

Keresforth Road should be resurfaced for the extent of the new junction.

### 3.2 PROBLEM

Location: Keresforth Road j/w site access road

Summary: Sunken utility may be a loss of control hazard to turning vehicles

There is a sunken utility cover within the southbound running lane on Keresforth Road at the site access junction. The manhole cover may be a potential loss of control hazard to vehicles making turning manoeuvres to and from the site access. This may be a particular issue for two wheeled vehicles.

In addition, the polished nature of the utility cover may present a potential skid hazard to vehicles, exacerbated during wet or icy conditions.



### RECOMMENDATION

The utility cover should be reset flush with the carriageway and treated with a suitable non-slip surface with similar skid resistance to the surrounding carriageway.

### 3.3 PROBLEM

Location: Keresforth Road j/w site access road

Summary: Poor illumination of the junction may increase the risk of darkness related vehicle collisions

There is an existing lighting column that will be within the extents of the widened access junction and will therefore require removal. No details have been provided to show if and where the lighting column will be relocated. A lack of illumination at the junction may increase the risk of darkness related vehicle collisions.



### RECOMMENDATION

The junction of Keresforth Road and the site access road should be appropriately illuminated.

A suitable system of street lighting should also be provided along the site access road.

### 3.4 PROBLEM

Location: Site access road

Summary: Lack of suitable access may result in potential vehicle damage or collisions between vehicles and pedestrians

No kerbing details are provided to show how Wood End Court private drive will adjoin to the development access road. If a full height kerb is provided, drivers will have to 'bump' up across the footway which may cause damage to vehicles. This may also increase the risk of collisions between vehicles and pedestrians.

#### RECOMMENDATION

Suitable access should be provided to the private drive (as this is a singular dwelling a 25mm dropped kerb vehicle crossover would be the most suitable means of access).

### 3.5 PROBLEM

Location: Keresforth Road j/w site access road

Summary: Standing water within the junction may be a potential skid hazard to vehicles

No drainage details have been provided for the widened access junction. A lack of suitable drainage may result in surface water accumulating within the junction which may be a potential skid hazard to vehicles, particularly in heavy rain or icy conditions.

#### RECOMMENDATION

Suitable drainage should be provided.

### 3.6 PROBLEM

Location: General – cycle slips

Summary: High kerbs at cycle slips may be a potential hazard to cyclists

No kerbing details have been provided for the scheme. Where cycle slips are to be provided to enable cyclists to transition between carriageway and the shared use footway / cycleway, the presence of high kerbs will mean that cyclists will have to 'bump' up over the kerbs increasing the risk of becoming destabilised and falling from their bikes.

#### RECOMMENDATION

A suitable dropped kerb should be provided at the cycle slips.

#### 4. **Audit Team Statement**

We certify that the terms of reference of the road safety audit are as described in GG 119 Revision 2.

##### **Audit Team Leader**

|  |
|--|
| Darren Newbold – MSc, BSc (Hons), MCIHT, MSoRSA<br>National Highways Approved RSA Certificate of Competency<br>Principal Engineer, TMS Consultancy |
|--|



|        |   |
|--------|---|
| Signed |  |
| Date   | 28 <sup>th</sup> July 2025  |

##### **Audit Team Member**

|   |
|---|
| Neal Roderick - BEng (Hons), PGCE, MCIHT, MSoRSA<br>National Highways Approved RSA Certificate of Competency<br>Engineer / Road Safety Auditor, TMS Consultancy |
|---|

|        |   |
|--------|---|
| Signed |  |
| Date   | 28 <sup>th</sup> July 2025  |

**TMS Consultancy**  
Unit 36, Business Innovation Centre  
Binley Business Park  
Harry Weston Road  
Coventry, CV3 2TX

 + 44 (0)24 7669 0900  
 [info@tmsconsultancy.co.uk](mailto:info@tmsconsultancy.co.uk)  
 [www.tmsconsultancy.co.uk](http://www.tmsconsultancy.co.uk)

## Appendix A

### Documents Examined:

- LTP 4283 P2 01 06 REV L Potential Access Road SPA.pdf
- LTP 4283 P2 01 09 Potential Access Road Existing Footway Widening.pdf
- LTP 4283 P3 01 01 REV B Potential Access Road Between Keresforth Road and Central Woodland.pdf
- LTP 4283 P3 01 02 REV C Potential Access Road Between Keresforth Road and Central Woodland SPA.pdf
- LTP 4283 P3 01 03 REV B Potential Access Road Between Keresforth Road and Central Woodland Visibility Splay.pdf
- LTP 4283 P2 01 01 REV M Potential Access Road Preliminary Design.pdf
- LTP 4283 P2 01 02 REV F Potential Access Road Long Sections.pdf
- LTP 4283 P2 01 05 REV M Potential Access Road Visibility Splays.pdf

### Other Information Provided:

- Road Safety Audit Brief
- Transport Assessment
- Supplementary Transport Assessment
- Stage 1&2 Road Safety Audit (TMS Report No. 18507)
- Checklist of Information

## Appendix B

Please refer to the following page for a plan illustrating the locations of the problems identified as part of this audit (location numbers refer to paragraph numbers in the report).

The location of the scheme is shown below:

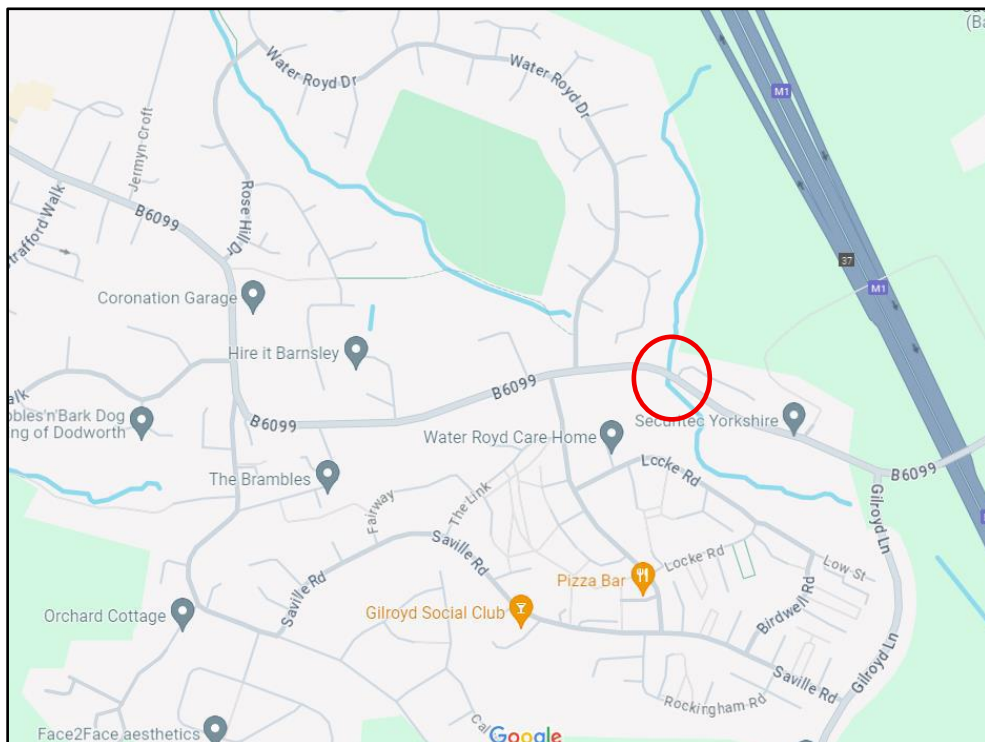



safer roads for everyone

Client: Local Transport Projects for Keepmoat Homes  
 Scheme: Land North of Keresforth Road, Dodworth, Barnsley (S278 Works)

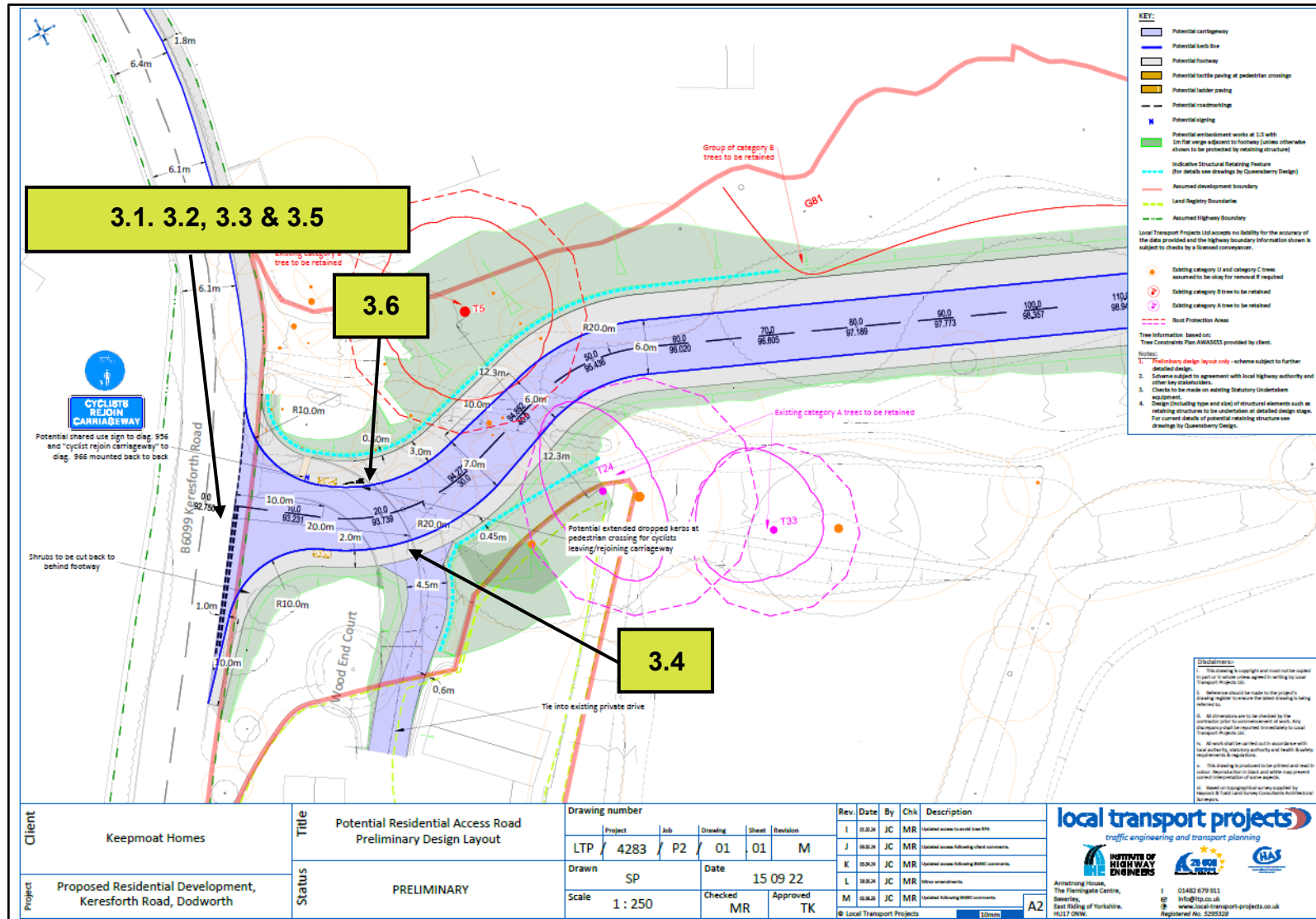

|         |   |
|---------|---|
| Client  | Keepmoat Homes  |
| Project | Proposed Residential Development, Keresforth Road, Dodworth |

|        |   |
|--------|---|
| Title  | Potential Residential Access Road Preliminary Design Layout |
| Status | PRELIMINARY   |

|                |            |               |       |          |  |
|----------------|------------|---------------|-------|----------|--|
| Drawing number |            |               |       |          |  |
| Project        | Job        | Drawing       | Sheet | Revision |  |
| LTP / 4283     | P2         | 01            | 01    | M        |  |
| Drawn SP       |            | Date 15 09 22 |       |          |  |
| Scale 1 : 250  | Checked MR | Approved TK   |       |          |  |

| Rev | Date     | By | Chk | Description                              |
|-----|----------|----|-----|--|
| I   | 01.01.24 | JC | MR  | Updated access to avoid tree T16         |
| J   | 04.01.24 | JC | MR  | Updated access following client comments |
| K   | 05.01.24 | JC | MR  | Updated access following BMSI comments   |
| L   | 18.01.24 | JC | MR  | Minor amendments                         |
| M   | 04.01.24 | JC | MR  | Updated following BMSI comments          |

© Local Transport Projects

**local transport projects**  
 traffic engineering and transport planning

**INSTITUTE OF HIGHWAY ENGINEERS**

**GLS**

**CAA**

Armstrong House,  
 The Flemingate Centre,  
 Bawtry,  
 East Riding of Yorkshire,  
 YO21 0NW

01482 679 911  
 info@ltp.co.uk  
 www.local-transport-projects.co.uk  
 Registered No. 5295328



safer roads for everyone

Client: Local Transport Projects for Keepmoat Homes  
 Scheme: Land North of Keresforth Road, Dodworth, Barnsley (S278 Works)

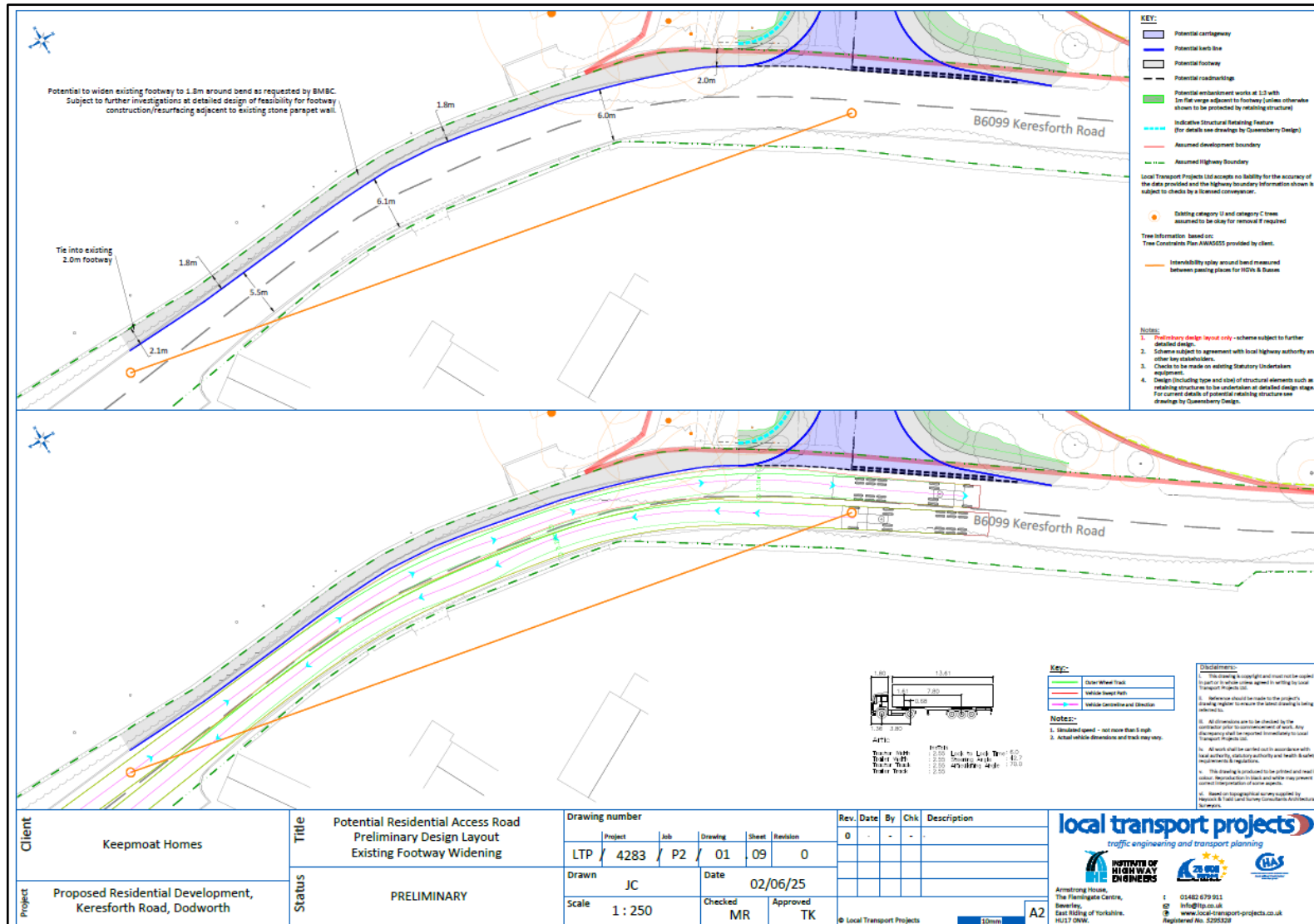

Client: Local Transport Projects for Keepmoat Homes  
 Scheme: Land North of Keresforth Road, Dodworth, Barnsley (S278 Works)

