

NOTES

Read this drawing in conjunction with drawings 2372:15, 2372:16 and MET topographical survey.

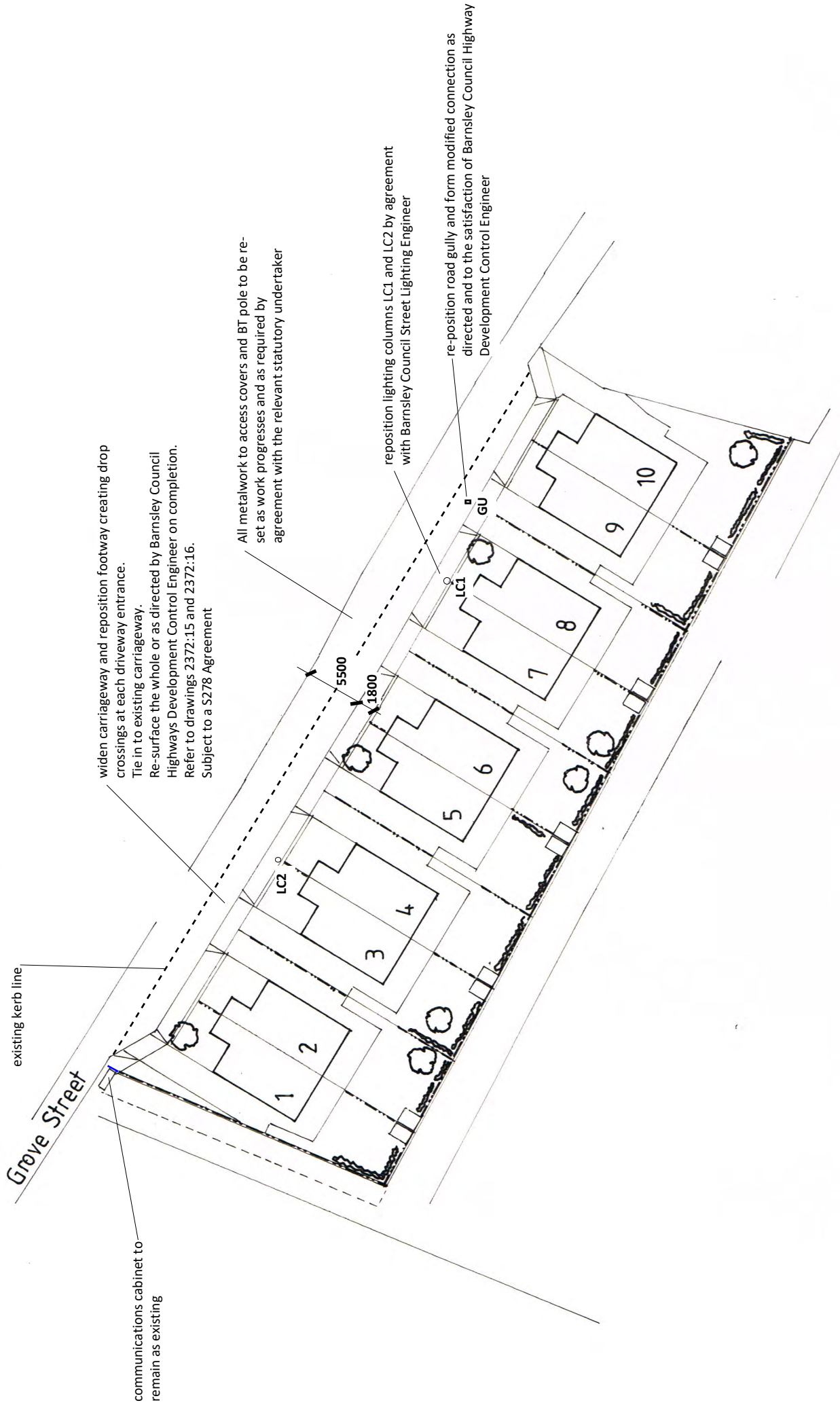
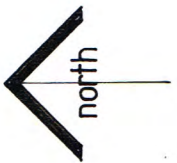

revision	description	date

The contractor shall check all dimensions on site and report discrepancies. No dimension shall be scaled off this drawing.
© Copyright of this drawing is retained by A.L. Turner.

client	LMW Development Solutions Ltd	Date	05.19	dwg size	A3
project	Residential Development at Grove	Scale	1:500	drawn	ALT
title	Street, Worsbrough, S70 4SN	Issue	final		
	Highway Works Layout				

1 LORING ROAD, RAVENSCAR, SCARBOROUGH, YO13 0LY	A L Turner + Associates	drawing no.	rev.
07976 397307	tony.turner@btinternet.com	2372 : 17	
www.yorkshirearchitectural.co.uk	www.yorkshirearchitectural.co.uk		