

EXISTING TREES TO BE RETAINED  
LEVELS TO REMAIN AS EXISTING  
ANY WORKS BELOW CANOPY TO BE  
SUBJECT TO A METHOD  
STATEMENT

APPROXIMATE  
LOCATION OF TREE  
PROTECTION FENCE

Huddersfield Road

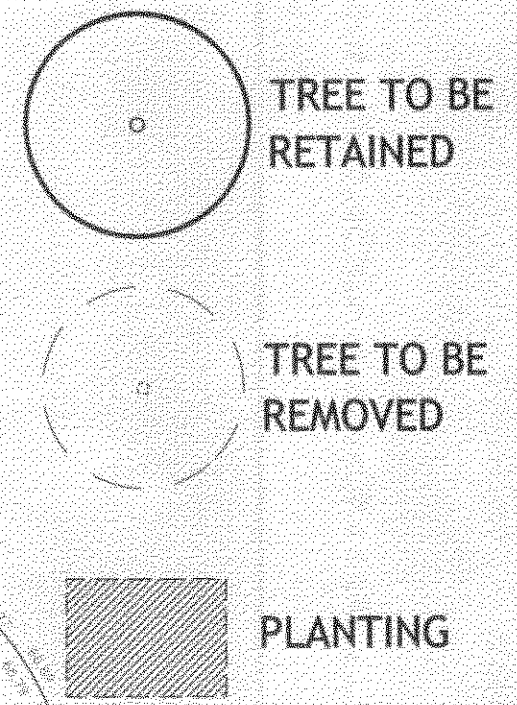

- NOTES**
- ALL WORK TO BE CARRIED OUT IN ACCORDANCE WITH THE BUILDING REGULATIONS AND THE REQUIREMENTS OF THE LOCAL AUTHORITY.
  - NO DIMENSIONS TO BE SCALED FROM THIS DRAWING.
  - THE CONTRACTOR SHALL VERIFY ALL LEVELS AND DIMENSIONS ON SITE BEFORE COMMENCEMENT OF WORK.
  - ON SITE ALTERATIONS TO THE CONSTRUCTION OR FINISHES SHOWN OR IMPLIED ON THIS DRAWING MUST BE DRAWN TO THE ATTENTION OF THE ARCHITECT BEFORE SUCH WORK IS IMPLEMENTED.
- © COPYRIGHT RESERVED

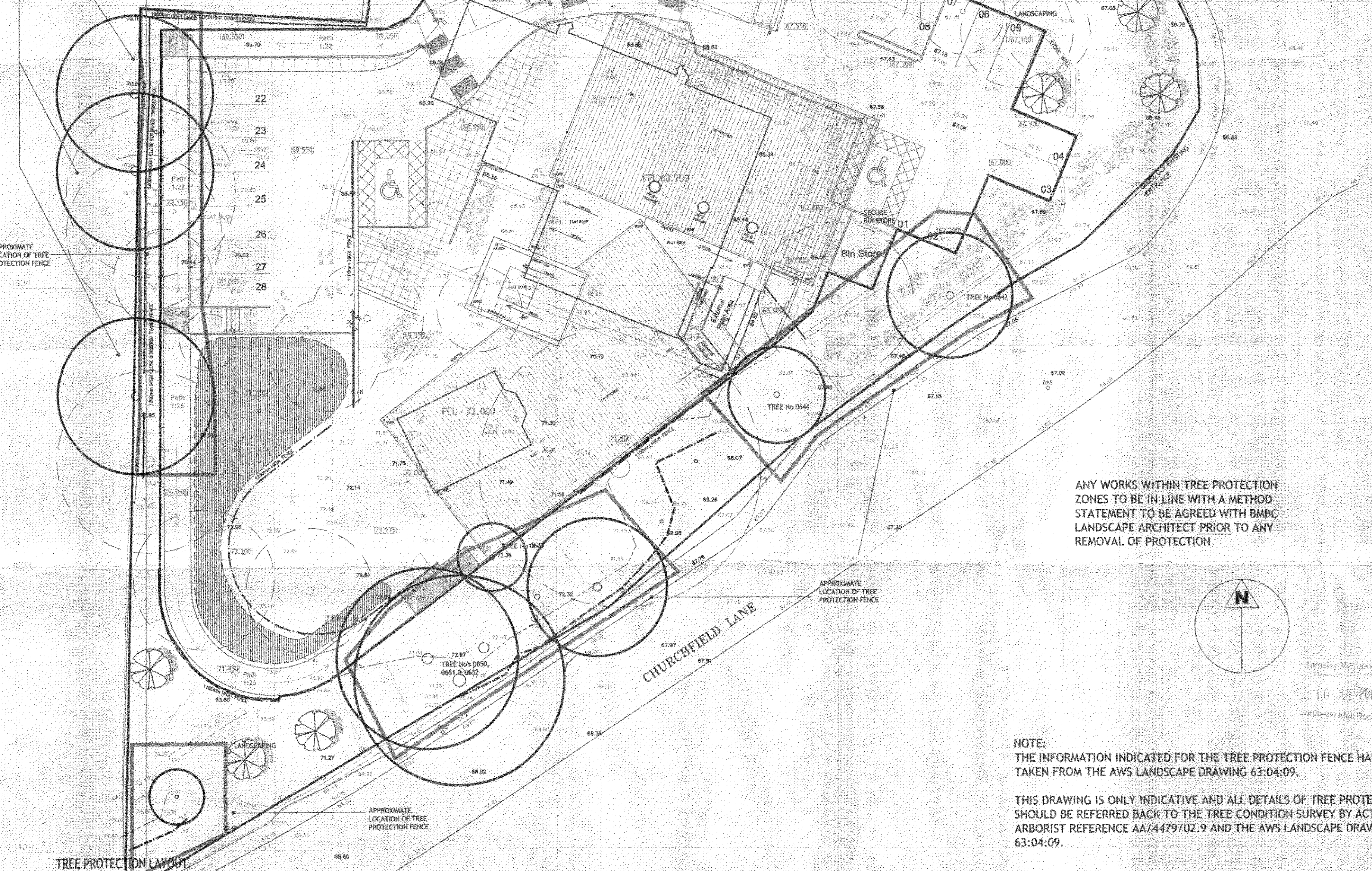

ANY WORKS WITHIN TREE PROTECTION ZONES TO BE IN LINE WITH A METHOD STATEMENT TO BE AGREED WITH BMBC LANDSCAPE ARCHITECT PRIOR TO ANY REMOVAL OF PROTECTION

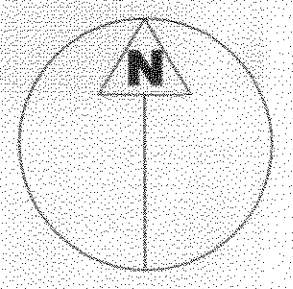

APPROXIMATE LOCATION OF TREE PROTECTION FENCE

APPROXIMATE LOCATION OF TREE PROTECTION FENCE

TREE PROTECTION LAYOUT

Areas of low maintenance shrubs extended around external childrens play area-clients request	22.06.09	DR	F
UPDATED FOLLOWING COMMENTS FROM CLIENT	120609	MD	E
TREE PROTECTION ZONE ADDED TO NEIGHBOURING TREES AT WEST SIDE OF SITE	110609	MD	D
TREES OUTSIDE BOUNDARY INDICATED, TREE NUMBERS TO BE RETAINED ADDED, ADDITIONAL NOTES ADDED	280509	MD	C
ALTERATIONS TO SITE & EXISTING LEVELS ADDED	MAY 09	MT	B
ALTERATIONS TO SITE FOLLOWING CLIENT MEETING AND COMMENTS	MAY 09	MT	A
Revisions	09b	09d	0a

PRELIMINARY ISSUE

Project  
**DARTON  
PRIMARY CARE CENTRE  
BARNSELY LIFT**

Client  
**MORGAN ASHURST**

140 Moorhead Way, Salford, Greater Manchester, M6 6PU  
Tel: 0161 434 3000 Fax: 0161 434 3001 www.hdp.co.uk  
Planning permission for Barnsley Lift, Barnsley, S70 2BQ

10 JUL 2009  
Site Office

TREE PROTECTION PLAN

Drawn JG	Scale 1:200 @ A2
Checked	Date JAN 09
Job No. 161	Draw No. (12P) 10
	Rev. F

NOTE:  
THE INFORMATION INDICATED FOR THE TREE PROTECTION FENCE HAS BEEN TAKEN FROM THE AWS LANDSCAPE DRAWING 63:04:09.

THIS DRAWING IS ONLY INDICATIVE AND ALL DETAILS OF TREE PROTECTION SHOULD BE REFERRED BACK TO THE TREE CONDITION SURVEY BY ACTIVE ARBORIST REFERENCE AA/4479/02.9 AND THE AWS LANDSCAPE DRAWING 63:04:09.