

Elevation As Proposed

Scale 1:20@A3

NOTE
Drawing to be read in conjunction with drawings 202 - 207 to identify individual windows by type.

Existing wall construction and lintols etc to be retained

New window frames to be made from FSC treated European Redwood, sills to be FSC Sapele and all finished in spray applied, water based, microporous paint, colour to be confirmed, casement profile to be Ovolo profile beading, glazing to be 6mm float glass. Safety glass to be fitted where necessary, all by Crookes & Son Joinery, 3 Shenstone Road, Sheffield S6 1SP, Tel 0114 233 0699 or equal approved

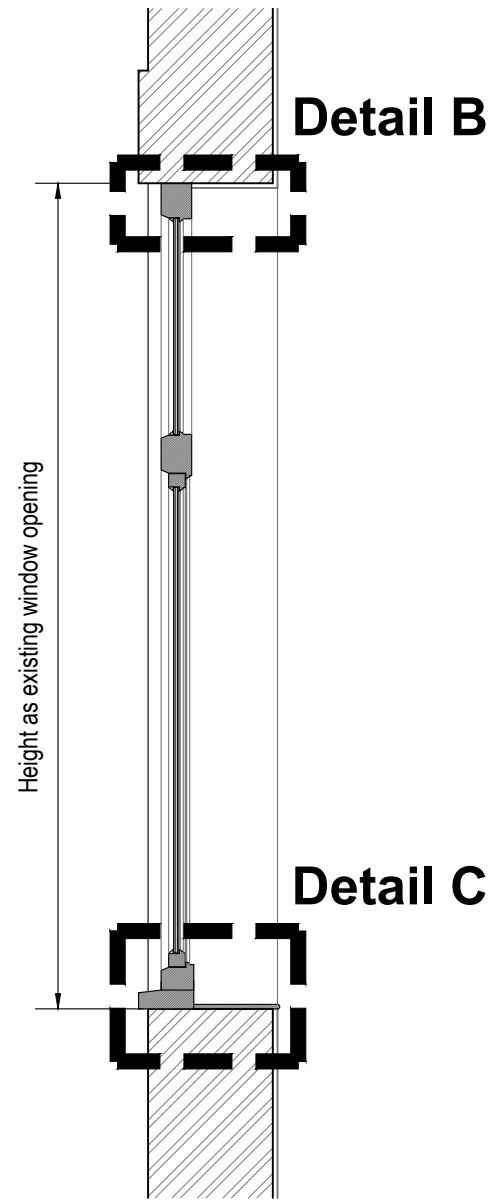

Section B-B As Proposed

Scale 1:20@A3

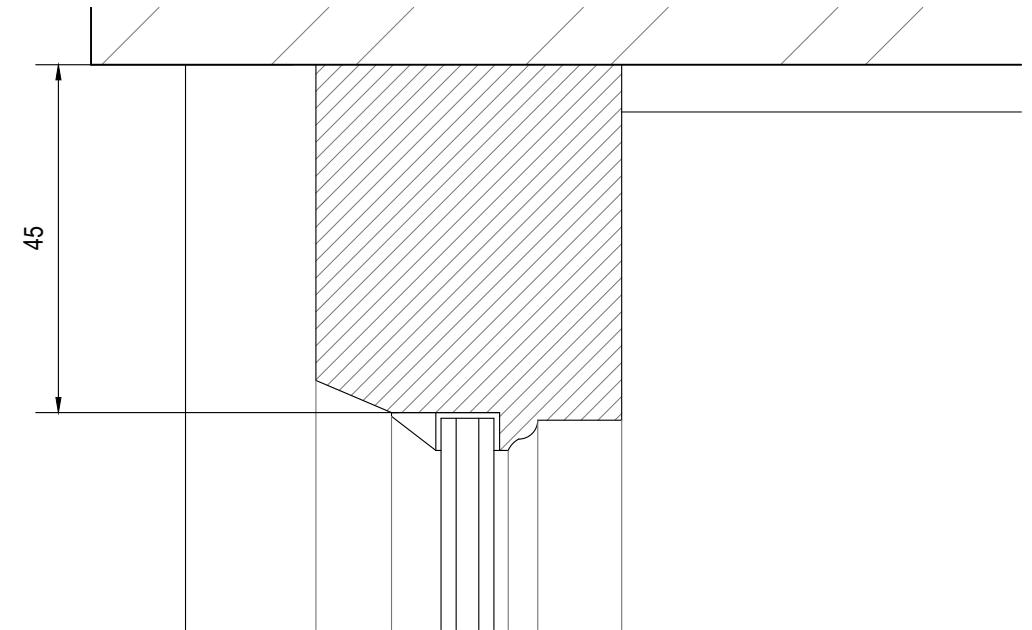

Detail B As Proposed

Scale 1:2@A3

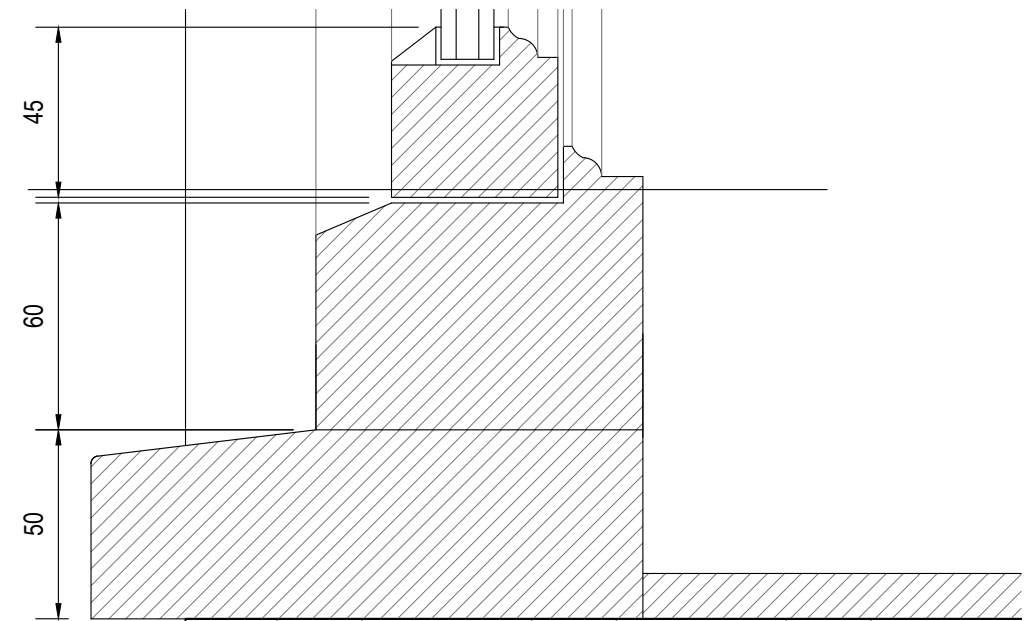

Detail C As Proposed

Scale 1:2@A3

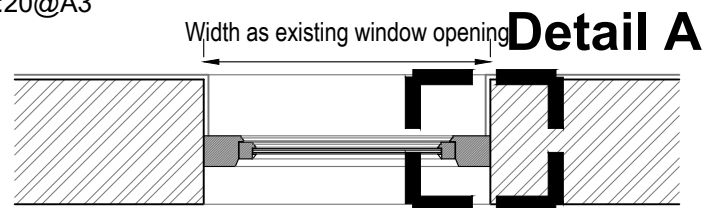

Section A-A As Proposed

Scale 1:20@A3

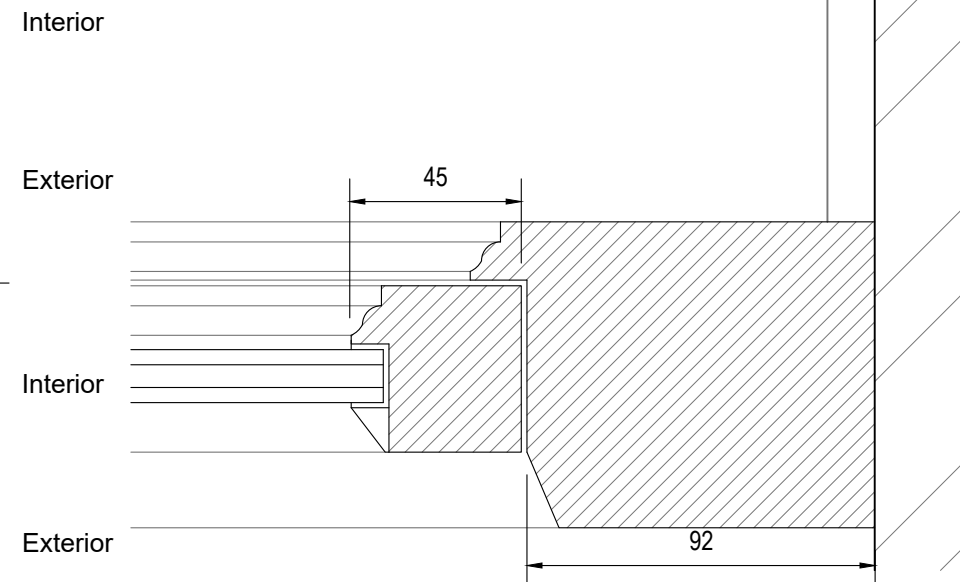

Detail A As Proposed

Scale 1:2@A3

ISSUED FOR CONSTRUCTION

REVISION	DATE	DRAWN	CHECKED	DESCRIPTION	SCALE	DATE
A	Sep 2023	ML		Works reduced to just front elevation of 70 - 72 Eldon Street	1:2&20@A3	SEPT 2022
CLIENT	MR CORBETT			DRAWN	ML	CHECKED
PROJECT	70 - 76 ELDON STREET, BARNSELY			JOB NUMBER	2239	REVISION
DRAWING TITLE	TYPICAL TIMBER CASEMENT WINDOW DETAIL			DRAWING NO.	216	A

TIMEARCHITECTS

Creative Conservation - Inspiring Design. Time Architects 226-228 Holme Lane, Sheffield, S64JZ
Registered Company Number in England and Wales: 8033383, Director: Michael Leigh
W. www.timearchitects.co.uk E. info@timearchitects.co.uk T. 0114 430 0114
© all rights reserved, report all discrepancies, do not scale from drawing, check dimensions on site