

NO	TREE SPECIES		HIGHT	SPREAD	Clear	DIA	N	CAT.	Life	Life	NOTES
	Common Name	Scientific Name									
T1	English Oak	Quercus robur	20	10	-	800	B1	Mature	+40		
T2	English Oak	Quercus robur	18	7	2	500	B1	Semi-Mature	+40	Suppressed.	
T3	English Oak	Quercus robur	14	4	1	350	C1	Early-Mature	+40	Main leader broken at 10m.	
T4	English Oak	Quercus robur	20	6	-	750	B1	Mature	+40		
T5	English Oak	Quercus robur	18	7	2	500	B1	Mature	+40		
T6	English Oak	Quercus robur	20	9	-	450	B1	Semi-Mature	+40	Some dead wood.	
T7	English Oak	Quercus robur	18	11	3	600	B1	Mature	+40	Some dead wood.	
T8	English Oak	Quercus robur	18	9	5	500	B1	Mature	+40	Cavity at 1m on west.	
T9	English Oak	Quercus robur	20	8	4	500	B1	Mature	+40	Some dead wood.	
T10	English Oak	Quercus robur	20	10	6	500	B1	Mature	+40		
T11	English Oak	Quercus robur	18	7	5	500	B1	Mature	+40	Suppressed. Some dead wood.	
T12	English Oak	Quercus robur	18	10	2	600	B1	Mature	+40		
T13	English Oak	Quercus robur	18	7	5	600	B1	Mature	+40	Some dead wood.	
T14	Sweet Chestnut	Castanea sativa	15	10	-	800	C1	Mature	+40	Epicormic growth. Some dead wood.	
T15	English Oak	Quercus robur	20	8	-	700	C1	Mature	+40	Lean east.	
T16	Ash	Fraxinus excelsior	16	16	-	600	B1	Mature	+40		
T17	Sycamore	Acer pseudoplatanus	18	16	2	600	B1	Mature	+40	Ivy covered stem.	
T18	English Oak	Quercus robur	18	10	2	300	C1	Semi-Mature	+40		
T19	English Oak	Quercus robur	20	9	2	400	C1	Mature	+40		
T20	English Oak	Quercus robur	18	8	5	500	B1	Mature	+40		
T21	English Oak	Quercus robur	20	6	2	300	B1	Semi-Mature	+40		
T22	English Oak	Quercus robur	20	7	-	350	C1	Semi-Mature	+40		
T23	Ash	Fraxinus excelsior	12	5	-	200	N C1	Early-Mature	+40	Suppressed. Multi-stemmed	
T24	Ash	Fraxinus excelsior	12	6	-	300	C2	Semi-Mature	+40	Suppressed.	
T25	Sycamore	Acer pseudoplatanus	15	5	-	250	N C1	Early-Mature	+40	Multi-stemmed. Epicormic growth. Ivy covered stem	
T26	Sycamore	Acer pseudoplatanus	16	12	-	800	N C1	Mature	+40	Multi-stemmed. Epicormic growth. Ivy covered stem	
T27	English Oak	Quercus robur	22	15	-	850	C1	Mature	+40	Ivy covered stem. Some dead wood	
T28	English Oak	Quercus robur	10	2	-	250	C1	Early-Mature	+40	Ivy covered stem. Suppressed	
T29	English Oak	Quercus robur	10	4	-	200	N C1	Early-Mature	+40	Ivy covered stem. Multi-stemmed	
T30	English Oak	Quercus robur	20	9	6	700	B1	Mature	+40	Ivy covered stem.	
T31	English Oak	Quercus robur	18	10	3	550	B1	Mature	+40	Ivy covered stem.	
T32	English Oak	Quercus robur	10	6	-	150	C1	Early-Mature	+40	Ivy covered stem. Suppressed.	
T33	Ash	Fraxinus excelsior	15	8	2	600	N C1	Mature	+40	Multi-stemmed. Dieback. Some dead wood.	
T34	Sycamore	Acer pseudoplatanus	18	10	-	425	N C1	Semi-Mature	+20	Multi-stemmed. Ivy covered stem.	
T35	Sycamore	Acer pseudoplatanus	12	6	1	350	N C1	Early-Mature	+40	Suppressed. Multi-stemmed. Ivy covered stem.	
T36	English Oak	Quercus robur	18	11	-	700	B1	Mature	+40		
T37	English Oak, Sycamore, Beech	Quercus robur, Acer pseudoplatanus, Fagus sylvatica	18	10	-	700	B1	Mature	+40	Ivy covered stem.	
T38	Sycamore	Acer pseudoplatanus	10	6	-	200	N C1	Early-Mature	+40	Ivy covered stem. Multi-stemmed.	
T39	English Oak	Quercus robur	18	16	-	700	C1	Mature	+40	Ivy covered stem.	
G40	Lawson Cypress	Chamaecyparis lawsoniana	10	3	-	150	C2	Early-Mature	+40		
T41	English Oak	Quercus robur	15	15	4	750	C1	Mature	+40	Ivy covered stem.	
T42	English Oak	Quercus robur	13	12	3	300	C1	Semi-Mature	+40	Ivy covered stem. Lean west	
G43	English Oak	Quercus robur	14	10	-	100-200	N C1	Young	+40	Ivy covered stem. Multi-stemmed	
T44	English Oak	Quercus robur	20	12	5	700	C1	Mature	+40	Some dead wood. Ivy covered stem. Girdling rope at 2m. Cavity at base on east.	
T45	English Oak	Quercus robur	20	11	4	750	B1	Mature	+40	Some dead wood.	
T46	English Oak	Quercus robur	20	14	4	750	B1	Mature	+40	Ivy covered stem.	
G47	English Oak	Quercus robur	8-15	10	-	75-150	C1	Young	+40	30. No. Ivy covered stem.	
T48	English Oak	Quercus robur	18	10	5	500	B1	Mature	+40	Some dead wood.	
T49	English Oak	Quercus robur	18	9	4	500	C1	Mature	+40	Some dead wood. Lean east. Old wound healing. Girdling damage.	
T50	English Oak	Quercus robur	18	10	6	550	C1	Mature	+40	Nails in trunk. Cavity at base.	
T51	English Oak	Quercus robur	18	7	2	450	B1	Mature	+40		
T52	English Oak	Quercus robur	18	7	5	600	B1	Mature	+40	Some dead wood.	
T53	English Oak	Quercus robur	18	11	6	500	C1	Mature	+40	Cavity at base on west side. Healing split between 4-8m height.	
T54	English Oak	Quercus robur	16	11	6	500	C1	Mature	+40	Some dead wood. Ivy covered stem. Epicormic growth.	
T55	Sycamore	Acer pseudoplatanus	8	6	-	100	N C1	Young	+40	Multi-stemmed.	
T56	English Oak	Quercus robur	18	8	-	500	C1	Mature	+40	Cavity at base on west.	
T57	English Oak	Quercus robur	18	6	2	400	C1	Mature	+40		
T58	English Oak	Quercus robur	18	7	-	400	U	Mature	+40	Some dead wood. Decay through trunk.	
T59	English Oak	Quercus robur	20	10	7	600	B1	Mature	+40	Nest in canopy at 18m.	
T60	English Oak	Quercus robur	20	10	5	700	B1	Mature	+40	Some dead wood.	
T61	English Oak	Quercus robur	20	6	-	500	C1	Mature	+40	Suppressed.	
T62	English Oak	Quercus robur	18	8	3	500	C1	Mature	+40	Limb broken from vehicle collision at 2m. Some dead wood.	
T63	English Oak	Quercus robur	20	17	1	700	B1	Mature	+40	Limb broken vehicle collision at 2m. Some dead wood.	
T64	English Oak	Quercus robur	18	7	-	500	C1	Mature	+40		
T65	English Oak	Quercus robur	11	8	2	400	C1	Mature	+40	Some dead wood.	
T66	English Oak	Quercus robur	11	9	4	600	B1	Mature	+40		
T67	English Oak	Quercus robur	11	9	6	700	B1	Mature	+40	Some dead wood.	
T68	English Oak	Quercus robur	8	5	-	150	C1	Young	+40	Lean north. Suppressed.	
T69	English Oak	Quercus robur	18	9	-	450	C1	Mature	+40	Broken branch at 10m.	
T70	English Oak	Quercus robur	7	4	-	200	C1	Young	+40	Suppressed.	
T71	English Oak	Quercus robur	20	12	4	700	C1	Mature	+40	Lean south. Branch damage from vehicle collision.	
T72	English Oak	Quercus robur	20	9	4	500	C1	Mature	+40		
T73	English Oak	Quercus robur	20	8	7	700	B1	Mature	+40		
T74	English Oak	Quercus robur	20	10	8	500	C1	Mature	+40	Some dead wood. Cavity at base.	
T75	English Oak	Quercus robur	20	10	-	550	U	Mature	0-10	Fire damage at the base. 60% of bark lost.	
T76	English Oak	Quercus robur	18	10	15	500	B1	Mature	+40	Some dead wood.	
T77	English Oak	Quercus robur	20	12	-	600	B1	Mature	+40	Some dead wood.	
T78	English Oak	Quercus robur	8	8	-	400	U	Mature	+40	Lean south-west. Decay in cavity on trunk.	
T79	English Oak	Quercus robur	14	10	-	250	C2	Early-Mature	+40	On wall above site.	
T80	English Oak	Quercus robur	18	12	2	700	B1	Semi-Mature	+40	Ivy covered stem.	
T81	English Oak	Quercus robur	18	12	3	600	C1	Mature	+40	Ropeswing girdling to branch. Wet cavity on south-west at 6m. Cavity at base on south-west and north-west.	

HEDGES											
H1	Beech, Hawthorn	Fagus sylvatica, Crataegus monogyna	3-4	1	-	30-50	C2	Young	40+		

TREE SURVEY TO BS5837:2012

KEY	COLOUR	QUALITY	DESCRIPTION
GREEN	●	A: HIGH	Vigorous healthy good form, retention most desirable
BLUE	●	B: MODERATE	Slightly impaired condition, numerous immature, A' potential
GREY	●	C: LOW	Adequate condition requiring minimal surgery
RED	●	U: FELL	Dead dying, dangerous insecure rooting, significant fungal disease
GREEN	■	SHRUBS	

SUB-CATEGORY:

- 1 ARBORICULTURAL
- 2 LANDSCAPE
- 3 CULTURAL/CONSERVATION

--- Site Boundary

In accordance with BS5837:2012 'Trees in relation to design, demolition and construction', offsite trees within a distance equal to 12x stem diameter from boundary should be surveyed. In accordance with good working practice, all trees within 12m of the site boundary have been surveyed.

The original of this drawing is produced in colour - a monochrome copy should not be relied upon.

LIMITATION OF THIS SURVEY
This survey records amenity quality and desirability of tree retention in relation to proposed construction by visual inspection from ground level where accessible.

It does not constitute a Tree Inspection or detailed report on condition.

Tree heights and spread approximate. The diameter of single stem trees is taken at 1.5m above ground level. For the diameter of multistemmed trees, each multistem is measured at 1.5m above ground level and calculated to give a notional diameter as if all multistems were fused into one stem.

The branch spread is an accurate representation of the crown as clause 4.4.2.5 (e)

Tree inspections should take place annually in September/October when trees are in leaf.

Several trees have girdling damage by wire or rope garotting. This is noted where visible. There may be other girdling damage not visible due to density of shrubberies. Detailed inspection of retained trees should be carried out at time of site clearance.

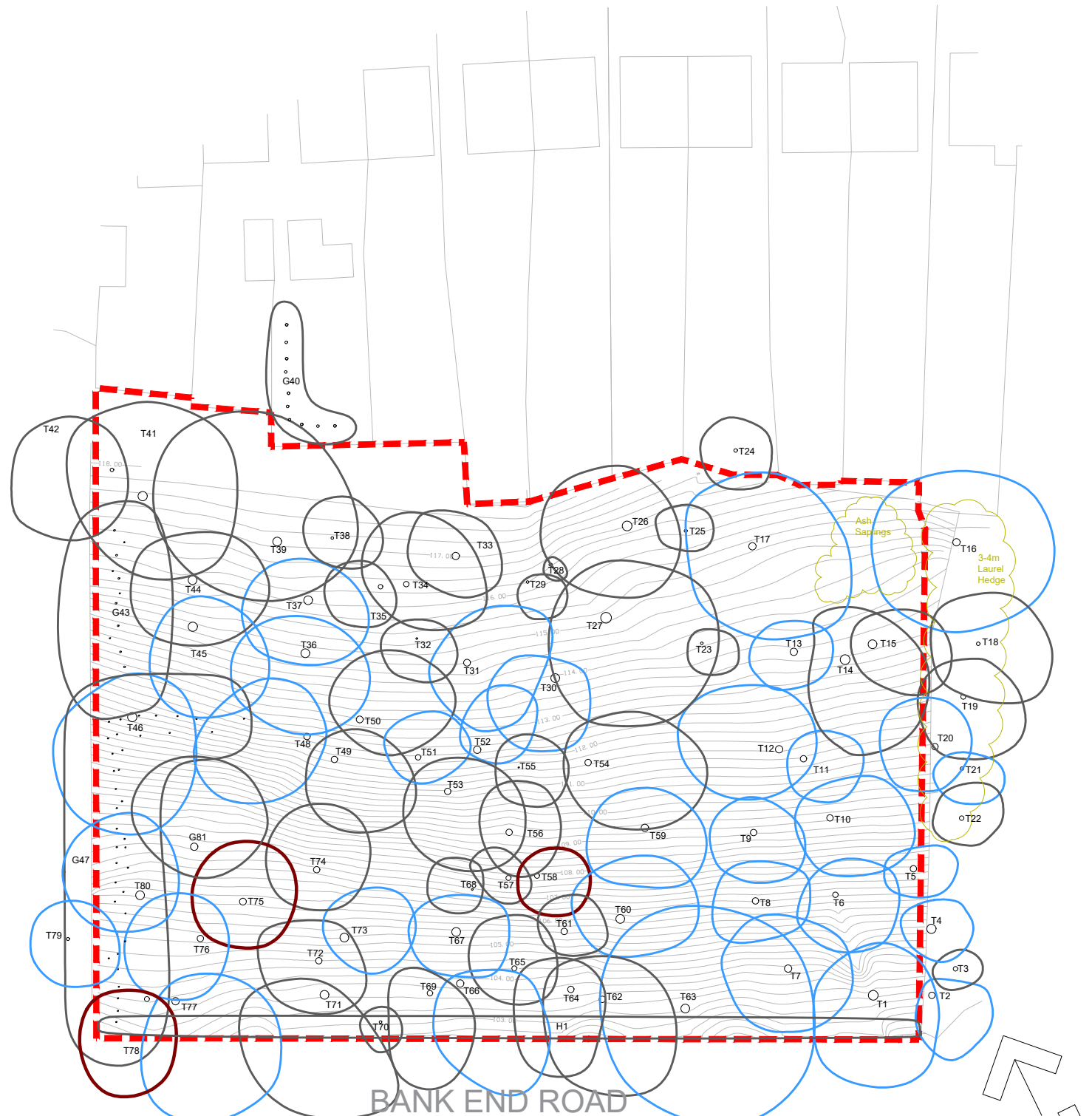

Scale 1:500
0 5 10 15 20 25 [m]

Based on Star Surveys Topographic Survey drawing no. 2966/19 rec'd OCT 2019

Weddle Landscape Design
LANDSCAPE ARCHITECTURE
ENVIRONMENTAL PLANNING
Mews Studio, Charnwood House, Tel (0114) 250 1181
8 Kenwood Bank, Sheffield S7 1NU Fax (0114) 250 1188
www.weddles.co.uk mail@weddles.co.uk

Job BANK END ROAD, BARNSELEY

Title TREE SURVEY

scale@A3	drawn	date	job number	number	revision
1:500	TH	JAN 20	1001	003	-