



The
University
Of
Sheffield.

Darton, Barnsley, South Yorkshire

Archaeological Desk-Based Appraisal

ARCUS report 1268.1(1)

March 2009

Client: Morgan Ashurst plc

12
Archaeological Desk-Based Appraisal



Churchfield Lane, Darton, Barnsley

Grid Reference: SE 3096 0988

Archaeological Desk-Based Assessment

Assessment Report No. 1268.1(1)

© ARCUS 2009

Reporting: Helen Holderness

Project manager: Glyn Davies

Project supervisor: Glyn Davies

Illustrations: Helen Holderness

Client: Morgan Ashurst plc

Client address: Pavillion Court, Green Lane, Garforth, Leeds, L25 2AF

Location of archive: ARCUS



Planning reference: Outline planning proposal

Copyright Declaration:

ARCUS give permission for the material presented within this report to be used by the archives/repository with which it is deposited, in perpetuity, although ARCUS retains the right to be identified as the author of all project documentation and reports, as specified in the Copyright, Designs and Patents Act 1988 (chapter IV, section 79). The permission will allow the repository to reproduce material, including for use by third parties, with the copyright owner suitably acknowledged.

Disclaimer:

This document has been prepared for the commissioning body and titled project (or named part thereof) and should not be relied upon or used for any other project without an independent check being carried out as to its suitability and prior written authority of ARCUS being obtained. ARCUS accepts no responsibility or liability for the consequences of this document being used for a purpose other than that for which it was commissioned. Any person/party using or relying on the document for such other purposes agrees, and will by such use or reliance be taken to confirm their agreement to indemnify ARCUS for all loss or damage resulting therefrom. ARCUS accepts no responsibility or liability for this document to any party other than the person/party by whom it was commissioned.

Checked by: 	Passed for submission to client: 
Date: 4/3/09	Date: 4/3/09
Helen Holderness Project Archaeologist	Glyn Davies Project Manager

CONTENTS

LIST OF ILLUSTRATIONS AND PLATES	3
NON-TECHNICAL SUMMARY	4
1 INTRODUCTION	5
1.1 Scope of Report.....	5
1.2 Site Location.....	5
2 AIMS AND METHODOLOGY	5
2.1 Aims and Objectives	5
2.2 Methodology.....	5
2.3 Geotechnical Data	6
3 PLANNING FRAMEWORK	6
3.1 Designations	6
3.2 Planning Policies	6
4 ARCHAEOLOGICAL AND HISTORICAL BACKGROUND	6
4.1 Gazetteer of Known Archaeological Sites	7
4.2 Prehistoric to Roman	7
4.3 Medieval	7
4.4 Sixteenth to Eighteenth Centuries	7
4.5 Nineteenth to Twentieth Centuries	7
4.6 Site Inspection.....	8
5 ARCHAEOLOGICAL POTENTIAL AND SIGNIFICANCE	8
5.1 Assessment of Current State of Knowledge.....	8
5.2 Significance Assessment Methodology.....	9
5.3 Potential for Survival of Archaeological Remains	9
5.4 Development Proposals and Potential Impact.....	9
6 CONCLUSIONS	10
7 ARCHIVE	10
8 ACKNOWLEDGEMENTS	10
9 BIBLIOGRAPHY	10
11 ILLUSTRATIONS AND PLATES	11

LIST OF ILLUSTRATIONS AND PLATES

Illustrations

- 1 Site location map
- 2 Location of known SMR sites
- 3 1854 Ordnance Survey map
- 4 1893 Ordnance Survey map
- 5 1932 Ordnance Survey map
- 6 1961 Ordnance Survey map
- 7 2007 Ordnance Survey map
- 8 Overlay of 1961 OS on 2007 OS map
- 9 Site plan showing ground conditions

Plates

- 1 Present entrance to the site
- 2 Site from new Huddersfield Road looking southwest
- 3 Revetted wall across middle of the site
- 4 House on concrete platform to rear of council offices
- 5 Land to southwest of council offices
- 6 Tarmac surface and garages along western boundary
- 7 Public lavatories on southeast boundary: lamp-post would mark rear corner of Rock Cottage
- 8 Bedrock from Churchfield Lane
- 9 View along Churchfield Lane towards Darton
- 10 View along line of old Huddersfield Road
- 11 Darton All Saints' Church opposite the site
- 12 Old vicarage opposite the site

NON-TECHNICAL SUMMARY

In February 2009, ARCUS were commissioned by Morgan Ashurst plc to undertake an archaeological desk-based assessment on a site at Darton, Barnsley, South Yorkshire (NGR SE 3096 0988). The evaluation was required to inform an outline planning application for redevelopment at the site. The assessment consisted of documentary and cartographic research, and a site visit.

The village of Darton has a long history which can be traced back to the early medieval period. The church, which is close to the site, was founded in the 12th century, although the present church probably dates from the 16th century.

The site has no known archaeological features and although a small building is known from the map data, no trace survives and its location is now under the modern footpath and road. The southern edge of the site appears to have been the northern edge of Darton Quarry in the mid-19th century, although no quarrying has been recorded within the development area.

The construction of council offices in the 1930s removed the soil and bedrock on the northern half of the site. A house at the rear of the council offices was built on a levelled area at the same time. These actions would have removed any potential archaeology in over half of the site. The potential for surviving archaeological features across the remaining area of the site is low, as the observed soil depth at the southern edge is approximately 0.30m, immediately overlying the bedrock.

1 INTRODUCTION

1.1 Scope of Report

This report presents the results of an archaeological desk-based assessment on a site at Churchfield Lane, Darton, Barnsley, South Yorkshire. This was required to inform an outline planning application for redevelopment at the site and was undertaken in line with Barnsley Unitary Development Plan policies BE3 and BE4, and the government's guidance set down in PPG16. The assessment consisted of documentary and cartographic research, as well as a site visit, and was prepared in accordance with Institute for Archaeologists guidelines (IfA 2008) and with a brief prepared by South Yorkshire Archaeology Service. ARCUS were commissioned by Morgan Ashurst plc to undertake the assessment.

1.2 Site Location

The site (centred on NGR SE 3096 0988), is located at a junction of the main Huddersfield to Barnsley road, Darton, c.4km northwest of Barnsley (**Illustration 1**). It is bounded to the north by Huddersfield Road and to the southeast by Churchfield Lane. The western boundary is formed by small housing estate, with the M1 motorway further to the west.

The underlying geology consists of sandstone.

2 AIMS AND METHODOLOGY

2.1 Aims and Objectives

The general aim of the assessment is to determine the nature of the archaeological resource in areas affected by the proposed development. This is achieved by collating existing archaeological and historical information relating to the proposed development and its immediate environs and by placing it in its local, regional and national context.

The specific aims are:

- to assess the survival and potential significance of buried archaeological remains within the application area; and
- to assess the extent of impact likely to be caused by the proposed development.

2.2 Methodology

All relevant and readily available published and unpublished documentary sources were consulted, including historic maps and photographs. Information on recorded archaeological sites was obtained from the regional authority. Data was collected from the following sources:

- South Yorkshire Sites and Monuments Record (HER);
- Sheffield Archives;
- Barnsley Archives and Local Studies Library;
- Archaeology Data Service (ADS).

A site visit was made on 20th February 2009, to assess the current land use and identify any visible archaeological or historic features. Areas of previous ground

disturbance which may have affected the survival of buried archaeological deposits were also noted. Recording consisted of an annotated sketch plan and digital photography.

2.3 Geotechnical Data

No known geotechnical investigations have been undertaken at the site.

3 PLANNING FRAMEWORK

3.1 Designations

All cultural heritage designations were checked for the area, including Scheduled Monuments, Listed Buildings, Conservation Areas, Registered Parks and Gardens, and Registered Battlefield Sites. The proposed development site is not within a Conservation Area and contains no sites with cultural heritage designations.

3.2 Planning Policies

Barnsley Unitary Development Plan, adopted 2003, contains policies for the protection of the historic environment, covering issues such as Listed Buildings and Conservation Areas, development within sensitive areas and archaeological remains. The policies are based on the government's planning guidelines set down in PPG15 (Planning and the Historic Environment, 1994) and PPG16 (Planning and Archaeology, 1990). PPG 16 emphasises the need for archaeological issues to be considered early in the planning process and provides a framework for the investigation of sites and the management of archaeological remains, which are considered to be a finite and non-renewable resource (PPG16, paragraph 6). Where archaeological remains of national significance are identified, preservation *in situ* is the preferred option, although in cases of lesser significance, preservation by record may be an acceptable alternative (PPG16 paragraph 25; UDP policies BE3 and BE4).

4 ARCHAEOLOGICAL AND HISTORICAL BACKGROUND

This section presents a summary of the historical and archaeological background of the area, focusing in particular on the proposed development site. Information on known archaeological sites and findspots within 1km of the site was compiled from the South Yorkshire SMR. Historic maps and plans of the area were consulted, including the Ordnance Survey series. Relevant documents, databases and secondary sources, published and unpublished, were also consulted. A gazetteer of known archaeological sites and historic structures was compiled from this information, and is presented below, with the locations of the sites shown on **Illustration 2**.

Glossary of time periods referred to in the text:

Palaeolithic:	500,000-10,000 BC	Mesolithic:	10,000-4000 BC
Neolithic:	4000-2300 BC	Bronze Age:	2300-700 BC
Iron Age:	700 BC-AD 43	Romano-British:	AD 43-450
Early Medieval	450-1066	Medieval:	1066-1485
Post-Medieval	1485-1900	Modern:	1901-present

4.1 Gazetteer of Known Archaeological Sites

Site no	Description	NGR	Identifier
1	The Vicarage, 17-21 Church Street. Three houses, formerly an 18 th -century vicarage with 19 th -century alterations. Grade II listed.	SE 3105 0995	SMR 3942
2	All Saints Church, Darton. Perpendicular church, chancel with inscription '1517'. Grade I listed.	SE 3110 0990	SMR 3989
3	Site of Darton Mill, Barnsley. A corn mill first recorded in 1260, which continued in use into the late 19 th century, when it was converted to a saw mill. Disused by 1914.	SE 3120 1015	SMR 4744
4	Site of Darton Hall, a fine house of 17 th -century appearance, demolished in 1966.	SE 3157 1005	02157

4.2 Prehistoric to Roman

The available sources list no prehistoric sites within the 1km search area. A Romano-British urn was discovered towards the end of the 17th century (Fletcher 1899, 270) but no clear location is given. ADS has a four-figure grid reference of SE 31 09 (NMR NATINV-52420), which places the find within the 1km grid square to the southeast of the proposed development site.

4.3 Medieval

Darton was first recorded in the Domesday Survey of 1086, which stated that prior to 1066, the manor of 'Dertune' was held by the Lords of Barugh and Cawthorne. Following the Norman Conquest, the manor was granted to Ilbert de Laci, who held large estates in the area (Atkinson 1994). Domesday Book noted that the village had four carucates of taxable ploughland, with four villagers and a small holder having two ploughs. It also contained woodland and pasture one league long and one wide. The name of the settlement derives from 'deor-tun', meaning deer park or enclosure (Smith 1961, 317). This may indicate that there was an early medieval hunting park in the vicinity of the settlement.

The original church was built in 1154 by the de Laci family and may have been damaged by fire. It was rebuilt in the late 15th century and completed by the monks of Monk Bretton priory in 1522 (Mee 1969). The location of the medieval village is not known, but 19th-century maps suggest that Darton may have been a relatively dispersed settlement, with no clear settlement focus. There is currently no evidence for medieval settlement in the immediate vicinity of the church.

4.4 Sixteenth to Eighteenth Centuries

Darton was well known for its nail making trade during the 18th century. This appears to have been a 'cottage industry', with no large scale works (Mee 1969). There are some suggestions that iron and coal mining has been carried out in the area since the 15th century. No mining activity is known to have taken place in the immediate vicinity of the proposed development site.

A vicarage was built in 1716 to the northeast of, and slightly downhill from, the proposed development site (Plate 12), opposite the church and on the outskirts of the current village.

4.5 Nineteenth to Twentieth Centuries

The village and area of Darton was enclosed in the 1820s (EM 981), but no associated map is held at Sheffield or Barnsley archives. The only recorded tithe map for the parish dates to 1903, and was not examined for the assessment, as this post-dates the Ordnance Survey coverage.

The Ordnance Survey map of 1854 (**Illustration 3**) depicted the site as a field, with a small building along the southern boundary of the site. The 1893 OS map showed this as Rock Cottage (**Illustration 4**), the name probably deriving from its location against the northern face of Darton Quarry. This was a sandstone quarry, shown on the 1854 map, but was disused by 1893. The northern edge of the quarry forms the southern boundary of the proposed development area. The date of the quarry's original establishment is unknown, but Churchfield Lane appears to run through the northern part of the quarry, suggesting that it is of some antiquity. The 1893 map indicated that Rock Cottage was associated with the field to the north, within the proposed development site.

The census returns for 1841, 1861 and 1891 did not mention Rock Cottage, and it is possible that the cottage was derelict or that it was occupied by squatters or as temporary accommodations for quarry workers. The 1932 map depicted the cottage as having been split into two properties (**Illustration 5**). The land to the north was still a field at that date. Council offices were built within the field in the mid-1930s, with a two-storey structure built on a concrete platform to the southwest (**Plate 4**). Public lavatories had been built at the south end of the site, adjacent to Rock Cottage, by 1961 (**Illustration 6**).

The Rock Cottage dwellings were demolished after 1961, possibly in association with the widening of Churchfield Lane and construction of a bus stop. The pavement now partially overlies the site of the northern cottage (**Illustrations 7-8**).

4.6 Site Inspection

A site visit was undertaken on the 20th February 2009 (**Illustration 9**). It is clear that a significant amount of landscaping was carried out on the northern half of the site during the construction of the council offices (**Plates 1-2**), including the removal of bedrock and soil. There is a 1.50m revetted wall dividing the site (**Plate 3**). The western side of the site has a tarmac surface and two garages lie on the western boundary (**Plate 6**). The land at the north side of the site has been landscaped where the modern Huddersfield Road cuts to the north and the patch of grass slopes down towards the site; there is a large man-hole cover suggesting that mains services run below the ground (**Plate 10**).

The lavatories have been boarded up and are built in similar brick to the offices and house, suggesting that they were all built at the same time (**Plate 7**). There is no visible trace of the remains of Rock Cottage and the bed rock was exposed along much of the quarry face at the southeast boundary (**Plates 8-9**). The covering soil visible above the rock face was relatively thin (no more than 0.30m) and appears to immediately overlie the bedrock.

5 ARCHAEOLOGICAL POTENTIAL AND SIGNIFICANCE

5.1 Assessment of Current State of Knowledge

The current state of knowledge of above-ground remains is considered to be good, and is based on SMR records and the site visit. The current state of knowledge of the sub-surface archaeological resource is moderate. No known archaeological or geotechnical investigations have been carried out within the site, therefore the current knowledge is based on recorded sites in the vicinity, and conditions observed during the walkover survey.

5.2 Significance Assessment Methodology

There is currently no nationally agreed methodology for measuring the relative significance of archaeological monuments. PPG16 (paragraph 8) draws a distinction between nationally important remains and those of lesser significance. On this basis, it is possible to distinguish between sites based on factors including period, rarity, documentation, group value, vulnerability and diversity. The archaeological significance of the sites is allocated to one of five categories:

International: World Heritage Site;

National: Scheduled Ancient Monuments, Grade I Listed Building, or site/ building suitable for scheduling, or considered to be of national importance but not covered by the Secretary of State's criteria for scheduling;

Regional or District: Grade II* Listed Building, site or building which consists of a significant example in a regional context;

Local or Borough: Other archaeological sites, Grade II Listed Building, locally important historic building;

Negligible: Areas in which investigative techniques have proved negative archaeological results, or where large-scale destruction of deposits has taken place.

Significance ratings have only been assigned to the potential archaeological remains that are recorded cartographically, or in other documentation. No rating can be assigned to previously unrecorded deposits (e.g. medieval and earlier) although the potential for such deposits to exist must be acknowledged.

The potential for impact is an assessment of the likelihood of archaeological remains being affected by the proposed development. This is based on an analysis of the distribution of known archaeology in the vicinity, the current and historic land use, and the topographical situation. Based on this assessment, the potential for impact is assigned to one of four categories:

High: above average potential for encountering archaeological deposits, structures, artefacts or environmental remains;

Moderate: average potential for encountering archaeological deposits, structures, artefacts or environmental remains;

Low: below average potential for encountering archaeological deposits, structures, artefacts or environmental remains;

None: no potential for encountering archaeological remains due to previous disturbance or based on the results of prior investigations.

5.3 Potential for Survival of Archaeological Remains

No archaeological sites are recorded in the vicinity of the proposed development site. The potential for previously unrecorded archaeological deposits is low over most of the site, due to the extensive landscaping undertaken in advance of the construction of the council offices and associated structures in the 1930s. The main potential is for remains associated with the former Rock Cottage along the southern edge of the site.

5.4 Development Proposals and Potential Impact

The development is likely to have a low archaeological impact at the northern side of the site, as substantial landscaping appears to have been undertaken prior to the construction of the council offices in the 1930s. Some smaller areas of undisturbed ground may survive along the southwest and southeast boundary, mainly associated with the former Rock Cottage, although given the difference in height between this

area and the main part of the site, it is unlikely that this will form part of the proposed development.

6 CONCLUSIONS

The desk-based assessment has indicated that there is only a low potential for surviving sub-surface archaeological features or deposits within the proposed development area. The landscaping activities undertaken in association with the construction of the 1930s council offices and associated buildings are likely to have removed the majority of any buried archaeology within the development area. It is not possible, based on current knowledge, to establish whether the site was close to the medieval settlement of Darton.

7 ARCHIVE

The assessment archive, including primary written documents, plans and digital photographs, will be retained by ARCUS in the first instance, although it may be deposited with the relevant museum if any associated fieldwork is undertaken at the site at a later date. Copies of this report will be deposited with the South Yorkshire SMR, circulated to the client, and retained in the offices of ARCUS.

8 ACKNOWLEDGEMENTS

The author would like to thank the staff at the Sheffield Archives and Barnsley Local Studies Library. Andrew Lines and Sarah Howard of SYAS also assisted with information and data collection.

9 BIBLIOGRAPHY

References

Atkinson, S. 1994. *A Locality Study of Darton*. Unpublished manuscript, Barnsley Archives and Local Studies.

IfA. 2008. *Standard and Guidance for Archaeological Desk-Based Assessment*. Institute for Archaeologists.

Mee, A. 1969. *The King's England: Yorkshire West Riding*. London: Hodder & Stoughton.

Smith, A.H. 1961. *The Place-Names of the West-Riding of Yorkshire. Part 1*. English Place-Name Society volume 30: Cambridge University Press.

Primary documents

EM 981: Printed act for enclosing lands at Darton, 1820. Sheffield Archives.

Darton census records, 1841, 1861, 1891. (Barnsley Archives and Local Studies Library).

Historic maps

1854 Ordnance Survey 6 inch: 1 mile map.

1893 Ordnance Survey 25 inch: 1 mile map.

1934 Ordnance Survey 25 inch: 1 mile map.

1961 Ordnance Survey 1:2,500 map.

11 ILLUSTRATIONS AND PLATES



ARCUS Unit 6, Riverside Block Sheaf Bank Business Park, Prospect Road Sheffield, S2 3EN Phone: 0114 2225106 Fax: 0114 2224346	Project Name: Darton, Barnsley		Scale: 1:7500	Date: March 2009	Project No: 1268
	Title: Site location map		NGR: SE 3096 0988	Drawn by: H. Holderness	Illustration No: 1

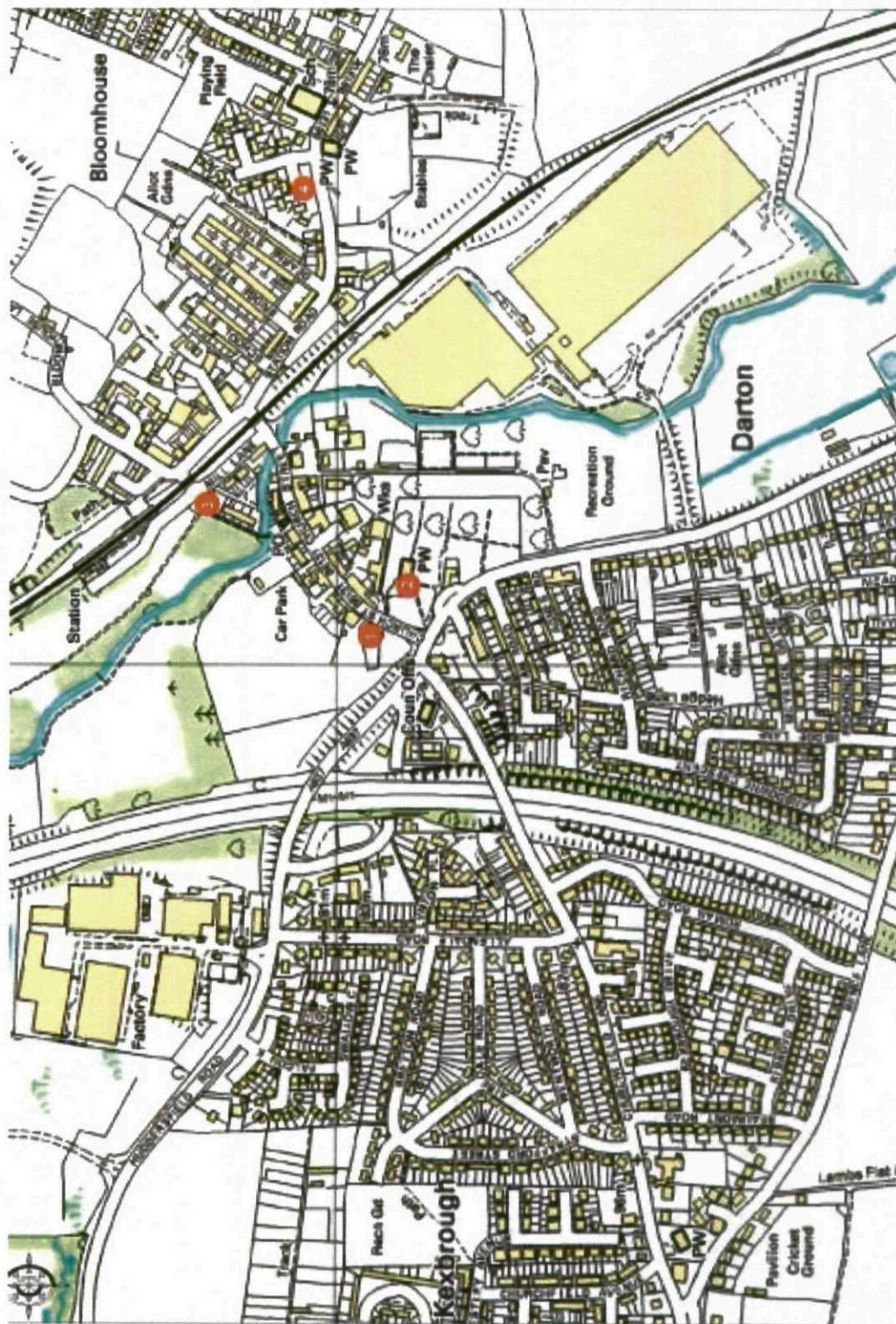

<p>ARCUS Unit 6, Riverside Block Sheaf Bank Business Park, Prospect Road Sheffield, S2 3EN Phone: 0114 2225106 Fax: 0114 2224346</p>	<p>Project Name: Darton, Barnsley</p>	<p>Scale: 1:7500</p>	<p>Date: March 2009</p>	<p>Project No: 1268</p>
<p>Title: Location of known SMR sites</p>	<p>Drawn by: H. Holderness</p>	<p>NGR: SE 3096 0988</p>	<p>Illustration No: 2</p>	

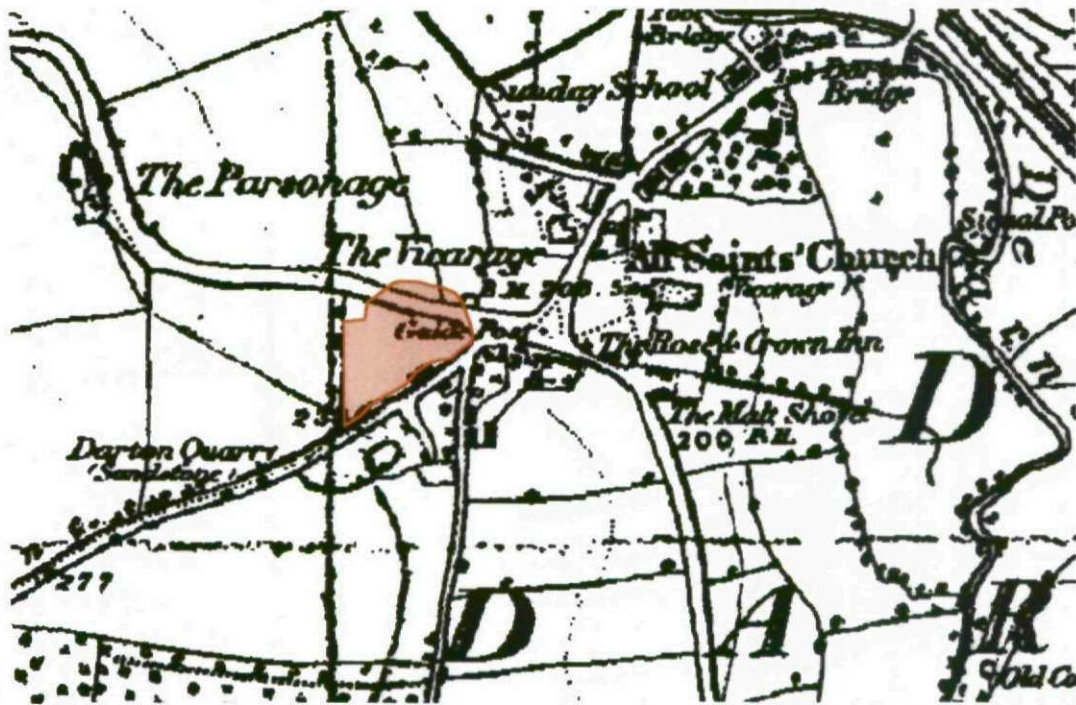

Illustration 3 Ordnance Survey map of 1854

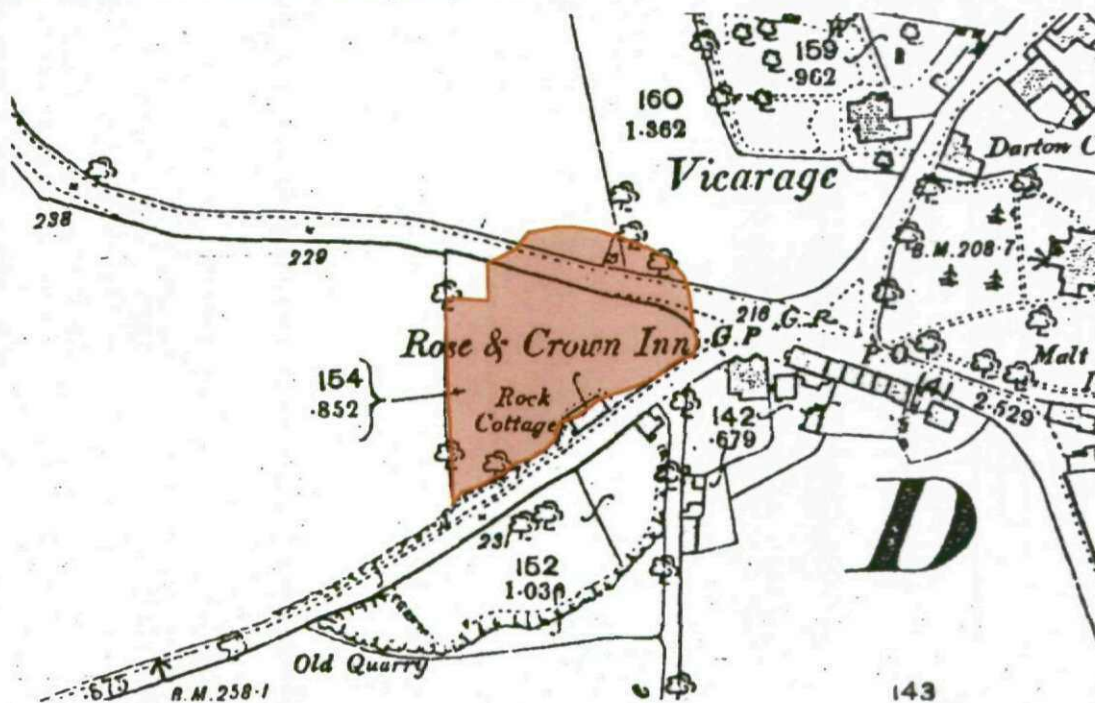

Illustration 4 Ordnance Survey map of 1893

ARCUS Unit 6, Riverside Block Sheaf Bank Business Park Prospect Road Sheffield S2 3EN Tel: 0114 2225106 Fax: 0114 2224346	Project:	Scale:	Date:
	Darton, Barnsley	n/a	March 2009
	Title:	NGR:	Drawn:
	Ordnance Survey 1854 Ordnance Survey 1893	SE 3096 0988	H.Holderness
	Project No:	Illustration No:	
	1268	3 & 4	

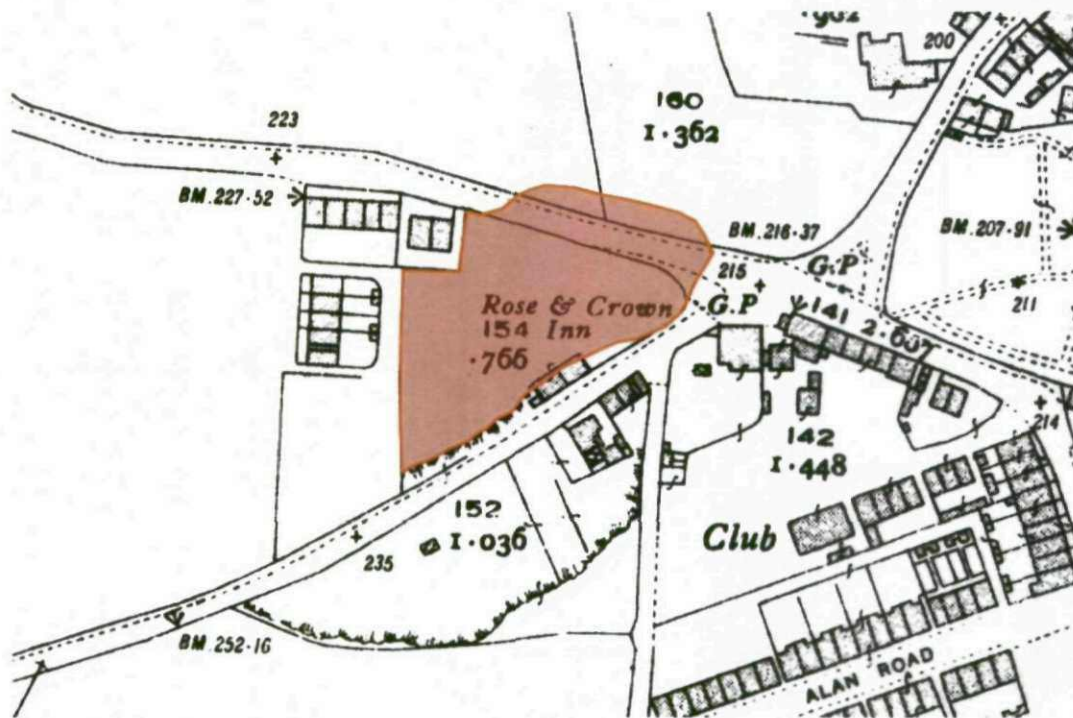

Illustration 5 Ordnance Survey map of 1932

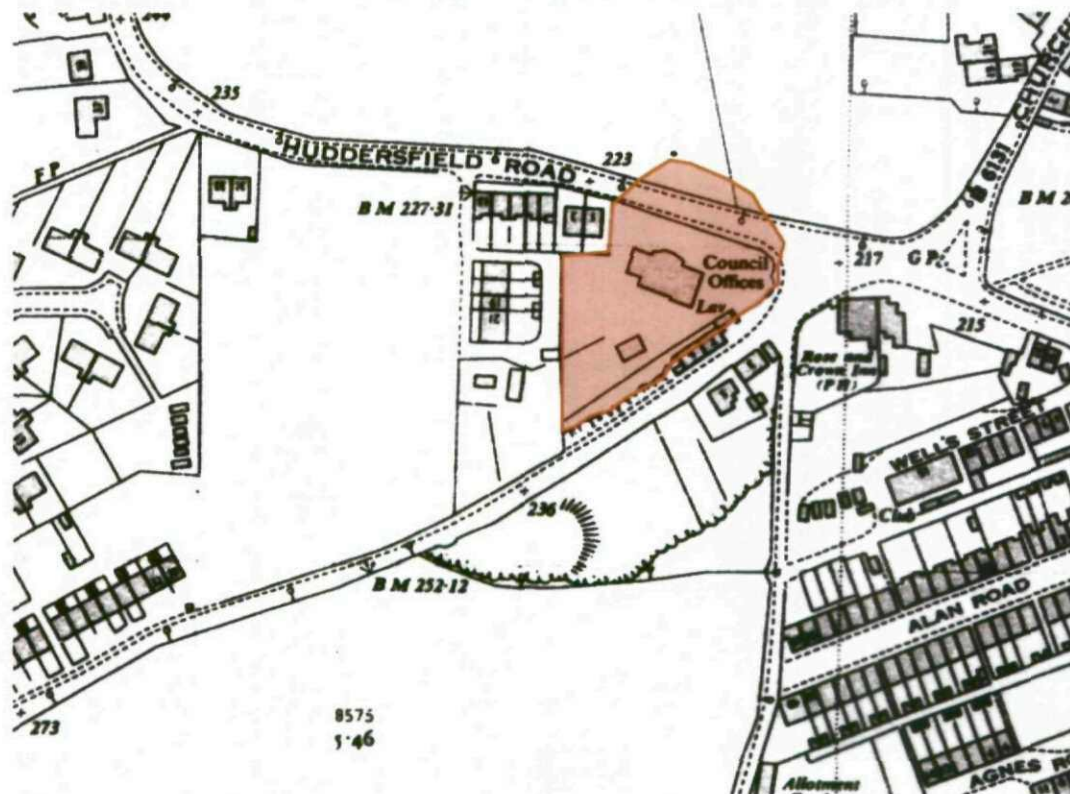
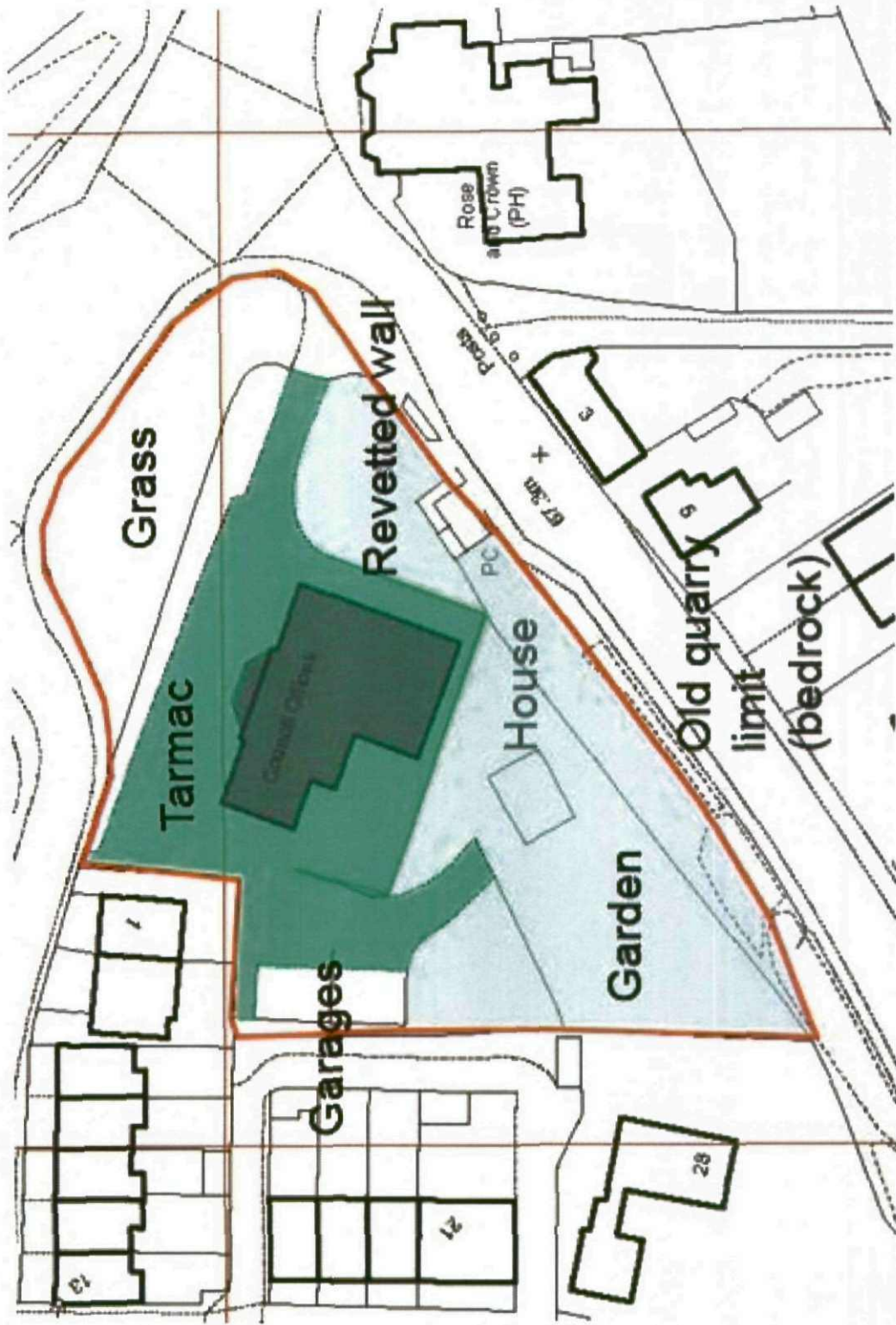

Illustration 6 Ordnance Survey map of 1961

ARCUS Unit 6, Riverside Block Sheaf Bank Business Park Prospect Road Sheffield S2 3EN Tel: 0114 2225106 Fax: 0114 2224346	Project: <p style="text-align: center;">Darton, Barnsley</p>	Scale: <p style="text-align: center;">n/a</p>	Date: <p style="text-align: center;">March 2009</p>
	Title: <p style="text-align: center;">Ordnance Survey 1932 Ordnance Survey 1961</p>	NGR: <p style="text-align: center;">SE 3096 0988</p>	Drawn: <p style="text-align: center;">H.Holderness</p>
		Project No: <p style="text-align: center;">1268</p>	Illustration No: <p style="text-align: center;">5 & 6</p>



ARCUS Unit 6, Riverside Block Sheaf Bank Business Park, Prospect Road Sheffield, S2 8EN Phone: 0114 2225106 Fax: 0114 2224346	Project Name: Darton, Barnsley		Scale: 1:7500	Date: March 2009	Project No.: 1268
	Title: Ordnance Survey map 2007		NGR: SE 3096 0988	Drawn by: H. Holderness	Illustration No.: 7



ARCUS Unit 6, Riverside Block Sheaf Bank Business Park, Prospect Road Sheffield, S2 8EN Phone: 0114 2225106 Fax: 0114 2224346	Project Name: Darton, Barnsley	Scale: n/a	Date: March 2009	Project No: 1268
	Title: Details of ground conditions at site	NGR: SE 3096 0988	Drawn by: H. Holderness	Illustration No: 9

PLATES



Plate 1 Present entrance to the site



Plate 2 Site from Huddersfield Road looking southwest



Plate 3 Revetted wall across middle of the site



Plate 4 House on concrete platform to rear of council offices



Plate 5 Land to southwest of council offices



Plate 6 Tarmac surface and garages along western boundary



Plate 7 Public lavatories on southeast boundary: lamp-post would mark rear corner of Rock Cottage



Plate 8 Bedrock from Churchfield Lane



Plate 9 View along Churchfield Lane towards Darton



Plate 10 View along line of old Huddersfield Road



Plate 11 Darton All Saints' Church opposite the site



Plate 12 Old vicarage opposite the site