

Ambient warehouse roof:
 Kingspan TD insulated composite roof panel with Sika Trocal roof membrane bonded to surface. Colour, Light Grey. Roof pitch 1".
 Roof drainage designed as a siphonic system by specialist.
 Roof lights to ambient warehouse at 10% of the ambient roof area.

Roof lights

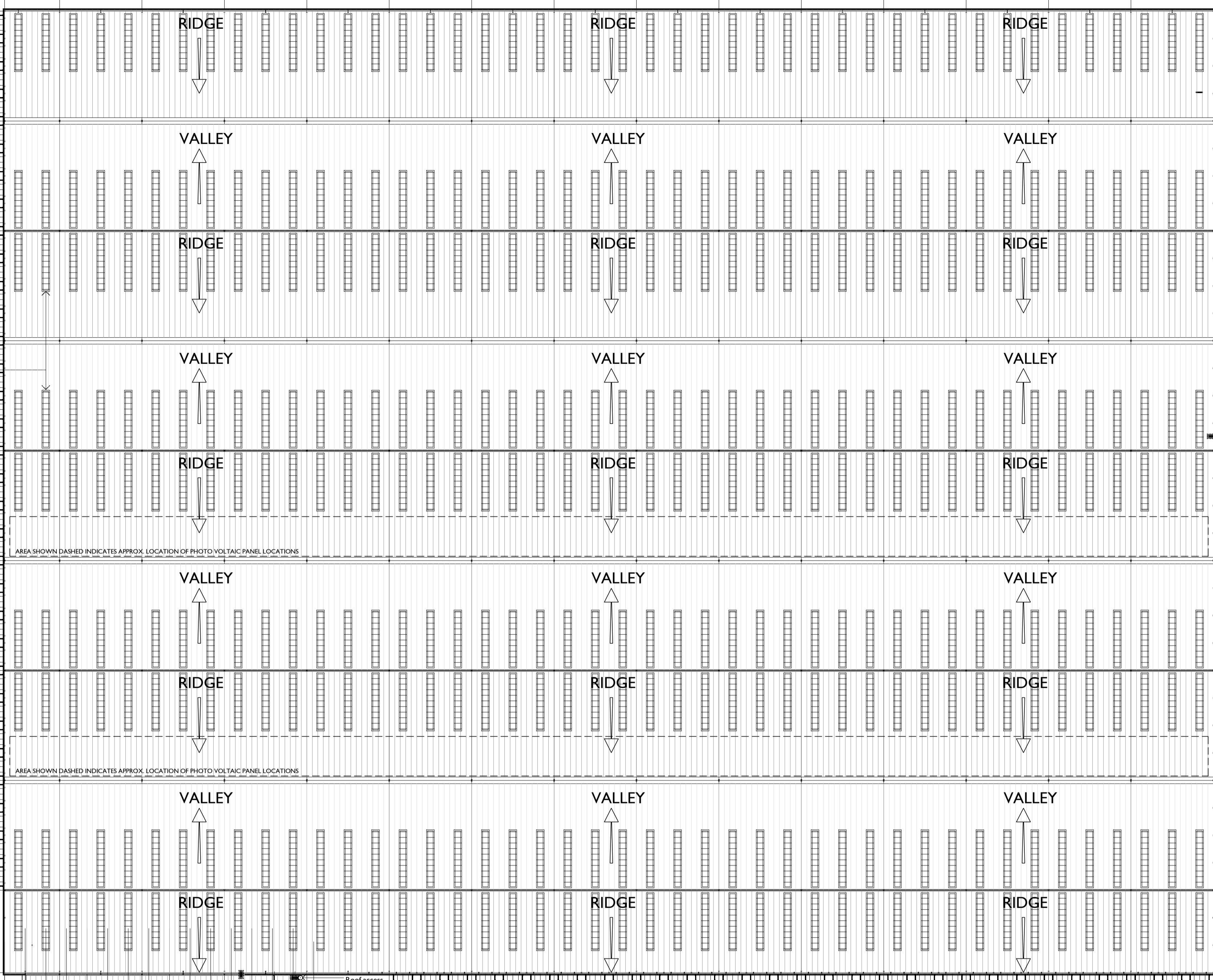

AREA SHOWN DASHED INDICATES APPROX. LOCATION OF PHOTO VOLTAGIC PANEL LOCATIONS

AREA SHOWN DASHED INDICATES APPROX. LOCATION OF PHOTO VOLTAGIC PANEL LOCATIONS

Office roof:
 Kingspan TD insulated composite roof panel with Sika Trocal roof membrane bonded to surface. Colour, Light Grey. Roof pitch 1".
 Roof drainage designed as a siphonic system by specialist.
 Roof lights over main entrance stairs and along first floor corridor.

Dock Pod:
 Single skin profiled metal sheet colour RAL 7016
 Rainwater to discharge via R.W.P. direct on to truck apron.

Recycling Area canopy roof:
 Single skin profiled metal sheet colour RAL 7016
 Anthracite pitched to central valley gutter.

Cold handling and freezer roof:
 Kingspan coldstore insulated composite roof panel with Sika Trocal roof membrane bonded to surface. Colour, Light Grey. Roof pitch 1".
 Roof drainage designed as a siphonic system by specialist.

Dalkin Scotton Partnership
 Architects Limited
PLANNING ISSUE

Revision	Description	Date	Drawn	Checked
A	REVISED TO CLIENTS COMMENT 11.09.12	17.09.12	DJN	SB

DALKIN SCOTTON PARTNERSHIP
 ARCHITECTS LIMITED
 305 FORT DUNLOP FORT PARKWAY BIRMINGHAM B24 9FD
 TEL - 0121 747 1943
 FAX - 0121 747 1944
 www.dsparchitects.com

CLIENT	ALDI STORES LTD.			
PROJECT	GOLDTHORPE INDUSTRIAL ESTATE COMMERCIAL ROAD, GOLDTHORPE			
TITLE	REGIONAL DISTRIBUTION CENTRE AMBIENT WAREHOUSE - ROOF PLAN			
DATE	16.08.12	SCALE	1:500 @ A1	DRAWN DJN
DWG No.	Y11A25-01-P220	REVISION	A	CHECKED SB
				NORTH

