

Notes
 All dimensions to be checked on site
 Any discrepancies to be reported immediately to the Architect
 Drawing to be read in conjunction with all relevant design information, including Architects, Services, Civil and Structural Engineers drawings
 All existing site, tree, building and survey information has been compiled from different sources, including information supplied by third parties

NOT FOR CONSTRUCTION

- Drawing Notes:**
- 1 Existing timber first floor structure to be removed as part of the proposition
 - 2 Existing roof truss to be removed as part of proposition, a scheme identifying structural alterations is to be produced by the Project Structural Engineer in due course
 - 3 Existing external masonry element to front of building which is assumed to be load-bearing and identified as requiring demolition / taking down as part of the proposition, the existing roof construction over is to be retained with new structural support provided to suit a design scheme which is to be produced by the Project Structural Engineer in due course
 - 3a Existing external masonry element forming cut out to outshut which is assumed to be load-bearing and identified as requiring part demolition / taking down to form an opening as part of the proposition, the existing roof construction over is to be retained with new structural support provided to suit a design scheme which is to be produced by the Project Structural Engineer in due course
 - 4 Existing windows to be stripped out of existing openings, openings to receive treatment as identified on Dawson Williamson Ltd proposals
 - 5 Existing doors to be stripped out of existing openings, openings to receive treatment as identified on Dawson Williamson Ltd proposals
 - 6 Existing 'Queen Post' roof truss to be altered to allow access through, a scheme identifying structural alterations is to be produced by the Project Structural Engineer in due course

General Structural Notes:
 All work is to be carried out in accordance with a design scheme and details which will be produced by the Project Structural Engineer
 The Principal Contractor is to be responsible for maintaining the integrity of the existing structure throughout the Construction Phase of the project

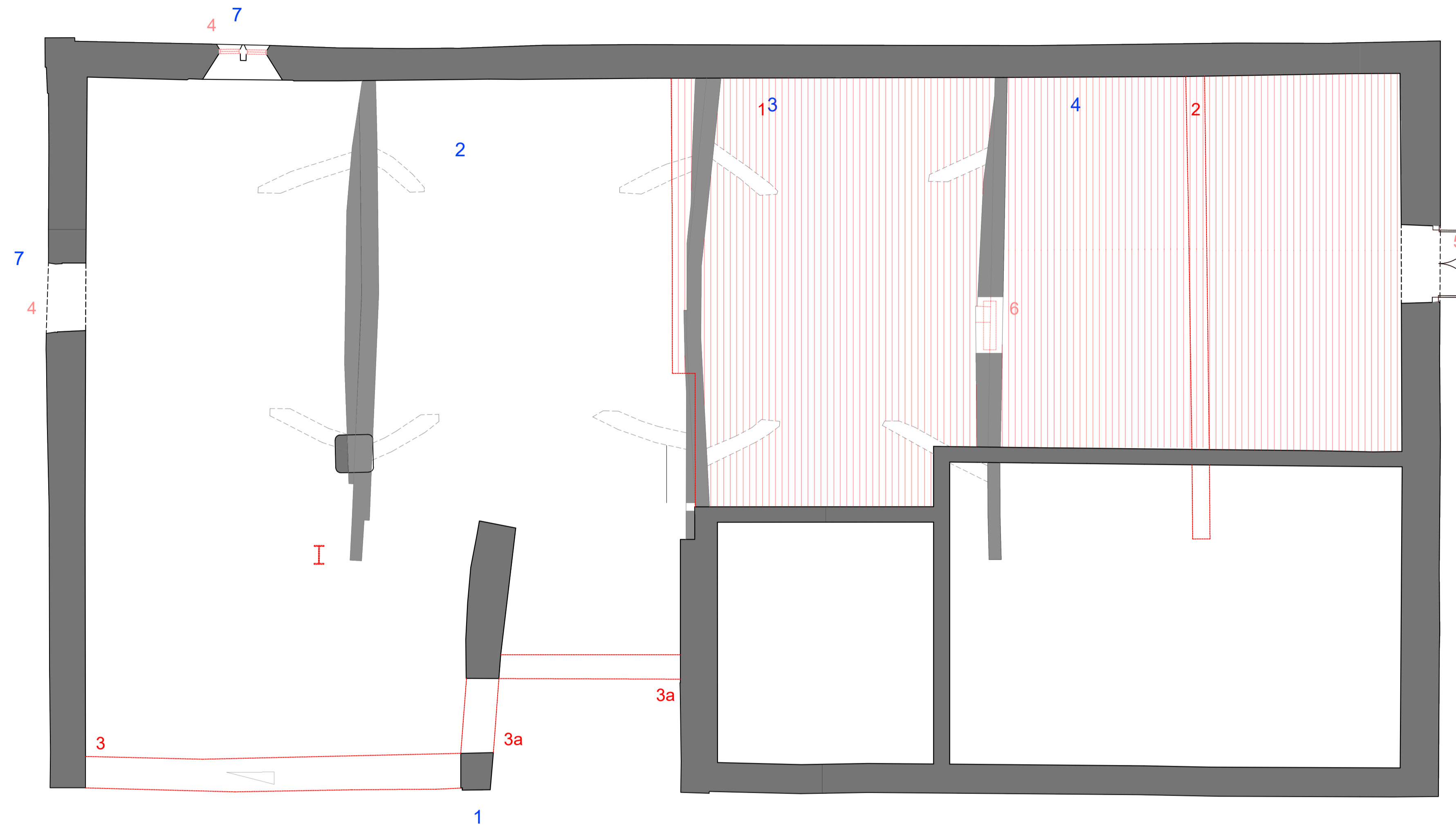

- Rev 2 2022.06.21 Design development, Drawing updated to 'Planning Issue' status
 Rev 1 2022.02.14 Notes added, design development

C1096 051 Rev 2

TITLE DEMOLITION & DOWNTAKINGS
 BUILDING 1
 HIGHER LEVEL
SCALE 1:50 @ A1 / 1:100 @ A1

PLANNING

PROJECT REFURBISHMENT OF NETHER MILL BARN
 (GRADE II LISTED BUILDING)
 TO FORM NEW VETERINARY SURGERY
 BARNISLEY ROAD
 PENISTONE
 S36

CLIENT DONALDSONS VETS LTD

DAWSON WILLIAMSON
 ARCHITECTS

Bradford Edinburgh
 01274 551 300

info@dawsonwilliamson.co.uk

THE DETAILS SHOWN ON THIS DRAWING ARE CONFIDENTIAL & THE DRAWING IS THE EXCLUSIVE PROPERTY OF DAWSON WILLIAMSON LTD. NO USE, COPY OR DISCLOSURE OF THE DRAWING MAY BE MADE WITHOUT OUR PERMISSION & THE DRAWING MUST BE RETURNED TO DAWSON WILLIAMSON LTD WHEN REQUIRED.
 © Dawson Williamson Ltd 2021