

OVERVIEW (SCALE 1:1000@A1)

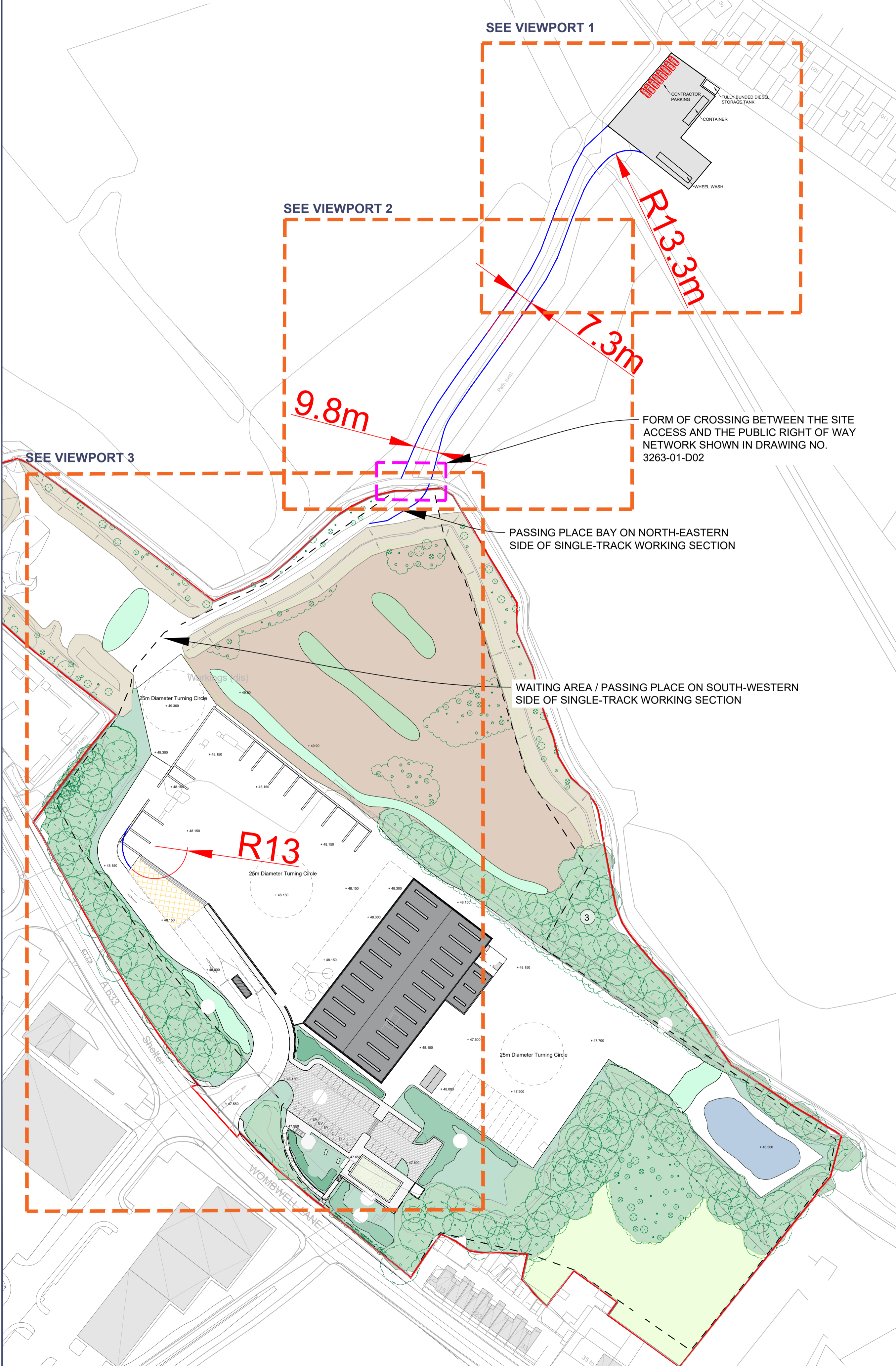

VIEWPORT 1 - PROPOSED SITE COMPOUND (SCALE 1:500@A1)

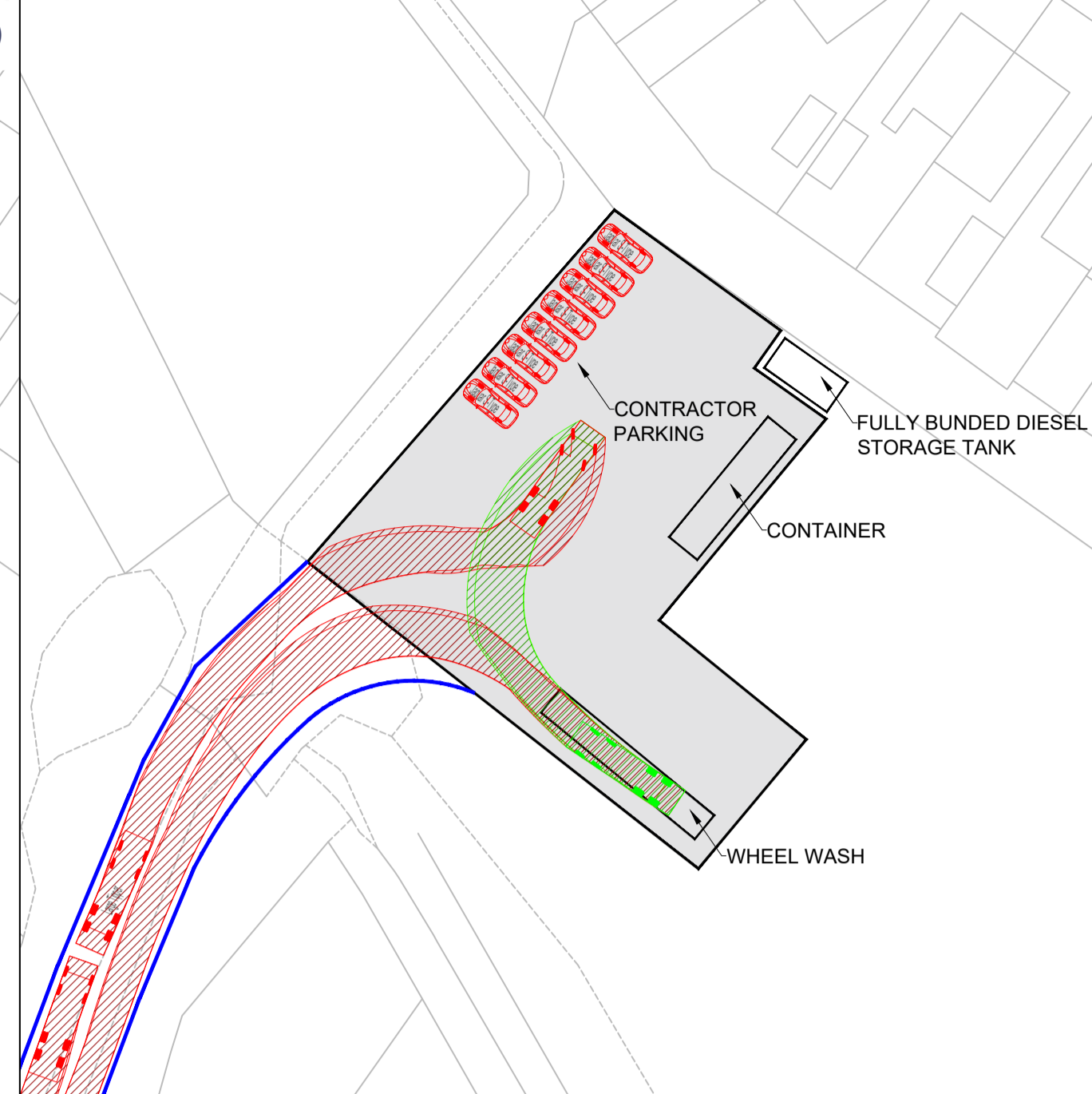
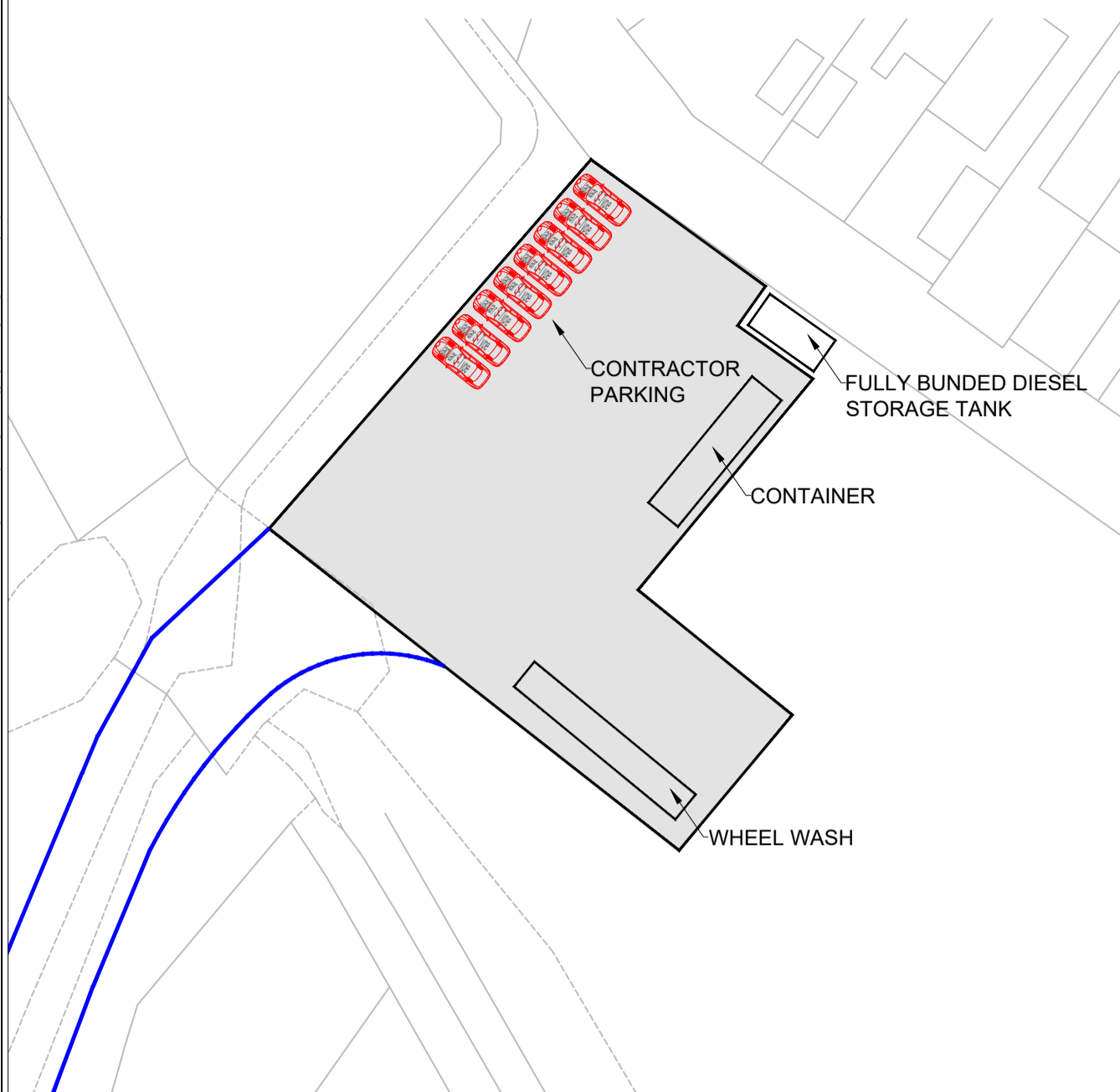

VIEWPORT 2 - SWEEP PATH ANALYSIS (SCALE 1:1000@A1)



VIEWPORT 3 - SWEEP PATH ANALYSIS (SCALE 1:1000@A1)

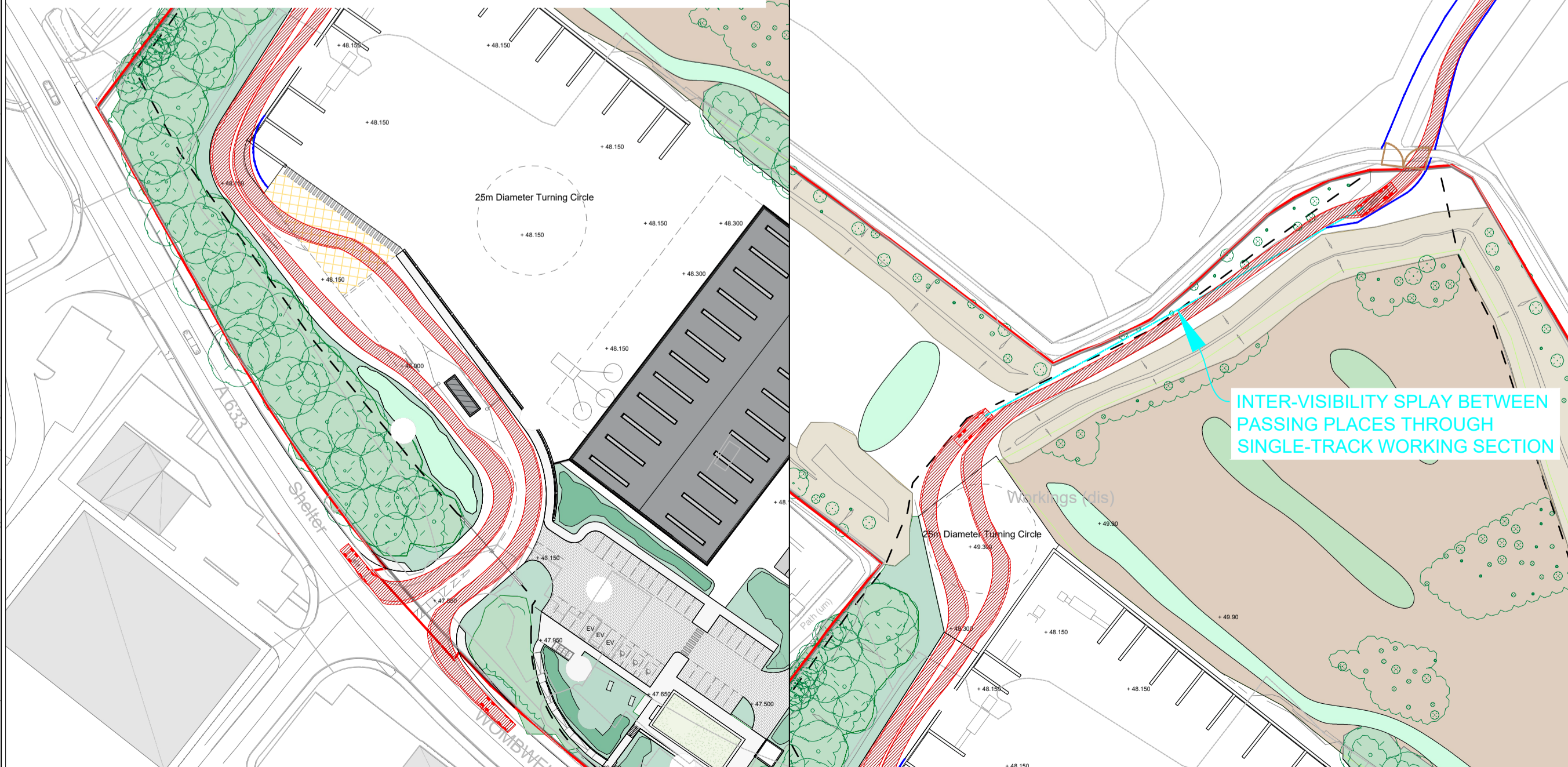

Proposed Widening to Access

Application Ref. 2024/0373 Site Boundary

Design Vehicle:

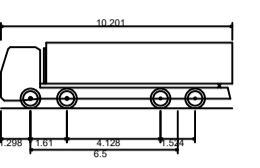

Large Tipper
 Overall Length: 10.201m
 Overall Width: 2.895m
 Overall Body Height: 2.895m
 Min. Body Ground Clearance: 0.241m
 Track Width: 0.271m
 Load to Road: 6.5m
 Kerb to Kerb Turning Radius: 11.550m

0344 8700 007
 axis.co.uk



Client
Green Earth (Stairfoot) Limited

Project
Stairfoot Quarry

Drawing Title

Proposed Site Access Arrangements

Scale: **As Stated** Status

Date: **October 2025** Drawn: **JD** Checked: **SH**

Dwg no: Rev

Figure NTS3

This drawing is the copyright of AXIS P.E.D Limited and may not be loaned, copied or reproduced in any way - or used for any offer, quote, tender or construction purposes without written consent of the company to do so. Follow any figured dimensions - do not scale for construction purposes. If in doubt ask.



revision: desc:

date: