

Proposed Site Plan

1 : 250

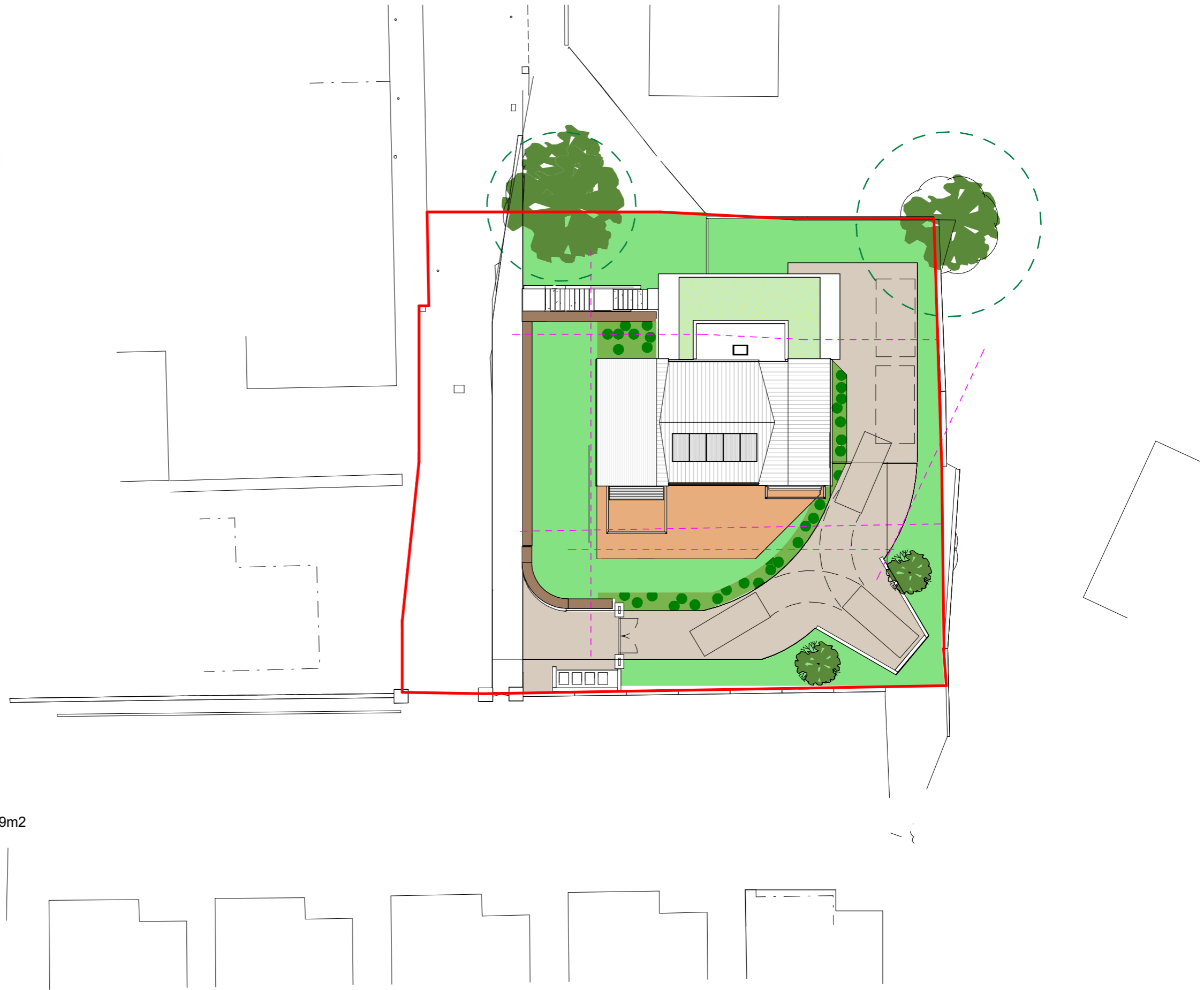
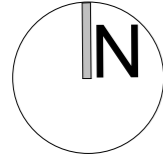
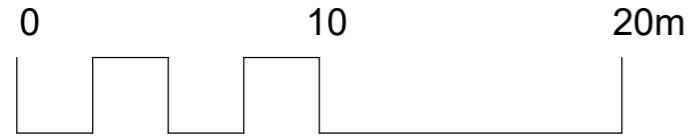

- Site boundary - planning. Site area = 949m²
- - - Overlooking distance constraints
- - - Tree Root Protection Area

NOTES
 The contractor is responsible for checking dimensions, tolerances and references.
 Verify any discrepancies with the architect before proceeding with the work.
 Where an item is covered by drawings of different scales the larger scale drawing is to be worked to.
 Construct to figured dimensions only.

Date	Rev	Revision / author/ checker
20.12.23	A	Option 2 developed following client comments. JNBP/SD
26.01.24	B	Red line revised SD
06.02.24	C	Issued for planning. JNBP/ SD

Purpose of Issue	Planning
Project	Tower Street, Barnsley
Drawing	Proposed Site Plan

Drwg. no	23-122-110	Rev	C
Drawn	JNBP	Checked	SD
Scale	1 : 250 @A3	Date	12/04/23