

EVA-07S-SE / EVA-07S-SE RFID
32amp VEHICLE CHARGING POINT

100MM DIA DUCT TO BE PROVIDED FROM HIGHWAY INTO EACH DWELLING FOR INSTALLATION OF HIGH SPEED FULL FIBRE BROADBAND. INSTALLATION OF THE ASSOCIATED CABLE/EQUIPMENT TO BE AGREED WITH PROVIDER INCLUDING TIMESCALE.

PROPOSED BOUNDARY TREATMENTS
POINTS A-B EXISTING STONE WALL AND TIMBER FENCER TO BE RETAINED
POINTS B-C FENCE TYPE A
POINTS C-D 900MM HIGH STONE WALL TO MATCH EXISTING WITH THE OPENING AND GATE TO FRONT ENTRANCES OF PLOTS 1 & 2.
POINTS D-E NO BOUNDARY TREATMENT
POINTS E-F-G WALL TYPE B
POINTS H-J EXISTING STONE WALL RETAINED AND HEIGHT INCREASED TO 1.8 WITH FENCE TYPE A ON TOP OF EXISTING WALL.
POINTS J-A THERE IS NO EXISTING BOUNDARY TREATMENT. 900MM HIGH STONE WALL TO MATCH DWELLINGS
UNLESS OTHERWISE STATED ALL BOUNDARIES BETWEEN PLOTS TO BE FENCE TYPE A.
POINTS K-L FENCE AND WALL TYPE B

METHOD STATEMENT - CONSTRUCTION OF NEW DWELLINGS AT FORMER METHODIST CHURCH, MARKET STREET/DUKE ST HOYLAND

SECTION 1 - ACCESS TO SITE FOR CONSTRUCTION TRAFFIC:

- The existing access points from Market Street and Duke Street are to be retained if necessary and will be used by construction traffic.

SECTION 2 - THE PARKING OF VEHICLES OF SITE OPERATIVES AND VISITORS

- Limited parking will be available within the curtilage of the site. Operatives and visitors will be directed to suitable 'on street' parking areas. There is a public carpark on Duke Street, opposite the site

SECTION 3 - DEMARCATION OF THE SITE/SECURITY HOARDING

- The site area will be secured by a perimeter fence to prevent unauthorised access.

SECTION 4 - DELIVERIES TO SITE & THE LOADING AND UNLOADING OF PLANT & MATERIALS

- All deliveries to site shall be guided in by a banksman wearing a Hi Vis vest to ensure safe access on to site from the highway.
- Where possible all deliveries to be unloaded within the site.
- All deliveries leaving site shall be guided out by a banksman wearing a Hi Vis vest and ensuring safe departure paying attention to members of the public and other traffic.

SECTION 5 - MEASURES TO CONTROL DUST & DIRT

- During dry periods of weather the site will be monitored for high levels of dust and, if required, will be controlled using sprinkler/hose pipe systems.
- Any mud and dirt transferred onto the road will be brushed and cleaned off daily to ensure the surrounding roads are kept as clean as possible.
- The banksman escorting vehicles out of the site will do a visual check of the road and footpath for dirt and take action if required.
- The Builder will inspect all vehicles and wash off any mud / debris to ensure they are clean & safe before driving onto the public highway.

SECTION 6 - NOISE LEVELS DURING CONSTRUCTION

- Noise from plant will be kept to a minimum by using modern well maintained plant, incorporating appropriate silences etc.
- Site operatives will be reminded of the importance of being considerate to neighbouring properties and members of the public during the course of their work, keeping noise to a minimum.

SECTION 7 - NEIGHBOURING PROPERTIES

- The site foreman will liaise with neighbouring properties to ensure a good working relationship.

SECTION 8 - STORAGE OF MATERIALS & PLANT ON SITE

- Materials will be stored on site in a safe and tidy manner
- Plant will have a designated parking area.
- Waste materials will be removed to a skip and taken off site to keep the site safe and looking tidy.

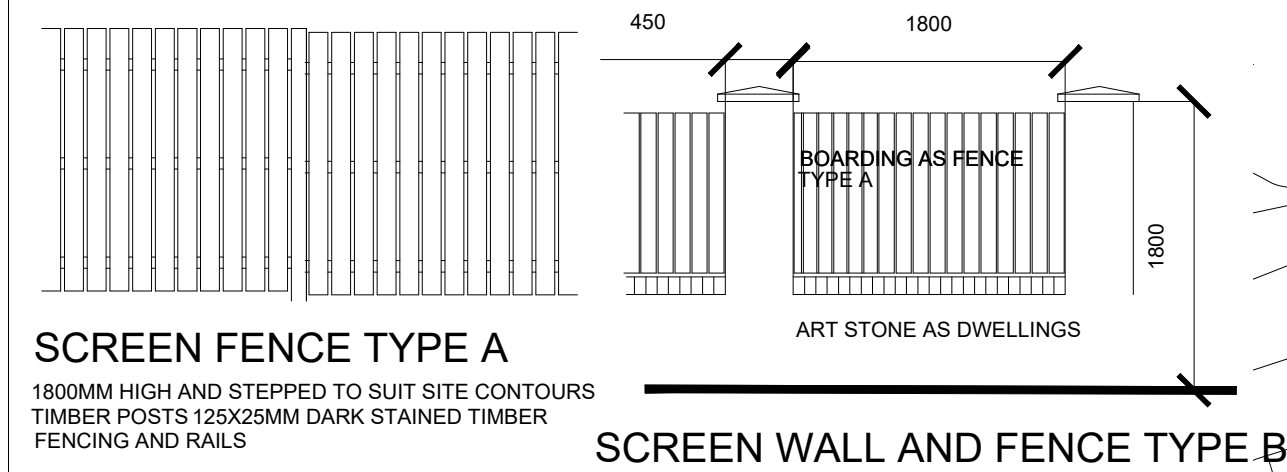

SCREEN FENCE TYPE A
1800MM HIGH AND STEPPED TO SUIT SITE CONTOURS
TIMBER POSTS 125X25MM DARK STAINED TIMBER FENCING AND RAILS

SCREEN WALL AND FENCE TYPE B

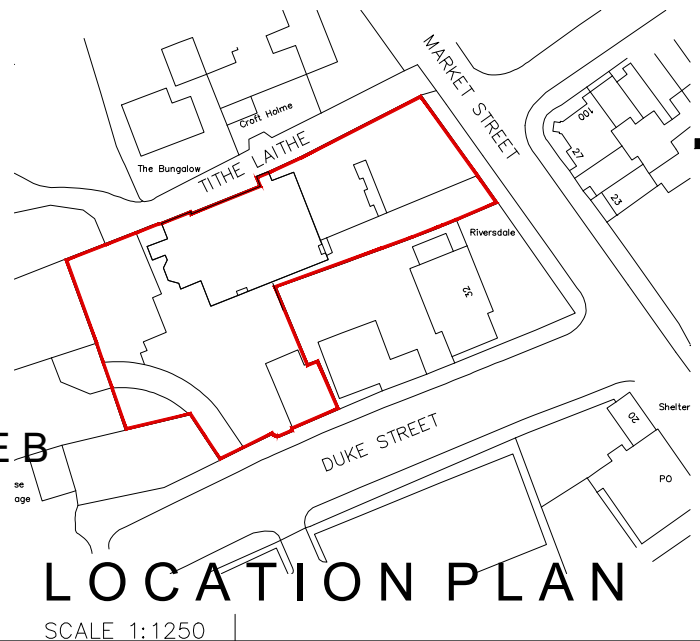

LOCATION PLAN
SCALE 1:1250

			OFFICE ONE, DRILL HALL, 11 EASTGATE, BARNSLY, S70 2EU Phone: 01226 208482 Email: info@whiteagus.co.uk Web: www.whiteagus.co.uk		
Project: RESIDENTIAL DEVELOPMENT AT MARKET STREET AND DUKE STREET HOYLAND, BARNSLY			Client: E.J. LIDSTER (BARNSLY) LTD		
Drawing Title: SITE PLAN			Date: SEPT 2024	Scale: 1:500 @ A3	
Ref: 22-173		Dwg. No. 10	Rev.		
Date	Suffix	Description	Date	Suffix	Description