

Drawing status

Drawn by	DB	Size	A1	Scale	VAR
Notes				Status	Rev Date
PRELIMINARY STUDY				P	-
AMENDMENTS:				P	A
- Well size reduced from 600mm to 500mm					
AMENDMENTS:				P	B 03/03/21
Ramp length and construction amended; modular building pushed further 200mm from the face of the existing building.					
AMENDMENTS:				P	C 08/03/21
Ramp base & annotation amended					
AMENDMENTS:				P	D 22/03/21
MRI and link dims added. Suspended ceiling dim amended.					
AMENDMENTS:				P	E 01/04/21
Link Heights amended following site visit.					
AMENDMENTS:				P	F 15/04/21
Link Heights amended. Suspended ceiling omitted.					
AMENDMENTS:				P	G 25/05/21
The link roof is now higher. Suspended ceiling has been reintroduced. ceiling height tbc on site.					

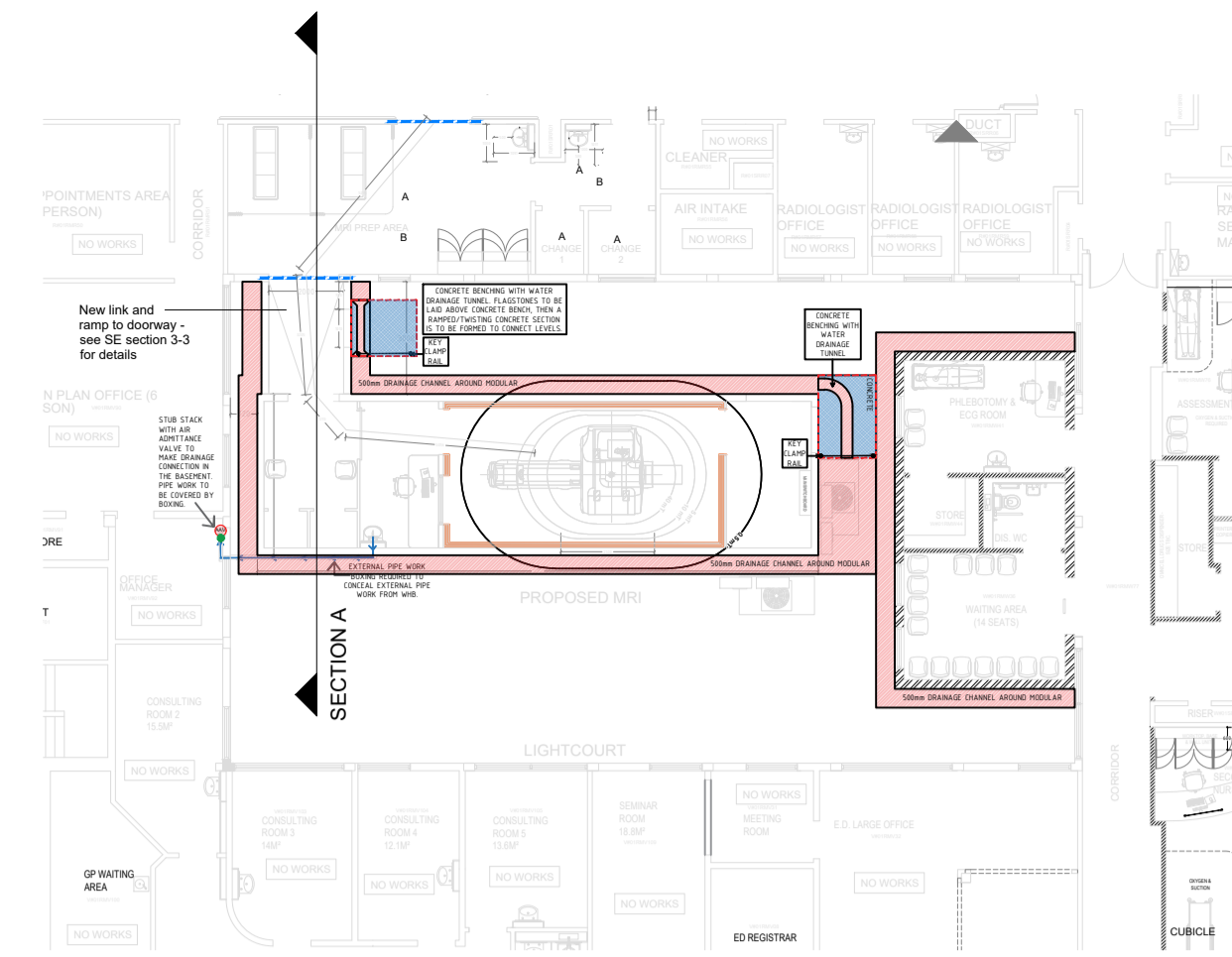

REFERENCE PLAN
1:200

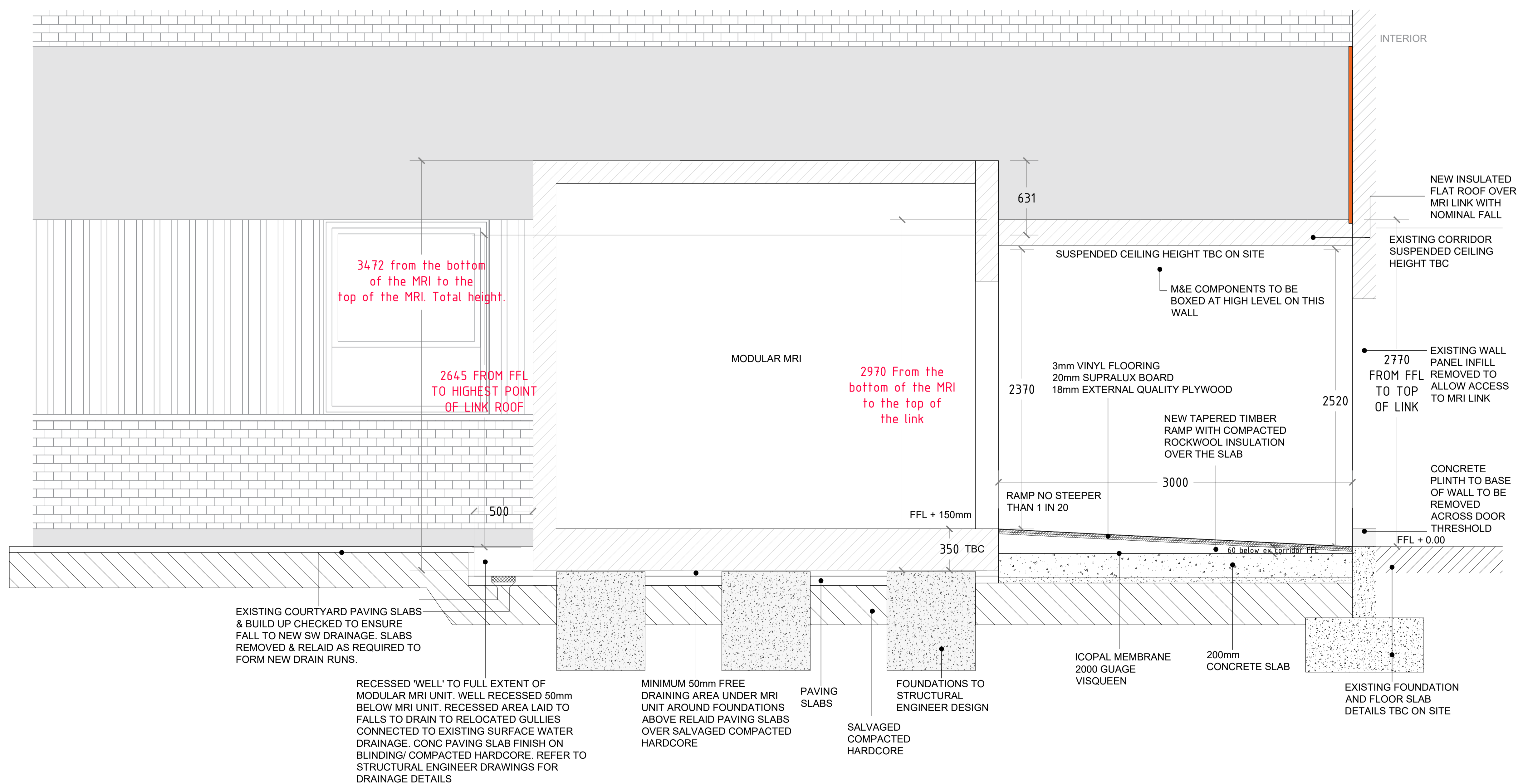

PROPOSED SECTION A
1:20

Drawing status annotation
P-Preliminary T-Tender D-Design (post preliminary) C-Construction As-Built

Client

BARNSELY HOSPITAL NHS
FOUNDATION TRUST

Project title

MODULAR MRI

Project no

170/032

Drawing title

EXISTING AND PROPOSED
COURTYARD SECTIONS

Drawing no

(0-100)02

Status Revision

P G