

LOCATION PLAN

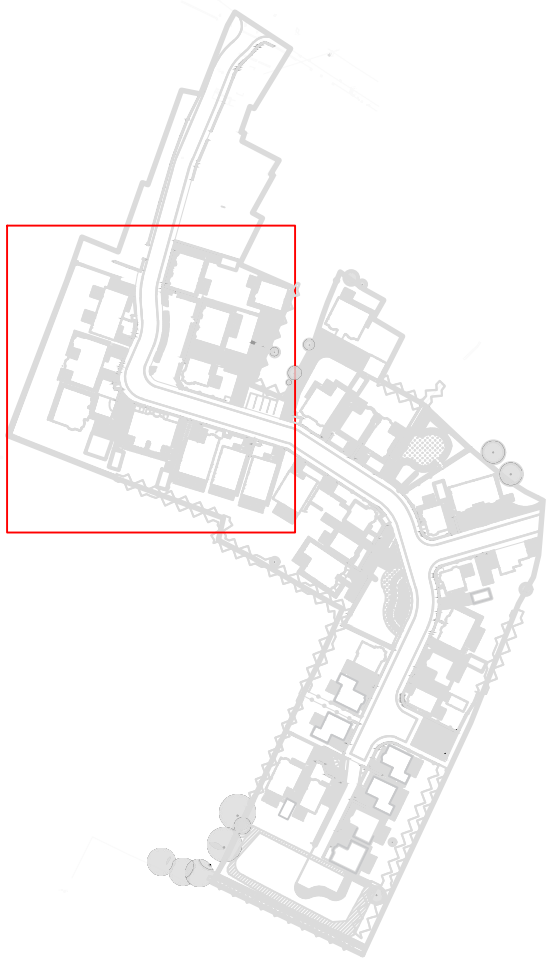

NOTES

1. All dimensions to be verified on site. Do not scale this drawing. All discrepancies to be clarified with project Landscape Architect.
2. This drawing is the property of Urban Wilderness Ltd and is issued on the condition it is not reproduced, retained or disclosed to any unauthorised person, either wholly or in part without written consent of Urban Wilderness Ltd.
3. **DRAWING FOR PLANNING**
4. Drawing to be read in conjunction with UW dwgs and specification, and all other information prepared by project design team. See below list of UW information:
 - 436-UW-P-001/002-Hardworks and Furniture Plan Sheet 1 & 2
 - 436-UW-P-004/5/6-Softworks Sheet 2 to 4.
 - 436-UW-P-007-Softworks Schedule.
5. Drawings for coordination only and subject to input from the wider design team.
6. For all drainage and associated levels, and structural matters, please refer to Project Engineers information.
7. All plants to be supplied in accordance with BS3936 generally, ie. healthy and vigorous, of good shape and without elongated growth.
8. Carry out all planting during dormant season (November to April) to ensure early establishment.
9. Listed species are subject to availability. Any replacements to be 'similar and approved'.
10. Topsoil should be a sandy loam, be clean and come from a reputable source, free from all noxious, noxious and perennial weeds and be in accordance with BS 3882 generally.

11. Topsoil depth minimum requirement: 400mm for trees, 300mm for shrubs and mixed herbaceous borders, 150mm for Amenity Lawn and 50mm for Meadow Areas.
12. Handling: In accordance with BS 3882. Keep handling of topsoil to a minimum, avoid compaction and store in heaps less than 1.5m high.
13. Apply 50mm amenity grade bark mulch to all beds following all planting operations.
14. Apply mycorrhizal inoculant to all trees and shrub planting pits.
15. Protect all trees on or adjacent to site in accordance with BS 5837: Trees in relation to design, demolition and construction, using physical barriers to prevent storage of material and construction within tree root protection areas.
16. All works within the root Protection Area (RPA) of existing trees to be undertaken in accordance with arboricultural guidance.
17. Tree Pits to be 900x900x900mm or to fully accommodate full extent of root ball - whichever is larger. Tree pits to be free draining, avoiding smeared sides and compacted base.
18. Tree Pits to include Root Rain Metro irrigation and air tube as per the manufactured recommendations (or similar and approved)
19. Where proposed service runs pass through or adjacent to (within 1m) existing tree root protection areas (RPAs), root protection barriers will be required. Exact location and extent of root protection to be agreed prior to installation.
20. Where proposed buildings are to be constructed within or adjacent to (within 1m) existing tree root Protection areas (RPAs), root protection barriers will be required. Exact location and extent of root protection to be agreed prior to installation.
21. Where proposed buildings are to be constructed adjacent to (within 6m) of proposed trees and hedges, building foundations are to be developed by engineer to avoid subsidence.

21. Where proposed buildings are to be constructed adjacent to (within 6m) of proposed trees and hedges, building foundations are to be developed by engineer to avoid subsidence.

-	First Issue	19.09.24
rev	details	date



7 Saw Mill Yard, Water Lane, Holbeck, Leeds,
LS11 5WH
www.urbanwilderness.co.uk
design@urbanwilderness.co.uk
0113 472 0030
Registered in Scotland SC371979

client
Richard Bell

project
Paddock Road

drawing title
Softworks
Sheet 1 of 4

drawing status
Planning

<i>drawn by</i>	<i>checked by</i>	<i>date</i>
RS	SF	19 Sept 24
<i>scale</i>		<i>paper size</i>
1:250		A2
<i>job/dwg no.</i>		<i>rev.</i>
436-UW-P-003		-