

ELEVATION

Slip ties and movement joints to be used on every third panel at abutment with pier to allow for differential movement. Top slip tie to be positioned directly below header course and two remaining ties to be spaced equally from top tie to ground.

For clay brick a 16mm movement joint is required with first movement joint being no more than 6m from the end of the wall.

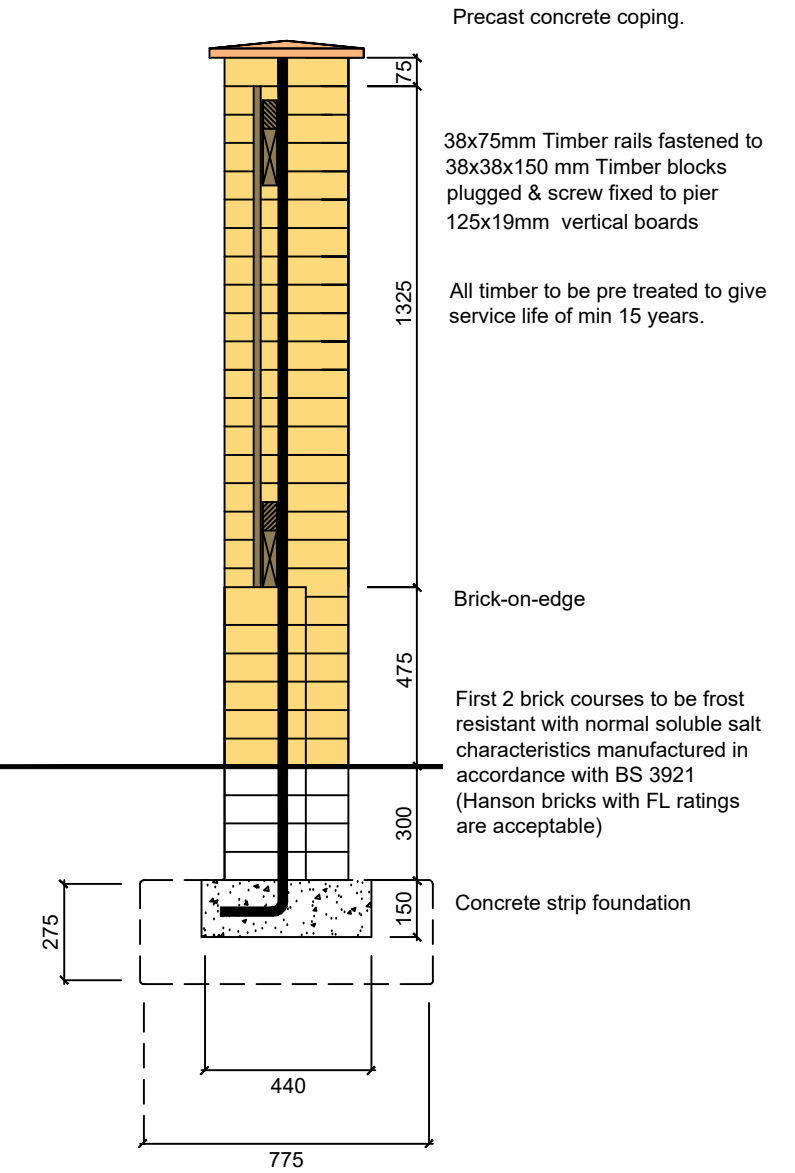
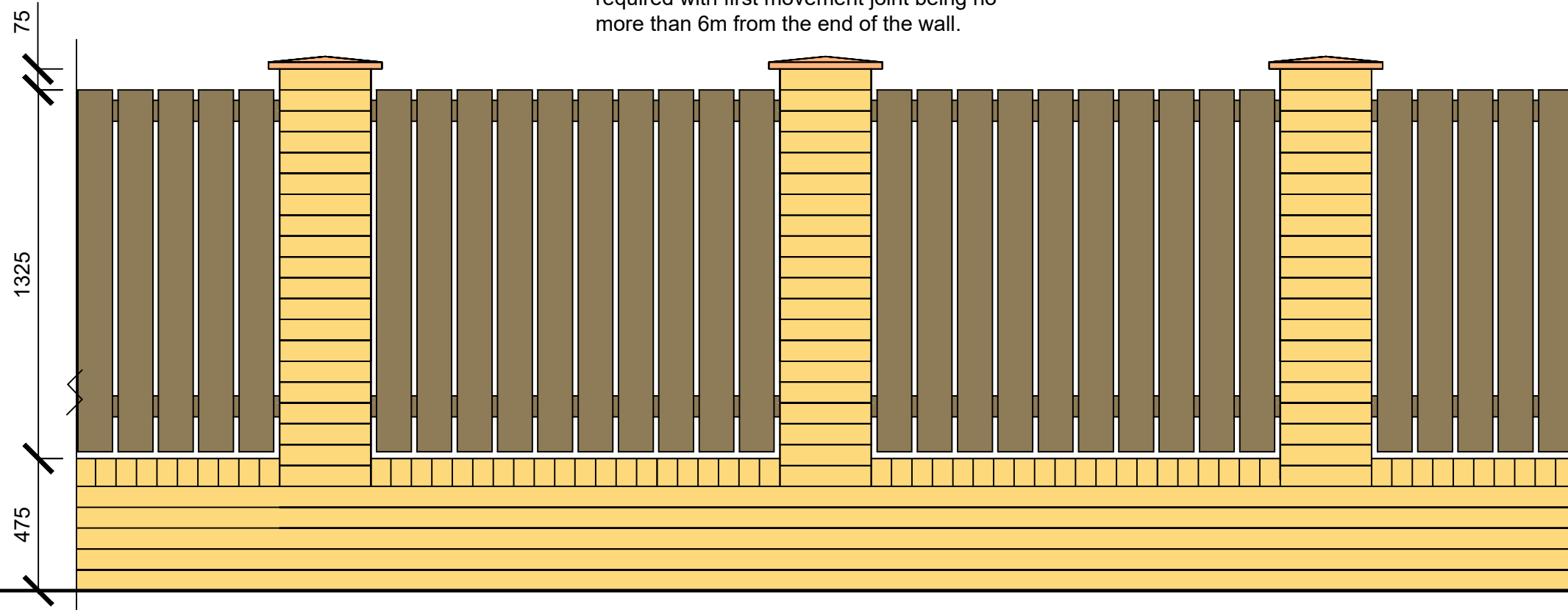

PLAN

Steel reinforcing bar to be set into foundations and run up the center of the pier to underside of coping.

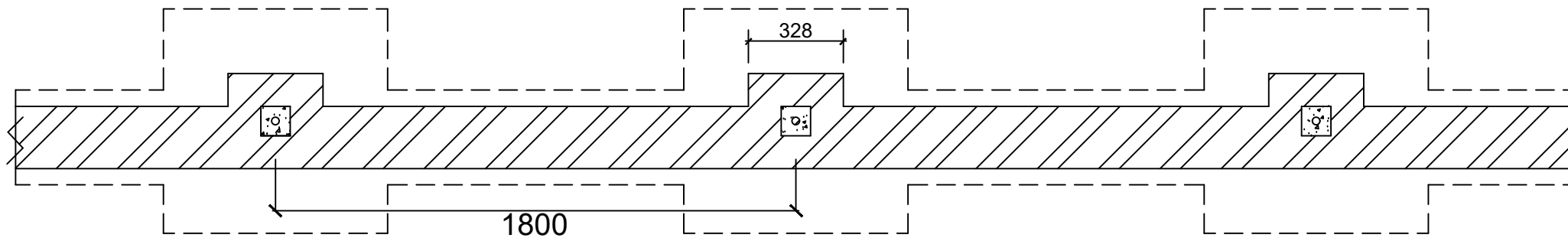

SECTION

Scaled @ 1:20

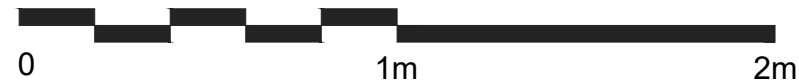

REV.	DESCRIPTION	BY:	DATE:



Suite 4, Unit 1,
Benton Office Park,
Bennett Avenue,
Horbury,
Wakefield,
WF4 5RA
Tel: 01924 669424

Web: www.sten-architecture.co.uk
Twitter: @STEN_arch
Facebook: [stenarchitectureitd](https://www.facebook.com/stenarchitectureitd)
LinkedIn: [Sten Architecture](https://www.linkedin.com/company/sten-architecture)

CLIENT:	AVANT homes		
TITLE:	Boundary treatments 1.8m Brick & timber panel fence		
SCALE AT A3:	DATE:	DRAWN:	CHECKED:
1:100	23.09.18	TW	
PROJECT NO:	DRAWING NO:	REVISION:	
1821	1821.B.02		
SITE:	Hoyland Road Barnsley		