



COAL MINING RISK ASSESSMENT

For:

PLOT B – DANCE LANE, CRANE MOOR

On behalf of:

MR P DIMBERLINE

Project Reference: 22-064

Document Reference: 22064-MCE-XX-ZZ-RP-S-1001

Status: S0 - INITIAL STATUS

Revision: P01

Date: 05/05/22



REPORT					
Project Title:	PLOT B – DANCE LANE, CRANE MOOR		Project Reference:	22-064	
Document Reference:	22064-MCE-XX-ZZ-RP-S-1001	Date:	05/05/22	Rev:	P01

REVISION RECORD

Rev	Status	Date	Originator	Checked	Approved
P01	S0 - INITIAL STATUS	05/05/22	AJH	LJH	AJH

COPYRIGHT STATEMENT

Copyright subsists in all Matrix Consulting Engineers Ltd documents. This document is to be regarded as confidential to our Client and it is intended for their use only and may not be assigned. Consequently, and in accordance with current practice, any liability to any third party in respect of the whole or any part of its contents is hereby expressly excluded. Before the document or any part of it is reproduced or referred to in any other document, circular or statement and before its contents or the contents of any part of it are disclosed orally to any third party, our written approval as to the form and context of such a publication or disclosure must be obtained.

PREPARED FOR:

Mr P Dimberline
2 Tipsey Court
Wakefield Road
Staincross
Barnsley
S75 6FZ

PREPARED BY:

Matrix Consulting Engineers
Unit 7, BBI Centre
Innovation Way
Barnsley
S75 1JL

Tel: 03330 142926
Email: info@matrixce.co.uk

REPORT					
Project Title:	PLOT B – DANCE LANE, CRANE MOOR	Project Reference:	22-064		
Document Reference:	22064-MCE-XX-ZZ-RP-S-1001	Date:	05/05/22	Rev:	P01

CONTENTS

SECTION	TITLE	PAGE
1.0	INTRODUCTION	3
2.0	THE SITE AND ITS SETTING	4
3.0	PROPOSED DEVELOPMENT	6
4.0	COAL MINING RISK ASSESSMENT	7
5.0	CONCLUSIONS AND RECOMMENDATIONS	14
	APPENDIX A – Architectural Layout	
	APPENDIX B – Coal Authority Reports	
	APPENDIX C – Borehole Records	

REPORT					
Project Title:	PLOT B – DANCE LANE, CRANE MOOR	Project Reference:	22-064		
Document Reference:	22064-MCE-XX-ZZ-RP-S-1001	Date:	05/05/22	Rev:	P01

2.0 THE SITE AND ITS SETTING

- 2.1 The site is situated due east of Thurgoland, and to the northeast of Stockbridge, see Figure 2.1, 2.2, 2.3 and 2.4. Directly to the northwest of the site is a residential development, which was constructed sometime prior to 1990, and, to the east of the site, there is a sewage treatment works, constructed at some time between 1948 and 1990.
- 2.2 Historic maps of the area, dated 1990, 1948, 1930, 1910 and 1985, indicate that the site has not had any other purposes than agricultural, over the course of this time. To the east of the site, at a distance of 250 m from the boundary, was the location of the Cliffe Bridge Colliery, which operated between 1903 and 1949, and then, at a distance of 450 m, also to the east of the site, was the location of the Vernon Silkstone Colliery, which operated between 1874 and 1892. To the northwest of the site was the location of the Sim Hill Colliery, which operated between 1862 and 1872.
- 2.3 The site information is tabularised below.

Site Information	
Site Address:	Dance Lane
	Crane Moor
	SHEFFIELD
	S35 7AW
Grid Reference	SE 30835 01348
Easting:	430835
Northing:	401348
Latitude	53.507921
Longitude	-1.5365399

REPORT					
Project Title:	PLOT B – DANCE LANE, CRANE MOOR	Project Reference:	22-064		
Document Reference:	22064-MCE-XX-ZZ-RP-S-1001	Date:	05/05/22	Rev:	P01



Figure 2.1 – Extract from OS Map

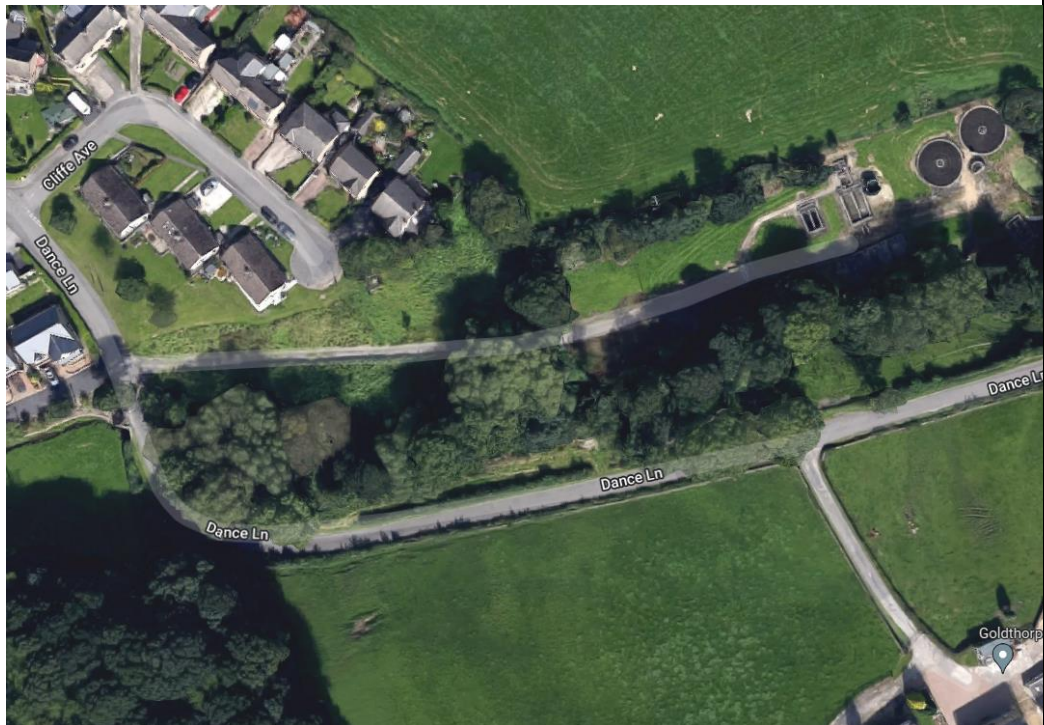

Figure 2.2 – Extract from Google Maps

REPORT					
Project Title:	PLOT B – DANCE LANE, CRANE MOOR		Project Reference:	22-064	
Document Reference:	22064-MCE-XX-ZZ-RP-S-1001	Date:	05/05/22	Rev:	P01

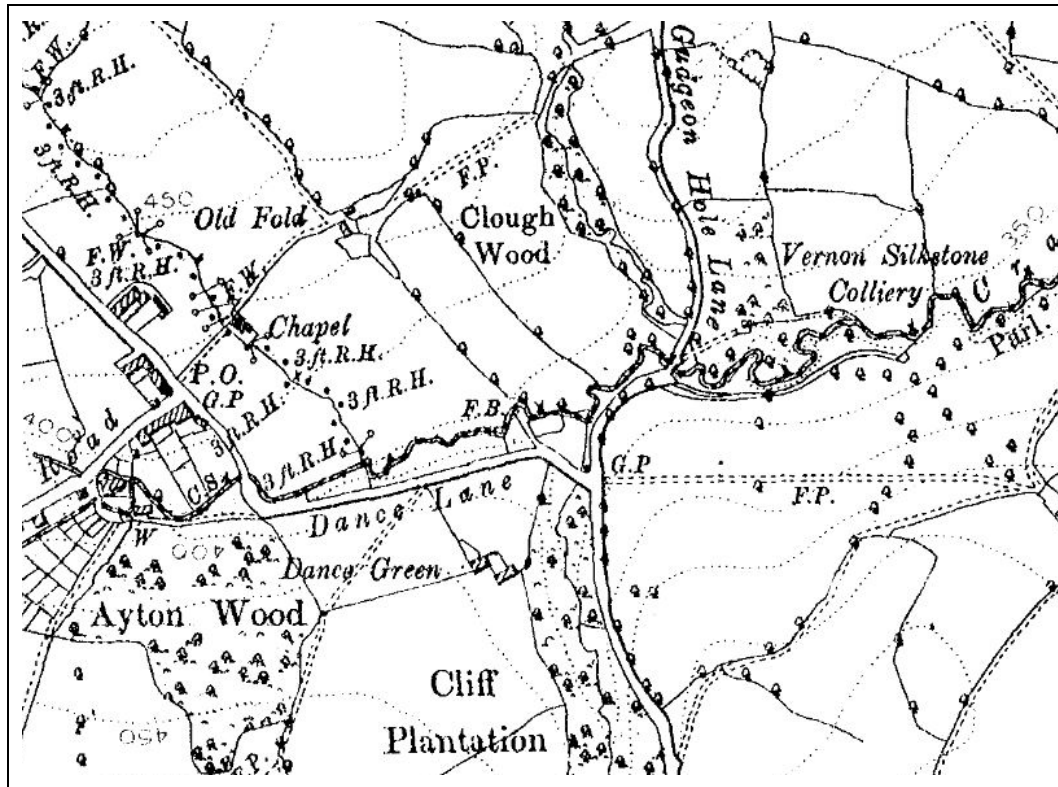

Figure 2.3 – Extract from 1895 Map

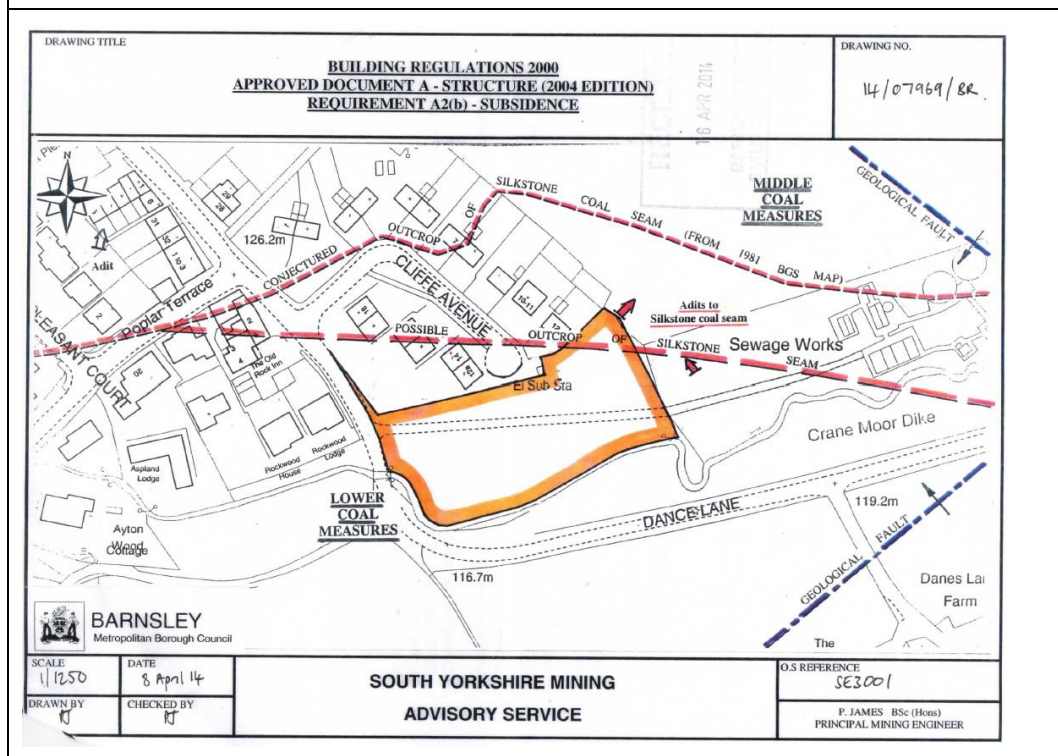

Figure 2.4 – Extract from SYMAS Report

REPORT					
Project Title:	PLOT B – DANCE LANE, CRANE MOOR	Project Reference:	22-064		
Document Reference:	22064-MCE-XX-ZZ-RP-S-1001	Date:	05/05/22	Rev:	P01

3.0 PROPOSED DEVELOPMENT

- 3.1 It is intended for the development to be comprised of a single private dwelling, together with associated external hard standings, drainage and services infrastructure.
- 3.2 No information exists on the proposed houses, but it is assumed that they will be comprised of a traditional form of low-rise construction.

REPORT					
Project Title:	PLOT B – DANCE LANE, CRANE MOOR	Project Reference:	22-064		
Document Reference:	22064-MCE-XX-ZZ-RP-S-1001	Date:	05/05/22	Rev:	P01

4.0 COAL MINING RISK ASSESSMENT

4.1 Information Sources

- i. The following assessment of coal mining risks at the proposed site is based on information on coal mining hazards identified from the following sources:
 - i. Consultants Coal Mining Report: Reference – 51003113766001 (Appendix B)
 - ii. British Geological Survey Geindex Website,
 - iii. South Yorkshire Mining Advisory Service Report (Figure 2.4).
 - iv. The Coal Authority Interactive Map.

4.2 Geology

1. The site is underlain by the Pennine Middle Coal Measures Formation, which are comprised of Mudstone, Siltstone and Sandstone, which are sedimentary bedrocks formed approximately 310 to 318 million years ago, in the Carboniferous Period. This would suggest that the local environment was, therefore, previously dominated by swamps, estuaries and deltas.

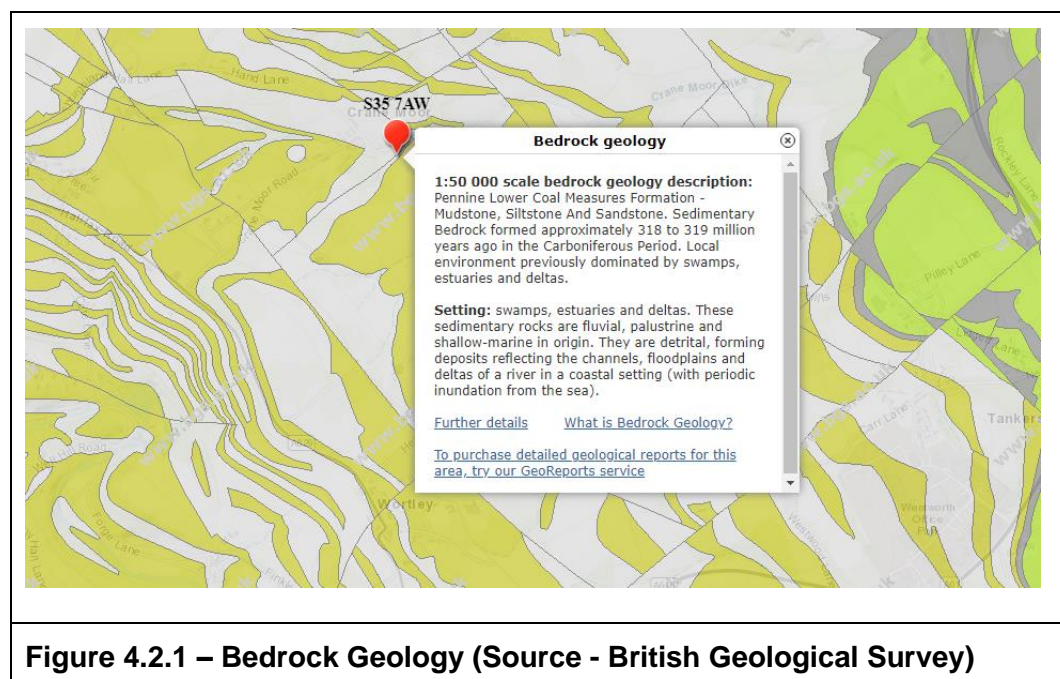

Figure 4.2.1 – Bedrock Geology (Source - British Geological Survey)

REPORT					
Project Title:	PLOT B – DANCE LANE, CRANE MOOR	Project Reference:	22-064		
Document Reference:	22064-MCE-XX-ZZ-RP-S-1001	Date:	05/05/22	Rev:	P01

- There are no records of the superficial deposits covering the site recorded on the geological maps (See Figure 4.2.2.a), which would suggest that the superficial deposits are relatively shallow and, therefore, the rockhead is at a relatively high level. There are no boreholes close to the site, however, which could confirm this, as the one due east was sunk with the coal workings, starting at a depth of 397 ft below ground level (See Figure 4.2.2.b)

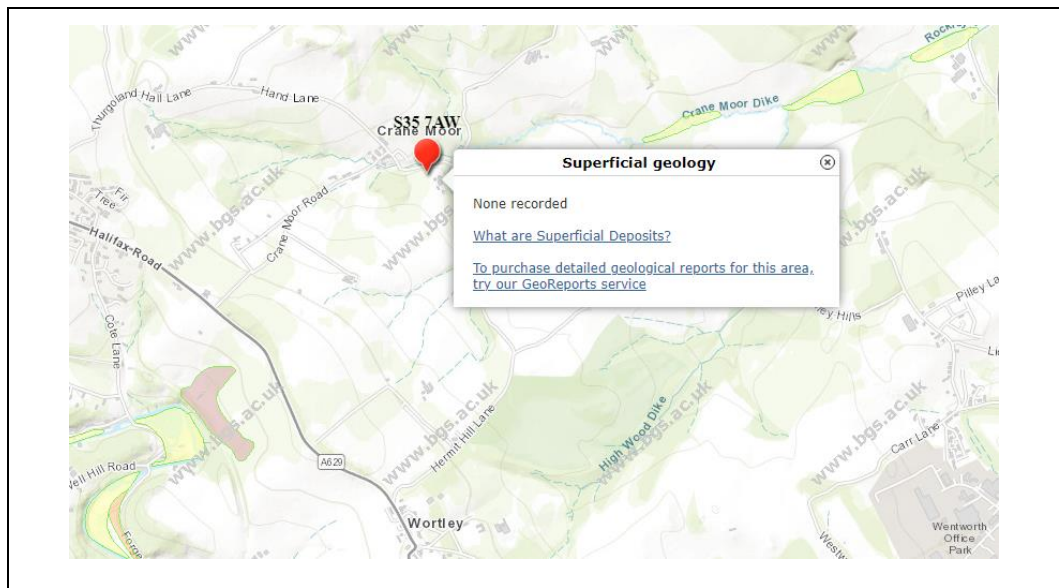

Figure 4.2.2.a – Superficial Deposits (Source - British Geological Survey)

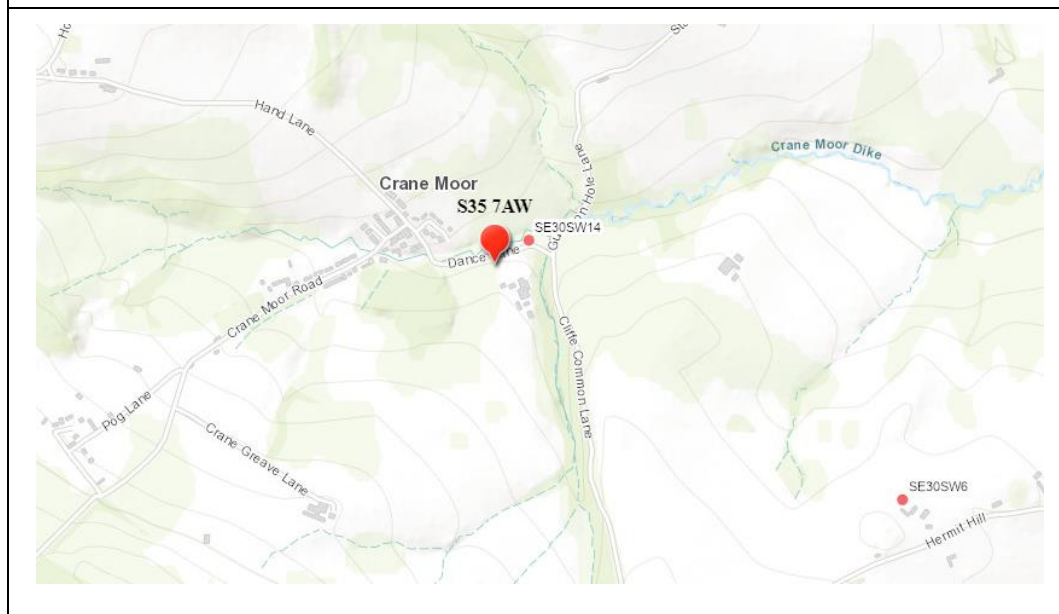

Figure 4.2.2.b – Location of Borehole records

REPORT					
Project Title:	PLOT B – DANCE LANE, CRANE MOOR	Project Reference:	22-064		
Document Reference:	22064-MCE-XX-ZZ-RP-S-1001	Date:	05/05/22	Rev:	P01

4.3 Mine Entries

1. The area has been extensively mined, as can be seen from Figure 4.3.a, with numerous entries to the north, east and west of the site.
2. Two mine entries are, however, known to exist close to or actually on the site. These were adits, which are horizontal passages through which access can be gained into mine workings, that were probably associated with the original Cliffe Bridge Colliery.
3. The Coal Authority Report provides accurate location information for these features as bellow, but provides no information as to the manner in which they have been treated.:

Entry Type	Reference	Grid Reference
Adit 1	430401-019	430738 401472
Adit 2	430401-031	430767 401453

Table 4.3 – Mine Entries

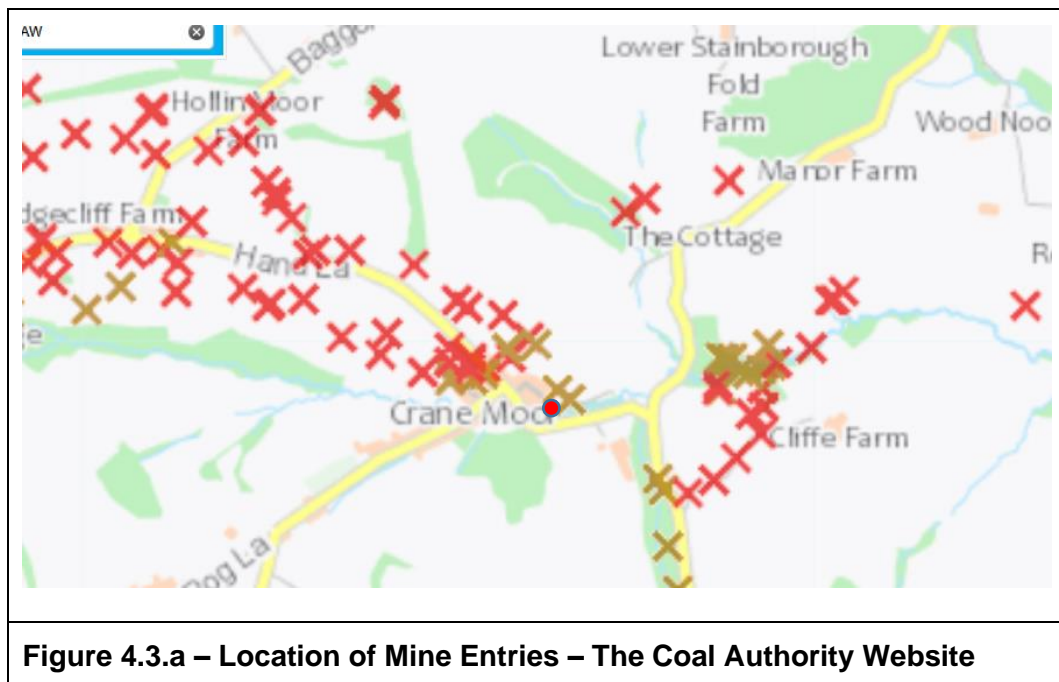

REPORT					
Project Title:	PLOT B – DANCE LANE, CRANE MOOR	Project Reference:	22-064		
Document Reference:	22064-MCE-XX-ZZ-RP-S-1001	Date:	05/05/22	Rev:	P01

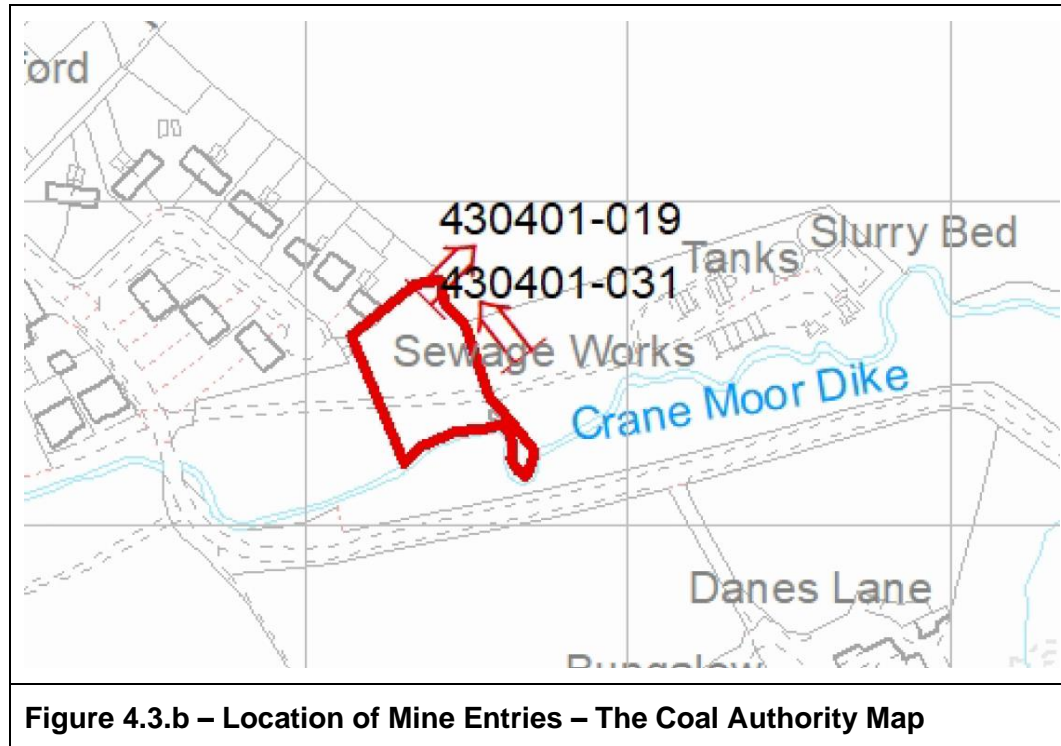

Figure 4.3.b – Location of Mine Entries – The Coal Authority Map

4.4 Shallow Mine Workings

1. This relates to coal workings that exist at or within 30 metres of the ground surface.
2. The findings of the Coal Authority Report and Interactive Map differ to that of the SYMAS report on the matter of coal outcropping. The former both suggest that there is no coal outcropping on the site, whereas the latter indicates that the Silkstone Coal Seam outcrops across the northeast corner (Compare Figure 2.4 and Figures 4.4.1, 2 and 3). If the findings of the SYMAS report is correct, then there is a risk that this seam could have been worked, from this outcropping, by shallow mine working techniques on the site.

REPORT					
Project Title:	PLOT B – DANCE LANE, CRANE MOOR	Project Reference:	22-064		
Document Reference:	22064-MCE-XX-ZZ-RP-S-1001	Date:	05/05/22	Rev:	P01



Figure 4.4.1 – Extent of Actual Shallow Mine Workings (TCA Map)



Figure 4.4.2 – Extent of Probable Shallow Mine Workings (TCA Map)

REPORT					
Project Title:	PLOT B – DANCE LANE, CRANE MOOR	Project Reference:	22-064		
Document Reference:	22064-MCE-XX-ZZ-RP-S-1001	Date:	05/05/22	Rev:	P01

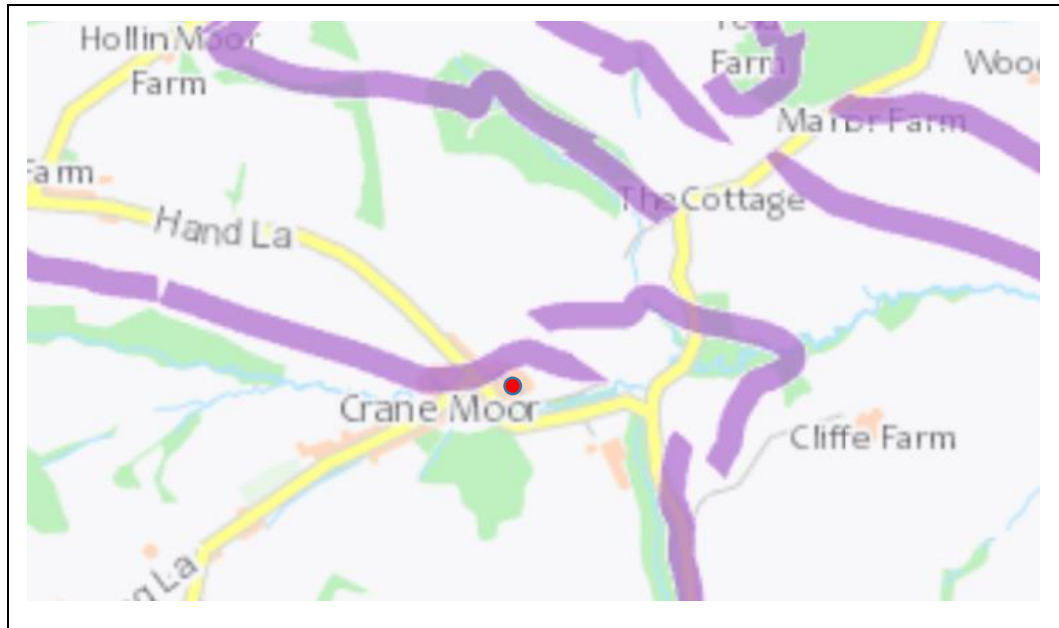

Figure 4.4.3 – Location of Inferred and Actual Coal Outcrops

4.5 Deep Coal Mine Workings

1. The Coal Authority have no records of any deep coal mining affecting the site.

4.6 Opencast Sites - Surface Mining Workings

1. Open cast mine workings have been recorded, at a distance of between 150 and 200 m of the north, east and west of the site (See Figure 4.6).
2. No licenses have been issued by the Coal Authority, either within, or within 200 metres, of the enquiry boundary in relation to the undertaking of surface coal mining, underground coal mining or underground coal gasification.

REPORT					
Project Title:	PLOT B – DANCE LANE, CRANE MOOR	Project Reference:	22-064		
Document Reference:	22064-MCE-XX-ZZ-RP-S-1001	Date:	05/05/22	Rev:	P01

2. The Coal Authority has not received a damage notice for any buildings within 50m of the site since 31st October 1994.
3. The Coal Authority is not aware of any request having been made to carry out preventative works, before coal is worked, under Section 33 of the Coal Mining Subsidence Act 1991.

4.10 Mine Gas

1. The Coal Authority has no record of a mine gas emission requiring action within 500m of the site.

4.11 Future Coal Recovery

1. There are no records of any planned underground mining relative to the enquiry boundary.
2. The site is not in an area where a license has been granted to remove coal using underground or opencast methods within 200m of the site. Consequently, the site is not likely to be affected by future mining activity, though reserves of coal exist in the local area which could be worked at some time in the future.
3. There are no court orders affecting the site in respect of the working of coal under the Mines (Working Facilities and Support) Acts of 1923 and 1966 or any statutory modification or amendment thereof.
4. No notices have been given, under section 46 of the Coal Mining Subsidence Act 1991, stating that the land is at risk of subsidence.
5. The site is not within an area where notices to withdraw support have been given, nor is it in an area where a notice has been given under section 41 of the Coal Industry Act 1994, cancelling the entitlement to withdraw support.
6. With respect to the payments to owners of former copyhold land, the site is not in an area where a relevant notice has been published under the Coal Industry Act 1975/Coal Industry Act 1994.

REPORT					
Project Title:	PLOT B – DANCE LANE, CRANE MOOR	Project Reference:	22-064		
Document Reference:	22064-MCE-XX-ZZ-RP-S-1001	Date:	05/05/22	Rev:	P01

5.0 CONCLUSIONS AND RECOMMENDATIONS

- 5.1 The site is located in an area where extensive mine workings have taken place over a protracted period of time. Some of these workings will be recorded and others will not. It is, therefore, recommended that technical advice relating to both the investigation of coal and former coal mines, and their treatment, should be obtained before beginning work on site. All proposals should apply good engineering practice developed for mining areas.
- 5.2 With respect to deep and open cast mining, there are no records of any such activity in the area that will affect the site, nor does the Coal Authority appear to have granted any licenses, nor have plans for any mining activity that will affect the site.
- 5.3 Given that the likely depth of superficial deposits on the site, the proposed development is not considered to be within the zone of influence of any mine entries that are remote from the site boundary.
- 5.4 The precise locations of the 2No adits which are reported to exist close to, or on the site, should be established, by means of the setting out information provided by the Coal authority, to determine whether they will affect the development. Should it prove that they are close enough to affect the development, then further Engineering advice should be sought on this matter.
- 5.5 From a review of the desk-based information, it has not, however, been possible to discount the risks posed to the new development by the shallow mine workings, due to the possible presence of unrecorded worked seams within 30m of the surface, primarily associated with the Silkstone Coal Seam, which has a total extraction depth in the order of 1.2m
- 5.6 Given this, we would make the following recommendations for intrusive investigation works, in accordance with the guidance provided in CIRIA Special Publication 32, *Construction Over Abandoned Mine Workings*, though the exact scope of the investigation should be established by means of a detailed Phase 1 Desk Top Study:

REPORT					
Project Title:	PLOT B – DANCE LANE, CRANE MOOR	Project Reference:	22-064		
Document Reference:	22064-MCE-XX-ZZ-RP-S-1001	Date:	05/05/22	Rev:	P01

- i A group of 3No investigatory boreholes should be undertaken at the location of the proposed building. These should extend to a depth of 12 m below bedrock level, as this will establish whether 10 times the seam thickness of rock cover exist over the thickest conjectured seam, which is the 1.2 m thick, Silkstone Coal seam. Given a 15° Angle of Draw, this group should extend 4m beyond the extremities of any new building, where possible.
 - ii During these investigations, tests should be undertaken and records kept relating to: the nature and depth of the superficial deposits, the depth of any rock head, the nature and thickness of rock cover to any coal seams, the thickness of any coal seams and any evidence that the coal seams have been worked, such as broken ground or voids.
- 5.7 Should it be established that no worked coal seams or worked coal seams with a rock cover in excess of ten times the seam thickness, exist beneath the site, then no further action is required.
- 5.8 Should it be established that worked coal seams exist beneath the site, with rock cover less than ten times the seam thickness, then, dependent on the nature and depth of the workings, measures should be adopted to ensure that the buildings will not be damaged by the effects of shallow mine workings. These include:
- i. Adopting conventional foundations in conjunction with remedial ground measures, to consolidate the mine workings, such as:
 - a. For very shallow seams, bulk excavation and backfilling of the workings.
 - b. Partial grouting, to either improve bearing characteristics of specific areas on site or to reduce the risk of void migration.
 - c. Full grouting of the mine workings, and possibly overlying strata, to improve overall ground-bearing characteristics.
 - ii. Adopt foundations which incorporate additional design measures to accommodate or avoid problems from associated ground movements, such as stiff rafts or piled foundations, which extend through the workings and into competent strata beneath.

REPORT					
Project Title:	PLOT B – DANCE LANE, CRANE MOOR	Project Reference:	22-064		
Document Reference:	22064-MCE-XX-ZZ-RP-S-1001	Date:	05/05/22	Rev:	P01

APPENDIX A – ARCHITECTURAL LAYOUT

REPORT

Project Title:	PLOT B – DANCE LANE, CRANE MOOR	Project Reference:	22-064
Document Reference:	22064-MCE-XX-ZZ-RP-S-1001	Date:	05/05/22
		Rev:	P01

This plan has been prepared by the author in accordance with the provisions of the Planning (Listed Buildings and Conservation Areas) Act 1967 and the Planning (Listed Buildings and Conservation Areas) Regulations 2009. It is intended to be used in conjunction with the accompanying text and drawings. The author accepts no liability for any errors or omissions in this document. The author is not responsible for any loss or damage, whether direct or indirect, arising from the use of this document. The author is not responsible for any loss or damage, whether direct or indirect, arising from the use of this document.

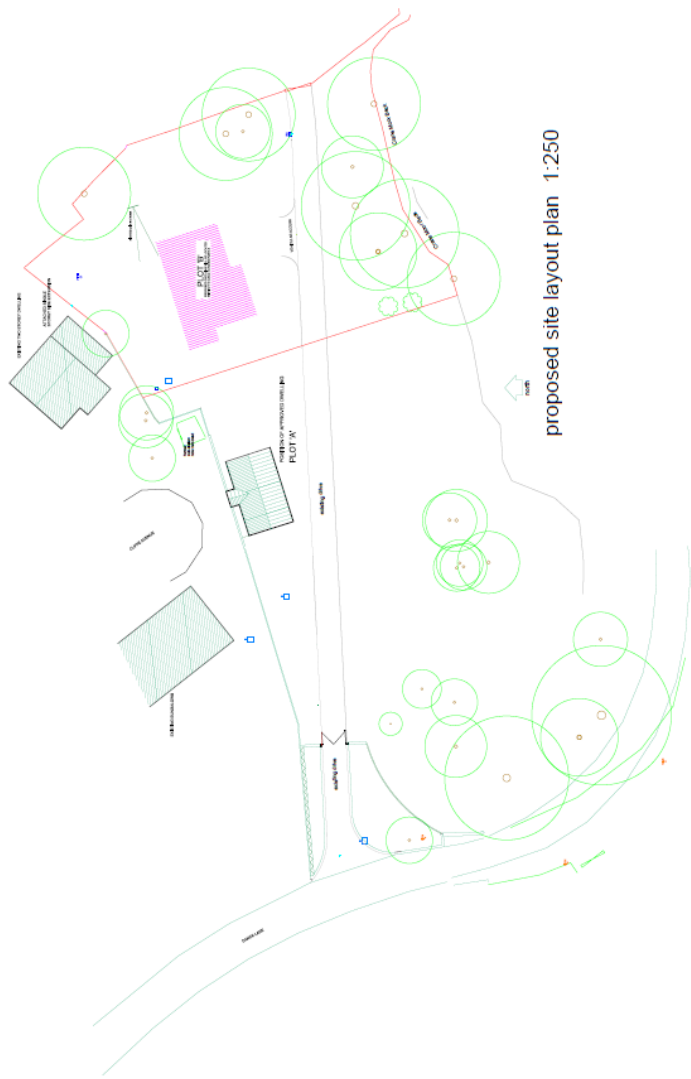

PETER DIMBERLINE Chartered Architect	
2 TIPSEY COURT, STAINCROSS BARNLEY, S75 6FZ	
tel/fax: 01228 380847	email: peter@pdmce.co.uk
char: PDCA	
project: Proposed residential development	
location: sites off Dance Lane, Crane Moor, Barnsley	
subject: Proposed site layout	
scale: 1:250	sheet: P01 of 21
date: 2021/08/03	author: PD

REPORT					
Project Title:	PLOT B – DANCE LANE, CRANE MOOR	Project Reference:	22-064		
Document Reference:	22064-MCE-XX-ZZ-RP-S-1001	Date:	05/05/22	Rev:	P01

APPENDIX B – COAL AUTHORITY REPORTS

Consultants Coal Mining Report



The Coal
Authority

Consultants Coal Mining Report

Caravan
Dance Lane Farm
Dance Lane
Crane Moor
Barnsley
S35 7AW

Date of enquiry: 5 May 2022
Date enquiry received: 5 May 2022
Issue date: 5 May 2022

Our reference: 51003113766001
Your reference: 22-064

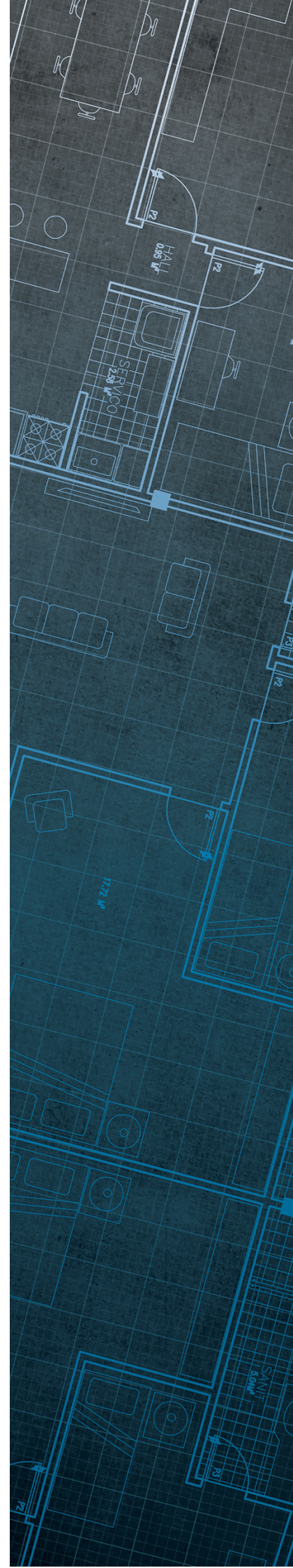

Consultants Coal Mining Report

This report is based on and limited to the records held by the Coal Authority at the time the report was produced.

Client name

Andrew Hoyland

Enquiry address

Caravan
Dance Lane Farm
Dance Lane
Crane Moor
Barnsley
S35 7AW

How to contact us

0345 762 6848 (UK)
+44 (0)1623 637 000 (International)

200 Lichfield Lane
Mansfield
Nottinghamshire
NG18 4RG

www.groundstability.com

 @coalauthority

 /company/the-coal-authority

 /thecoalauthority

 /thecoalauthority

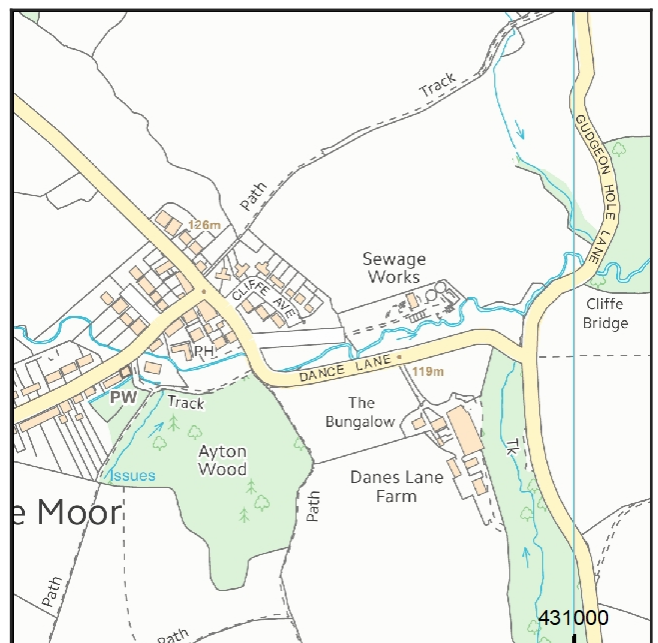

Approximate position of property



Reproduced by permission of Ordnance Survey on behalf of HMSO. © Crown copyright and database right 2018. All rights reserved.

Ordnance Survey Licence number: 100020315

Section 1 – Mining activity and geology

Past underground mining

No past mining recorded.

Probable unrecorded shallow workings

None.

Spine roadways at shallow depth

No spine roadway recorded at shallow depth.

Mine entries

Entry type	Reference	Grid reference	Treatment description	Mineral	Conveyancing details
Adit	430401-019	430738 401472		Coal	
Adit	430401-031	430767 401453		Coal	

Abandoned mine plan catalogue numbers

The following abandoned mine plan catalogue numbers intersect with some, or all, of the enquiry boundary:

5147	SY118	SY130
NE452	OC260	SY128
SY102	NE612	SY95

Our records show we have more plans than those shown above which could affect the enquiry boundary.

Please contact us on 0345 762 6848 to determine the exact abandoned mine plans you require based on your needs.

Outcrops

No outcrops recorded.

Geological faults, fissures and breaklines

No faults, fissures or breaklines recorded.

Opencast mines

Please refer to the “Summary of findings” map (on separate sheet) for details of any opencast areas within 500 metres of the enquiry boundary.

Coal Authority managed tips

None recorded within 500 metres of the enquiry boundary.

Section 2 – Investigative or remedial activity

Please refer to the 'Summary of findings' map (on separate sheet) for details of any activity within the area of the site boundary.

Site investigations

None recorded within 50 metres of the enquiry boundary.

Remediated sites

None recorded within 50 metres of the enquiry boundary.

Coal mining subsidence

The Coal Authority has not received a damage notice or claim for the subject property, or any property within 50 metres of the enquiry boundary, since 31 October 1994.

There is no current Stop Notice delaying the start of remedial works or repairs to the property.

The Coal Authority is not aware of any request having been made to carry out preventive works before coal is worked under section 33 of the Coal Mining Subsidence Act 1991.

Mine gas

None recorded within 500 metres of the enquiry boundary.

Mine water treatment schemes

None recorded within 500 metres of the enquiry boundary.

Section 3 – Licensing and future mining activity

Future underground mining

None recorded.

Coal mining licensing

None recorded within 200 metres of the enquiry boundary.

Court orders

None recorded.

Section 46 notices

No notices have been given, under section 46 of the Coal Mining Subsidence Act 1991, stating that the land is at risk of subsidence.

Withdrawal of support notices

The property is not in an area where a notice to withdraw support has been given.

The property is not in an area where a notice has been given under section 41 of the Coal Industry Act 1994, cancelling the entitlement to withdraw support.

Payments to owners of former copyhold land

The property is not in an area where a relevant notice has been published under the Coal Industry Act 1975/Coal Industry Act 1994.

Section 4 – Further information

Based on the responses in this report, no further information has been highlighted.

Section 5 – Data definitions

The datasets used in this report have limitations and assumptions within their results. For more guidance on the data and the results specific to the enquiry boundary, please **call us on 0345 762 6848** or **email us at groundstability@coal.gov.uk**.

Past underground coal mining

Details of all recorded underground mining relative to the enquiry boundary. Only past underground workings where the enquiry boundary is within 0.7 times the depth of the workings (zone of likely physical influence) allowing for seam inclination, will be included.

Probable unrecorded shallow workings

Areas where the Coal Authority believes there to be unrecorded coal workings that exist at or close to the surface (less than 30 metres deep).

Spine roadways at shallow depth

Connecting roadways either, working to working, or, surface to working, both in-seam and cross measures that exist at or close to the surface (less than 30 metres deep), either within or within 10 metres of the enquiry boundary.

Mine entries

Details of any shaft or adit either within, or within 100 metres of the enquiry boundary including approximate location, brief treatment details where known, the mineral worked from the mine entry and conveyance details where the mine entry has previously been sold by the Authority or its predecessors British Coal or the National Coal Board.

Abandoned mine plan catalogue numbers

Plan numbers extracted from the abandoned mines catalogue containing details of coal and other mineral abandonment plans deposited via the Mines Inspectorate in accordance with the Coal Mines Regulation Act and Metalliferous Mines Regulation Act 1872. A maximum of 9 plan extents that intersect with the enquiry boundary will be included. This does not infer that the workings and/or mine entries shown on the abandonment plan will be relevant to the site/property boundary.

Outcrops

Details of seam outcrops will be included where the enquiry boundary intersects with a conjectured or actual seam outcrop location (derived by either the British Geological Survey or the Coal Authority) or intersects with a defined 50 metres buffer on the coal (dip) side of the outcrop. An indication of whether the Coal Authority believes the seam to be of sufficient thickness and/or quality to have been worked will also be included.

Geological faults, fissures and breaklines

Geological disturbances or fractures in the bedrock. Surface fault lines (British Geological Survey derived data) and fissures and breaklines (Coal Authority derived data) intersecting with the enquiry boundary will be included. In some circumstances faults, fissures or breaklines have been known to contribute to surface subsidence damage as a consequence of underground coal mining.

Opencast mines

Opencast coal sites from which coal has been removed in the past by opencast (surface) methods and where the enquiry boundary is within 500 metres of either the licence area, site boundary, excavation area (high wall) or coaling area.

Coal Authority managed tips

Locations of disused colliery tip sites owned and managed by the Coal Authority, located within 500 metres of the enquiry boundary.

Site investigations

Details of site investigations within 50 metres of the enquiry boundary where the Coal Authority has received information relating to coal mining risk investigation and/or remediation by third parties.

Remediated sites

Sites where the Coal Authority has undertaken remedial works either within or within 50 metres of the enquiry boundary following report of a hazard relating to coal mining under the Coal Authority's Emergency Surface Hazard Call Out procedures.

Coal mining subsidence

Details of alleged coal mining subsidence claims made since 31 October 1994 either within or within 50 metres of the enquiry boundary. Where the claim relates to the enquiry boundary confirmation of whether the claim was accepted, rejected or whether liability is still being determined will be given. Where the claim has been discharged, whether this was by repair, payment of compensation or a combination of both, the value of the claim, where known, will also be given.

Details of any current 'Stop Notice' deferring remedial works or repairs affecting the property/site, and if so the date of the notice.

Details of any request made to execute preventative works before coal is worked under section 33 of the Coal Mining Subsidence Act 1991. If yes, whether any person withheld consent or failed to comply with any request to execute preventative works.

Mine gas

Reports of alleged mine gas emissions received by the Coal Authority, either within or within 500 metres of the enquiry boundary that subsequently required investigation and action by the Coal Authority to mitigate the effects of the mine gas emission.

Mine water treatment schemes

Locations where the Coal Authority has constructed or operates assets that remove pollutants from mine water prior to the treated mine water being discharged into the receiving water body.

These schemes are part of the UK's strategy to meet the requirements of the Water Framework Directive. Schemes fall into 2 basic categories: Remedial – mitigating the impact of existing pollution or Preventative – preventing a future pollution incident.

Mine water treatment schemes generally consist of one or more primary settlement lagoons and one or more reed beds for secondary treatment. A small number are more specialised process treatment plants.

Future underground mining

Details of all planned underground mining relative to the enquiry boundary. Only those future workings where the enquiry boundary is within 0.7 times the depth of the workings (zone of likely physical influence) allowing for seam inclination will be included.

Coal mining licensing

Details of all licenses issued by the Coal Authority either within or within 200 metres of the enquiry boundary in relation to the under taking of surface coal mining, underground coal mining or underground coal gasification.

Court orders

Orders in respect of the working of coal under the Mines (Working Facilities and Support) Acts of 1923 and 1966 or any statutory modification or amendment thereof.

Section 46 notices

Notice of proposals relating to underground coal mining operations that have been given under section 46 of the Coal Mining Subsidence Act 1991.

Withdrawal of support notices

Published notices of entitlement to withdraw support and the date of the notice. Details of any revocation notice withdrawing the entitlement to withdraw support given under Section 41 of the Coal Industry Act 1994.

Payment to owners of former copyhold land

Relevant notices which may affect the property and any subsequent notice of retained interests in coal and coal mines, acceptance or rejection notices and whether any compensation has been paid to a claimant.