

GROUND SUPPORT SERVICES (UK) LTD
GEOTECHNICAL AND GROUND SUPPORT FOUNDATION SPECIALISTS

Unit D2B Bryans Close, Harworth Industrial Estate, Harworth, South Yorkshire, DN11 8RY
 Phone: 01302 744 322 Email: thomas@groundsupportservices.net

Site Investigation Drillers log			Site: Darton lane Mapplewell			Sheet: 1 of 2				
Rig: Soilmecc 400			Crew: G Pilkington J Frugget			Date: 20-7-18				
Hours on site:					Travelling Time:					
Equipment used:										
BH	Depth	Strata Description	BH	Depth	Strata Description					
	move rig	to Darton lane		Mapplewell						
1	0-00-0-10	Soil		11-80-15-00	Sandstone grey					
	0-10-0-40	made ground								
	0-40-2-60	mudstone brown	4	0-00-0-10	Soil					
	2-60-5-70	Sandstone brown		0-10-0-30	made ground					
	5-70-11-20	mudstone grey		0-30-2-50	mudstone brown					
	11-20-14-10	Sandstone grey		2-50-5-80	Sandstone brown					
	14-10-30-00	mudstone grey with silty bands		5-90-11-20	mudstone grey					
				11-20-14-40	Sandstone grey					
				14-40-15-00	mudstone grey					
2	0-00-0-10	Soil								
	0-10-0-30	made ground	5	0-00-0-10	Soil					
	0-30-2-50	mudstone brown		0-10-0-30	made ground					
	2-50-5-90	Sandstone brown		0-30-2-40	mudstone brown					
	5-90-11-30	mudstone grey		2-40-5-70	Sandstone brown					
	11-30-14-40	Sandstone grey		5-70-11-20	mudstone grey					
	14-40-15-00	mudstone grey		11-20-14-30	Sandstone grey					
				14-30-15-00	mudstone grey					
3	0-00-0-10	Soil								
	0-10-0-40	made ground								
	0-40-2-90	mudstone brown								
	2-90-6-30	Sandstone brown								
	6-30-11-80	mudstone grey								
Casing / Water level details										
BH	Casing Die	Depth	Strike	Water Rise	Sealed	Totals	BH's	Drill	Case	Core
						Today				
						Previous				
						To date				

Signed:  Driller

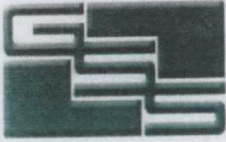

GROUND SUPPORT SERVICES (UK) LTD
 GEOTECHNICAL AND GROUND SUPPORT FOUNDATION SPECIALISTS

Unit D2B Bryans Close, Harworth Industrial Estate, Harworth, South Yorkshire, DN11 8RY
 Phone: 01302 744 322 Email: thomas@groundsupportservices.net

Site Investigation Drillers log			Site: <i>Darton lane Mapplewell</i>			Sheet: <i>2 of 2</i>				
Rig: <i>Soilmec 600</i>			Crew: <i>G Pilkington J Frasset</i>			Date: <i>20-7-18</i>				
Hours on site:					Travelling Time:					
Equipment used:										
BH	Depth	Strata Description	BH	Depth	Strata Description					
<i>6</i>	<i>0.00 - 0.10</i>	<i>Soil</i>								
	<i>0.10 - 2.30</i>	<i>mudstone brown</i>								
	<i>2.30 - 5.50</i>	<i>Sandstone brown</i>								
	<i>5.50 - 10.80</i>	<i>mudstone grey</i>								
	<i>10.80 - 14.00</i>	<i>Sandstone grey</i>								
	<i>14.00 - 15.00</i>	<i>mudstone grey</i>								
<i>7</i>	<i>0.00 - 0.10</i>	<i>Soil</i>								
	<i>0.10 - 2.30</i>	<i>mudstone brown</i>								
	<i>2.30 - 5.60</i>	<i>Sandstone brown</i>								
	<i>5.60 - 10.70</i>	<i>mudstone grey</i>								
	<i>10.70 - 14.00</i>	<i>Sandstone grey</i>								
	<i>14.00 - 15.00</i>	<i>mudstone grey</i>								
Casing / Water level details										
BH	Casing Die	Depth	Strike	Water Rise	Sealed	Totals	BH's	Drill	Case	Core
						Today	<i>7</i>	<i>120</i>		
						Previous	<i>-</i>	<i>-</i>		
						To date	<i>7</i>	<i>120</i>		

Signed *[Signature]* Driller

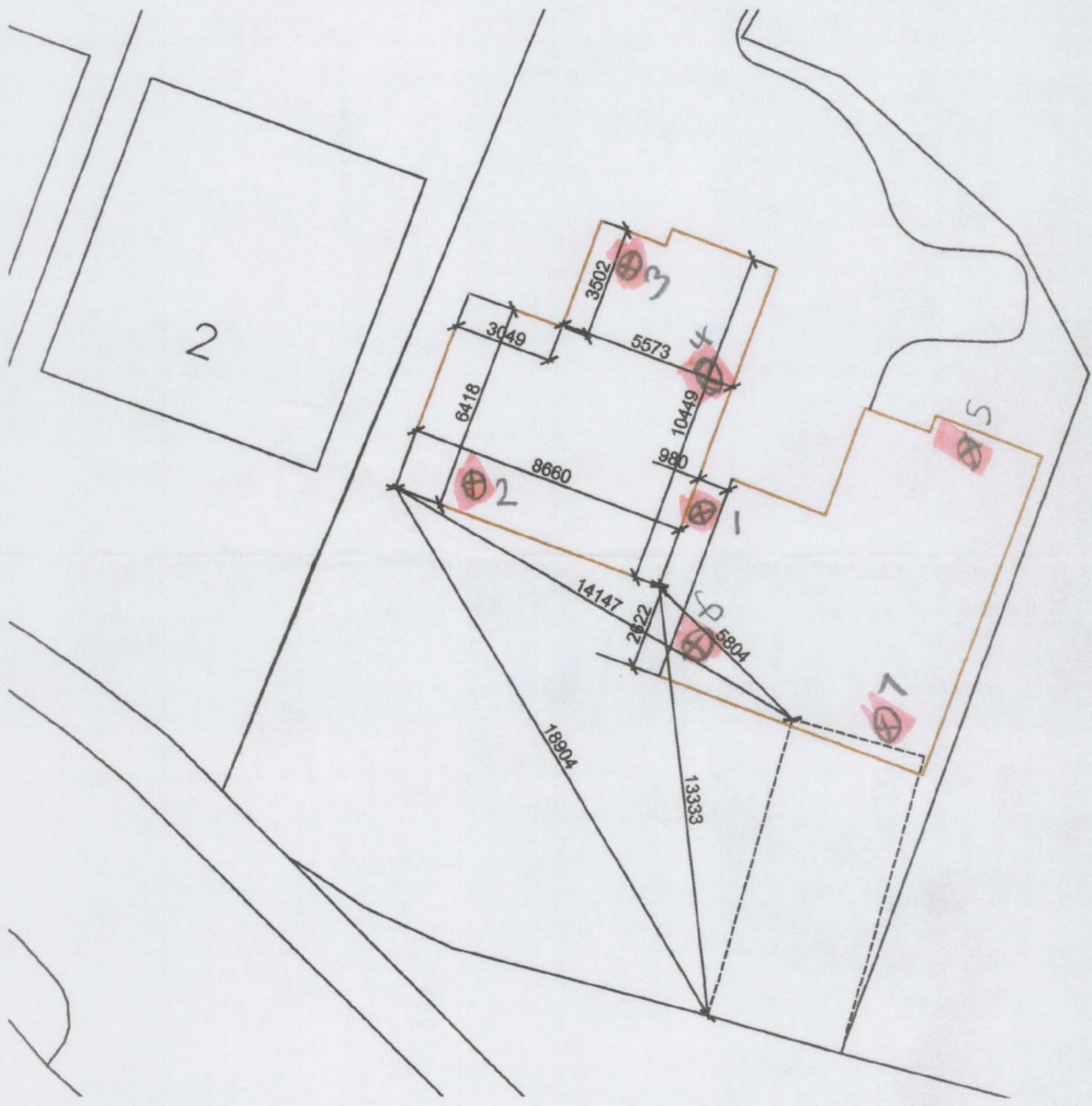

The