

Former Wombwell High School, Wombwell

Notes:
xx

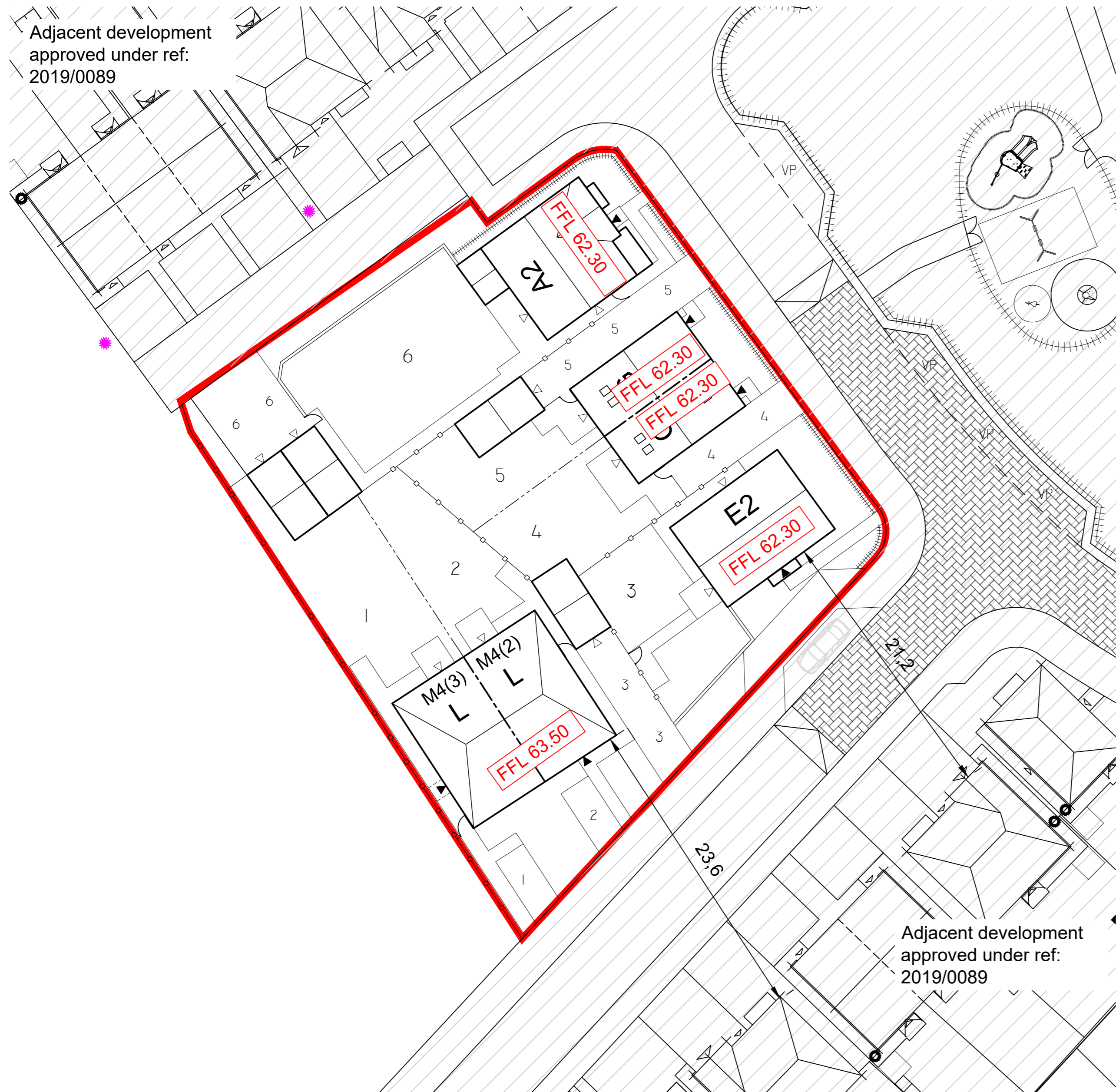

KEY:

FFL 7.60

INDICATIVE FINISHED FLOOR LEVEL. ALL FFLs TO BE DETERMINED DURING DETAILED DESIGN OF SITE LEVELS AND SURFACE WATER NETWORK. THE AIM IS TO REDUCE FFLs WHERE POSSIBLE BUT THERE MAY ALSO BE THE NEED TO INCREASE THE LEVEL WHERE NECESSARY. LEVELS INDICATED TO HAVE A TOLERANCE OF +/- 500mm

D	Updated to Planning Layout E	TS	02.07.24
C	Updated to Planning Layout D	TS	06.07.23
B	Updated to Planning Layout C	VR	29.06.23
A	Garage added to plot 4	TS	21.12.22
REV:	DESCRIPTION:	BY:	DATE:

STEN
ARCHITECTURE

STEN Architecture Ltd
The Studio
Harrison Street
Wakefield
WF1 1PS
Tel: 01924 950985

Web: www.sten-architecture.co.uk
Twitter: @STEN_arch
Facebook: stenarchitecturetd
LinkedIn: Sten Architecture

CLIENT: Premier construction northern
51 Rimington Road
Wombwell
Barnsley
S73 8DQ

SITE: Former Wombwell High School
Wombwell

TITLE: Finished floor levels

SCALE AT A2: 1:250	DATE: 26.05.22	DRAWN: TS	CHECKED: DS
PROJECT NO: 2228	DRAWING NO: 2228.13	REVISION: D	

