

SUBSTATION DOORS TO MEET SPECIFICATION WITH VENTILATION OPENINGS IN 2590x2200 OPENING. RIGHT LEAF TO OPEN FIRST

REMOVABLE GRP ROOF

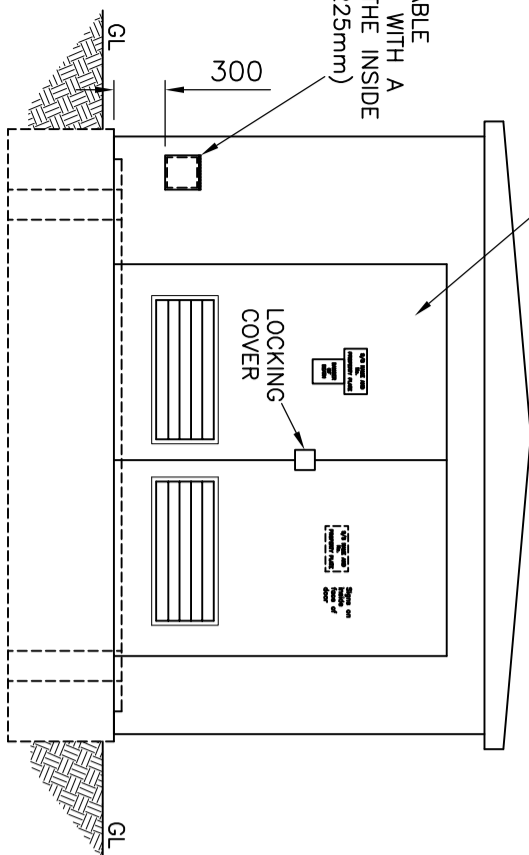

FRONT ELEVATION
SCALE 1:50

ROOF TO HAVE EXPLOSION RELIEF FITTINGS

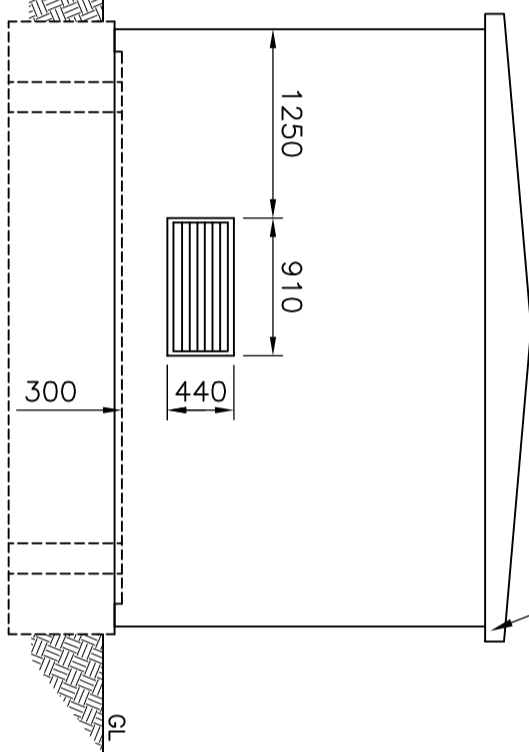

REAR ELEVATION
SCALE 1:50

EAVES VENTILATION TO BE PROVIDED TO 3 SIDES (REAR & SIDES)

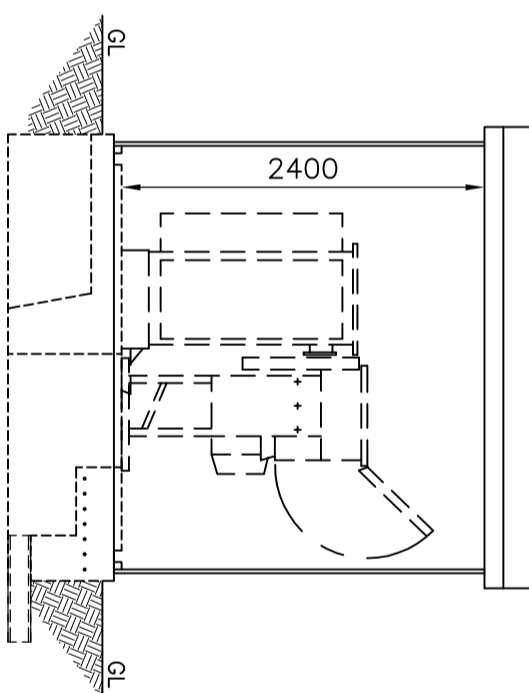

SECTION B-B
SCALE 1:50

NOTES

FLOOR:

1. Foundations shown are based on a maximum weight of transformer of 40kN and a minimum ground bearing pressure of 80kN/m²
2. The foundations are to be adjusted to structural engineers instructions.
3. Floor slab shall be designed to carry a minimum load of 7.5kN/m². Floor to be level, steel floor finish concrete, and sealed with approved concrete sealer or concrete paint.
4. Earthed area of floor slab reinforcement shown hatched (on electrical layout) to be inspected by Northern Powergrid clerk of works prior to pouring concrete.
5. Floor to be cast to front face of door opening, providing solid threshold. External level to be 125mm below finished floor level, allow unrestricted access for gear, and have a level landing area.
6. Trench covers to be 25mm exterior quality WBP ply, maximum width 1200mm, each cover to have 2 No. 35mm diameter finger holes, covers to be painted two coats silver gloss paint both sides and all edges
7. External paving and site finishes shall be provided as agreed with Northern Powergrid representative on site. As a minimum this shall consist of paving to full width of substation doors x 1200mm deep, with paving linking nearest highway path

Core is to be taken to ensure that access to cable openings is not impaired.

No Gas, Sanitary, Water or other Services to run through or under the substation.

REFERENCE DRAWINGS :

C978643 - Earth Point Connection Details

REFERENCE DOCUMENTS :

NPS/006/002 - Technical Specification for Distribution Substation Enclosures

CUSTOMER NOTES

The customer to carry out all necessary lighting and heating installation and building work as described including the provision of the LV supply. The substation shall be wired independently of any other areas or customers accommodation.

Northern Powergrid will not install any equipment until the accommodation is deemed fit for purpose. Customer service will not be made live until completion certificate is issued.

Customer or their agent to obtain all necessary Planning and Building approvals before construction work commences.

This drawing is intended to indicate the minimum requirements for the installation of Northern Powergrid apparatus and is not in any way intended to describe the building to architectural, structural or other requirements.

The customer shall provide full construction drawings minimum 15 days prior to commencement of works, to allow Northern Powergrid to check for compliance with their requirements.

Substation to be designed in accordance with Northern Powergrid flood mitigation policy.

Northern Powergrid Project Engineer to be notified of commencement of site works to enable site inspections to be carried out during construction.

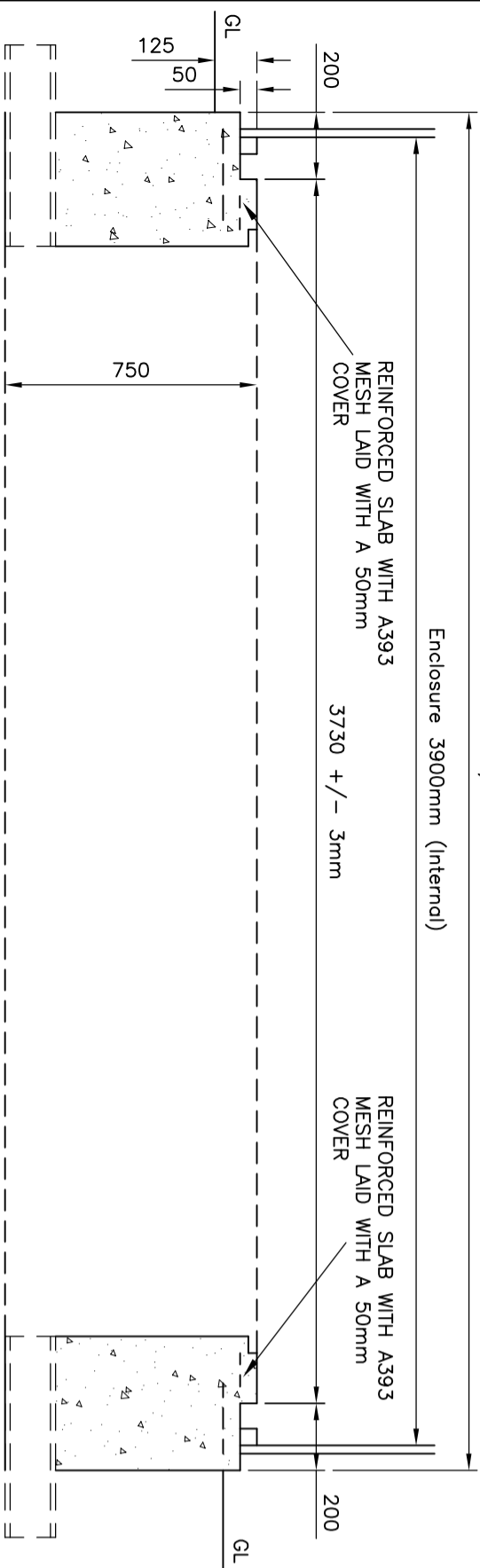

DETAILED SECTION A-A
SCALE 1:20

EARTH POINT CONNECTION
H10 "L" BAR 600mm LONG
A=500mm, B=1000mm
TO BE WIRE TIED IN FOUR PLACES
TO THE UNDERSIDE OF THE TOP
LAYER OF REINFORCEMENT MESH

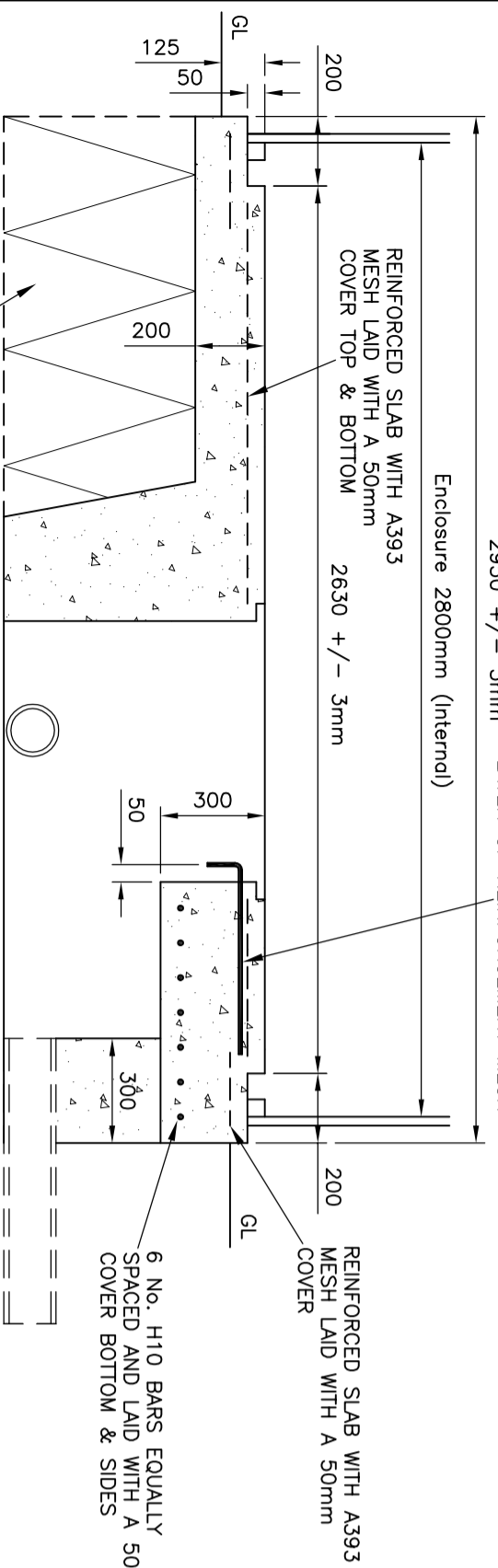

DETAILED SECTION B-B
SCALE 1:20

THIS COMPACTED MOT STONE SHOULD BE SUBSTITUTED WITH MASS POURED CONCRETE IF GROUND CONDITIONS ARE UNSUITABLE (IF COMPACTED STONE IS USED, IT SHALL BE MINIMUM 150mm THICK)

PLAN OF EQUIPMENT & ENCLOSURE
SCALE 1:50

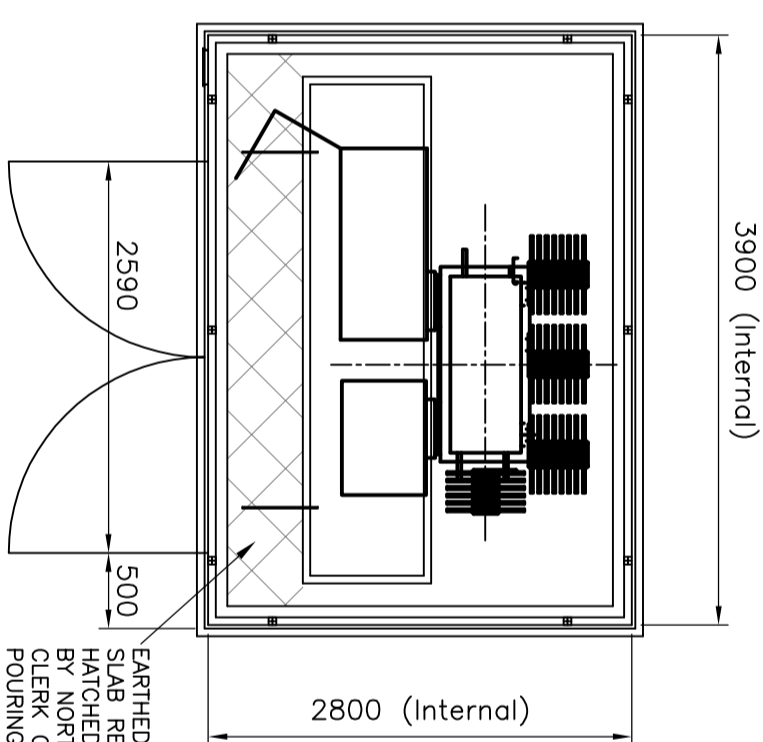

EARTHED AREA OF FLOOR SLAB REINFORCEMENT SHOWN HATCHED TO BE INSPECTED BY NORTHERN POWERGRID CLERK OF WORKS PRIOR TO POURING CONCRETE.

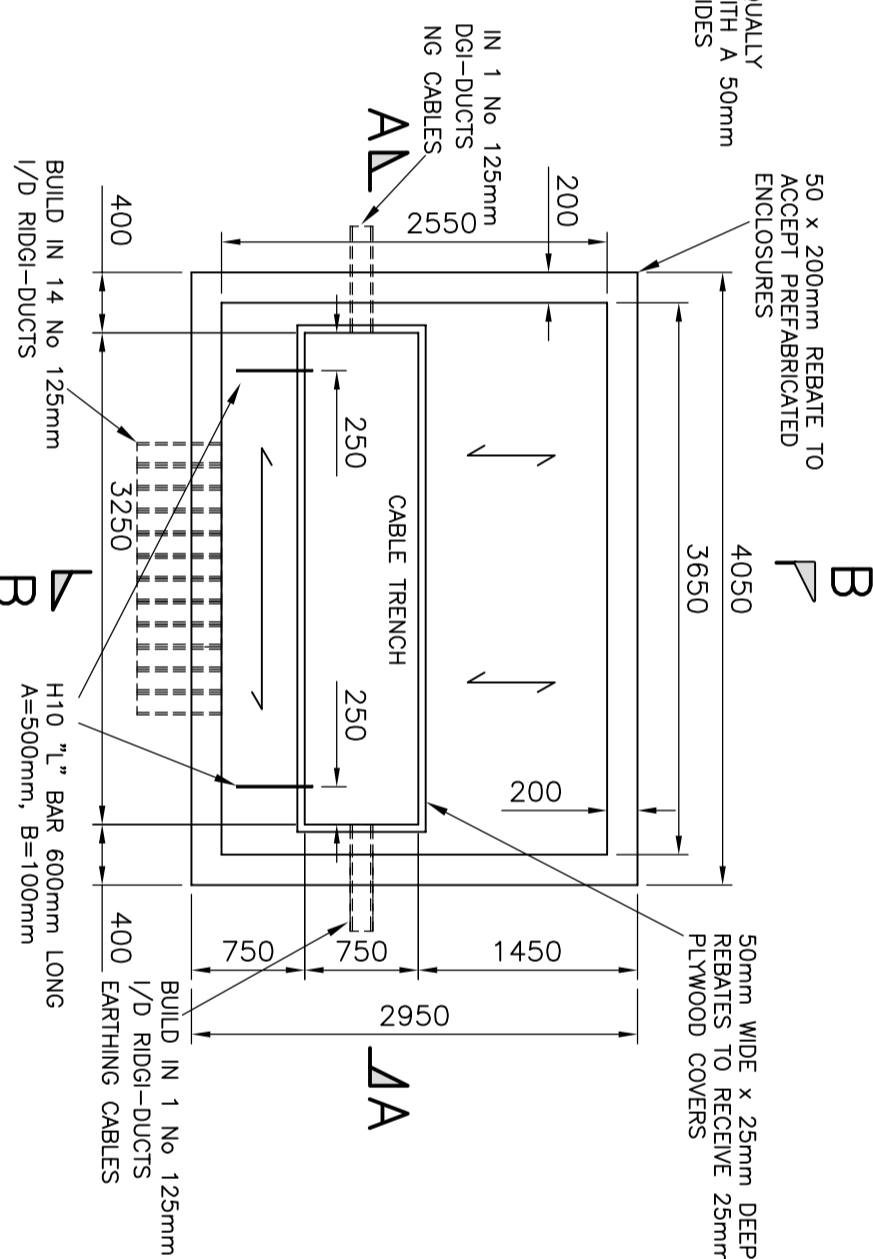

FOUNDATION PLAN
SCALE 1:50

INTERNAL CUBIC CAPACITY - 26.2m³

ISOMETRIC VIEW
OF FOUNDATION



NORTHERN POWERGRID

Lloyds Court, 78 Grey Street, Newcastle Upon Tyne, NE1 6AF

800 - 1000kVA UDE IN PREFABRICATED ENCLOSURE

Manufacturer Details	Scale	AS SHOWN	Document Details	Ref No.	C991443	Historic Drawing No.
Sheet No. 1	TD	AS SHOWN	Prepared By	Revision	C	Notes
Revised	Grid Reference	CD	Date Issued	14.11.11		