

Do not scale from this drawing. All drawings to be checked on site. If in doubt, please ask.

Revision: A Date: 15/01/2021  
Drawings revised following clients comments.  
Revision: B Date: 14/02/2021  
Boundary wall position revised following planning officer comments.  
Revision: C Date: 20/02/2021  
En-suite window size revised following planning officers comments.

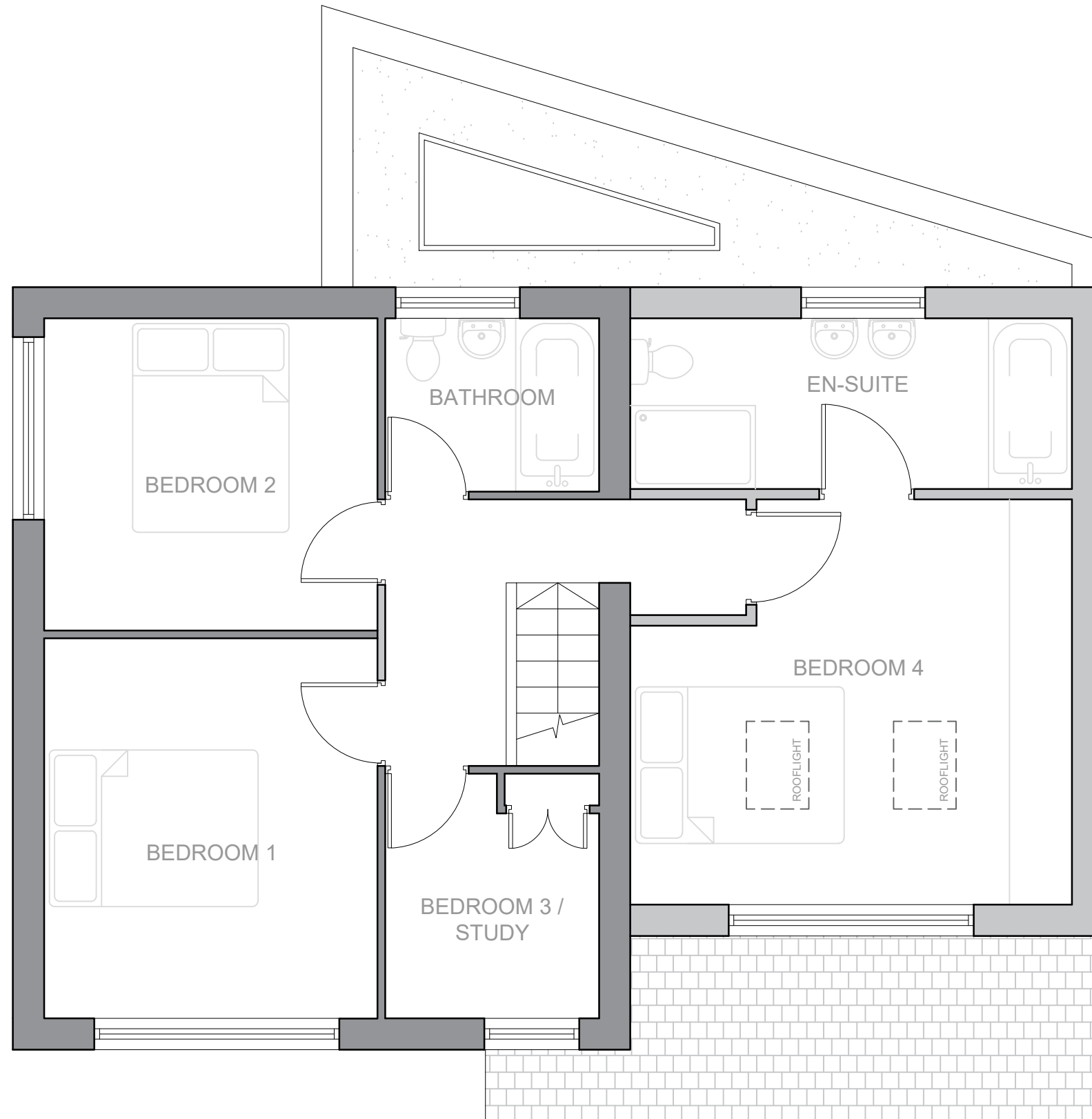

PROPOSED FIRST FLOOR PLAN  
SCALE 1:50

Client:  
Mr and Mrs Allen

Project:  
2 Warwick Road

Monk Bretton

Barnsley

S71 2NN

Drawing Title:  
Proposed First Floor Plan

Drawing Status:  
Information

Scale: 1:50 Paper Size: A3

Date: 07/01/2021 DWG No: 2022\_05C