

- Notes:
1. This drawing is subject to copyright and is not to be reproduced in part or whole without approval.
 2. Do not scale this drawing - check all dimensions on site.

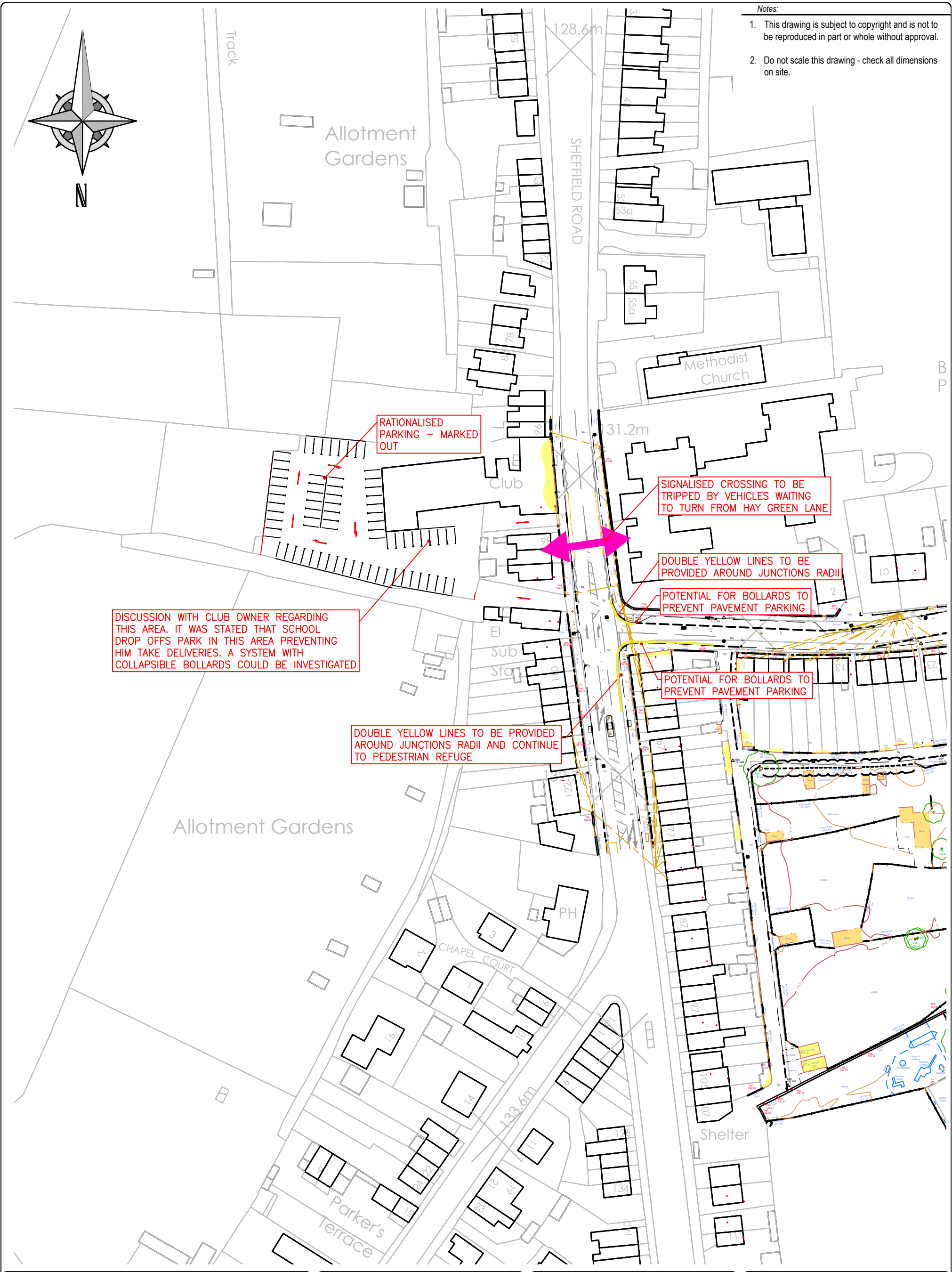

DISCUSSION WITH CLUB OWNER REGARDING THIS AREA. IT WAS STATED THAT SCHOOL DROP OFFS PARK IN THIS AREA PREVENTING HIM TAKE DELIVERIES. A SYSTEM WITH COLLAPSIBLE BOLLARDS COULD BE INVESTIGATED

DOUBLE YELLOW LINES TO BE PROVIDED AROUND JUNCTIONS RADII AND CONTINUE TO PEDESTRIAN REFUGE

SIGNALISED CROSSING TO BE TRIPPED BY VEHICLES WAITING TO TURN FROM HAY GREEN LANE

DOUBLE YELLOW LINES TO BE PROVIDED AROUND JUNCTIONS RADII

POTENTIAL FOR BOLLARDS TO PREVENT PAVEMENT PARKING

POTENTIAL FOR BOLLARDS TO PREVENT PAVEMENT PARKING

Rev:	Date:	Status/Amendments:	By:
B	18.05.20	AMENDED PARKING	RAM
A	04.05.20	AMENDED PARKING	RAM
-	24.03.20	INITIAL ISSUE	RAM

mosodi
 mobility solutions through design and innovation

Manchester Leeds
 0161 413 5168 0113 323 0854

Client:
HARWORTH

Project:
HAY GREEN LANE,
BIRDWELL

Drawing Title: POTENTIAL SCHOOL DROP OFF STRATEGY		
Drawn By: RAM	Checked By: -	Approved By: -
Scale: 1:1000	Paper Size: A3	Date Created: 24.03.2020
Drawing Number: 18039.IN.08	Drawing Revision: B	