

Drawing status

Drawn by	AP	Size	A1	Scale	VAR.
Notes					
PRELIMINARY STUDY	P				
AMENDMENTS:					
Ramp length amended; modular building pushed further 200mm from the face of the existing building.	P	A			03/03/21
AMENDMENTS:					
Vinyl to be dressed up the face of the new IPS 100mm	P	B			03/03/21
AMENDMENTS:					
D02 handed the other way.	P	C			16/03/21
AMENDMENTS:					
D03 and D05 located to be 190mm from the neighbouring wall.	P	D			19/03/21
D05 opening direction has been changed to be outwards.					
Change 1 has been widened by 100mm towards the MRI Prep Area.					
D4 has been changed to be a double swing door.					
Cabinets in the MRI Prep Area have been moved 75mm away from the wall to create space for the scribe.					
AMENDMENTS:					
Existing column in wall has been moved to correct location. Accurate dimension provided by the contractor.	P	E			22/03/21
AMENDMENTS:					
WHB locations amended.	P	F			31/03/21

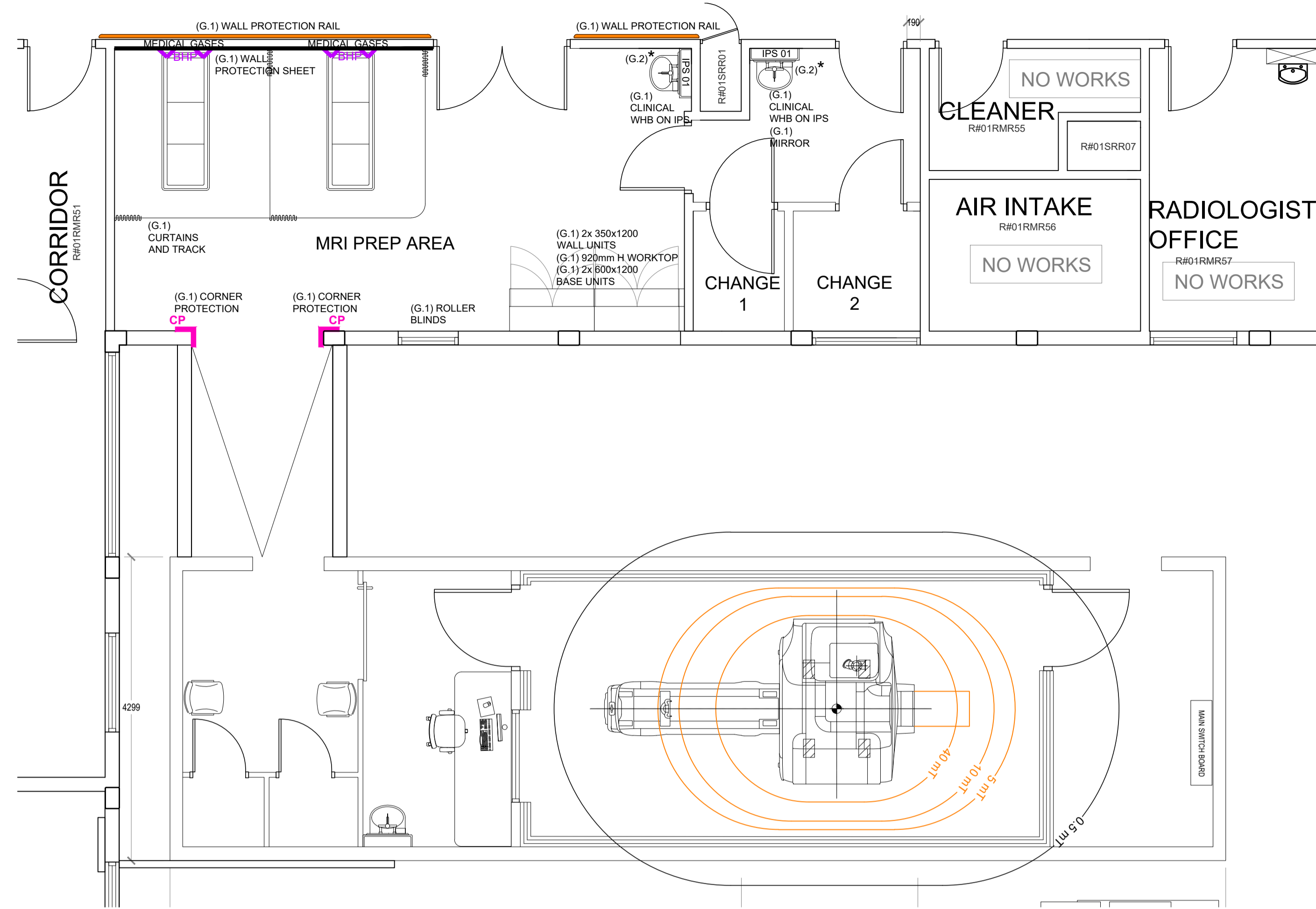

LOADED PLAN:
REFER TO NBS N10

(G.1) - GROUP 1 ITEMS ARE SUPPLIED AND FITTED BY THE CONTRACTOR.
(G.2) - GROUP 2 ITEMS ARE SUPPLIED BY THE CLIENT AND FITTED BY THE CONTRACTOR.
(G.3) - GROUP 3 ITEMS ARE SUPPLIED AND FITTED BY THE CLIENT.

(G.2)* - DENOTES THE LOCATION OF A PAPER TOWEL DISPENSER, SOAP DISPENSER AND ALCOHOL GEL DISPENSER

LOADED PLAN
1:50

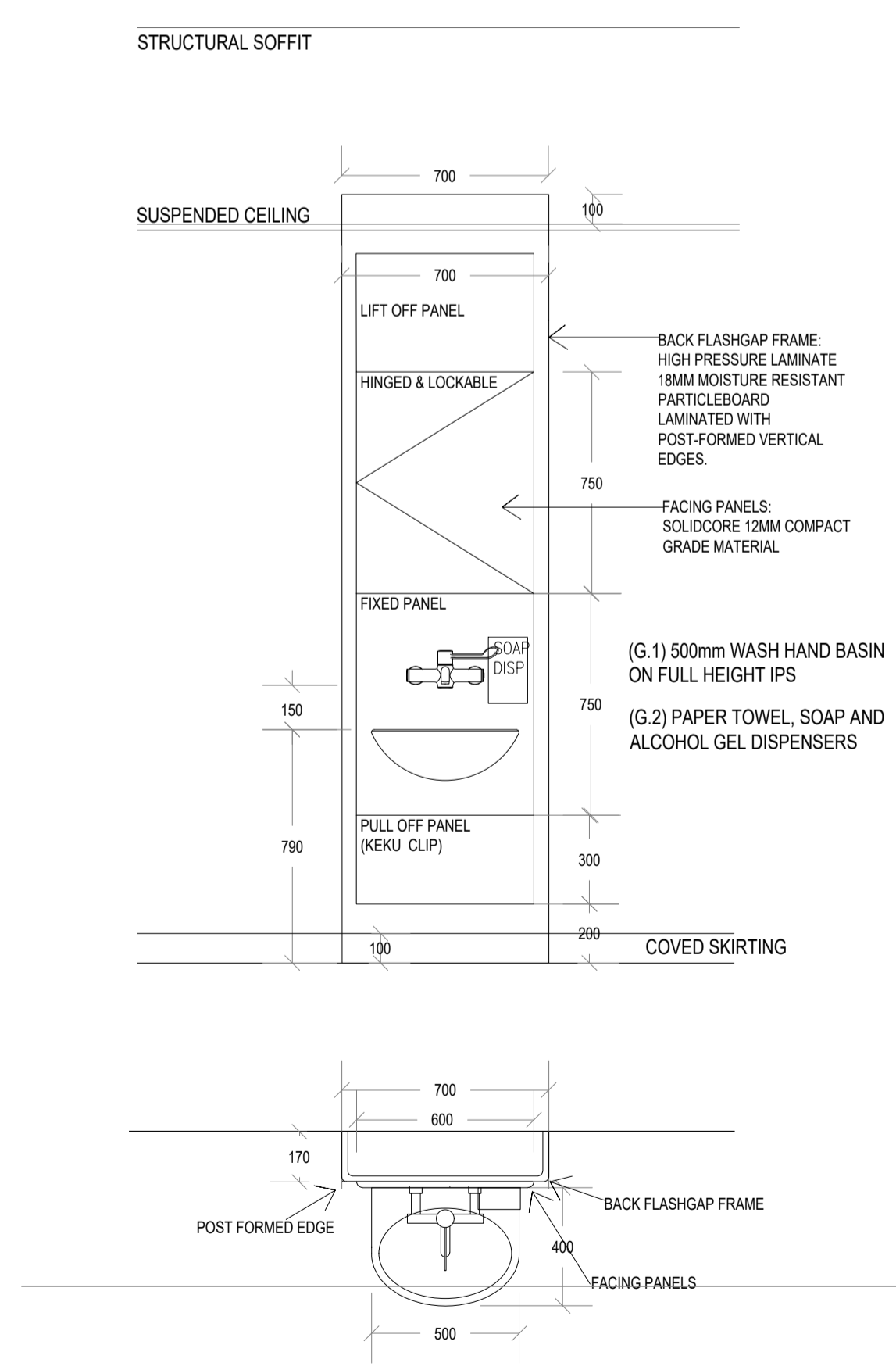

IPS 01 - ELEVATION & PLAN
1:20

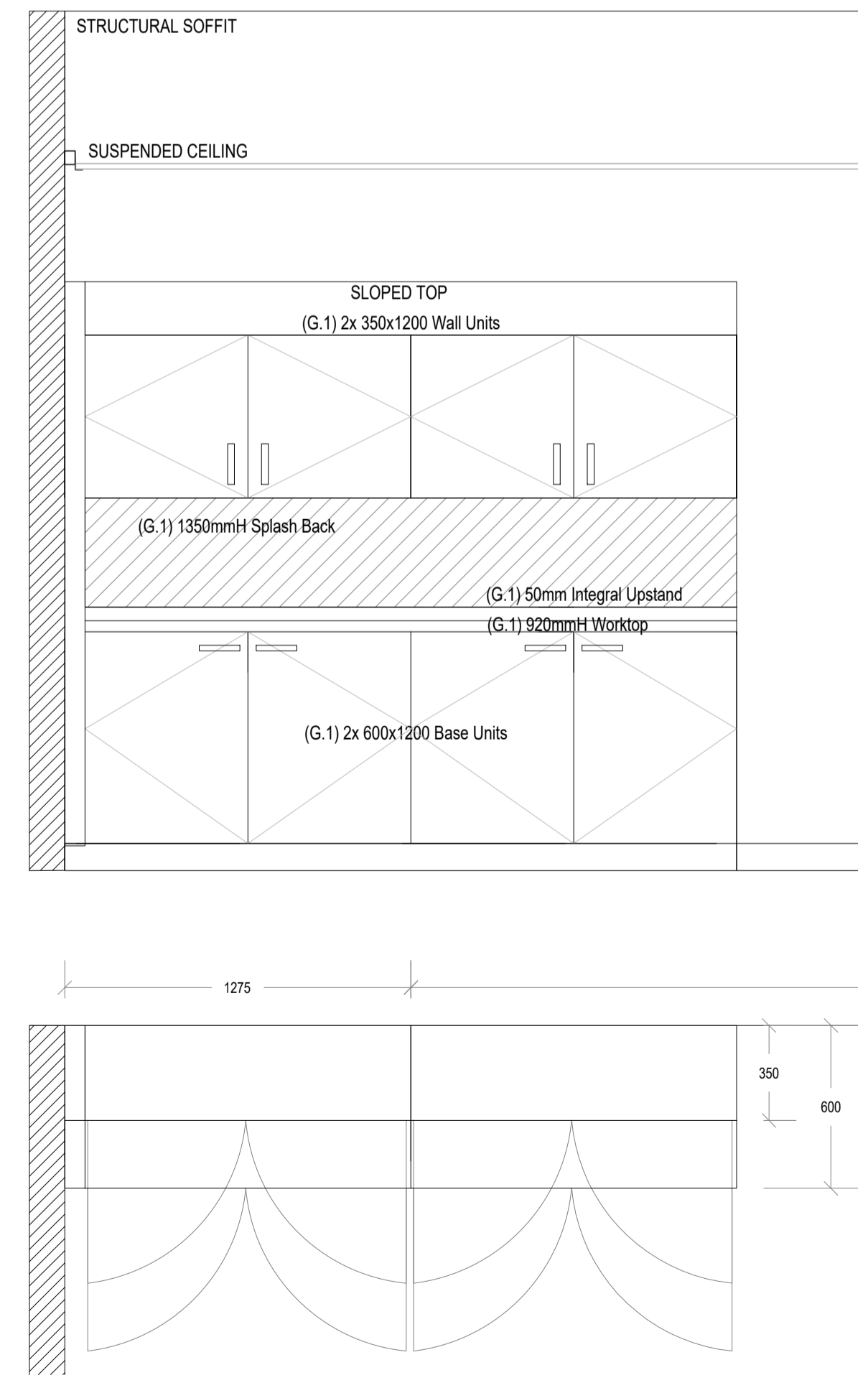

CABINETS - ELEVATION & PLAN
1:20

Drawing status annotation
P-Preliminary T-Tender D-Design (post preliminary) C-Construction As-As Built

Client
BARNSELY HOSPITAL NHS
FOUNDATION TRUST

Project title
MODULAR MRI

Project no
170/032

Drawing title
LOADED PLAN,
IPS AND FURNITURE
DETAILS

Drawing no
(72)-01

Status Revision
P F