



1 Front Elevation
1 : 50



4 Side Elevation
1 : 50



3 Rear Elevation
1 : 50

RESPONSIBILITY IS NOT ACCEPTED FOR OTHERS SCALING DIRECTLY FROM THIS DRAWING. DO NOT SCALE FROM THIS DRAWING. USE WRITTEN DIMENSIONS ONLY.

KEY PLAN

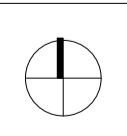
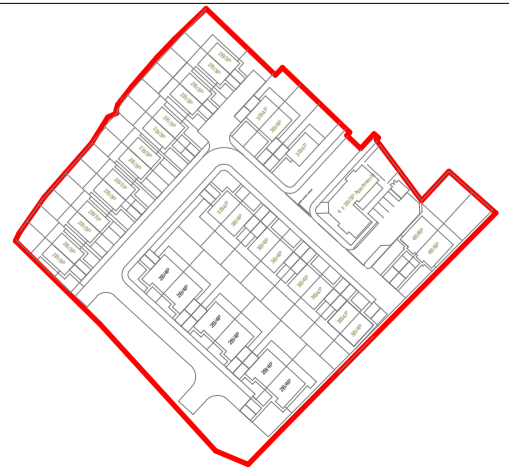

NOTES

ORIGINAL SHEET SIZE **A1**

THIS DRAWING IS PRODUCED FOR USE IN THIS PROJECT ONLY AND MAY NOT BE USED FOR ANY OTHER PURPOSE. THE ORIGINATOR ACCEPTS NO LIABILITY FOR THE USE OF THIS DRAWING OTHER THAN THE PURPOSE FOR WHICH IT WAS INTENDED IN CONNECTION WITH THIS PROJECT AS RECORDED IN THE 'PURPOSE FOR ISSUE' AND 'FILE STATUS CODE'.

THIS DRAWING MAY NOT BE REPRODUCED IN ANY FORM WITHOUT PRIOR WRITTEN AGREEMENT.
© CROWN COPYRIGHT AND DATABASE RIGHTS - ORDNANCE SURVEY LICENCE NUMBER 100019340.

Rev	Description	Date
P01	First Issue	06.12.19
P02	Updated to reflect client comments	13.12.2019

CLIENT
BMBC Housing Growth

PROJECT
St. Michael's Avenue

TITLE
3Bed House Elevations - Stone Option

SCALE
1 : 50

DRAWING NUMBER
NPS_XX_DR_A_071

STATUS CODE
S2

PURPOSE OF ISSUE
Planning

PROJECT NUMBER
1811301

REV CODE
P02

Drawn by
EA

Approved by
-



Barnsley - Gateway Plaza
Sackville Street
Barnsley
South Yorkshire
S70 2RD
barnsley@nps.co.uk