

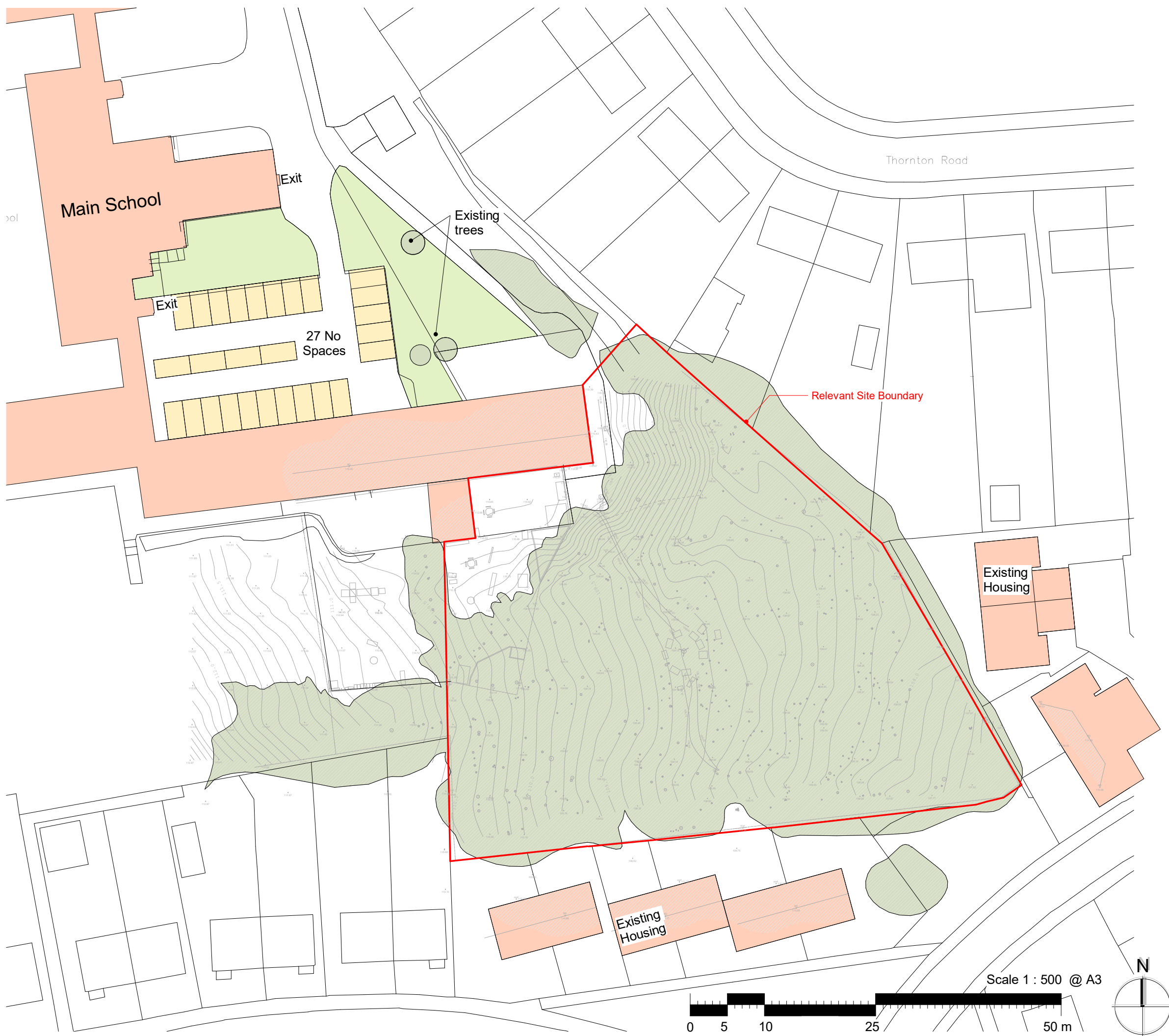

This drawing and CAD data therein is protected by copyright and must not be reproduced without the written consent of DLG Architects LLP. ©

1. Do not scale from the drawing, figured dimensions only to be used. All dimensions are in millimetres unless noted otherwise. Scale bar for reference only.
2. All dimensions and sizes shall be verified on site before proceeding with the work.
3. Drawing to be read in conjunction with all supporting information issued by the Architect, and associated information provided by all other Consultants and Designers.
4. Information limited to architectural design and dimensional coordination of the works. Specialist design proposals to be fully coordinated with the architectural design.
5. DLG Architects shall be notified in writing of any discrepancies with other Consultant or Designers information. Where discrepancies are apparent, the design intent on the architectural drawings will take precedence, unless otherwise agreed in writing with the Architect.
6. All proprietary materials must be installed or constructed in strict accordance with the manufacturer's specification and installation guidance.
7. All works to be undertaken in accordance with current Building Regulations and associated BS and BS EN Standards.
8. PDF drawings to take precedence over any 2D or 3D CAD data.
9. All aspects of the design and specification are limited to the agreed DLG Architects LLP scope. Independent advice relating to all aspects of specialist design to be sought.



Rev	Date	Description	By	Chkd
P03	15.12.25	Relevant site boundary added.	LM	DB
P02	01.10.25	Renumbered as (PL) series.	LM	DB
P01	09.06.25	Issued to client	NS	

Project  
**WELLSPRING ACADEMY TRUST**  
**THE FOREST ACADEMY**  
**THORNTON RD, BARNSELY**



Drawing Title  
**EXISTING SITE PLAN**

Status  
**PLANNING**

Job No	Date Drawn	Scale	Drawn	Checked
4547	19/05/25	1:500 @ A3	NS	DB

Project ID	Originator	Volume	Level	Type	Role	Number	Revision
4547	- DLG - ZZ - ZZ -	D	- A -	(PL)01			P03