

E-13 Elevation 1:100

Rev:	Date	Revision Notes
------	------	----------------

**Client:** Oakstone Developments

**Project:** Proposed 5 Residential development at Crowick House, Belle Green lane, Cudworth, Barnsley

**Drawing Title:** Ground, First Floor plans and Elevation

**Scale:** 1:200, 1:100 **Date:** 02/02/2012

**Drawn By:** AR **Rev:**

**Drwg Nr:** AE1

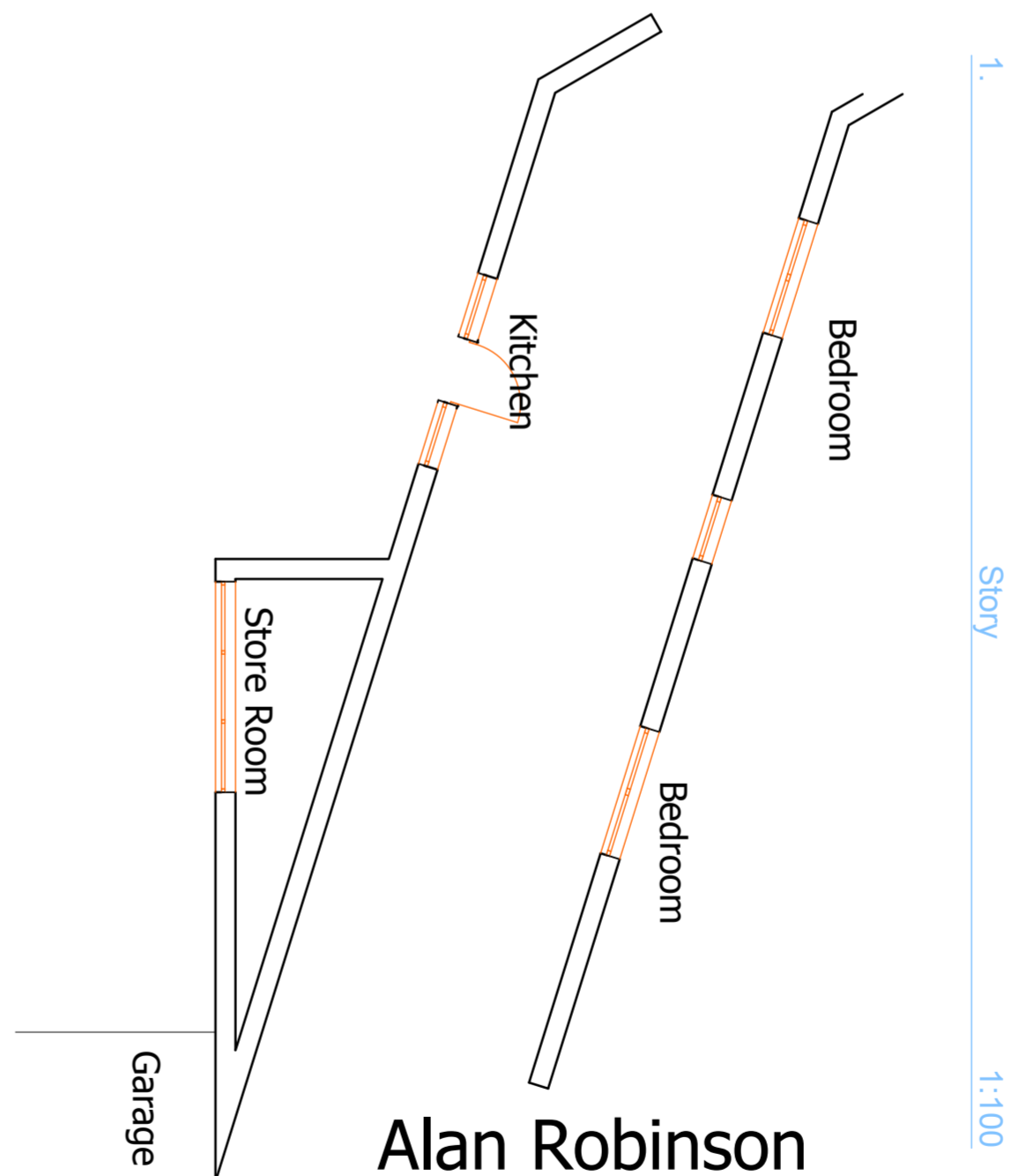
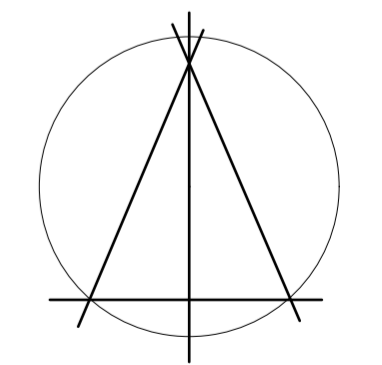

Alan Robinson  
 Chartered Architect BA Dip Arch RIBA BSc (Hons)  
 2 Gawber Road, Barnsley S75 2AF  
 Tel/Fax 01226 286066  
 Mob: 07947808933