

DETAILED SITE LOCATION
(Scale 1:1250)

Based upon Ordnance Survey map extract with the permission of the Controller of Her Majesty's Stationery Office. Crown copyright. Licence No. 100022432

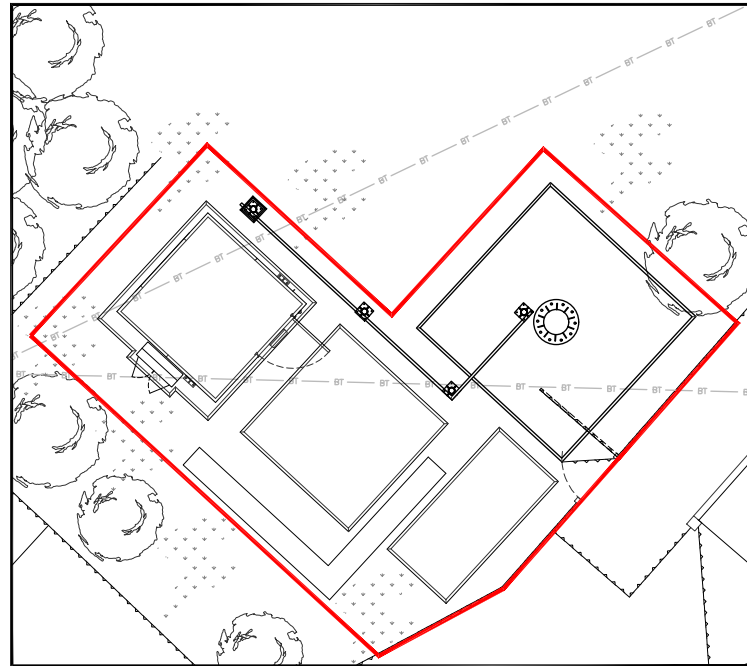

DEMISE PLAN
(1:100)

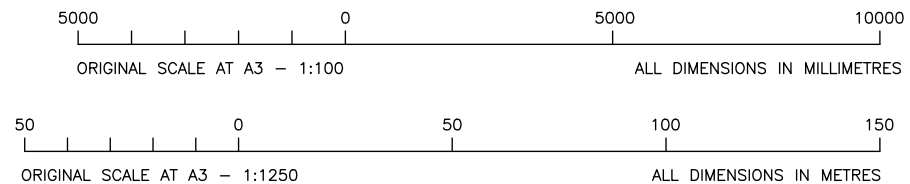

ALL DIMENSIONS ARE IN mm UNLESS NOTED OTHERWISE			
N.G.R	E: 437071	N: 405454	
CONCESSION REQUIRED		NO	
DIRECTIONS TO SITE: TRAVELLING ON THE M1, EXIT AT JCT. 37 AND TAKE THE A628 HEADING FOR BARNSELY. CONTINUE FOR APPROX. 0.5km, THEN TURN RIGHT ONTO THE A6133 BROADWAY. ROAD BENDS TO LEFT AFTER APPROX. 1.0km AND BECOMES PARK ROAD, CONTINUE FOR A FURTHER 1.75km THEN AT THE JCT. WITH SHEFFIELD ROAD, CONTINUE STRAIGHT ON, ON THE A6133. CONTINUE FOR A FURTHER 1.0km THEN AT JUNCTION BEAR RIGHT ONTO THE A635 DONCASTER ROAD. CONTINUE ON THE A635 FOR APPROX 1.75km, THEN AT ROUNDABOUT TAKE THE FOURTH EXIT ONTO THE B6100 HUNNINGLEY LANE. TAKE THE FIRST RIGHT ONTO STANLEY LANE THEN FIRST LEFT ONTO WHEATLEY ROAD. SITE LOCATED WITHIN INDUSTRIAL YARD AT THE END OF WHEATLEY ROAD ON THE RIGHT HAND SIDE. PEDESTRIAN ACCESS GATE TO SITE IS ON THE RIGHT HAND SIDE OF DOUBLE GATES AT THE END OF WHEATLEY ROAD.			
NOTES:			
C	Demise amended	SH	LB 08.02.19
B	Demise amended	SH	LB 04.01.19
A	Issued For Approval	CCD	LB 10.06.18
REV	MODIFICATION	BY	CH DATE



Cell Name		Opt.
BA HAXBY (BARNSELY) LTD.		-
Cell ID No		
CTIL	TEF	VF
206425	71714	N/A

Site Address / Contact Details
WHEATLEY ROAD OFF STANLEY ROAD
STAIRFOOT
BARNSELY
SOUTH YORKSHIRE
S70 3PG

Drawing Title:		LEASE DRAWING	
Purpose of issue:		PLANNING	
Drawing Number:		101	
Surveyed By:		Original Sheet Size:	
PW		A3	
Drawn:	Date:	Checked:	Date:
CCD	10.06.18	LB	10.06.18
Pack Issue:		C	
E		E	

The drawings comply with TEF & Vodafone Standard ICNIRP guidelines.
Designed in accordance with CTIL document: SDN0008