

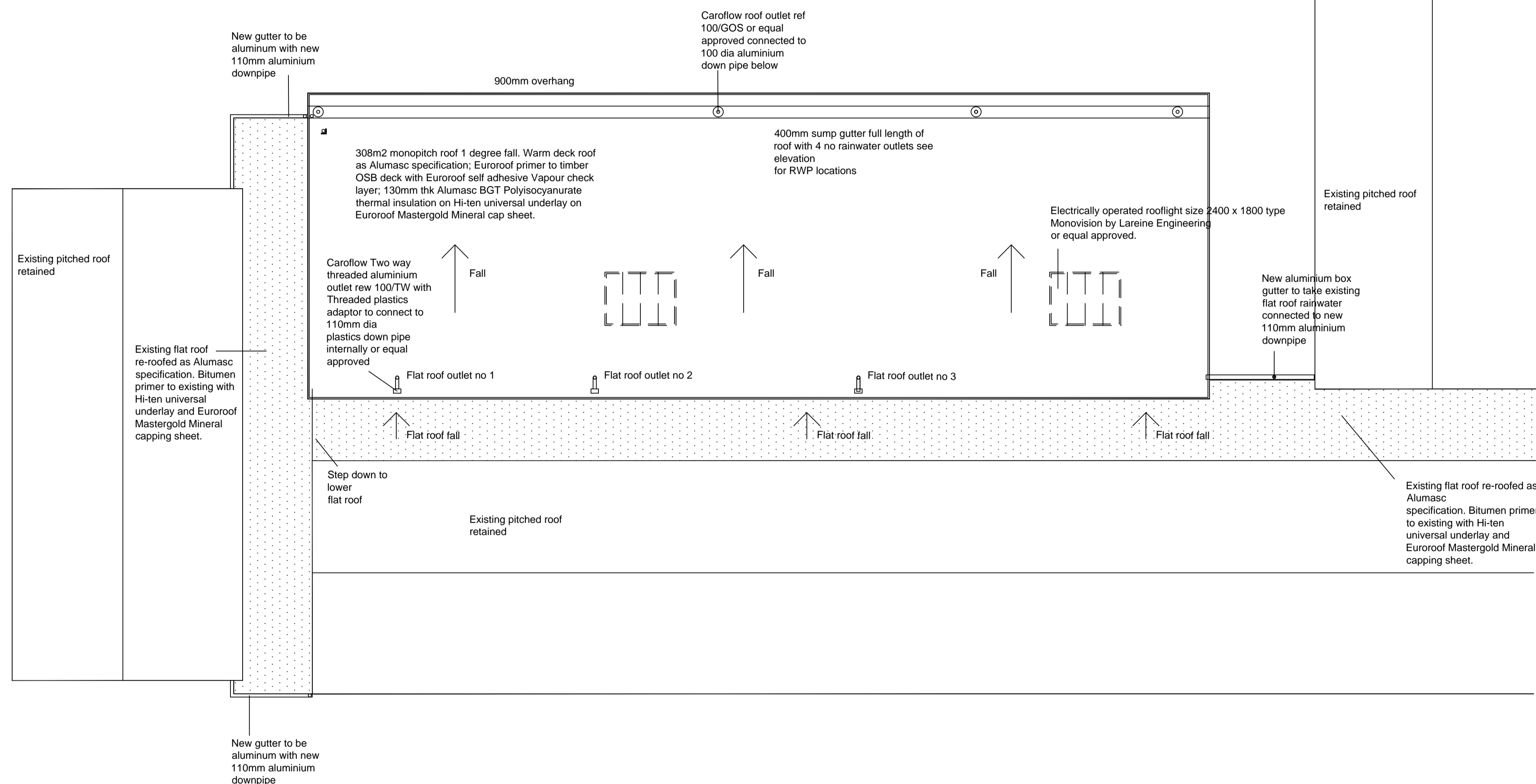

Notes:



FIRST ISSUE						
P1						
COMMENT						
REV	DRAWN	DATE	CHECKED	DATE	APPROVED	DATE

THIS DRAWING IS PRODUCED FOR USE IN THIS PROJECT ONLY AND MAY NOT BE USED FOR ANY OTHER PURPOSE. NPS PROPERTY CONSULTANTS LTD ACCEPT NO LIABILITY FOR THE USE OF THIS DRAWING OTHER THAN THE PURPOSE FOR WHICH IT WAS INTENDED IN CONNECTION WITH THIS PROJECT AS RECORDED IN THE PURPOSE FOR ISSUE AND FILE STATUS CODE.

THIS DRAWING MAY NOT BE REPRODUCED IN ANY FORM WITHOUT PRIOR WRITTEN AGREEMENT OF NPS PROPERTY CONSULTANTS LTD.

© CROWN COPYRIGHT AND DATABASE RIGHTS 2016 ORDNANCE SURVEY LICENCE NUMBER 100022264

RESPONSIBILITY IS NOT ACCEPTED FOR OTHERS SCALING DIRECTLY FROM THIS DRAWING. DO NOT SCALE FROM THIS DRAWING. USE WRITTEN DIMENSIONS ONLY.

0m 1 2 3 6m

1:100

ORIGINAL SHEET SIZE A1

CLIENT
BMBC EDUCATION

TITLE
PROPOSED ROOF PLAN

PROJECT
**HUNNINGLEY PRIMARY SCHOOL PHASE 2
PROPOSED 2 NO CLASSROOMS PLUS INTERNAL ALTERATIONS**



NPS Barnsley Ltd
Gateway Plaza, Sackville St, Barnsley, South Yorkshire, S70 2RD,
Tel: 01226 774000; Email: barnsley@nps.co.uk
web: www.nps.co.uk

SCALES 1:100	DISCIPLINE ARCHITECT	PROJECT NUMBER 17-1-1051
DRAWING NUMBER NPS-DR-A-(00)-034	REV CODE P1	
STATUS CODE D2	PURPOSE OF ISSUE TENDER	DRAWN BY P HEPP