

revisions
 A 10-5-2024
 updated to planners and clients requirements
 B 3-6-2024
 updated first floor plan to match description

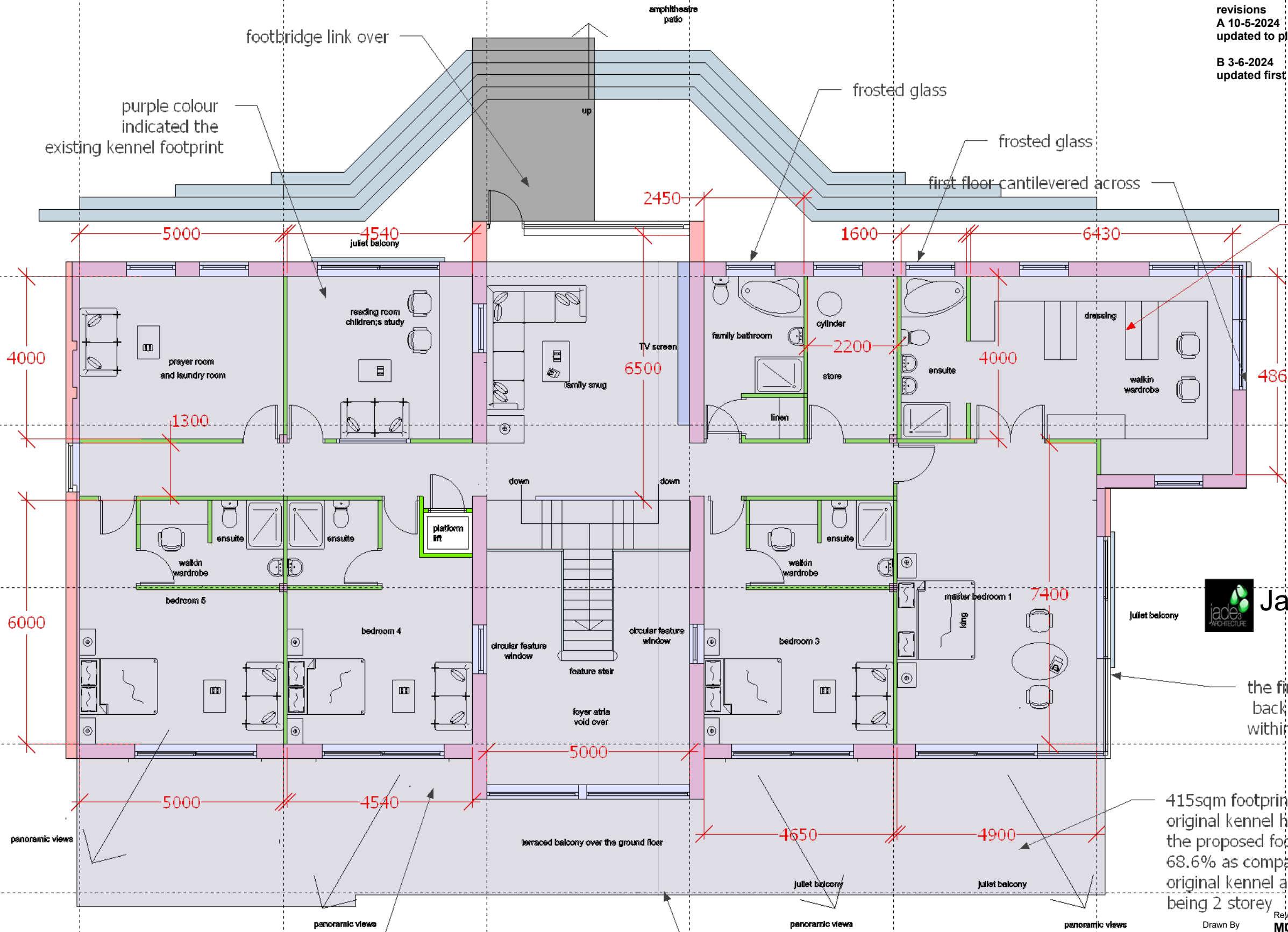

275m²total 560 sqm
 (6030sqft)
 assumed 2.6m floor to ceiling
 therefore the volume is
 560x2.6= 1456cubic metres
 ie 1560sqft more than
 the original kennel



Jade3 Architecture Ltd

Jade3 Architecture Ltd, Studio 12, Silver Street, Wakefield WF1 1UY
 Cellphone : 07535 740097 www.jade3architecture.co.uk

the first floor is slide
 back so that it is
 within the footprint
 of the original House Farm
 (former kennel site)
 Woodhead Road
 Wortley
 Sheffield
 S35 7DA

415sqm footprint of
 original kennel however,
 the proposed footprint is only
 68.6% as compared with the
 original kennel albeit
 being 2 storey

all bedrooms are facing
 the front to maximise
 panoramic views of
 the valley and beyond

frameless glass balustrades to
 provide uninterrupted views

proposed first floor

Project No. 2023 Enquiry 76	Project Title Proposed first
Scale: 1:100 @A3 size	Date 6/12/2023
Drawn By MC	Reviewed By MC
Drawn No. 103	Reviewed Title
Revision B	

Important Notice
 Do not scale off this drawing. Critical dimensions should be checked on site prior to works commencing. Dimensional conflicts should be brought to the company's attention as soon as they become apparent. Failure to do so could render the contractor liable for subsequent losses. Copyright in this drawing and any work executed from this drawing remains the property of Jade3 Architecture Ltd.

© Copyright Jade3 Architecture Ltd.