

Drawing status

| Drawn by | DB | Size | A1 | Scale | VAR |
|---|----|------|----|--------|------------|
| Notes | | | | Status | Rev Date |
| PRELIMINARY STUDY | | | | P | - |
| AMENDMENTS: | | | | P | A |
| - Well size reduced from 600mm to 500mm | | | | | |
| AMENDMENTS: | | | | P | B 03/03/21 |
| Ramp length and construction amended; modular building pushed further 200mm from the face of the existing building. | | | | | |
| AMENDMENTS: | | | | P | C 08/03/21 |
| Ramp base & annotation amended | | | | | |
| AMENDMENTS: | | | | P | D 22/03/21 |
| MRI and link dims added. Suspended ceiling dim amended. | | | | | |
| AMENDMENTS: | | | | P | E 01/04/21 |
| Link Heights amended following site visit. | | | | | |
| AMENDMENTS: | | | | P | F 15/04/21 |
| Link Heights amended. Suspended ceiling omitted. | | | | | |

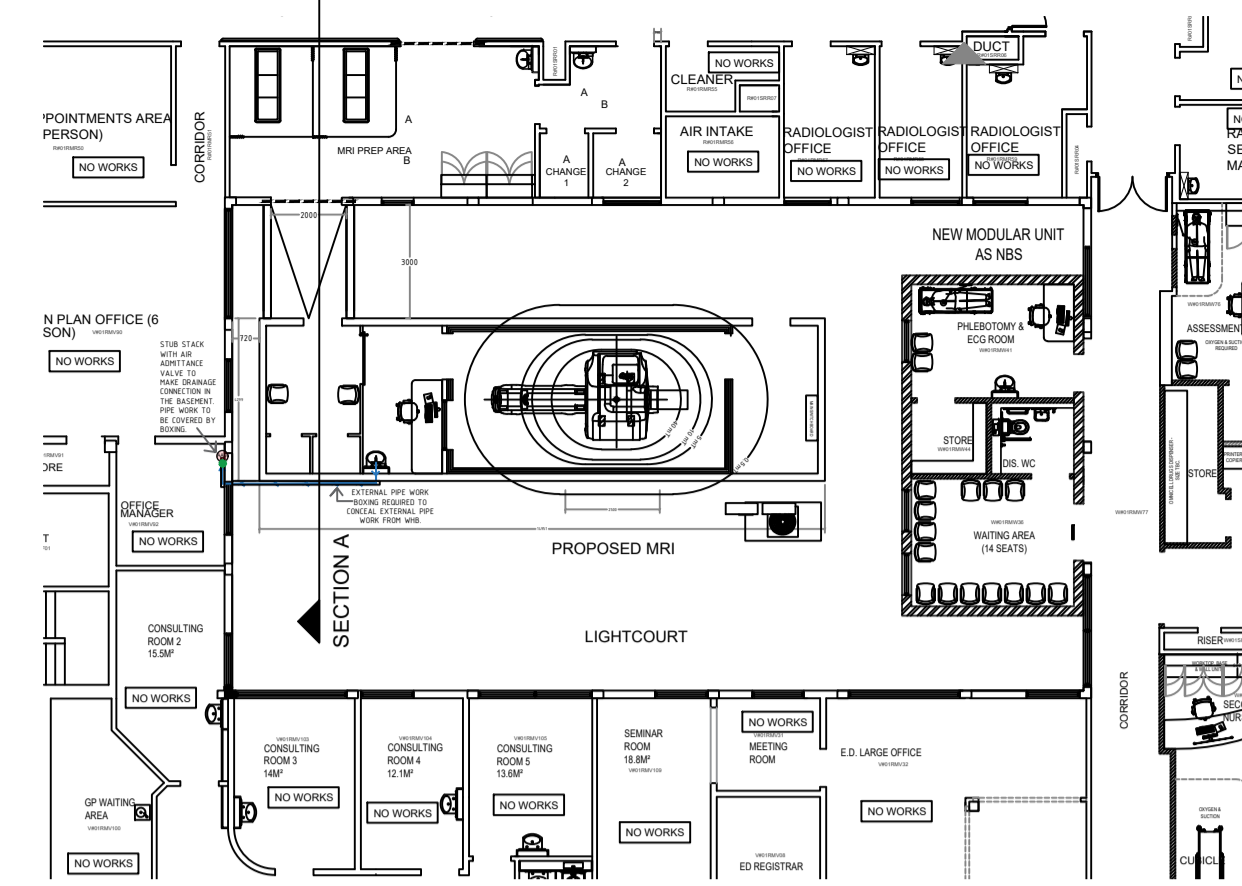

REFERENCE PLAN
1:200

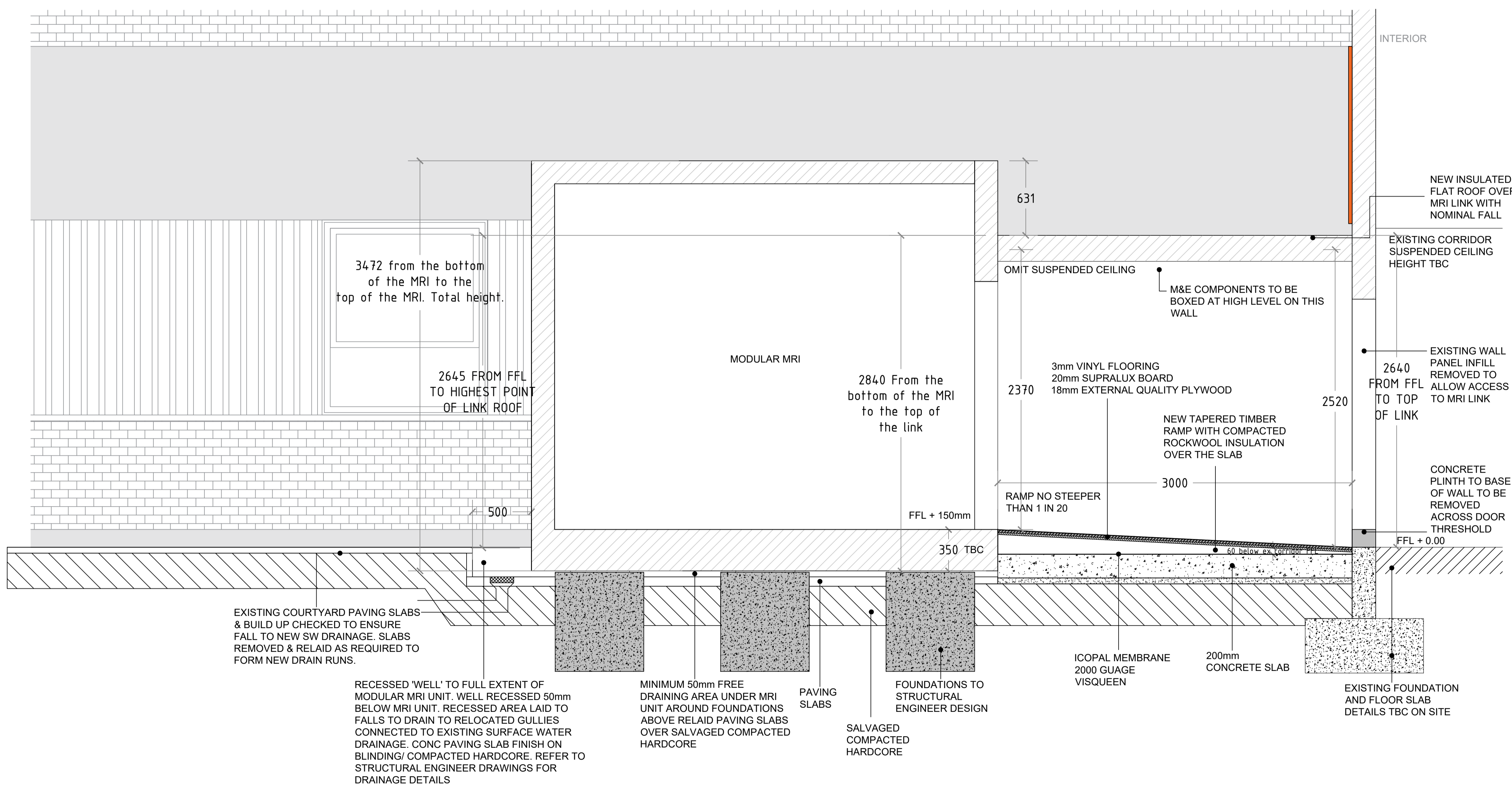

PROPOSED SECTION A
1:20

Drawing status annotation
P-Preliminary T-Tender D-Design (post preliminary) C-Construction As-Built

Client
BARNSELY HOSPITAL NHS
FOUNDATION TRUST

Project title
MODULAR MRI

Project no
170/032

Drawing title
EXISTING AND PROPOSED
COURTYARD SECTIONS

Drawing no
(0-100)02

| | |
|--------|----------|
| Status | Revision |
| P | F |