

Road 1

Chainage	Existing Ground Level	Proposed Road CL Level	Cut & Fill Differential
0	81.111	81.111	0.00
5	81.123	81.123	0.04
10	81.205	81.205	0.73
15	81.289	81.289	0.88
20	81.373	81.373	1.07
25	81.456	81.456	1.17
30	81.539	81.539	1.26
35	81.623	81.623	1.12
40	81.706	81.706	1.10
45	81.789	81.789	1.16
50	81.873	81.873	0.05
55	81.956	81.956	0.54
60	82.039	82.039	1.16
65	82.123	82.123	1.23
70	82.206	82.206	1.23

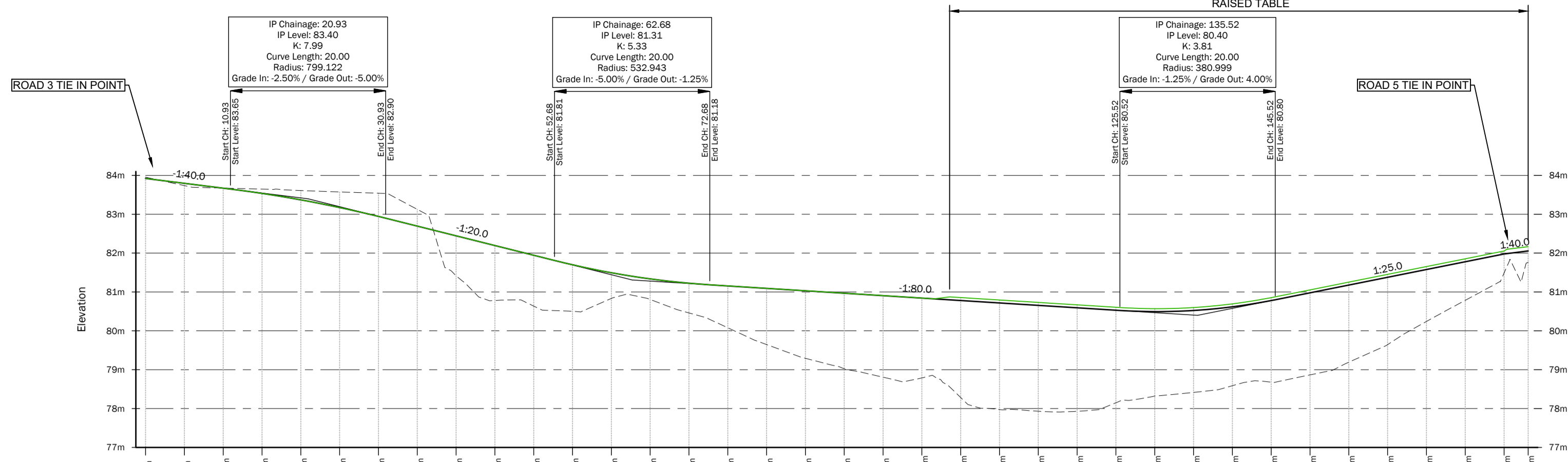

Road 2

Chainage	Existing Ground Level	Proposed Road CL Level	Cut & Fill Differential
0	83.797	83.797	0.00
5	83.738	83.738	0.00
10	83.674	83.674	0.00
15	83.536	83.536	0.00
20	83.511	83.511	0.00
25	83.574	83.574	0.00
30	83.540	83.540	0.00
35	83.126	83.126	0.00
40	81.415	81.415	0.00
45	80.782	80.782	0.00
50	80.638	80.638	0.00
55	80.501	80.501	0.00
60	80.534	80.534	0.00
65	80.507	80.507	0.00
70	80.460	80.460	0.00
75	80.079	80.079	0.00
80	79.647	79.647	0.00
85	79.293	79.293	0.00
90	79.022	79.022	0.00
95	78.807	78.807	0.00
100	78.787	78.787	0.00
105	78.583	78.583	0.00
110	77.975	77.975	0.00
115	77.831	77.831	0.00
120	77.530	77.530	0.00
125	78.149	78.149	0.00
130	78.521	78.521	0.00
135	78.415	78.415	0.00
140	78.588	78.588	0.00
145	78.680	78.680	0.00
150	78.866	78.866	0.00
155	79.193	79.193	0.00
160	79.645	79.645	0.00
165	80.241	80.241	0.00
170	80.786	80.786	0.00
175	81.489	81.489	0.00
180	82.167	82.167	0.00

THIS DRAWING IS TO BE READ IN CONJUNCTION WITH ALL OTHER HBL DRAWINGS ISSUED FOR THIS PROJECT

**LONGITUDINAL SECTION NOTES:**

- THE CONTRACTOR SHALL ESTABLISH EXACT LEVELS OF THE EXISTING FOUL AND SURFACE WATER SEWERS AND/OR PROPOSED LEVEL AT DISCHARGE POINT, PRIOR TO THE COMMENCEMENT OF ANY DRAINAGE WORKS.
- THE CONTRACTOR MUST ENSURE THAT THE GRADIENTS INDICATED ON THE LONGITUDINAL SECTIONS ARE CHECKED BEFORE THE LEVELS SHOWN, PRIOR TO LAYING PIPES. AT NO TIMES MUST THE CONTRACTOR PROCEED WITH PIPE LAYING BY DIALLING THE GRADIENT SHOWN INTO A LASER WITHOUT CHECKING. ANY DISCREPANCY IN THIS RESPECT MUST BE REPORTED TO THE ENGINEER PRIOR TO PIPE LAYING.
- THE CONTRACTOR SHALL CHECK HIS PIPE GRADIENTS BY MEANS OF PROFILES AND TRAVELLER TO VERIFY THE LASER GRADIENTS.
- IN THE EVENT OF THE ABOVE PROCEDURES NOT BEING FOLLOWED, THE CLIENT WILL ACCEPT NO RESPONSIBILITY WHATSOEVER FOR ANY CONSEQUENTIAL LOSS OR DAMAGE.
- THE CONTRACTOR IS RESPONSIBLE FOR ENSURING THAT ALL WORKS ARE TO THE SATISFACTION OF THE ENGINEER AND SHALL BE DEEMED TO HAVE INCLUDED WITHIN HIS RATES FOR ANY NECESSARY TESTING.
- ALL PIPES SHALL BE LAID WITH SOFFITS LEVEL UNLESS OTHERWISE SPECIFIED.
- ALL ADAPTABLE DRAINAGE MUST BE LAID IN ACCORDANCE WITH THE DCG SECTION C CURRENT EDITION, TOGETHER WITH THE SEWERAGE UNDERTAKER'S REQUIREMENTS.

**KEY - SECTIONS**

--- EXISTING SURFACE TOPOGRAPHICAL SURVEY S10840-3D

— PROPOSED FINISHED SURFACE

WORKS WITHIN EXISTING HIGHWAY ARE SUBJECT TO SECTION 278 AGREEMENT. VEHICLE CROSSOVER AND/OR BELLMOUTH AGREEMENTS WILL BE REQUIRED WITH THE LOCAL AUTHORITY. ALL LICENSES SHOULD BE AGREED WITH THE LA BY CONTRACTOR PRIOR TO ANY WORKS

ANY WORKS UNDERTAKEN PRIOR TO RECEIPT OF TECHNICAL APPROVAL FOR THEIR RESPECTIVE PROPOSALS IS DONE AT THE CONTRACTOR'S OWN RISK.

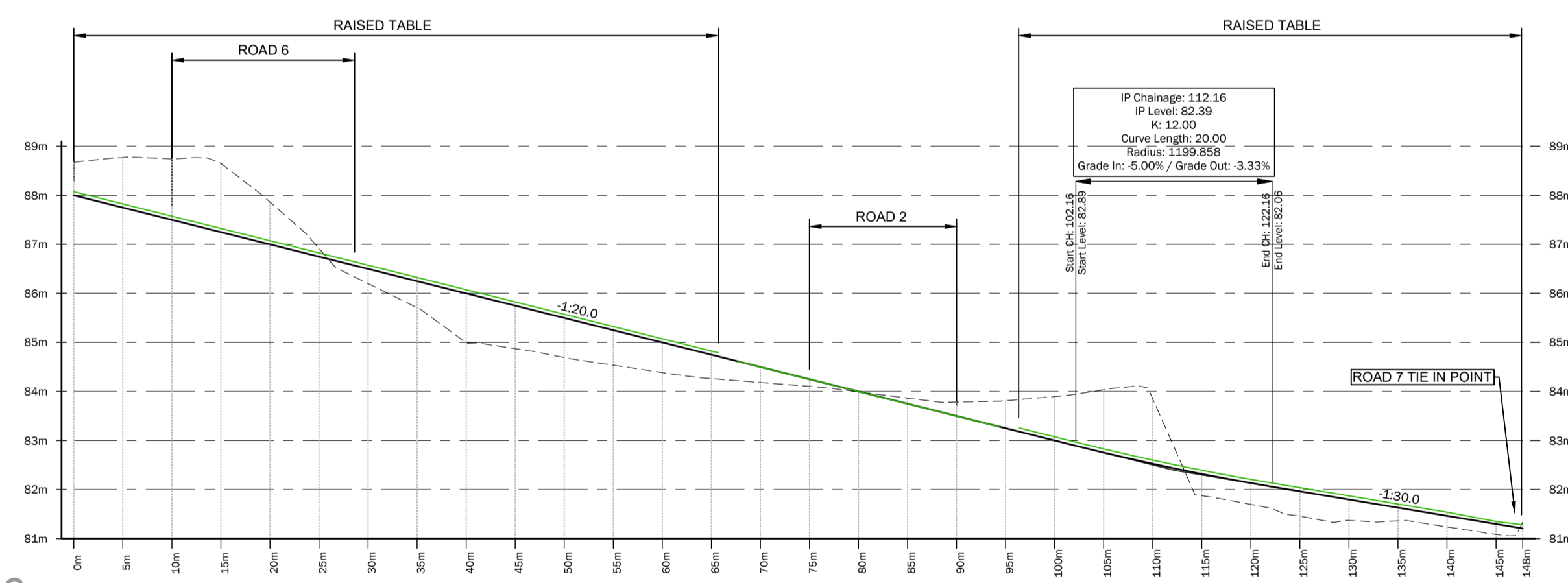

Road 3

Chainage	Existing Ground Level	Proposed Road CL Level	Cut & Fill Differential
0	85.712	85.712	0.00
5	85.725	85.725	-0.95
10	85.744	85.744	-1.17
15	85.850	85.850	-1.33
20	85.863	85.863	-0.79
25	85.916	85.916	-0.09
30	85.901	85.901	0.37
35	85.707	85.707	0.62
40	84.984	84.984	1.08
45	84.873	84.873	0.95
50	84.692	84.692	0.88
55	84.536	84.536	0.79
60	84.386	84.386	0.69
65	84.262	84.262	0.56
70	84.183	84.183	0.32
75	84.105	84.105	0.15
80	83.993	83.993	0.01
85	83.864	83.864	-0.11
90	83.784	83.784	-0.28
95	83.811	83.811	0.52
100	83.897	83.897	0.51
105	84.035	84.035	-1.21
110	83.848	83.848	-1.25
115	83.877	83.877	0.52
120	83.897	83.897	0.51
125	84.159	84.159	0.58
130	84.370	84.370	0.50
135	84.361	84.361	0.34
140	84.236	84.236	0.30
145	84.086	84.086	0.26
150	84.334	84.334	-0.05

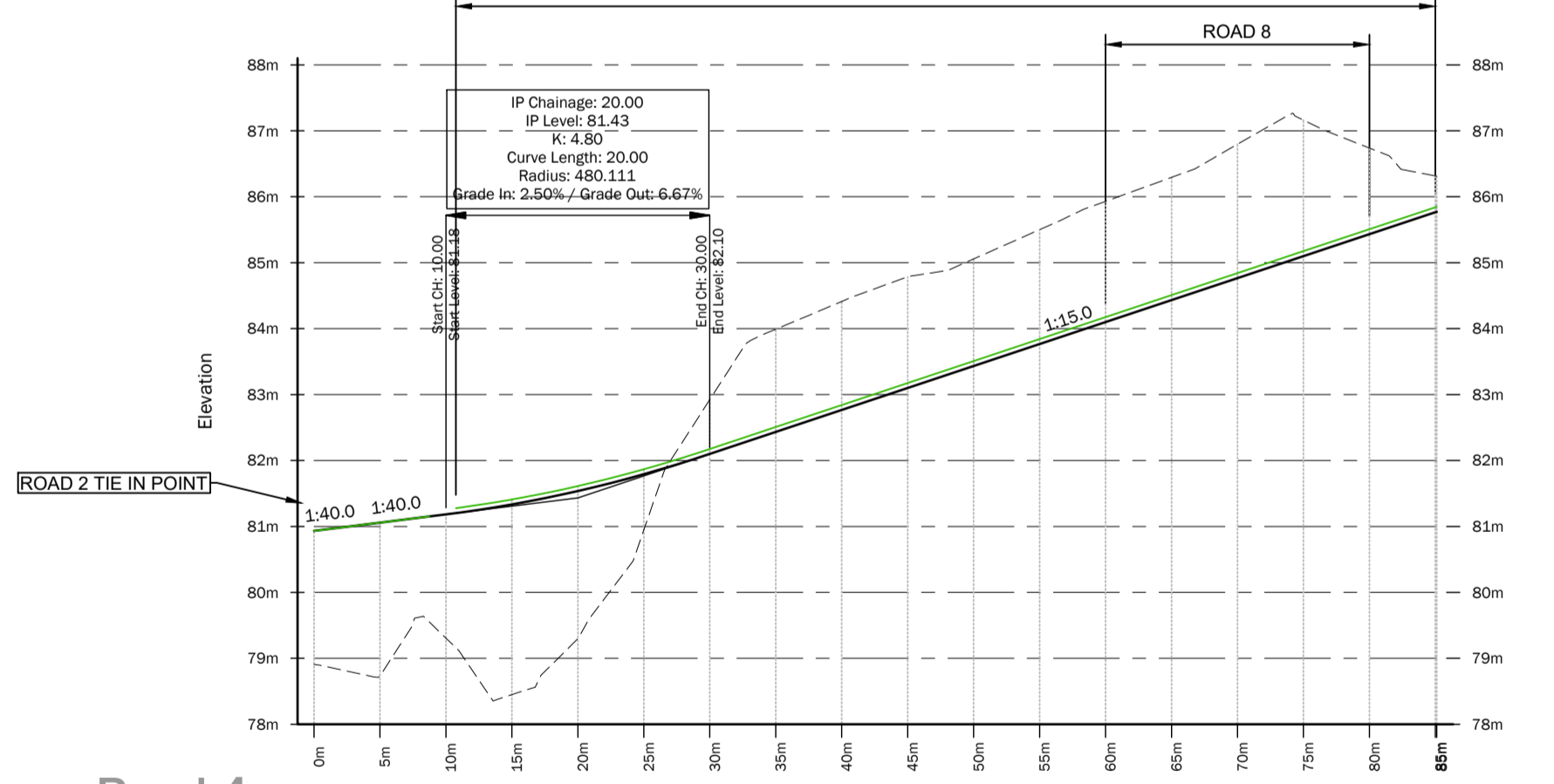

Road 4

Chainage	Existing Ground Level	Proposed Road CL Level	Cut & Fill Differential
0	76.937	76.937	0.00
5	76.721	76.721	2.33
10	79.307	79.307	2.33
15	78.461	78.461	2.96
20	79.297	79.297	2.31
25	80.945	80.945	0.92
30	82.524	82.524	-0.75
35	83.951	83.951	-1.48
40	84.411	84.411	-1.57
45	84.744	84.744	-1.61
50	85.056	85.056	-1.55
55	85.501	85.501	-1.66
60	85.930	85.930	-1.76
65	86.293	86.293	-1.79
70	86.796	86.796	-1.96
75	87.162	87.162	-1.99
80	86.739	86.739	-1.23
85	86.312	86.312	-0.48

REV.	DATE	DRAWN	DESCRIPTION	CHKD	APPRD
P01	06.03.26	RJ	REVISED FOR S38 APPROVAL	RJ	RJ

STATUS DESCRIPTION: **FOR TECHNICAL APPROVAL**

STATUS: **S4**



PROJECT: <b>WOOLLEY COLLIERY</b>	
DRAWING TITLE: <b>S38 ROAD LONGSECTIONS SHEET 1</b>	
CLIENT: <b>MJ GLEESON</b>	
HBL REF: <b>10701</b>	DATE: <b>29.09.25</b>
SCALE(S): <b>H:1:500 V 1:100</b>	<b>A1</b>
DRAWN: <b>MS</b>	CHECKED: <b>RJ</b>
APPROVED: <b>RJ</b>	
DRAWING No. <b>10701-HBL-XX-XX-DR-C-5350</b>	REV. <b>P01</b>