

NOTES

- 1 ALL WORK TO BE CARRIED OUT IN ACCORDANCE WITH THE BUILDING REGULATIONS AND THE REQUIREMENTS OF THE LOCAL AUTHORITY.
 - 2 NO DIMENSIONS TO BE SCALED FROM THIS DRAWING.
 - 3 THE CONTRACTOR SHALL VERIFY ALL LEVELS AND DIMENSIONS ON SITE BEFORE COMMENCEMENT OF WORK.
 - 4 ON SITE ALTERATIONS TO THE CONSTRUCTION OR FINISHES SHOWN OR IMPLIED ON THIS DRAWING MUST BE DRAWN TO THE ATTENTION OF THE ARCHITECT BEFORE SUCH WORK IS IMPLEMENTED.
 - 5 ALL TIMBERS REQUIRE PRESERVATIVE TREATMENT
- © COPYRIGHT RESERVED

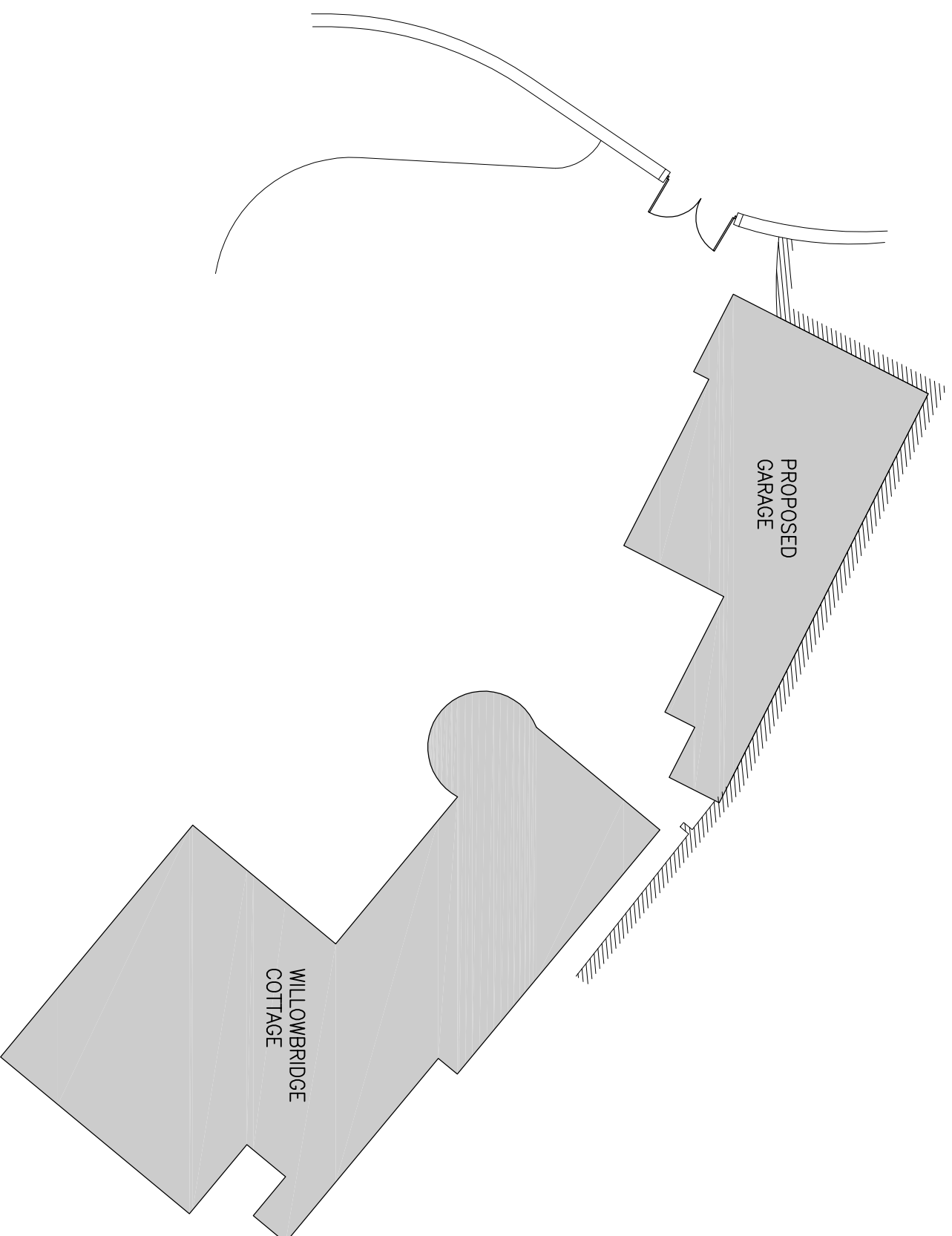
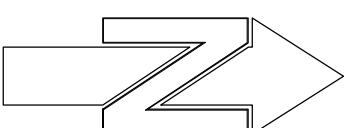

Rev	Date	Details

Drawing Status:

PRELIMINARY

**Progressive
Design & Build**

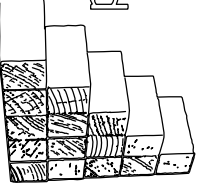

4 Lewisham Road, Sloughville, West Yorkshire HD7 5AL. Tel: 01484 846786

Client:

Matthew Robinson

Site:

**Willow Bridge Cottage
Sheffield Road
Barnsley S36 8YW**

Drawing Title:

Block Plan

Project Number: Drawing Number: Revision:

P781 03 -

Date: 28-07-15 Scale: 1:200 @ A3 Drawn: CC