



Preliminary Ecological Appraisal

Planning Application for the Development of Houghton Main Renewable Energy Park (comprising a Timber Resource Recovery Centre and an Anaerobic Digestion Facility) Including Associated Infrastructure.

Peel Environmental Management (UK) Limited and Houghton Main Waste Limited

'Experience and expertise working in union'

enzygo.com



Contact Details:

Enzygo Ltd.
Unit 24,
Singleton Court Business Park
Wonastow Road Industrial Estate
Monmouth
NP25 5JA

tel: 01600 719838
fax: 01600 716744
email: kirsty.rogers@enzygo.com
www: enzygo.com

Application for the Development of Houghton Main Renewable Energy Park (REP) comprising a Timber Resource Recovery Centre (TRRC) and an Anaerobic Digestion Facility (AD) Including Associated Infrastructure on Land off Houghton Main Colliery Roundabout, Park Spring Road, Houghton Main, Barnsley

Project:	Preliminary Ecological Appraisal
For:	Peel Environmental Management (UK) Limited and Houghton Main Waste Limited
Status:	Final
Date:	09 th May 2014
Author:	Kirsty Rogers MZoo GradCIEEM – Consultant Ecologist
Reviewer:	Chris Formaggia BSc(Joint Hons) CBiol CEnv MBS MCIEEM – Director of Ecology

Disclaimer:

This report has been produced by Enzygo Limited within the terms of the contract with the client and taking account of the resources devoted to it by agreement with the client.

We disclaim any responsibility to the client and others in respect of any matters outside the scope of the above.

This report is confidential to the client and we accept no responsibility of whatsoever nature to third parties to whom this report, or any part thereof, is made known. Any such party relies on the report at their own risk.

Contents

Contents.....	2
Executive Summary	3
1.1. <i>Commission</i>	4
1.2. <i>Site Details</i>	4
2.0 Methodology.....	7
2.2 <i>Enzygo Ltd Ecology Experience</i>	7
2.3 <i>Survey Objectives</i>	7
3.0 Results.....	8
4.0 Conclusions	14
Appendix 1 –Phase 1 habitat and key	15
Appendix 2 – Director’s CV	16
Appendix 3 – Data Search Summary	17

Executive Summary

- i. A Preliminary Ecological Appraisal of the site was conducted in February 2014
- ii. The site habitat appears to have low intrinsic ecological value but may be valuable for lower plants (to be verified).
- iii. The site is expected to contain some protected species and Phase II surveys are recommended for the 2014 season to determine these.
- iv. There is potential to offer habitat connectivity/biodiversity gains on the peripheries of the site in conjunction with local biodiversity initiatives.

1.0 Introduction

1.1. Commission

- 1.1.1. Enzygo Ltd was commissioned to conduct a preliminary ecological appraisal (PEA) for the proposed Houghton Main Renewable Energy Park (REP) including the erection of an Anaerobic Digestion Facility (AD) and a Timber Resource Recovery Centre (TRRC) on land off Houghton Main Colliery Roundabout on the A6195, Park Spring Road. A previous Phase I Habitat Surveys have been conducted by SLR consulting Ltd, on behalf of Peel Environmental Management Ltd in March 2012.
- 1.1.2. The site was surveyed by Enzygo in February 2014. This was outside the normal timing window of May to September but was commissioned to refresh the 2012 SLR report whose shelf-life would otherwise expire and to check for any pronounced change in ecological base condition since March 2012.

1.2. Site Details

- 1.2.1. The approximate site centre is located on National Grid Reference SE 41693 06444, near Little Houghton, South Yorkshire, and at the far south-eastern point of the former Houghton Main Colliery site. The nearest postcode centre to the site is S72 0HN. The site was previously used for open cast mining up to 2001. Since the cessation of works a valid re-use of the site has been sought.

Photograph 1: View of the site, towards the north-east.



- 1.2.2. The northern boundary of the site is comprised of a dismantled colliery railway, boarded by a sparse, specie-poor, immature hedgerow. The eastern edge of the site is comprised of wire fence and immature blackthorn hedge which separates the site from the A4195 (Park Spring

Road). The south of the site is boarded partly by a new electricity generating compound, which utilises the same access point as the proposed site. Finally the western border of the site is made up of fencing and an intact hedgerow.

- 1.2.3. Beyond the site runs the River Dearne, at the north western corner of the site.
- 1.2.4. Beyond the immediate peripheries, the site is boarded by arable grassland (to the west) and a Dearne Valley RSPB reserve to the north, separated from the site by a small semi improved grassland field, with sparse scrub and plantation woodland. Towards the east is a large, and well used warehouse/distribution centre.
- 1.2.5. The sites proposed red-line boundary of the site is shown on **Figure 1.1**.

Figure 1.1 Red-line boundary of the proposed development site.

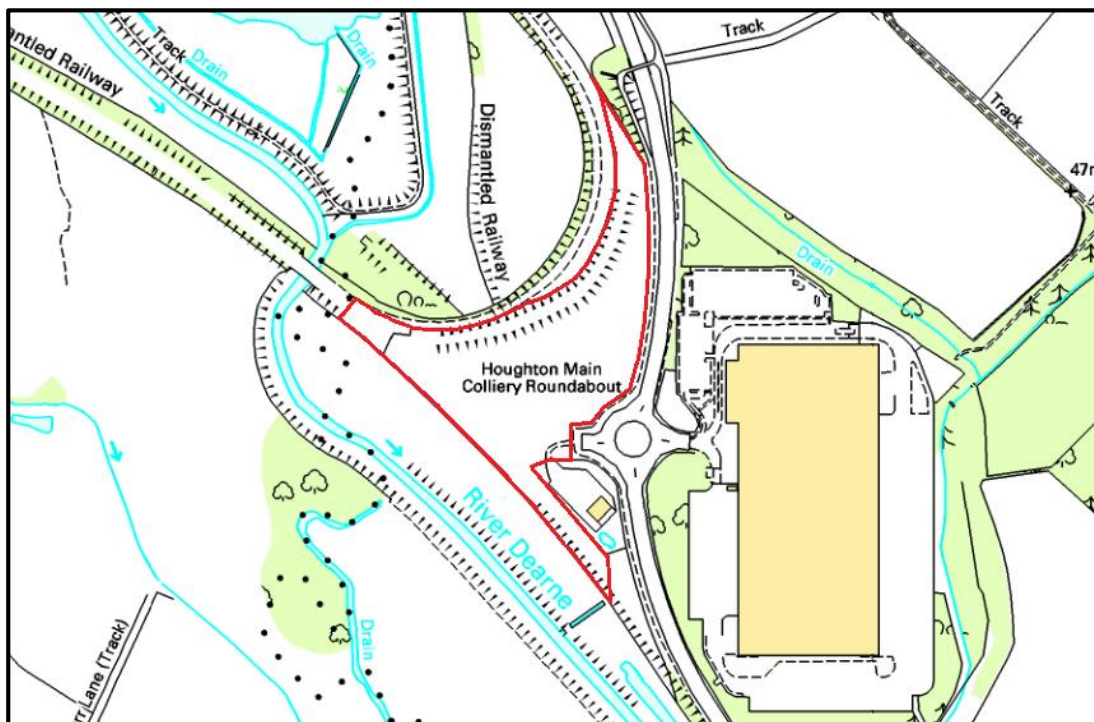

- 1.2.6. A 1:7176 scale habitat map based upon the conventions of the JNCC Phase 1 Habitat Survey₁ is attached in *Appendix 1* of this report.
- 1.2.7. The site was assessed outside the normal timing window that would be considered optimal for the conduct of this type of evaluation (April to September) so the survey is constrained as some vegetation would not be visible at the time of survey.

Photograph 2: View of the site and neighbouring electricity generating compound, towards the south.



Photograph 3: View of the dismantled railway, forming the northern boundary.



Handbook for Phase I Habitat Survey – a Technique for Environmental Audit. (2003) JNCC. Peterborough. ISBN 0-86139-636-7

2.0 METHODOLOGY

2.1 Survey Details

- 2.1.1 The site was surveyed on 4th February 2013 The site was visited and the vegetation was mapped onto an Ordnance Survey Mastermap (scale 1:7176) using standard colour codes for the ninety plus specified habitat types as defined in the JNCC guidelines. The surrounding land was similarly mapped but third-party land was only accessed where open and is assessed on the basis of what could be viewed from publically accessible areas.
- 2.1.2 Target notes were made for particular areas of interest and annotated.
- 2.1.3 An ecological walkover survey of the site was also conducted. The survey looks for direct and indirect evidenced (through sightings or field signs) of protected species and speculates on likely presence based upon habitat type and quality.
- 2.1.4 In addition to the ecological walkover survey, the presence of flora included within Schedule 9 of the Wildlife and Countryside Act 1981) (as amended) was investigated on site.

2.2 Enzygo Ltd Ecology Experience

- 2.2.1 This study and the site survey were conducted by Kirsty Rogers MZoo GradCIEEM under the management of Christopher Formaggia BSc (Joint Hons) CBiol CEnv MBS MIEEM MBPR (aquatic) – Director of Ecology. The Director of Ecology has been a professional ecologist for 22 years both as a regulator and consultant. He has held senior positions in environmental protection and management and is and experienced field ecologist. A CV describing his experience is provided in *Appendix 2*.

2.3 Survey Objectives

- 2.3.1 On the basis of the brief provided by the client Enzygo Ltd has conducted an ecological study:
- To determine the baseline ecological value of the site.
 - To determine the baseline ecological constraints that might require further evaluation with respect to any site development.
 - Advice on further ecological evaluation that might be necessary.

2.4 Survey Area

- 2.4.1 The appraisal has considered the whole of the site and its immediate peripheries where visible/accessible.

3.0 RESULTS

3.1 Phase 1 Habitat Mapping

- 3.1.1 The completed Phase 1 Habitat map is presented in *Appendix 1*.
- 3.1.2 The overall area of the site is approximately 4.14 Hectares.
- 3.1.3 There is an approximate 45% covering of scattered scrub (**A2**) on site. The dominant species is immature silver birch (*Betula pendula*), with occasional examples of goat willow (*Salix caprea*) and oak species (*Quercus*) scattered throughout.
- 3.1.4 The second prominent habitat on site is restored poor semi-improved grassland (**B6**) across around 40% of the site.
- 3.1.5 There is approximately 0.12 hectares of broadleaved woodland (**A1**) in the far north-western corner of the site comprised of crack willow (*Salix fragilis*), hawthorn (*Crataegus monogyna*), blackthorn (*Prunus spinosa*) and small quantities of elder (*Sambucus nigra*). The understory was comprised predominantly of bramble (*Rubus fruticosus*) and common nettle (*Urtica dioica*).
- 3.1.6 Towards the centre of the site there is a small area (approximately 5%) of acid flush (**E2.1**) comprised of species of sphagnum moss (*Sphagnum sp.*) and bulrush species (*Typha sp.*)

Photograph 4: View of the acid flush.



- 3.1.7 Immediately alongside the northern boundary is an area (~0.71 hectare) of mature semi natural broadleaved woodland, situated between the proposed site and the River Dearne. The woodland was comprised of similar species as the area of woodland on site, with occasional mature silver birch and ash (*Fraxinus excelsior*).

- 3.1.8 The western border of the site is comprised of hedgerow with trees (**J3.2**) emerging from woodland at its northern most point and becoming increasingly defunct towards the south of the site. The hedgerow is comprised both mature and immature specimens of silver birch, goat willow, oak, elder, hawthorn, blackthorn and hazel (*Corylus avellana*).
- 3.1.9 The eastern border of the site is made up of defunct immature hedge (**J2.2**) comprised of chiefly of blackthorn (*Prunus spinosa*).
- 3.1.10A small section to the south of the site, surrounding the electricity generating compound, is made up of introduced shrub (**J1.4**).
- 3.1.11The wider habitat includes areas of plantation woodland (**A1**) at the sites north eastern corner, standing water (**G1**), running water (**G2**) (River Dearne) and semi-improved grassland.

3.2 Habitat Quality Assessment

- 3.2.1 The majority of the site comprises of land of relatively low ecological value (restored poor semi-improved grassland, and encroaching scrub).
- 3.2.2 The woodland that borders areas of the site is generally uniform in age structure.
- 3.2.3 A number of small ponds are within a 500m boundary of the site, one of which is considered in a good condition and has the potential to support great crested newts (*Triturus cristatus*), (see *Appendix 4* for HIS scores).
- 3.2.4 The hedgerow along the west of the site is generally intact although patchy in places. In places the hedgerow is more species rich but lacks management. It is considered a few sections of hedge would likely qualify as “important” under the biological element of the Hedgerow Regulations (1997).
- 3.2.5 The patch of acid rush in the centre of the site is not ecologically important.

3.3 Desk Study

- 3.3.1 A 2km interrogation of the DEFRA Magic database and Barnsley Biological Records Centre (see *Appendix 3*) revealed the following nationally important designated sites:
- West Haigh Wood at ~1.6km from the proposed site boundary, designated as a Local Nature Reserve (**LNR**).
 - Carlton Main Brickworks, located approximately 1.3 km from the proposed site boundary, designated as a geological Site of Special Scientific Interest (**SSSI**).

Note: There are also 4 further Natural Heritage Sites (Barnsley) which are of county importance, with the 2km search area. These are; Edderthorpe Ings (~0.2km from the site boundary), Sunny Bank, Horse Carr and Storrs wood (~1.1km to the west of the site boundary), a section of West Haigh Wood (~0.9 km from the site boundary) and Houghton Marsh (located ~ 0.9km south of the proposed site boundary).

3.4 Protected Species Audit

Bats

3.4.1 There is limited roosting potential within the site itself due to the immaturity of the trees located throughout; however there is some potential within the wider environment and immediate habitats. The mature woodland at the northern boundary of the site and beyond the site boundary has potential for bat roosts in the form of old woodpecker holes, cracks and crevices. There is also roost potential for bats within the bridge over the River Dearne and limited potential for bats within the electricity compound to the south of the site.

Photograph 4: View of mature woodland with woodpecker holes (highlighted).



3.5.1. There are 15 records of bat species within the 2km search buffer from the sites peripheries, 7 of the records are made up of pipistrelle species (*Pipistrellus spp.*) sightings, the most recent in 2005. There is also one record of a noctule bat (*Nyctalus noctula*) and a record of a Daubenton's bat (*Myotis daubentoni*) within the buffer area; both were noted over a decade ago. The remaining records are comprised of bat records which could not be identified to species level.

3.5.2. Birds

With the site boundaries a number of nests seen within the hedgerows, introduced shrub and scrub on site expected to contain nesting common farmland birds. A number of species were seen on site Eurasian magpie (*Pica pica*), European robin (*Erithacus rubecula*), great tit (*Parus major*), blue tit (*Cyanistes caeruleus*), herring gull (*Larus argentatus*), wood pigeon (*Columba palumbus*) and jackdaw (*Corvus monedula*) on the site during the survey period.

The site offers a good range of habitats for nesting bird species, particularly the peripheries. The wider environment is considered of national and county importance for a large number of bird species. Within the 2km buffer zone, there are over 250 records of 28 bird species that are included on the “Birds of conservation concern 3”² red list and 700 records of 67 bird species noted on the amber list (see *Appendix 3, Table 3.2* and *3.3* for full summary).

3.5.3. Badgers

The site itself offers few resources to support a badger (*Meles meles*) population. No setts were located on site. Further there was limited secondary evidence to suggest a badger population is utilising the site, such as no obvious scratching posts, signs of foraging, dung and latrines or badger hairs in caught in any of the boundary fences. There was evidence of animal tracks and paths cutting from the south to east of the site (see *picture 5*) however this cannot be confidently identified to species level.

There are no records of badgers within the 2km buffer zone of the site area.

Picture 5: View of animal track/ path cutting across the site from the south entrance towards the eastern border.

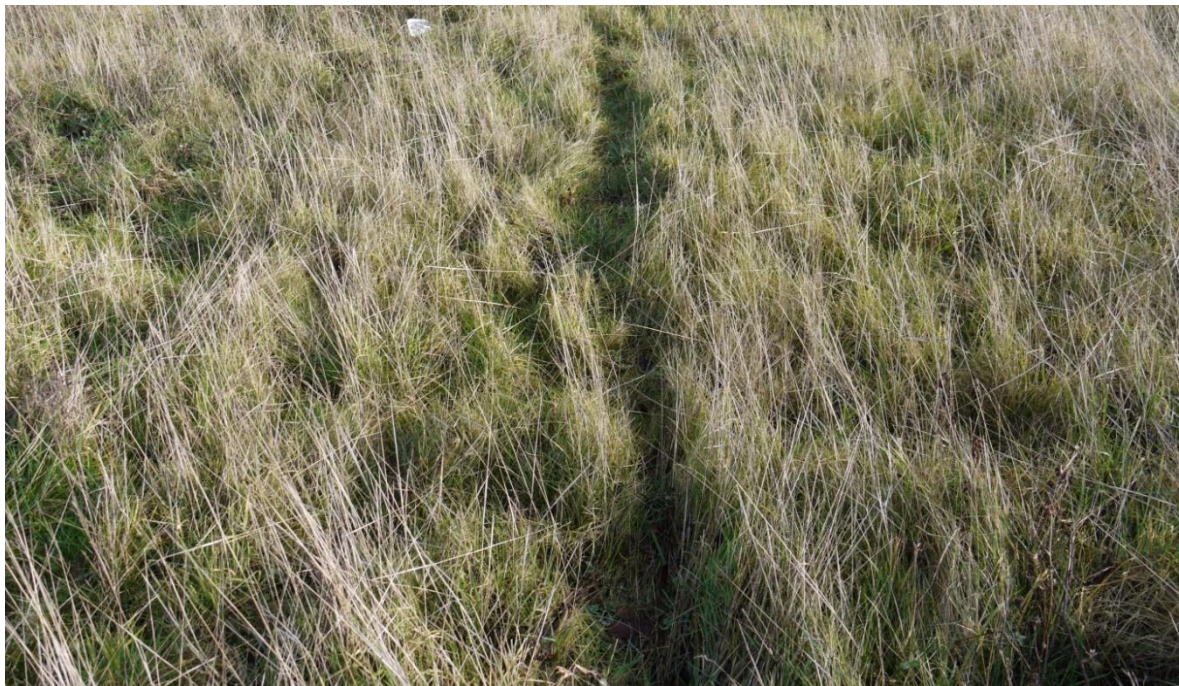

²Eaton MA, Brown AF, Noble DG, Musgrove AJ, Hearn R, Aebischer NJ, Gibbons DW, Evans A and Gregory RD (2009) Birds of Conservation Concern 3: the population status of birds in the United Kingdom, Channel Islands and the Isle of Man. *British Birds* 102, pp296–341.

3.5.4. Riparian species

The site itself offers no suitable habitat for riparian species; however there are 32 records of water vole (*Arvicola terrestris*) along the river Dearne, within the 2km buffer of the site boundary (the most recent in 2012) and a further 4 records of otters (*Lutra lutra*) within the same area.

3.5.5. Reptiles

The site offers areas of good quality reptile habitat (rough grassland, hedgerows and scrub habitat), with good connections to further suitable habitat, through the dismantled rail corridor and the river Dearne riparian corridor.

The data search provide a single record of a reptile, viviparous lizard (*Lacerta vivipara*) within 2km of the site, this was approximately 1km away from the site boundary directly along the rail corridor.

3.5.6. Amphibians

The site itself contains no waterbodies, or habitats which are suitable to support breeding amphibians. However, there are 5 waterbodies in 500m of the site boundary, one of which holds a high HIS score (see *SLR Phase 1 Habitat Survey, 2012*) which hold potential to support a number of amphibian species. The site does offer rough grassland, hedgerows and scrubland which may be attractive terrestrial habitat for some amphibians.

There are 12 records of amphibians within the 2km buffer area of the site, 5 records of common toad (*Bufo bufo*), 2 records of common frog (*Rana temporaria*) and 5 records of smooth newt (*Triturus vulgaris*)

3.6. Recommendations

3.6.1. It is recommended on the basis of this survey that the following further works should follow:

- *Bat Activity Survey*

Although none of the trees with the site are mature enough to support bat species, a number of trees alongside the survey boundary hold potential to sustain a number of roost spaces for various bats species. It is recommended to conduct a bat activity survey over the site for 3 evenings over 3 months, between the months of April to September to assess the significance of the site for neighbouring bats.

- *Badger Survey*

Even though neither the site nor its boundaries hold any badger setts, the site holds potential for badger species with limited evidence to support the potential for badger activity within the site. It is recommended to conduct a full badger survey, which will comprise of a walkover of the sit to inspect for signs of badger use (such as; badger setts, bedding materials, scratching posts, badger hairs, signs of foraging, dung and latrines and/or badger tracks and paths) or the suitability of any entrance holes to support badger setts and/or locate any setts present or near to the construction footprint. The optimal survey period for a badger survey is between March to November, and should be conducted within 6 months of the start date of construction.

In the event of a badger sett being identified within the site, a licence application would be required and submitted prior to works to avoid committing an offence under the Protection of Badgers Act 1992.

- *Breeding bird Survey*

A number of bird's nests were located across the sites boundary hedgerows, with a number of birds seen over the during the survey period. A breeding bird survey is advised to be conducted in 2014 to inform the proposal.

- *Reptile Survey*

Due to the suitable habitat found throughout the site to support reptile species, it is recommended that a comprehensive reptile survey is conducted in order to assess the sites appeal for reptile species. Typically the optimum survey period to assess reptile activity would be between April to May and September. The survey would consist of a number of checks to artificial refugia placed throughout the site during the survey period to assess the presents of a population and the population density within the site.

In the event of the discovery of a reptile population of site, a licence application would be required and submitted prior to works to avoid committing and offence under the Wildlife and Countryside Act 1981, in order to conduct mitigation works.

- *Great Crested Newt Survey*

Although the site itself does not contain any waterbodies, 5 waterbodies were identified during SLR's 2012 survey of the site. Upon assessment, only one of the waterbodies was identified to hold potential for supporting great crested newts (*Triturus cristatus*). However, it is recommended that if third party access can be gained that eDNA tests of the ponds be conducted to determine presence/absence of the species.

- *Problematic Species Survey*









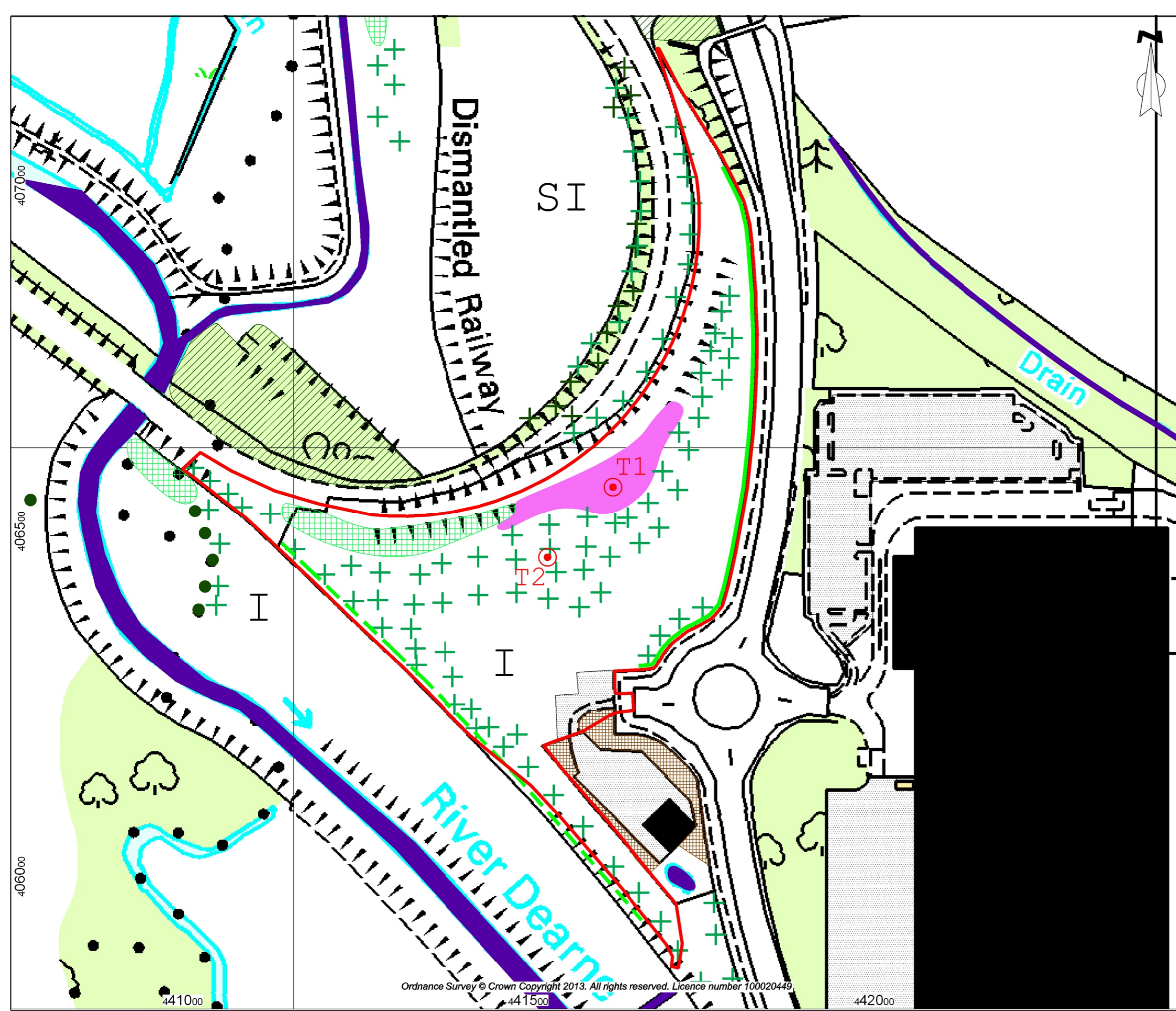





It is also recommended to conduct a complete Problematic Species Survey within the site. During SLR's 2012 Phase 1 Assessment, a quantity of Himalayan balsam (*Impatiens glandulifera*) was recorded along the peripheries of the site. A further survey is encouraged to assess the full quantity and the potential for its encroachment on to the site. Due to the free access to the site from the A6195 (Park Spring Road) at both the south east and north east corners of the site, the survey will also identify any other problematic species (e.g. Japanese knotweed, *Fallopia japonica*) which may have been introduced to the site through fly tipping or recreational activities.

4.0 CONCLUSIONS

- i. The proposal site is surrounded by land of agricultural value. The relative nature conservation value of the proposal site appears to be low and the site is considered to contain habitats and flora that are at most of local nature conservation significance, although this assessment will be revised after a full survey for lower plant species is undertaken in the summer of 2014.
- ii. There are important ecological areas on the immediate peripheries of the site including an RSPB nature reserve. Locally there are environmental initiatives underway to maximise the value of important habitat in the area. It may be possible to offer habitat linkage opportunities through planting on site.

APPENDIX 1 – PHASE 1 HABITAT AND KEY



- Key**
-  Site Boundary
 -  Building
 -  Target Note
 -  Bare Ground
 -  Broad-Leaved Plantation Woodland
 -  Scattered Broad-Leaf Tree
 -  Improved Grassland
 -  Semi-Improved Grassland
 -  Scattered Scrub
 -  Water
 -  Dense/Continuous Scrub.
 -  Acid/Neutral Flush
 -  Introduced Shrub
 -  Defunct hedge, species poor
 -  Intact, species poor hedgerow



STEP Business Centre, Wortley Rd, Sheffield, S36 2UH

CLIENT:
Peel Environmental Management (UK) Limited and Houghton Main Waste Limited

SCALE: 1:2,000@A3 PROJECT REF: CRM.066.001.001

DRAWN: SN CHECKED: LS DATE: May 2014

PROJECT:
Houghton Main

TITLE:
Phase 1 Habitat Plan

FIGURE NO:
Figure 1

Phase 1 habitat survey mapping colour codes

A - WOODLAND AND SCRUB		E - MIRE		I - ROCK EXPOSURE AND WASTE	
Green	Broad-leaved semi-natural woodland	Purple	Blanket bog	Scarlet red	Natural acid / neutral inland cliff
Green	Broad-leaved plantation woodland	Purple	Raised bog	Scarlet red	Natural basic inland cliff
True green	Coniferous semi-natural woodland	Purple	Wet modified bog	Scarlet red	Acid / neutral scree
True green	Coniferous plantation woodland	Purple	Dry modified bog	Scarlet red	Basic scree
Green over true green	Mixed semi-natural woodland	Magenta	Acid / neutral flush	Scarlet red	Natural limestone pavement
Green over true green	Mixed plantation woodland	Magenta	Basic flush	Scarlet red	Acid / neutral exposure
Green	Dense / continuous scrub	Magenta over purple	Fen	Scarlet red	Basic exposure
Green	Scattered scrub	Magenta over purple	Basic fen	Scarlet red	Cave
Green	Scattered broad-leaved tree	Magenta over purple	Valley mire	Scarlet red	Quarry
True green	Scattered coniferous tree	Magenta over purple	Basin mire	Scarlet red	Spoil
Green	Recently felled broad-leaved woodland	Magenta over purple	Flood-plain mire	Scarlet red	Mine
True green	Recently felled coniferous woodland	Magenta over purple	Bare peat	Scarlet red	Refuse-tip
Green / true green	Recently felled mixed woodland	F - SWAMP, MARGINAL AND INUNDATION		J - MISCELLANEOUS	
B - GRASSLAND AND MARSH		Sky blue	Swamp	No colour	Arable
Orange	Unimproved acid grassland	Sky blue	Marginal vegetation	Canary yellow	Amenity grassland
Orange	Semi-improved acid grassland	Sky blue	Inundation vegetation	Black	Ephemeral / short perennial
Orange	Unimproved neutral grassland	G - OPEN WATER		Terracotta	Introduced shrub
Orange	Semi-improved neutral grassland	Indigo blue	Standing water	Green	Native species-rich intact hedge
Orange	Unimproved calcareous grassland	Indigo blue	Eutrophic	Green	Species-poor intact hedge
Orange	Semi-improved calcareous grassland	Indigo blue	Mesotrophic	Green	Species-rich defunct / gappy hedge
No colour	Improved grassland	Indigo blue	Oligotrophic	Green	Species-poor defunct / gappy hedge
Purple over orange	Marsh / marshy grassland	Indigo blue	Dysotrophic	Green	Species-rich hedge with trees
No colour	Semi-improved grassland	Indigo blue	Marl	Green	Species-poor hedge with trees
C - TALL HERB AND FERN		Indigo blue	Brackish	True green	Coniferous hedge
Terracotta	Continuous bracken	Indigo blue	Running water	Black	Fence
Terracotta	Scattered bracken	H - COASTLAND		Scarlet red	Wall
Terracotta	Upland species-rich ledge	Zo	Intertidal Zostera beds	Scarlet red	Derelict wall
Terracotta	Tall ruderal	Ga	Intertidal green algal beds	Indigo blue	Dry ditch
Terracotta	Non-ruderal	Ba	Intertidal brown algal beds	Black	Boundary removed
D - HEATHLAND			Saltmarsh / dune interface	Black	Earth bank
Yellow ochre	Acid dry dwarf shrub heath	Pink	Scattered plants	Black	Caravan site
Yellow ochre	Basic dry dwarf shrub heath	Pink	Dense continuous saltmarsh	Black	Sea wall
Purple over yellow ochre	Wet dwarf shrub heath	Pink	Dune slack	Black	Building
Yellow ochre	Lichen / bryophyte heath	Indigo blue over flesh	Dune grassland	Black	Bare ground
Yellow ochre	Montane heath / dwarf herb	Orange over flesh	Dune heath	Scarlet red	Botanical target note
Orange over yellow ochre	Dry heath / acid grassland mosaic	Green over flesh	Dune scrub	Bright blue	Animal / Badger target note
Purple over yellow ochre	Wet heath / acid grassland mosaic	Flesh	Open dune	Green	Invertebrate target note
		Scarlet red	Maritime hard cliff		
		Scarlet red	Maritime soft cliff		
		Orange	Coastal grassland		
		Yellow ochre	Coastal heathland		

APPENDIX 2 – DIRECTOR’S CV

CURRICULUM VITAE

Name:	Christopher Formaggia
Position in Company:	Director of Ecology
Qualifications / Memberships:	BSc (Joint Hons) Zoology/ Environmental Studies Postgraduate Certificate in Management Royal Chartered Biologist CBiol Chartered Environmentalist CEnv Member of the Biological Society MBS Member of Institute of Ecology and Environmental Management MIEEM Associate Member of Emergency Planning Society BASIS qualified (Aquatics)
Date of Birth:	03 December 1966

Areas of Expertise:

Chris Formaggia has 22 years of professional experience in the fields of ecology, outdoor recreation and education and navigation within the regulatory, public and private sectors. He has particular expertise in the areas of wetland biology, biodiversity planning, environmental impact assessment, countryside recreation planning, species and habitat surveying, and habitat creation and restoration.

He has expertise of working on problems associated with invasive/alien species in marine, freshwater and terrestrial environments. As an invasion ecologist he has worked on aquatic and terrestrial plants, invasive vertebrates and was involved in the production of a marine biosecurity plan. His invasives experience is both ecological and practical and he has worked on a number of control programmes.

Chris's Recreation and Navigation experience includes the following:

- Management of Environment Agency recreation sites which ranged from small fisheries up to a International white water venue
- Production of recreation strategies
- Management of recreation conflict



- Public Enquiries
- Recreation demand studies/DDA analysis.
- Angling/Fisheries management
- Facility creation
- Conflict Resolution

Work History

Chris Formaggia is currently Director of Ecology with Enzygo Ltd.

He was formerly owner and Director of Formaggia Environmental Limited (and Formaggia Research Limited) and was responsible for all activities of the companies. Before setting up Formaggia Environmental Limited (and Formaggia Research Limited), Chris was Principal Ecological Consultant for RPS Planning, Transport and Environment Ltd. At RPS, Chris managed an ecology team split between offices in Chepstow and Milford Haven covering terrestrial, freshwater and marine ecology.

Prior to joining RPS Chris worked in local authority as Senior County Ecologist managing a local authority ecology unit. He was responsible for the provision of all of the council's internal and external ecological advice, its biodiversity planning, site management and an environmental education programme.

Chris has 13 years of experience with the National Rivers Authority/Environment Agency working at an area/regional and national level. He worked at Environment Agency Wales's Headquarters as Conservation, Recreation and Navigation (CRN) Officer for Wales and was responsible for all internal environmental assessment of Agency operations in Wales and for the development and implementation of all CRN policy. Prior to his headquarters' role Chris spent 8 years as an Area officer and was extensively involved in the assessment of consents and planning applications and major development schemes, aquatic survey work and species and habitat enhancement projects. He has substantial experience of working with protected species licences.

He sat on a number of government-level policy groups including the England and Wales River SSSI steering Group and the Wales Biodiversity Group. He was co-ordinator for a number of Species Plans within the UK Biodiversity Action Plan and represented the Agency on a further suite of habitat and species plans.

Major projects he was involved with included the "Wetlands for Wales" project which, at the time, was the largest successful HLF project to be initiated in Wales; the Review of the Dee Navigation and the internal re-structuring of the Environment Agency Wales EIA capability.

He was involved in two major Public Enquiries relating to the Usk Barrage and the Wye Navigation and a number of court procedures and planning enquiries.



Other Professional Interests

In recent years he has become increasingly interested in the ecological aspects of emergency planning, disaster relief, and conflict. He has attended a number of Home Office/Counter Terrorist courses and is an Associate Member of the Emergency Planning Society. He is a serving member of HM Reserve Forces and holds a number of higher level security clearances.

Experience Includes:

- River Habitat Surveyor and River Corridor Surveyor
- Management of ecology on major infrastructure projects
- Accredited electric fishing surveyor
- BASIS qualified and registered to sell and advice on crop protection.
- Holder of PA1 and PA6 amenity sprayer licences
- Substantial experience in advising on invasive species control especially Japanese knotweed, giant hogweed, Himalayan balsam, and aquatic invasives
- Expert experience on advising on wildlife crime matters especially in relation to the water environment
- Wetland creation/restoration and mitigation/compensation design
- Impacts of recreation/navigation on wildlife
- Woodland and coppice management.
- Appropriate Assessments and Conservation Regulations advice
- Waste facility development
- Environmental Supervision of major infrastructure projects
- Rebuttals, expert witness services and committee work.

Protected Species Licences:

Currently holds licences for bats, great crested newts, otters, dormouse, badgers and barn owls for England and Wales.

Have previously held licences for water vole and crayfish.

Has 20 years of practical experience with protected species working on enforcement, mitigation and enhancement at scales from local to international.

Experienced in obtaining Development Licenses from Natural England (formerly DEFRA) and Welsh Assembly Government. Services approximately 50-100 protected species applications per annum.

APPENDIX 3 – DATA SEARCH SUMMARY

Table 3.1 Summary of protected and notable species recorded within 4km of the proposed site (not including bird species, see Table 3.2 and 3.3).

Date	Scientific Name	Common Name	BAP Species	Wildlife and Countryside Act
27/06/2012	<i>Arvicola terrestris</i>	Water Vole	✓	✓
27/06/2012	<i>Arvicola terrestris</i>	Water Vole	✓	✓
05/05/2012	<i>Arvicola terrestris</i>	Water Vole	✓	✓
05/05/2012	<i>Arvicola terrestris</i>	Water Vole	✓	✓
25/03/2011	<i>Arvicola terrestris</i>	Water Vole	✓	✓
27/11/2009	<i>Arvicola terrestris</i>	Water Vole	✓	✓
27/11/2009	<i>Arvicola terrestris</i>	Water Vole	✓	✓
06/11/2009	<i>Arvicola terrestris</i>	Water Vole	✓	✓
06/11/2009	<i>Arvicola terrestris</i>	Water Vole	✓	✓
06/11/2009	<i>Arvicola terrestris</i>	Water Vole	✓	✓
23/09/2009	<i>Arvicola terrestris</i>	Water Vole	✓	✓
10/12/2002	<i>Arvicola terrestris</i>	Water Vole	✓	✓
24/06/2002	<i>Arvicola terrestris</i>	Water Vole	✓	✓
24/06/2002	<i>Arvicola terrestris</i>	Water Vole	✓	✓
24/06/2002	<i>Arvicola terrestris</i>	Water Vole	✓	✓
20/06/2002	<i>Arvicola terrestris</i>	Water Vole	✓	✓
20/06/2002	<i>Arvicola terrestris</i>	Water Vole	✓	✓
20/06/2002	<i>Arvicola terrestris</i>	Water Vole	✓	✓
18/06/2002	<i>Arvicola terrestris</i>	Water Vole	✓	✓
18/06/2002	<i>Arvicola terrestris</i>	Water Vole	✓	✓
18/06/2002	<i>Arvicola terrestris</i>	Water Vole	✓	✓
01/01/2002	<i>Arvicola terrestris</i>	Water Vole	✓	✓
01/01/2002	<i>Arvicola terrestris</i>	Water Vole	✓	✓
01/01/2002	<i>Arvicola terrestris</i>	Water Vole	✓	✓
01/01/2002	<i>Arvicola terrestris</i>	Water Vole	✓	✓
01/01/2002	<i>Arvicola terrestris</i>	Water Vole	✓	✓
01/01/2002	<i>Arvicola terrestris</i>	Water Vole	✓	✓
01/01/2002	<i>Arvicola terrestris</i>	Water Vole	✓	✓
01/01/2002	<i>Arvicola terrestris</i>	Water Vole	✓	✓
01/01/2002	<i>Arvicola terrestris</i>	Water Vole	✓	✓
01/01/2002	<i>Arvicola terrestris</i>	Water Vole	✓	✓
01/01/2001	<i>Arvicola terrestris</i>	Water Vole	✓	✓
30/06/1999	<i>Arvicola terrestris</i>	Water Vole	✓	✓
13/04/2012	<i>Bufo bufo</i>	Common Toad	✓	✓
25/03/2011	<i>Bufo bufo</i>	Common Toad	✓	✓
01/01/2010	<i>Bufo bufo</i>	Common Toad	✓	✓
01/01/2010	<i>Bufo bufo</i>	Common Toad	✓	✓
01/01/2007	<i>Bufo bufo</i>	Common Toad	✓	✓
25/11/2001	<i>Chiroptera</i>	Bats	☐	✓
25/11/2001	<i>Chiroptera</i>	Bats	☐	✓
01/07/1999	<i>Chiroptera</i>	Bats	☐	✓
08/05/1993	<i>Chiroptera</i>	Bats	☐	✓
29/05/1989	<i>Chiroptera</i>	Bats	☐	✓
22/05/1982	<i>Chiroptera</i>	Bats	☐	✓
13/04/2012	<i>Lacerta vivipara</i>	Viviparous Lizard	✓	✓
17/03/2005	<i>Lutra lutra</i>	Otter	✓	✓
01/03/2005	<i>Lutra lutra</i>	Otter	✓	✓
01/03/2005	<i>Lutra lutra</i>	Otter	✓	✓
30/07/1991	<i>Myotis daubentoni</i>	Daubenton's Bat	☐	✓
23/07/1997	<i>Nyctalus noctula</i>	Noctule	✓	✓
07/04/2005	<i>Pipistrellus</i>	Pipistrelle Bat species	☐	✓
10/06/1998	<i>Pipistrellus pipistrellus</i>	Pipistrelle	☐	✓

23/07/1997	<i>Pipistrellus pipistrellus</i>	Pipistrelle	<input type="checkbox"/>	✓
07/09/1993	<i>Pipistrellus pipistrellus</i>	Pipistrelle	<input type="checkbox"/>	✓
11/07/1993	<i>Pipistrellus pipistrellus</i>	Pipistrelle	<input type="checkbox"/>	✓
18/09/1989	<i>Pipistrellus pipistrellus</i>	Pipistrelle	<input type="checkbox"/>	✓
18/03/2000	<i>Pipistrellus pipistrellus</i>	Pipistrelle	<input type="checkbox"/>	✓
01/01/2010	<i>Rana temporaria</i>	Common Frog	<input type="checkbox"/>	✓
01/01/2010	<i>Rana temporaria</i>	Common Frog	<input type="checkbox"/>	✓
01/01/2010	<i>Triturus vulgaris</i>	Smooth Newt	<input type="checkbox"/>	✓
01/01/2010	<i>Triturus vulgaris</i>	Smooth Newt	<input type="checkbox"/>	✓
01/01/2010	<i>Triturus vulgaris</i>	Smooth Newt	<input type="checkbox"/>	✓
01/01/2010	<i>Triturus vulgaris</i>	Smooth Newt	<input type="checkbox"/>	✓
01/01/2010	<i>Triturus vulgaris</i>	Smooth Newt	<input type="checkbox"/>	✓

Table 3.2 Summary of Red Listed bird species within 4km of the proposed site.

Date	Scientific Name	Common Name	BAP Species	Wildlife and Countryside Act
07/03/2013	<i>Alauda arvensis</i>	Skylark		
07/03/2013	<i>Alauda arvensis</i>	Skylark		
07/03/2013	<i>Alauda arvensis</i>	Skylark		
07/03/2013	<i>Alauda arvensis</i>	Skylark		
07/03/2013	<i>Alauda arvensis</i>	Skylark		
07/03/2013	<i>Alauda arvensis</i>	Skylark		
07/03/2013	<i>Alauda arvensis</i>	Skylark		
08/03/2012	<i>Alauda arvensis</i>	Skylark		
12/11/2011	<i>Alauda arvensis</i>	Skylark		
27/06/2009	<i>Alauda arvensis</i>	Skylark		
17/03/2005	<i>Alauda arvensis</i>	Skylark		
17/03/2005	<i>Alauda arvensis</i>	Skylark		
01/01/2005	<i>Alauda arvensis</i>	Skylark		
01/01/2004	<i>Alauda arvensis</i>	Skylark		
04/04/1999	<i>Alauda arvensis</i>	Skylark		
18/11/1998	<i>Alauda arvensis</i>	Skylark		
28/05/1998	<i>Alauda arvensis</i>	Skylark		
28/05/1998	<i>Alauda arvensis</i>	Skylark		
28/05/1998	<i>Alauda arvensis</i>	Skylark		
01/03/1998	<i>Alauda arvensis</i>	Skylark		
27/11/1995	<i>Alauda arvensis</i>	Skylark		
15/11/1995	<i>Alauda arvensis</i>	Skylark		
14/04/1995	<i>Alauda arvensis</i>	Skylark		
20/02/1995	<i>Alauda arvensis</i>	Skylark		
14/03/1994	<i>Alauda arvensis</i>	Skylark		
03/03/1993	<i>Alauda arvensis</i>	Skylark		
01/03/1993	<i>Alauda arvensis</i>	Skylark		
14/02/1993	<i>Alauda arvensis</i>	Skylark		
14/02/1993	<i>Alauda arvensis</i>	Skylark		
15/12/1991	<i>Alauda arvensis</i>	Sky Lark		
14/05/1989	<i>Alauda arvensis</i>	Skylark		
19/05/1985	<i>Alauda arvensis</i>	Skylark		
01/01/1984	<i>Alauda arvensis</i>	Skylark		
14/05/1993	<i>Anthus trivialis</i>	Tree Pipit	✓	
04/05/1991	<i>Anthus trivialis</i>	Tree Pipit	✓	
04/08/1985	<i>Anthus trivialis</i>	Tree Pipit	✓	
02/08/1985	<i>Anthus trivialis</i>	Tree Pipit	✓	
27/07/1985	<i>Anthus trivialis</i>	Tree Pipit	✓	
10/02/2013	<i>Calidris alpina</i>	Dunlin		
05/11/2011	<i>Calidris alpina</i>	Dunlin		
09/10/2011	<i>Calidris alpina</i>	Dunlin		
02/08/2011	<i>Calidris alpina</i>	Dunlin		
08/05/2011	<i>Calidris alpina</i>	Dunlin		
25/09/2009	<i>Calidris alpina</i>	Dunlin		
10/09/2009	<i>Calidris alpina</i>	Dunlin		
18/03/2009	<i>Calidris alpina</i>	Dunlin		
14/10/1993	<i>Calidris alpina</i>	Dunlin		
14/09/1993	<i>Calidris alpina</i>	Dunlin		
04/08/1993	<i>Calidris alpina</i>	Dunlin		
15/05/1993	<i>Calidris alpina</i>	Dunlin		
06/02/1993	<i>Calidris alpina</i>	Dunlin		
27/10/1991	<i>Calidris alpina</i>	Dunlin		

22/05/1991	<i>Calidris alpina</i>	Dunlin	
18/03/1991	<i>Calidris alpina</i>	Dunlin	
05/05/1985	<i>Calidris alpina</i>	Dunlin	
23/04/1985	<i>Calidris alpina</i>	Dunlin	
09/04/1985	<i>Calidris alpina</i>	Dunlin	
28/01/1985	<i>Calidris alpina</i>	Dunlin	
04/11/1984	<i>Calidris alpina</i>	Dunlin	
19/07/1984	<i>Calidris alpina</i>	Dunlin	
25/04/1984	<i>Calidris alpina</i>	Dunlin	
17/03/1984	<i>Calidris alpina</i>	Dunlin	
01/03/1998	<i>Carduelis cannabina</i>	Linnet	
01/03/1998	<i>Carduelis cannabina</i>	Linnet	
28/08/1993	<i>Carduelis cannabina</i>	Linnet	
06/05/1993	<i>Carduelis cannabina</i>	Linnet	
11/03/1993	<i>Carduelis cannabina</i>	Linnet	
04/09/1991	<i>Carduelis cannabina</i>	Common Linnet	
15/04/1991	<i>Carduelis cannabina</i>	Common Linnet	
13/01/1991	<i>Carduelis cannabina</i>	Common Linnet	
13/05/1990	<i>Carduelis cannabina</i>	Linnet	
05/09/1985	<i>Carduelis cannabina</i>	Linnet	
30/09/1984	<i>Carduelis cannabina</i>	Linnet	
27/07/1984	<i>Carduelis cannabina</i>	Linnet	
28/08/1985	<i>Carduelis flavirostris</i>	Twite	
15/12/2012	<i>Circus cyaneus</i>	Hen Harrier	
01/01/2005	<i>Cuculus canorus</i>	Cuckoo	✓
01/01/2004	<i>Cuculus canorus</i>	Common Cuckoo	✓
12/08/1993	<i>Cuculus canorus</i>	Cuckoo	✓
28/05/1993	<i>Cuculus canorus</i>	Cuckoo	✓
20/04/1993	<i>Cuculus canorus</i>	Cuckoo	✓
03/08/1991	<i>Cuculus canorus</i>	Common Cuckoo	✓
26/04/1991	<i>Cuculus canorus</i>	Common Cuckoo	✓
13/05/1990	<i>Cuculus canorus</i>	Cuckoo	✓
14/05/1989	<i>Cuculus canorus</i>	Cuckoo	✓
22/08/1985	<i>Cuculus canorus</i>	Cuckoo	✓
07/05/1985	<i>Cuculus canorus</i>	Cuckoo	✓
04/05/1985	<i>Cuculus canorus</i>	Cuckoo	✓
24/08/1984	<i>Cuculus canorus</i>	Cuckoo	✓
20/08/1984	<i>Cuculus canorus</i>	Cuckoo	✓
25/04/1984	<i>Cuculus canorus</i>	Cuckoo	✓
08/05/1980	<i>Cuculus canorus</i>	Cuckoo	✓
10/12/1991	<i>Emberiza calandra</i>	Corn Bunting	
30/01/1991	<i>Emberiza calandra</i>	Corn Bunting	
07/03/2013	<i>Emberiza citrinella</i>	Yellowhammer	✓
01/01/2005	<i>Emberiza citrinella</i>	Yellowhammer	✓
01/01/2004	<i>Emberiza citrinella</i>	Yellowhammer	✓
01/03/1998	<i>Emberiza citrinella</i>	Yellowhammer	✓
04/11/1993	<i>Emberiza citrinella</i>	Yellowhammer	✓
04/04/1993	<i>Emberiza citrinella</i>	Yellowhammer	✓
08/03/1993	<i>Emberiza citrinella</i>	Yellowhammer	✓
06/12/1991	<i>Emberiza citrinella</i>	Yellowhammer	✓
01/05/1991	<i>Emberiza citrinella</i>	Yellowhammer	✓
20/01/1991	<i>Emberiza citrinella</i>	Yellowhammer	✓
07/12/1985	<i>Emberiza citrinella</i>	Yellowhammer	✓
01/04/1985	<i>Emberiza citrinella</i>	Yellowhammer	✓
13/01/1985	<i>Emberiza citrinella</i>	Yellowhammer	✓
22/11/1984	<i>Emberiza citrinella</i>	Yellowhammer	✓

17/09/1993	<i>Jynx torquilla</i>	Wryneck	✓	✓
01/01/1993	<i>Larus argentatus</i>	Herring Gull		
26/03/1991	<i>Larus argentatus</i>	Herring Gull		
01/01/1984	<i>Larus argentatus</i>	Herring Gull		
01/01/2005	<i>Locustella naevia</i>	Grasshopper Warbler Common Grasshopper	✓	
01/01/2004	<i>Locustella naevia</i>	Warbler	✓	
26/04/1984	<i>Locustella naevia</i>	Grasshopper Warbler	✓	
01/04/1989	<i>Motacilla flava subsp. flavissima</i>	Yellow Wagtail	✓	
01/04/1988	<i>Motacilla flava subsp. flavissima</i>	Yellow Wagtail	✓	
18/06/1993	<i>Muscicapa striata</i>	Spotted Flycatcher	✓	
08/07/1991	<i>Muscicapa striata</i>	Spotted Flycatcher	✓	
14/08/1985	<i>Muscicapa striata</i>	Spotted Flycatcher	✓	
01/05/2011	<i>Numenius phaeopus</i>	Whimbrel		✓
01/05/2011	<i>Numenius phaeopus</i>	Whimbrel		✓
02/08/1993	<i>Numenius phaeopus</i>	Whimbrel		✓
12/07/1993	<i>Numenius phaeopus</i>	Whimbrel		✓
26/04/1993	<i>Numenius phaeopus</i>	Whimbrel		✓
03/06/1991	<i>Numenius phaeopus</i>	Whimbrel		✓
20/05/1991	<i>Numenius phaeopus</i>	Whimbrel		✓
13/05/1990	<i>Numenius phaeopus</i>	Whimbrel		✓
03/05/1984	<i>Numenius phaeopus</i>	Whimbrel		✓
28/04/1984	<i>Numenius phaeopus</i>	Whimbrel		✓
01/01/2005	<i>Parus montanus</i>	Willow Tit		
01/01/2004	<i>Parus montanus</i>	Willow Tit		
21/07/1993	<i>Parus montanus</i>	Willow Tit		
13/05/1990	<i>Parus montanus</i>	Willow Tit		
01/04/1989	<i>Parus montanus</i>	Willow Tit		
01/04/1988	<i>Parus montanus</i>	Willow Tit		
27/07/1985	<i>Parus montanus</i>	Willow Tit		
09/07/1993	<i>Passer domesticus</i>	House Sparrow	✓	
28/08/1991	<i>Passer domesticus</i>	House Sparrow	✓	
28/05/1985	<i>Passer domesticus</i>	House Sparrow	✓	
25/10/1984	<i>Passer domesticus</i>	House Sparrow	✓	
09/08/1984	<i>Passer domesticus</i>	House Sparrow	✓	
01/01/2002	<i>Passer montanus</i>	Tree Sparrow	✓	
01/03/1999	<i>Passer montanus</i>	Tree Sparrow	✓	
16/04/1993	<i>Passer montanus</i>	Tree Sparrow	✓	
20/01/1991	<i>Passer montanus</i>	Eurasian Tree Sparrow	✓	
01/04/1989	<i>Passer montanus</i>	Tree Sparrow	✓	
01/04/1988	<i>Passer montanus</i>	Tree Sparrow	✓	
17/05/1985	<i>Passer montanus</i>	Tree Sparrow	✓	
27/09/1984	<i>Passer montanus</i>	Tree Sparrow	✓	
07/03/2013	<i>Perdix perdix</i>	Grey Partridge	✓	
07/03/2013	<i>Perdix perdix</i>	Grey Partridge	✓	
08/03/2012	<i>Perdix perdix</i>	Grey Partridge	✓	
08/03/2012	<i>Perdix perdix</i>	Grey Partridge	✓	
08/03/2012	<i>Perdix perdix</i>	Grey Partridge	✓	
08/03/2012	<i>Perdix perdix</i>	Grey Partridge	✓	
01/03/1999	<i>Perdix perdix</i>	Grey Partridge	✓	
04/11/1993	<i>Perdix perdix</i>	Grey Partridge	✓	
03/08/1993	<i>Perdix perdix</i>	Grey Partridge	✓	
12/01/1993	<i>Perdix perdix</i>	Grey Partridge	✓	
25/11/1991	<i>Perdix perdix</i>	Grey Partridge	✓	

10/10/1989	<i>Perdix perdix</i>	Grey Partridge	✓	
02/08/1985	<i>Perdix perdix</i>	Grey Partridge	✓	
16/01/1985	<i>Perdix perdix</i>	Grey Partridge	✓	
31/12/1984	<i>Perdix perdix</i>	Grey Partridge	✓	
25/08/1984	<i>Perdix perdix</i>	Grey Partridge	✓	
26/11/1977	<i>Perdix perdix</i>	Grey Partridge	✓	
12/09/2011	<i>Philomachus pugnax</i>	Ruff		✓
03/09/2011	<i>Philomachus pugnax</i>	Ruff		✓
02/09/2011	<i>Philomachus pugnax</i>	Ruff		✓
31/08/2011	<i>Philomachus pugnax</i>	Ruff		✓
29/06/2011	<i>Philomachus pugnax</i>	Ruff		✓
28/06/2011	<i>Philomachus pugnax</i>	Ruff		✓
03/05/2011	<i>Philomachus pugnax</i>	Ruff		✓
13/09/1993	<i>Philomachus pugnax</i>	Ruff		✓
27/08/1993	<i>Philomachus pugnax</i>	Ruff		✓
12/08/1993	<i>Philomachus pugnax</i>	Ruff		✓
14/04/1993	<i>Philomachus pugnax</i>	Ruff		✓
03/10/1991	<i>Philomachus pugnax</i>	Ruff		✓
24/09/1991	<i>Philomachus pugnax</i>	Ruff		✓
04/08/1991	<i>Philomachus pugnax</i>	Ruff		✓
01/06/1991	<i>Philomachus pugnax</i>	Ruff		✓
14/05/1989	<i>Philomachus pugnax</i>	Ruff		✓
18/04/1985	<i>Philomachus pugnax</i>	Ruff		✓
25/09/1984	<i>Philomachus pugnax</i>	Ruff		✓
14/08/1982	<i>Philomachus pugnax</i>	Ruff		✓
01/03/1998	<i>Streptopelia turtur</i>	Turtle Dove	✓	
28/08/1993	<i>Streptopelia turtur</i>	Turtle Dove	✓	
15/05/1993	<i>Streptopelia turtur</i>	Turtle Dove	✓	
27/04/1993	<i>Streptopelia turtur</i>	Turtle Dove	✓	
15/09/1991	<i>Streptopelia turtur</i>	European Turtle Dove	✓	
22/06/1991	<i>Streptopelia turtur</i>	European Turtle Dove	✓	
04/05/1991	<i>Streptopelia turtur</i>	European Turtle Dove	✓	
13/05/1990	<i>Streptopelia turtur</i>	Turtle Dove	✓	
14/05/1989	<i>Streptopelia turtur</i>	Turtle Dove	✓	
01/04/1989	<i>Streptopelia turtur</i>	Turtle Dove	✓	
01/04/1988	<i>Streptopelia turtur</i>	Turtle Dove	✓	
12/05/1985	<i>Streptopelia turtur</i>	Turtle Dove	✓	
25/08/1984	<i>Streptopelia turtur</i>	Turtle Dove	✓	
15/07/1984	<i>Streptopelia turtur</i>	Turtle Dove	✓	
22/05/1984	<i>Streptopelia turtur</i>	Turtle Dove	✓	
01/01/1984	<i>Streptopelia turtur</i>	Turtle Dove	✓	
01/07/1978	<i>Streptopelia turtur</i>	Turtle Dove	✓	
25/09/2009	<i>Sturnus vulgaris</i>	Starling		
24/08/2009	<i>Sturnus vulgaris</i>	Starling		
12/08/1993	<i>Sturnus vulgaris</i>	Starling		
18/01/1991	<i>Sturnus vulgaris</i>	Common Starling		
22/05/1985	<i>Sturnus vulgaris</i>	Starling		
04/11/1984	<i>Sturnus vulgaris</i>	Starling		
01/01/1984	<i>Sturnus vulgaris</i>	Starling		
14/10/1993	<i>Turdus iliacus</i>	Redwing		✓
01/04/1993	<i>Turdus iliacus</i>	Redwing		✓
12/01/1993	<i>Turdus iliacus</i>	Redwing		✓
06/11/1991	<i>Turdus iliacus</i>	Redwing		✓
18/10/1991	<i>Turdus iliacus</i>	Redwing		✓
15/03/1991	<i>Turdus iliacus</i>	Redwing		✓
17/01/1991	<i>Turdus iliacus</i>	Redwing		✓

10/11/1985	<i>Turdus iliacus</i>	Redwing	✓
21/10/1985	<i>Turdus iliacus</i>	Redwing	✓
30/03/1985	<i>Turdus iliacus</i>	Redwing	✓
13/01/1985	<i>Turdus iliacus</i>	Redwing	✓
14/11/1984	<i>Turdus iliacus</i>	Redwing	✓
22/10/1984	<i>Turdus iliacus</i>	Redwing	✓
13/04/1984	<i>Turdus iliacus</i>	Redwing	✓
07/03/2013	<i>Turdus philomelos</i>	Song Thrush	
01/01/1993	<i>Turdus philomelos</i>	Song Thrush	
31/01/1991	<i>Turdus philomelos</i>	Song Thrush	
01/01/1985	<i>Turdus philomelos</i>	Song Thrush	
13/04/1984	<i>Turdus philomelos</i>	Song Thrush	
22/10/1993	<i>Turdus pilaris</i>	Fieldfare	✓
06/10/1993	<i>Turdus pilaris</i>	Fieldfare	✓
21/03/1993	<i>Turdus pilaris</i>	Fieldfare	✓
12/01/1993	<i>Turdus pilaris</i>	Fieldfare	✓
30/12/1991	<i>Turdus pilaris</i>	Fieldfare	✓
02/11/1991	<i>Turdus pilaris</i>	Fieldfare	✓
01/11/1991	<i>Turdus pilaris</i>	Fieldfare	✓
05/05/1991	<i>Turdus pilaris</i>	Fieldfare	✓
21/03/1991	<i>Turdus pilaris</i>	Fieldfare	✓
17/01/1991	<i>Turdus pilaris</i>	Fieldfare	✓
24/11/1985	<i>Turdus pilaris</i>	Fieldfare	✓
20/10/1985	<i>Turdus pilaris</i>	Fieldfare	✓
27/03/1985	<i>Turdus pilaris</i>	Fieldfare	✓
15/03/1985	<i>Turdus pilaris</i>	Fieldfare	✓
05/02/1985	<i>Turdus pilaris</i>	Fieldfare	✓
13/11/1984	<i>Turdus pilaris</i>	Fieldfare	✓
07/11/1984	<i>Turdus pilaris</i>	Fieldfare	✓
06/10/1984	<i>Turdus pilaris</i>	Fieldfare	✓
17/04/1984	<i>Turdus pilaris</i>	Fieldfare	✓
11/04/1984	<i>Turdus pilaris</i>	Fieldfare	✓
29/02/1984	<i>Turdus pilaris</i>	Fieldfare	✓
21/04/1993	<i>Turdus torquatus</i>	Ring Ouzel	✓
26/04/1991	<i>Turdus torquatus</i>	Ring Ouzel	✓
25/11/1984	<i>Vanellus vanellus</i>	Lapwing	✓
02/09/1984	<i>Vanellus vanellus</i>	Lapwing	✓
04/03/1984	<i>Vanellus vanellus</i>	Lapwing	✓
09/09/1978	<i>Vanellus vanellus</i>	Lapwing	✓

Table 3.3 Summary of Amber listed bird species within 4km of proposed site.

Date	Scientific Name	Common Name	BAP Species	Wildlife and Countryside Act
06/07/2013	<i>Actitis hypoleucos</i>	Common Sandpiper		<input type="checkbox"/> <input type="checkbox"/>
08/05/2011	<i>Actitis hypoleucos</i>	Common Sandpiper		<input type="checkbox"/> <input type="checkbox"/>
23/08/1993	<i>Actitis hypoleucos</i>	Common Sandpiper		<input type="checkbox"/> <input type="checkbox"/>
27/07/1993	<i>Actitis hypoleucos</i>	Common Sandpiper		<input type="checkbox"/> <input type="checkbox"/>
08/07/1993	<i>Actitis hypoleucos</i>	Common Sandpiper		<input type="checkbox"/> <input type="checkbox"/>
10/04/1993	<i>Actitis hypoleucos</i>	Common Sandpiper		<input type="checkbox"/> <input type="checkbox"/>
04/11/1991	<i>Actitis hypoleucos</i>	Common Sandpiper		<input type="checkbox"/> <input type="checkbox"/>
16/07/1991	<i>Actitis hypoleucos</i>	Common Sandpiper		<input type="checkbox"/> <input type="checkbox"/>
03/07/1991	<i>Actitis hypoleucos</i>	Common Sandpiper		<input type="checkbox"/> <input type="checkbox"/>
01/06/1991	<i>Actitis hypoleucos</i>	Common Sandpiper		<input type="checkbox"/> <input type="checkbox"/>
13/04/1991	<i>Actitis hypoleucos</i>	Common Sandpiper		<input type="checkbox"/> <input type="checkbox"/>
13/05/1990	<i>Actitis hypoleucos</i>	Common Sandpiper		<input type="checkbox"/> <input type="checkbox"/>
03/07/1985	<i>Actitis hypoleucos</i>	Common Sandpiper		<input type="checkbox"/> <input type="checkbox"/>
21/05/1985	<i>Actitis hypoleucos</i>	Common Sandpiper		<input type="checkbox"/> <input type="checkbox"/>
23/03/1985	<i>Actitis hypoleucos</i>	Common Sandpiper		<input type="checkbox"/> <input type="checkbox"/>
16/09/1984	<i>Actitis hypoleucos</i>	Common Sandpiper		<input type="checkbox"/> <input type="checkbox"/>
20/08/1984	<i>Actitis hypoleucos</i>	Common Sandpiper		<input type="checkbox"/> <input type="checkbox"/>
27/07/1984	<i>Actitis hypoleucos</i>	Common Sandpiper		<input type="checkbox"/> <input type="checkbox"/>
04/07/1984	<i>Actitis hypoleucos</i>	Common Sandpiper		<input type="checkbox"/> <input type="checkbox"/>
12/07/1977	<i>Actitis hypoleucos</i>	Common Sandpiper		<input type="checkbox"/> <input type="checkbox"/>
05/03/1993	<i>Alcedo atthis</i>	Kingfisher		<input type="checkbox"/> <input checked="" type="checkbox"/>
01/01/1991	<i>Alcedo atthis</i>	Common Kingfisher		<input type="checkbox"/> <input checked="" type="checkbox"/>
01/01/1985	<i>Alcedo atthis</i>	Kingfisher		<input type="checkbox"/> <input checked="" type="checkbox"/>
23/12/1984	<i>Alcedo atthis</i>	Kingfisher		<input type="checkbox"/> <input checked="" type="checkbox"/>
16/10/1984	<i>Alcedo atthis</i>	Kingfisher		<input type="checkbox"/> <input checked="" type="checkbox"/>
26/09/1984	<i>Alcedo atthis</i>	Kingfisher		<input type="checkbox"/> <input checked="" type="checkbox"/>
19/07/1984	<i>Alcedo atthis</i>	Kingfisher		<input type="checkbox"/> <input checked="" type="checkbox"/>
31/03/1984	<i>Alcedo atthis</i>	Kingfisher		<input type="checkbox"/> <input checked="" type="checkbox"/>
21/03/1984	<i>Alcedo atthis</i>	Kingfisher		<input type="checkbox"/> <input checked="" type="checkbox"/>
03/03/1984	<i>Alcedo atthis</i>	Kingfisher		<input type="checkbox"/> <input checked="" type="checkbox"/>
10/03/2013	<i>Anas acuta</i>	Pintail		<input type="checkbox"/> <input checked="" type="checkbox"/>
10/02/2013	<i>Anas acuta</i>	Pintail		<input type="checkbox"/> <input checked="" type="checkbox"/>
02/01/2009	<i>Anas acuta</i>	Pintail		<input type="checkbox"/> <input checked="" type="checkbox"/>
30/09/1993	<i>Anas acuta</i>	Pintail		<input type="checkbox"/> <input checked="" type="checkbox"/>
08/02/1993	<i>Anas acuta</i>	Pintail		<input type="checkbox"/> <input checked="" type="checkbox"/>
13/09/1991	<i>Anas acuta</i>	Northern Pintail		<input type="checkbox"/> <input checked="" type="checkbox"/>
08/09/1991	<i>Anas acuta</i>	Northern Pintail		<input type="checkbox"/> <input checked="" type="checkbox"/>
04/11/1984	<i>Anas acuta</i>	Pintail		<input type="checkbox"/> <input checked="" type="checkbox"/>
20/03/1984	<i>Anas acuta</i>	Pintail		<input type="checkbox"/> <input checked="" type="checkbox"/>
10/02/2013	<i>Anas clypeata</i>	Shoveler		<input type="checkbox"/> <input type="checkbox"/>
13/01/2013	<i>Anas clypeata</i>	Shoveler		<input type="checkbox"/> <input type="checkbox"/>
22/09/2012	<i>Anas clypeata</i>	Shoveler		<input type="checkbox"/> <input type="checkbox"/>

11/11/2011	<i>Anas clypeata</i>	Shoveler	<input type="checkbox"/>	<input type="checkbox"/>
09/10/2011	<i>Anas clypeata</i>	Shoveler	<input type="checkbox"/>	<input type="checkbox"/>
08/05/2011	<i>Anas clypeata</i>	Shoveler	<input type="checkbox"/>	<input type="checkbox"/>
25/10/2009	<i>Anas clypeata</i>	Shoveler	<input type="checkbox"/>	<input type="checkbox"/>
25/09/2009	<i>Anas clypeata</i>	Shoveler	<input type="checkbox"/>	<input type="checkbox"/>
24/08/2009	<i>Anas clypeata</i>	Shoveler	<input type="checkbox"/>	<input type="checkbox"/>
17/04/2005	<i>Anas clypeata</i>	Northern Shoveler	<input type="checkbox"/>	<input type="checkbox"/>
01/01/2004	<i>Anas clypeata</i>	Northern Shoveler	<input type="checkbox"/>	<input type="checkbox"/>
01/01/1999	<i>Anas clypeata</i>	Shoveler	<input type="checkbox"/>	<input type="checkbox"/>
21/10/1993	<i>Anas clypeata</i>	Shoveler	<input type="checkbox"/>	<input type="checkbox"/>
21/07/1993	<i>Anas clypeata</i>	Shoveler	<input type="checkbox"/>	<input type="checkbox"/>
29/03/1993	<i>Anas clypeata</i>	Shoveler	<input type="checkbox"/>	<input type="checkbox"/>
17/10/1991	<i>Anas clypeata</i>	Northern Shoveler	<input type="checkbox"/>	<input type="checkbox"/>
01/04/1991	<i>Anas clypeata</i>	Northern Shoveler	<input type="checkbox"/>	<input type="checkbox"/>
13/05/1990	<i>Anas clypeata</i>	Shoveler	<input type="checkbox"/>	<input type="checkbox"/>
14/05/1989	<i>Anas clypeata</i>	Shoveler	<input type="checkbox"/>	<input type="checkbox"/>
01/04/1989	<i>Anas clypeata</i>	Shoveler	<input type="checkbox"/>	<input type="checkbox"/>
01/04/1988	<i>Anas clypeata</i>	Shoveler	<input type="checkbox"/>	<input type="checkbox"/>
21/05/1985	<i>Anas clypeata</i>	Shoveler	<input type="checkbox"/>	<input type="checkbox"/>
19/04/1985	<i>Anas clypeata</i>	Shoveler	<input type="checkbox"/>	<input type="checkbox"/>
22/01/1985	<i>Anas clypeata</i>	Shoveler	<input type="checkbox"/>	<input type="checkbox"/>
14/12/1984	<i>Anas clypeata</i>	Shoveler	<input type="checkbox"/>	<input type="checkbox"/>
29/03/1984	<i>Anas clypeata</i>	Shoveler	<input type="checkbox"/>	<input type="checkbox"/>
20/03/1984	<i>Anas clypeata</i>	Shoveler	<input type="checkbox"/>	<input type="checkbox"/>
01/06/1983	<i>Anas clypeata</i>	Shoveler	<input type="checkbox"/>	<input type="checkbox"/>
10/03/2013	<i>Anas crecca</i>	Teal	<input type="checkbox"/>	<input type="checkbox"/>
10/02/2013	<i>Anas crecca</i>	Teal	<input type="checkbox"/>	<input type="checkbox"/>
13/01/2013	<i>Anas crecca</i>	Teal	<input type="checkbox"/>	<input type="checkbox"/>
25/09/2009	<i>Anas crecca</i>	Teal	<input type="checkbox"/>	<input type="checkbox"/>
24/08/2009	<i>Anas crecca</i>	Teal	<input type="checkbox"/>	<input type="checkbox"/>
04/01/2009	<i>Anas crecca</i>	Teal	<input type="checkbox"/>	<input type="checkbox"/>
02/01/2009	<i>Anas crecca</i>	Teal	<input type="checkbox"/>	<input type="checkbox"/>
17/04/2005	<i>Anas crecca</i>	Common Teal	<input type="checkbox"/>	<input type="checkbox"/>
01/01/1999	<i>Anas crecca</i>	Teal	<input type="checkbox"/>	<input type="checkbox"/>
21/12/1993	<i>Anas crecca</i>	Teal	<input type="checkbox"/>	<input type="checkbox"/>
24/07/1993	<i>Anas crecca</i>	Teal	<input type="checkbox"/>	<input type="checkbox"/>
17/01/1993	<i>Anas crecca</i>	Teal	<input type="checkbox"/>	<input type="checkbox"/>
27/10/1991	<i>Anas crecca</i>	Eurasian Teal	<input type="checkbox"/>	<input type="checkbox"/>
29/03/1991	<i>Anas crecca</i>	Teal	<input type="checkbox"/>	<input type="checkbox"/>
01/03/1991	<i>Anas crecca</i>	Eurasian Teal	<input type="checkbox"/>	<input type="checkbox"/>
12/02/1991	<i>Anas crecca</i>	Teal	<input type="checkbox"/>	<input type="checkbox"/>
13/05/1990	<i>Anas crecca</i>	Teal	<input type="checkbox"/>	<input type="checkbox"/>
14/05/1989	<i>Anas crecca</i>	Teal	<input type="checkbox"/>	<input type="checkbox"/>
01/04/1989	<i>Anas crecca</i>	Teal	<input type="checkbox"/>	<input type="checkbox"/>
01/04/1988	<i>Anas crecca</i>	Teal	<input type="checkbox"/>	<input type="checkbox"/>

25/03/1985	<i>Anas crecca</i>	Teal	<input type="checkbox"/>	<input type="checkbox"/>
30/12/1984	<i>Anas crecca</i>	Teal	<input type="checkbox"/>	<input type="checkbox"/>
22/11/1984	<i>Anas crecca</i>	Teal	<input type="checkbox"/>	<input type="checkbox"/>
20/05/1984	<i>Anas crecca</i>	Teal	<input type="checkbox"/>	<input type="checkbox"/>
25/03/1984	<i>Anas crecca</i>	Teal	<input type="checkbox"/>	<input type="checkbox"/>
01/06/1983	<i>Anas crecca</i>	Teal	<input type="checkbox"/>	<input type="checkbox"/>
01/03/1982	<i>Anas crecca</i>	Teal	<input type="checkbox"/>	<input type="checkbox"/>
07/04/1977	<i>Anas crecca</i>	Teal	<input type="checkbox"/>	<input type="checkbox"/>
10/03/2013	<i>Anas penelope</i>	Wigeon	<input type="checkbox"/>	<input type="checkbox"/>
10/02/2013	<i>Anas penelope</i>	Wigeon	<input type="checkbox"/>	<input type="checkbox"/>
13/01/2013	<i>Anas penelope</i>	Wigeon	<input type="checkbox"/>	<input type="checkbox"/>
25/10/2009	<i>Anas penelope</i>	Wigeon	<input type="checkbox"/>	<input type="checkbox"/>
25/09/2009	<i>Anas penelope</i>	Wigeon	<input type="checkbox"/>	<input type="checkbox"/>
24/08/2009	<i>Anas penelope</i>	Wigeon	<input type="checkbox"/>	<input type="checkbox"/>
02/01/2009	<i>Anas penelope</i>	Wigeon	<input type="checkbox"/>	<input type="checkbox"/>
17/04/2005	<i>Anas penelope</i>	Eurasian Wigeon	<input type="checkbox"/>	<input type="checkbox"/>
01/01/1999	<i>Anas penelope</i>	Wigeon	<input type="checkbox"/>	<input type="checkbox"/>
04/11/1993	<i>Anas penelope</i>	Wigeon	<input type="checkbox"/>	<input type="checkbox"/>
09/09/1993	<i>Anas penelope</i>	Wigeon	<input type="checkbox"/>	<input type="checkbox"/>
12/04/1993	<i>Anas penelope</i>	Wigeon	<input type="checkbox"/>	<input type="checkbox"/>
14/02/1993	<i>Anas penelope</i>	Wigeon	<input type="checkbox"/>	<input type="checkbox"/>
27/10/1991	<i>Anas penelope</i>	Eurasian Wigeon	<input type="checkbox"/>	<input type="checkbox"/>
04/09/1991	<i>Anas penelope</i>	Eurasian Wigeon	<input type="checkbox"/>	<input type="checkbox"/>
08/04/1991	<i>Anas penelope</i>	Eurasian Wigeon	<input type="checkbox"/>	<input type="checkbox"/>
11/03/1991	<i>Anas penelope</i>	Eurasian Wigeon	<input type="checkbox"/>	<input type="checkbox"/>
01/12/1985	<i>Anas penelope</i>	Wigeon	<input type="checkbox"/>	<input type="checkbox"/>
23/02/1985	<i>Anas penelope</i>	Wigeon	<input type="checkbox"/>	<input type="checkbox"/>
04/11/1984	<i>Anas penelope</i>	Wigeon	<input type="checkbox"/>	<input type="checkbox"/>
22/03/1984	<i>Anas penelope</i>	Wigeon	<input type="checkbox"/>	<input type="checkbox"/>
05/02/1982	<i>Anas penelope</i>	Wigeon	<input type="checkbox"/>	<input type="checkbox"/>
10/03/2013	<i>Anas platyrhynchos</i>	Mallard	<input type="checkbox"/>	<input type="checkbox"/>
10/02/2013	<i>Anas platyrhynchos</i>	Mallard	<input type="checkbox"/>	<input type="checkbox"/>
13/01/2013	<i>Anas platyrhynchos</i>	Mallard	<input type="checkbox"/>	<input type="checkbox"/>
08/03/2012	<i>Anas platyrhynchos</i>	Mallard	<input type="checkbox"/>	<input type="checkbox"/>
08/05/2011	<i>Anas platyrhynchos</i>	Mallard	<input type="checkbox"/>	<input type="checkbox"/>
25/09/2009	<i>Anas platyrhynchos</i>	Mallard	<input type="checkbox"/>	<input type="checkbox"/>
24/08/2009	<i>Anas platyrhynchos</i>	Mallard	<input type="checkbox"/>	<input type="checkbox"/>
27/06/2009	<i>Anas platyrhynchos</i>	Mallard	<input type="checkbox"/>	<input type="checkbox"/>
04/01/2009	<i>Anas platyrhynchos</i>	Mallard	<input type="checkbox"/>	<input type="checkbox"/>
17/03/2005	<i>Anas platyrhynchos</i>	Mallard	<input type="checkbox"/>	<input type="checkbox"/>
01/01/2004	<i>Anas platyrhynchos</i>	Mallard	<input type="checkbox"/>	<input type="checkbox"/>
01/01/1999	<i>Anas platyrhynchos</i>	Mallard	<input type="checkbox"/>	<input type="checkbox"/>
21/09/1993	<i>Anas platyrhynchos</i>	Mallard	<input type="checkbox"/>	<input type="checkbox"/>
15/05/1993	<i>Anas platyrhynchos</i>	Mallard	<input type="checkbox"/>	<input type="checkbox"/>
08/02/1993	<i>Anas platyrhynchos</i>	Mallard	<input type="checkbox"/>	<input type="checkbox"/>

21/09/1991	<i>Anas platyrhynchos</i>	Mallard	<input type="checkbox"/>	<input type="checkbox"/>
11/03/1991	<i>Anas platyrhynchos</i>	Mallard	<input type="checkbox"/>	<input type="checkbox"/>
13/05/1990	<i>Anas platyrhynchos</i>	Mallard	<input type="checkbox"/>	<input type="checkbox"/>
14/05/1989	<i>Anas platyrhynchos</i>	Mallard	<input type="checkbox"/>	<input type="checkbox"/>
22/12/1985	<i>Anas platyrhynchos</i>	Mallard	<input type="checkbox"/>	<input type="checkbox"/>
19/07/1985	<i>Anas platyrhynchos</i>	Mallard	<input type="checkbox"/>	<input type="checkbox"/>
02/03/1984	<i>Anas platyrhynchos</i>	Mallard	<input type="checkbox"/>	<input type="checkbox"/>
01/06/1983	<i>Anas platyrhynchos</i>	Mallard	<input type="checkbox"/>	<input type="checkbox"/>
01/03/1982	<i>Anas platyrhynchos</i>	Mallard	<input type="checkbox"/>	<input type="checkbox"/>
10/03/2013	<i>Anas strepera</i>	Gadwall	<input type="checkbox"/>	<input type="checkbox"/>
10/02/2013	<i>Anas strepera</i>	Gadwall	<input type="checkbox"/>	<input type="checkbox"/>
13/01/2013	<i>Anas strepera</i>	Gadwall	<input type="checkbox"/>	<input type="checkbox"/>
08/05/2011	<i>Anas strepera</i>	Gadwall	<input type="checkbox"/>	<input type="checkbox"/>
25/09/2009	<i>Anas strepera</i>	Gadwall	<input type="checkbox"/>	<input type="checkbox"/>
24/08/2009	<i>Anas strepera</i>	Gadwall	<input type="checkbox"/>	<input type="checkbox"/>
27/06/2009	<i>Anas strepera</i>	Gadwall	<input type="checkbox"/>	<input type="checkbox"/>
17/04/2005	<i>Anas strepera</i>	Gadwall	<input type="checkbox"/>	<input type="checkbox"/>
01/01/2004	<i>Anas strepera</i>	Gadwall	<input type="checkbox"/>	<input type="checkbox"/>
29/09/1993	<i>Anas strepera</i>	Gadwall	<input type="checkbox"/>	<input type="checkbox"/>
05/09/1993	<i>Anas strepera</i>	Gadwall	<input type="checkbox"/>	<input type="checkbox"/>
27/07/1993	<i>Anas strepera</i>	Gadwall	<input type="checkbox"/>	<input type="checkbox"/>
12/05/1993	<i>Anas strepera</i>	Gadwall	<input type="checkbox"/>	<input type="checkbox"/>
19/01/1993	<i>Anas strepera</i>	Gadwall	<input type="checkbox"/>	<input type="checkbox"/>
13/09/1991	<i>Anas strepera</i>	Gadwall	<input type="checkbox"/>	<input type="checkbox"/>
14/03/1991	<i>Anas strepera</i>	Gadwall	<input type="checkbox"/>	<input type="checkbox"/>
23/02/1991	<i>Anas strepera</i>	Gadwall	<input type="checkbox"/>	<input type="checkbox"/>
14/05/1989	<i>Anas strepera</i>	Gadwall	<input type="checkbox"/>	<input type="checkbox"/>
01/04/1989	<i>Anas strepera</i>	Gadwall	<input type="checkbox"/>	<input type="checkbox"/>
10/03/2013	<i>Anser anser</i>	Greylag Goose	<input type="checkbox"/>	<input checked="" type="checkbox"/>
21/02/2013	<i>Anser anser</i>	Greylag Goose	<input type="checkbox"/>	<input checked="" type="checkbox"/>
13/01/2013	<i>Anser anser</i>	Greylag Goose	<input type="checkbox"/>	<input checked="" type="checkbox"/>
08/03/2012	<i>Anser anser</i>	Greylag Goose	<input type="checkbox"/>	<input checked="" type="checkbox"/>
25/09/2009	<i>Anser anser</i>	Greylag Goose	<input type="checkbox"/>	<input checked="" type="checkbox"/>
24/08/2009	<i>Anser anser</i>	Greylag Goose	<input type="checkbox"/>	<input checked="" type="checkbox"/>
04/01/2009	<i>Anser anser</i>	Greylag Goose	<input type="checkbox"/>	<input checked="" type="checkbox"/>
14/09/1993	<i>Anser anser</i>	Greylag Goose	<input type="checkbox"/>	<input checked="" type="checkbox"/>
11/05/1993	<i>Anser anser</i>	Greylag Goose	<input type="checkbox"/>	<input checked="" type="checkbox"/>
19/04/1993	<i>Anser anser</i>	Greylag Goose	<input type="checkbox"/>	<input checked="" type="checkbox"/>
31/03/1993	<i>Anser anser</i>	Greylag Goose	<input type="checkbox"/>	<input checked="" type="checkbox"/>
13/04/1991	<i>Anser anser</i>	Greylag Goose	<input type="checkbox"/>	<input checked="" type="checkbox"/>
13/05/1990	<i>Anser anser</i>	Greylag Goose	<input type="checkbox"/>	<input checked="" type="checkbox"/>
04/10/1991	<i>Anser brachyrhynchus</i>	Pink-footed Goose	<input type="checkbox"/>	<input type="checkbox"/>
03/01/1991	<i>Anser brachyrhynchus</i>	Pink-footed Goose	<input type="checkbox"/>	<input type="checkbox"/>
13/01/2013	<i>Anser brachyrhynchus</i>	Pink-footed Goose	<input type="checkbox"/>	<input type="checkbox"/>
23/02/1993	<i>Anser brachyrhynchus</i>	Pink-footed Goose	<input type="checkbox"/>	<input type="checkbox"/>

07/02/1993	<i>Anser brachyrhynchus</i>	Pink-Footed Goose	<input type="checkbox"/>	<input type="checkbox"/>
12/01/1993	<i>Anser brachyrhynchus</i>	Pink-Footed Goose	<input type="checkbox"/>	<input type="checkbox"/>
16/12/1985	<i>Anser brachyrhynchus</i>	Pink-Footed Goose	<input type="checkbox"/>	<input type="checkbox"/>
17/01/1985	<i>Anser brachyrhynchus</i>	Pink-Footed Goose	<input type="checkbox"/>	<input type="checkbox"/>
14/02/1975	<i>Anser brachyrhynchus</i>	Pink-Footed Goose	<input type="checkbox"/>	<input type="checkbox"/>
01/01/2004	<i>Anthus pratensis</i>	Meadow Pipit	<input type="checkbox"/>	<input type="checkbox"/>
15/09/1993	<i>Anthus pratensis</i>	Meadow Pipit	<input type="checkbox"/>	<input type="checkbox"/>
20/04/1993	<i>Anthus pratensis</i>	Meadow Pipit	<input type="checkbox"/>	<input type="checkbox"/>
23/03/1993	<i>Anthus pratensis</i>	Meadow Pipit	<input type="checkbox"/>	<input type="checkbox"/>
07/10/1991	<i>Anthus pratensis</i>	Meadow Pipit	<input type="checkbox"/>	<input type="checkbox"/>
20/05/1991	<i>Anthus pratensis</i>	Meadow Pipit	<input type="checkbox"/>	<input type="checkbox"/>
23/03/1991	<i>Anthus pratensis</i>	Meadow Pipit	<input type="checkbox"/>	<input type="checkbox"/>
13/05/1990	<i>Anthus pratensis</i>	Meadow Pipit	<input type="checkbox"/>	<input type="checkbox"/>
14/05/1989	<i>Anthus pratensis</i>	Meadow Pipit	<input type="checkbox"/>	<input type="checkbox"/>
04/05/1985	<i>Anthus pratensis</i>	Meadow Pipit	<input type="checkbox"/>	<input type="checkbox"/>
13/04/1985	<i>Anthus pratensis</i>	Meadow Pipit	<input type="checkbox"/>	<input type="checkbox"/>
20/11/1984	<i>Anthus pratensis</i>	Meadow Pipit	<input type="checkbox"/>	<input type="checkbox"/>
06/09/1984	<i>Anthus pratensis</i>	Meadow Pipit	<input type="checkbox"/>	<input type="checkbox"/>
22/03/1984	<i>Anthus pratensis</i>	Meadow Pipit	<input type="checkbox"/>	<input type="checkbox"/>
04/03/1984	<i>Anthus pratensis</i>	Meadow Pipit	<input type="checkbox"/>	<input type="checkbox"/>
21/03/1984	<i>Anthus spinoletta</i>	Water Pipit	<input type="checkbox"/>	<input type="checkbox"/>
17/03/1984	<i>Anthus spinoletta</i>	Water Pipit	<input type="checkbox"/>	<input type="checkbox"/>
08/05/2011	<i>Apus apus</i>	Swift	<input type="checkbox"/>	<input type="checkbox"/>
27/06/2009	<i>Apus apus</i>	Swift	<input type="checkbox"/>	<input type="checkbox"/>
17/09/1993	<i>Apus apus</i>	Swift	<input type="checkbox"/>	<input type="checkbox"/>
03/08/1993	<i>Apus apus</i>	Swift	<input type="checkbox"/>	<input type="checkbox"/>
05/05/1993	<i>Apus apus</i>	Swift	<input type="checkbox"/>	<input type="checkbox"/>
07/09/1985	<i>Apus apus</i>	Swift	<input type="checkbox"/>	<input type="checkbox"/>
02/08/1985	<i>Apus apus</i>	Swift	<input type="checkbox"/>	<input type="checkbox"/>
09/08/1984	<i>Apus apus</i>	Swift	<input type="checkbox"/>	<input type="checkbox"/>
24/07/1984	<i>Apus apus</i>	Swift	<input type="checkbox"/>	<input type="checkbox"/>
04/05/1984	<i>Apus apus</i>	Swift	<input type="checkbox"/>	<input type="checkbox"/>
22/07/1982	<i>Apus apus</i>	Swift	<input type="checkbox"/>	<input type="checkbox"/>
14/09/1993	<i>Asio flammeus</i>	Short-Eared Owl	<input type="checkbox"/>	<input type="checkbox"/>
18/08/1993	<i>Asio flammeus</i>	Short-Eared Owl	<input type="checkbox"/>	<input type="checkbox"/>
12/07/1993	<i>Asio flammeus</i>	Short-Eared Owl	<input type="checkbox"/>	<input type="checkbox"/>
12/04/1993	<i>Asio flammeus</i>	Short-Eared Owl	<input type="checkbox"/>	<input type="checkbox"/>
19/02/1993	<i>Asio flammeus</i>	Short-Eared Owl	<input type="checkbox"/>	<input type="checkbox"/>
06/11/1991	<i>Asio flammeus</i>	Short-eared Owl	<input type="checkbox"/>	<input type="checkbox"/>
12/08/1991	<i>Asio flammeus</i>	Short-eared Owl	<input type="checkbox"/>	<input type="checkbox"/>
01/05/1989	<i>Asio flammeus</i>	Short-Eared Owl	<input type="checkbox"/>	<input type="checkbox"/>
01/04/1989	<i>Asio flammeus</i>	Short-Eared Owl	<input type="checkbox"/>	<input type="checkbox"/>
10/03/1985	<i>Asio flammeus</i>	Short-Eared Owl	<input type="checkbox"/>	<input type="checkbox"/>
10/03/2013	<i>Aythya ferina</i>	Pochard	<input type="checkbox"/>	<input type="checkbox"/>
10/02/2013	<i>Aythya ferina</i>	Pochard	<input type="checkbox"/>	<input type="checkbox"/>

13/01/2013	<i>Aythya ferina</i>	Pochard	<input type="checkbox"/>	<input type="checkbox"/>
06/10/1993	<i>Aythya ferina</i>	Pochard	<input type="checkbox"/>	<input type="checkbox"/>
05/07/1993	<i>Aythya ferina</i>	Pochard	<input type="checkbox"/>	<input type="checkbox"/>
19/05/1993	<i>Aythya ferina</i>	Pochard	<input type="checkbox"/>	<input type="checkbox"/>
12/05/1993	<i>Aythya ferina</i>	Pochard	<input type="checkbox"/>	<input type="checkbox"/>
08/02/1993	<i>Aythya ferina</i>	Pochard	<input type="checkbox"/>	<input type="checkbox"/>
05/05/1991	<i>Aythya ferina</i>	Common Pochard	<input type="checkbox"/>	<input type="checkbox"/>
13/03/1991	<i>Aythya ferina</i>	Common Pochard	<input type="checkbox"/>	<input type="checkbox"/>
24/03/1985	<i>Aythya ferina</i>	Pochard	<input type="checkbox"/>	<input type="checkbox"/>
23/02/1985	<i>Aythya ferina</i>	Pochard	<input type="checkbox"/>	<input type="checkbox"/>
05/01/1985	<i>Aythya ferina</i>	Pochard	<input type="checkbox"/>	<input type="checkbox"/>
31/12/1984	<i>Aythya ferina</i>	Pochard	<input type="checkbox"/>	<input type="checkbox"/>
29/02/1984	<i>Aythya ferina</i>	Pochard	<input type="checkbox"/>	<input type="checkbox"/>
10/03/2013	<i>Aythya fuligula</i>	Tufted Duck	<input type="checkbox"/>	<input type="checkbox"/>
10/02/2013	<i>Aythya fuligula</i>	Tufted Duck	<input type="checkbox"/>	<input type="checkbox"/>
13/01/2013	<i>Aythya fuligula</i>	Tufted Duck	<input type="checkbox"/>	<input type="checkbox"/>
25/09/2009	<i>Aythya fuligula</i>	Tufted Duck	<input type="checkbox"/>	<input type="checkbox"/>
24/08/2009	<i>Aythya fuligula</i>	Tufted Duck	<input type="checkbox"/>	<input type="checkbox"/>
01/01/2004	<i>Aythya fuligula</i>	Tufted Duck	<input type="checkbox"/>	<input type="checkbox"/>
09/09/1993	<i>Aythya fuligula</i>	Tufted Duck	<input type="checkbox"/>	<input type="checkbox"/>
14/04/1993	<i>Aythya fuligula</i>	Tufted Duck	<input type="checkbox"/>	<input type="checkbox"/>
01/04/1991	<i>Aythya fuligula</i>	Tufted Duck	<input type="checkbox"/>	<input type="checkbox"/>
13/05/1990	<i>Aythya fuligula</i>	Tufted Duck	<input type="checkbox"/>	<input type="checkbox"/>
12/04/1985	<i>Aythya fuligula</i>	Tufted Duck	<input type="checkbox"/>	<input type="checkbox"/>
26/07/1984	<i>Aythya fuligula</i>	Tufted Duck	<input type="checkbox"/>	<input type="checkbox"/>
03/05/1984	<i>Aythya fuligula</i>	Tufted Duck	<input type="checkbox"/>	<input type="checkbox"/>
01/06/1983	<i>Aythya fuligula</i>	Tufted Duck	<input type="checkbox"/>	<input type="checkbox"/>
29/04/1993	<i>Branta bernicla</i>	Brent Goose	<input type="checkbox"/>	<input type="checkbox"/>
17/09/1993	<i>Calcarius lapponicus</i>	Lapland Bunting	<input type="checkbox"/>	<input checked="" type="checkbox"/>
08/05/2011	<i>Charadrius dubius</i>	Little Ringed Plover	<input type="checkbox"/>	<input checked="" type="checkbox"/>
27/06/2009	<i>Charadrius dubius</i>	Little Ringed Plover	<input type="checkbox"/>	<input checked="" type="checkbox"/>
01/01/2005	<i>Charadrius dubius</i>	Little Ringed Plover	<input type="checkbox"/>	<input checked="" type="checkbox"/>
13/09/1993	<i>Charadrius dubius</i>	Little Ringed Plover	<input type="checkbox"/>	<input checked="" type="checkbox"/>
17/03/1993	<i>Charadrius dubius</i>	Little Ringed Plover	<input type="checkbox"/>	<input checked="" type="checkbox"/>
13/03/1993	<i>Charadrius dubius</i>	Little Ringed Plover	<input type="checkbox"/>	<input checked="" type="checkbox"/>
28/08/1991	<i>Charadrius dubius</i>	Little Plover	<input type="checkbox"/>	<input checked="" type="checkbox"/>
11/07/1991	<i>Charadrius dubius</i>	Little Plover	<input type="checkbox"/>	<input checked="" type="checkbox"/>
20/03/1991	<i>Charadrius dubius</i>	Little Plover	<input type="checkbox"/>	<input checked="" type="checkbox"/>
13/05/1990	<i>Charadrius dubius</i>	Little Ringed Plover	<input type="checkbox"/>	<input checked="" type="checkbox"/>
14/05/1989	<i>Charadrius dubius</i>	Little Ringed Plover	<input type="checkbox"/>	<input checked="" type="checkbox"/>
01/04/1989	<i>Charadrius dubius</i>	Little Ringed Plover	<input type="checkbox"/>	<input checked="" type="checkbox"/>
01/04/1988	<i>Charadrius dubius</i>	Little Ringed Plover	<input type="checkbox"/>	<input checked="" type="checkbox"/>
19/07/1985	<i>Charadrius dubius</i>	Little Ringed Plover	<input type="checkbox"/>	<input checked="" type="checkbox"/>
04/05/1985	<i>Charadrius dubius</i>	Little Ringed Plover	<input type="checkbox"/>	<input checked="" type="checkbox"/>
15/04/1985	<i>Charadrius dubius</i>	Little Ringed Plover	<input type="checkbox"/>	<input checked="" type="checkbox"/>

24/04/1984	<i>Charadrius dubius</i>	Little Ringed Plover	<input type="checkbox"/>	<input checked="" type="checkbox"/>
11/04/1984	<i>Charadrius dubius</i>	Little Ringed Plover	<input type="checkbox"/>	<input checked="" type="checkbox"/>
01/01/1984	<i>Charadrius dubius</i>	Little Ringed Plover	<input type="checkbox"/>	<input checked="" type="checkbox"/>
01/01/1983	<i>Charadrius dubius</i>	Little Ringed Plover	<input type="checkbox"/>	<input checked="" type="checkbox"/>
01/01/1982	<i>Charadrius dubius</i>	Little Ringed Plover	<input type="checkbox"/>	<input checked="" type="checkbox"/>
01/01/1981	<i>Charadrius dubius</i>	Little Ringed Plover	<input type="checkbox"/>	<input checked="" type="checkbox"/>
01/01/1980	<i>Charadrius dubius</i>	Little Ringed Plover	<input type="checkbox"/>	<input checked="" type="checkbox"/>
01/01/1978	<i>Charadrius dubius</i>	Little Ringed Plover	<input type="checkbox"/>	<input checked="" type="checkbox"/>
01/01/1975	<i>Charadrius dubius</i>	Little Ringed Plover	<input type="checkbox"/>	<input checked="" type="checkbox"/>
12/08/2011	<i>Chlidonias niger</i>	Black Tern	<input type="checkbox"/>	<input checked="" type="checkbox"/>
13/09/1993	<i>Chlidonias niger</i>	Black Tern	<input type="checkbox"/>	<input checked="" type="checkbox"/>
15/04/1984	<i>Chlidonias niger</i>	Black Tern	<input type="checkbox"/>	<input checked="" type="checkbox"/>
19/05/1991	<i>Circus pygargus</i>	Montagu's Harrier	<input type="checkbox"/>	<input type="checkbox"/>
07/03/2013	<i>Columba oenas</i>	Stock Dove	<input type="checkbox"/>	<input type="checkbox"/>
03/08/1993	<i>Columba oenas</i>	Stock Dove	<input type="checkbox"/>	<input type="checkbox"/>
08/01/1993	<i>Columba oenas</i>	Stock Dove	<input type="checkbox"/>	<input type="checkbox"/>
07/10/1991	<i>Columba oenas</i>	Stock Pigeon	<input type="checkbox"/>	<input type="checkbox"/>
09/01/1985	<i>Columba oenas</i>	Stock Dove	<input type="checkbox"/>	<input type="checkbox"/>
01/01/1984	<i>Columba oenas</i>	Stock Dove	<input type="checkbox"/>	<input type="checkbox"/>
03/06/2011	<i>Coturnix coturnix</i>	Quail	<input type="checkbox"/>	<input checked="" type="checkbox"/>
30/05/2011	<i>Coturnix coturnix</i>	Quail	<input type="checkbox"/>	<input checked="" type="checkbox"/>
30/05/2011	<i>Coturnix coturnix</i>	Quail	<input type="checkbox"/>	<input checked="" type="checkbox"/>
25/05/2011	<i>Coturnix coturnix</i>	Quail	<input type="checkbox"/>	<input checked="" type="checkbox"/>
11/11/1993	<i>Cygnus columbianus</i>	Bewick's Swan	<input type="checkbox"/>	<input checked="" type="checkbox"/>
10/03/1984	<i>Cygnus columbianus</i>	Bewick's Swan	<input type="checkbox"/>	<input checked="" type="checkbox"/>
31/10/2010	<i>Cygnus cygnus</i>	Whooper Swan	<input type="checkbox"/>	<input checked="" type="checkbox"/>
18/03/2009	<i>Cygnus cygnus</i>	Whooper Swan	<input type="checkbox"/>	<input checked="" type="checkbox"/>
01/02/2003	<i>Cygnus cygnus</i>	Whooper Swan	<input type="checkbox"/>	<input checked="" type="checkbox"/>
02/12/1993	<i>Cygnus cygnus</i>	Whooper Swan	<input type="checkbox"/>	<input checked="" type="checkbox"/>
11/11/1993	<i>Cygnus cygnus</i>	Whooper Swan	<input type="checkbox"/>	<input checked="" type="checkbox"/>
08/11/1993	<i>Cygnus cygnus</i>	Whooper Swan	<input type="checkbox"/>	<input checked="" type="checkbox"/>
22/10/1993	<i>Cygnus cygnus</i>	Whooper Swan	<input type="checkbox"/>	<input checked="" type="checkbox"/>
26/03/1993	<i>Cygnus cygnus</i>	Whooper Swan	<input type="checkbox"/>	<input checked="" type="checkbox"/>
27/10/1991	<i>Cygnus cygnus</i>	Whooper Swan	<input type="checkbox"/>	<input checked="" type="checkbox"/>
21/10/1991	<i>Cygnus cygnus</i>	Whooper Swan	<input type="checkbox"/>	<input checked="" type="checkbox"/>
25/03/1991	<i>Cygnus cygnus</i>	Whooper Swan	<input type="checkbox"/>	<input checked="" type="checkbox"/>
16/04/1985	<i>Cygnus cygnus</i>	Whooper Swan	<input type="checkbox"/>	<input checked="" type="checkbox"/>
18/11/1984	<i>Cygnus cygnus</i>	Whooper Swan	<input type="checkbox"/>	<input checked="" type="checkbox"/>
22/03/1984	<i>Cygnus cygnus</i>	Whooper Swan	<input type="checkbox"/>	<input checked="" type="checkbox"/>
10/03/1984	<i>Cygnus cygnus</i>	Whooper Swan	<input type="checkbox"/>	<input checked="" type="checkbox"/>
27/06/2009	<i>Delichon urbica</i>	House Martin	<input type="checkbox"/>	<input type="checkbox"/>
25/07/2000	<i>Delichon urbica</i>	House Martin	<input type="checkbox"/>	<input type="checkbox"/>
25/07/2000	<i>Delichon urbica</i>	House Martin	<input type="checkbox"/>	<input type="checkbox"/>
25/07/2000	<i>Delichon urbica</i>	House Martin	<input type="checkbox"/>	<input type="checkbox"/>
25/07/2000	<i>Delichon urbica</i>	House Martin	<input type="checkbox"/>	<input type="checkbox"/>

25/07/2000	<i>Delichon urbica</i>	House Martin	<input type="checkbox"/>	<input type="checkbox"/>
29/09/1993	<i>Delichon urbica</i>	House Martin	<input type="checkbox"/>	<input type="checkbox"/>
13/09/1993	<i>Delichon urbica</i>	House Martin	<input type="checkbox"/>	<input type="checkbox"/>
06/04/1993	<i>Delichon urbica</i>	House Martin	<input type="checkbox"/>	<input type="checkbox"/>
10/10/1989	<i>Delichon urbica</i>	House Martin	<input type="checkbox"/>	<input type="checkbox"/>
09/10/1989	<i>Delichon urbica</i>	House Martin	<input type="checkbox"/>	<input type="checkbox"/>
08/10/1989	<i>Delichon urbica</i>	House Martin	<input type="checkbox"/>	<input type="checkbox"/>
07/10/1989	<i>Delichon urbica</i>	House Martin	<input type="checkbox"/>	<input type="checkbox"/>
07/09/1985	<i>Delichon urbica</i>	House Martin	<input type="checkbox"/>	<input type="checkbox"/>
05/05/1985	<i>Delichon urbica</i>	House Martin	<input type="checkbox"/>	<input type="checkbox"/>
26/04/1985	<i>Delichon urbica</i>	House Martin	<input type="checkbox"/>	<input type="checkbox"/>
02/05/1984	<i>Delichon urbica</i>	House Martin	<input type="checkbox"/>	<input type="checkbox"/>
18/10/1991	<i>Delichon urbicum</i>	House Martin	<input type="checkbox"/>	<input type="checkbox"/>
26/04/1991	<i>Delichon urbicum</i>	House Martin	<input type="checkbox"/>	<input type="checkbox"/>
23/05/2012	<i>Egretta garzetta</i>	Little Egret	<input type="checkbox"/>	<input type="checkbox"/>
11/09/2009	<i>Egretta garzetta</i>	Little Egret	<input type="checkbox"/>	<input type="checkbox"/>
08/03/2012	<i>Emberiza schoeniclus</i>	Reed Bunting	<input checked="" type="checkbox"/>	<input type="checkbox"/>
08/03/2012	<i>Emberiza schoeniclus</i>	Reed Bunting	<input checked="" type="checkbox"/>	<input type="checkbox"/>
08/03/2012	<i>Emberiza schoeniclus</i>	Reed Bunting	<input checked="" type="checkbox"/>	<input type="checkbox"/>
08/03/2012	<i>Emberiza schoeniclus</i>	Reed Bunting	<input checked="" type="checkbox"/>	<input type="checkbox"/>
08/03/2012	<i>Emberiza schoeniclus</i>	Reed Bunting	<input checked="" type="checkbox"/>	<input type="checkbox"/>
08/03/2012	<i>Emberiza schoeniclus</i>	Reed Bunting	<input checked="" type="checkbox"/>	<input type="checkbox"/>
01/01/2005	<i>Emberiza schoeniclus</i>	Reed Bunting	<input checked="" type="checkbox"/>	<input type="checkbox"/>
01/01/2004	<i>Emberiza schoeniclus</i>	Reed Bunting	<input checked="" type="checkbox"/>	<input type="checkbox"/>
01/03/1998	<i>Emberiza schoeniclus</i>	Reed Bunting	<input checked="" type="checkbox"/>	<input type="checkbox"/>
01/03/1998	<i>Emberiza schoeniclus</i>	Reed Bunting	<input checked="" type="checkbox"/>	<input type="checkbox"/>
08/04/1993	<i>Emberiza schoeniclus</i>	Reed Bunting	<input checked="" type="checkbox"/>	<input type="checkbox"/>
10/01/1991	<i>Emberiza schoeniclus</i>	Reed Bunting	<input checked="" type="checkbox"/>	<input type="checkbox"/>
13/05/1990	<i>Emberiza schoeniclus</i>	Reed Bunting	<input checked="" type="checkbox"/>	<input type="checkbox"/>
01/01/1985	<i>Emberiza schoeniclus</i>	Reed Bunting	<input checked="" type="checkbox"/>	<input type="checkbox"/>
25/03/1984	<i>Emberiza schoeniclus</i>	Reed Bunting	<input checked="" type="checkbox"/>	<input type="checkbox"/>
29/10/1993	<i>Falco columbarius</i>	Merlin	<input type="checkbox"/>	<input checked="" type="checkbox"/>
14/09/1993	<i>Falco columbarius</i>	Merlin	<input type="checkbox"/>	<input checked="" type="checkbox"/>
21/04/1993	<i>Falco columbarius</i>	Merlin	<input type="checkbox"/>	<input checked="" type="checkbox"/>
20/01/1993	<i>Falco columbarius</i>	Merlin	<input type="checkbox"/>	<input checked="" type="checkbox"/>
21/10/1992	<i>Falco columbarius</i>	Merlin	<input type="checkbox"/>	<input checked="" type="checkbox"/>
11/11/1991	<i>Falco columbarius</i>	Merlin	<input type="checkbox"/>	<input checked="" type="checkbox"/>
12/08/1991	<i>Falco columbarius</i>	Merlin	<input type="checkbox"/>	<input checked="" type="checkbox"/>
31/01/1985	<i>Falco columbarius</i>	Merlin	<input type="checkbox"/>	<input checked="" type="checkbox"/>
12/11/2011	<i>Falco tinnunculus</i>	Kestrel	<input type="checkbox"/>	<input type="checkbox"/>
25/09/2009	<i>Falco tinnunculus</i>	Kestrel	<input type="checkbox"/>	<input type="checkbox"/>
01/01/2001	<i>Falco tinnunculus</i>	Kestrel	<input type="checkbox"/>	<input type="checkbox"/>
19/07/1993	<i>Falco tinnunculus</i>	Kestrel	<input type="checkbox"/>	<input type="checkbox"/>
21/10/1992	<i>Falco tinnunculus</i>	Kestrel	<input type="checkbox"/>	<input type="checkbox"/>
01/01/1991	<i>Falco tinnunculus</i>	Common Kestrel	<input type="checkbox"/>	<input type="checkbox"/>

01/01/1985	<i>Falco tinnunculus</i>	Kestrel	<input type="checkbox"/>	<input type="checkbox"/>
01/01/1984	<i>Falco tinnunculus</i>	Kestrel	<input type="checkbox"/>	<input type="checkbox"/>
01/01/1982	<i>Falco tinnunculus</i>	Kestrel	<input type="checkbox"/>	<input type="checkbox"/>
10/03/2013	<i>Gallinago gallinago</i>	Snipe	<input type="checkbox"/>	<input type="checkbox"/>
10/02/2013	<i>Gallinago gallinago</i>	Snipe	<input type="checkbox"/>	<input type="checkbox"/>
08/03/2012	<i>Gallinago gallinago</i>	Snipe	<input type="checkbox"/>	<input type="checkbox"/>
08/03/2012	<i>Gallinago gallinago</i>	Snipe	<input type="checkbox"/>	<input type="checkbox"/>
08/03/2012	<i>Gallinago gallinago</i>	Snipe	<input type="checkbox"/>	<input type="checkbox"/>
08/03/2012	<i>Gallinago gallinago</i>	Snipe	<input type="checkbox"/>	<input type="checkbox"/>
25/09/2009	<i>Gallinago gallinago</i>	Snipe	<input type="checkbox"/>	<input type="checkbox"/>
24/08/2009	<i>Gallinago gallinago</i>	Snipe	<input type="checkbox"/>	<input type="checkbox"/>
28/09/1993	<i>Gallinago gallinago</i>	Snipe	<input type="checkbox"/>	<input type="checkbox"/>
24/03/1993	<i>Gallinago gallinago</i>	Snipe	<input type="checkbox"/>	<input type="checkbox"/>
13/09/1991	<i>Gallinago gallinago</i>	Common Snipe	<input type="checkbox"/>	<input type="checkbox"/>
09/06/1991	<i>Gallinago gallinago</i>	Common Snipe	<input type="checkbox"/>	<input type="checkbox"/>
11/03/1991	<i>Gallinago gallinago</i>	Common Snipe	<input type="checkbox"/>	<input type="checkbox"/>
13/05/1990	<i>Gallinago gallinago</i>	Snipe	<input type="checkbox"/>	<input type="checkbox"/>
14/05/1989	<i>Gallinago gallinago</i>	Snipe	<input type="checkbox"/>	<input type="checkbox"/>
23/03/1985	<i>Gallinago gallinago</i>	Snipe	<input type="checkbox"/>	<input type="checkbox"/>
18/11/1984	<i>Gallinago gallinago</i>	Snipe	<input type="checkbox"/>	<input type="checkbox"/>
07/04/1984	<i>Gallinago gallinago</i>	Snipe	<input type="checkbox"/>	<input type="checkbox"/>
20/03/1984	<i>Gallinago gallinago</i>	Snipe	<input type="checkbox"/>	<input type="checkbox"/>
10/03/2013	<i>Haematopus ostralegus</i>	Oystercatcher	<input type="checkbox"/>	<input type="checkbox"/>
28/02/2010	<i>Haematopus ostralegus</i>	Oystercatcher	<input type="checkbox"/>	<input type="checkbox"/>
27/06/2009	<i>Haematopus ostralegus</i>	Oystercatcher	<input type="checkbox"/>	<input type="checkbox"/>
27/07/1993	<i>Haematopus ostralegus</i>	Oystercatcher	<input type="checkbox"/>	<input type="checkbox"/>
23/05/1993	<i>Haematopus ostralegus</i>	Oystercatcher	<input type="checkbox"/>	<input type="checkbox"/>
20/05/1993	<i>Haematopus ostralegus</i>	Oystercatcher	<input type="checkbox"/>	<input type="checkbox"/>
10/04/1993	<i>Haematopus ostralegus</i>	Oystercatcher	<input type="checkbox"/>	<input type="checkbox"/>
20/05/1991	<i>Haematopus ostralegus</i>	Eurasian Oystercatcher	<input type="checkbox"/>	<input type="checkbox"/>
24/03/1991	<i>Haematopus ostralegus</i>	Eurasian Oystercatcher	<input type="checkbox"/>	<input type="checkbox"/>
08/03/1991	<i>Haematopus ostralegus</i>	Eurasian Oystercatcher	<input type="checkbox"/>	<input type="checkbox"/>
14/05/1989	<i>Haematopus ostralegus</i>	Oystercatcher	<input type="checkbox"/>	<input type="checkbox"/>
08/04/1984	<i>Haematopus ostralegus</i>	Oystercatcher	<input type="checkbox"/>	<input type="checkbox"/>
27/06/2009	<i>Hirundo rustica</i>	Swallow	<input type="checkbox"/>	<input type="checkbox"/>
06/09/1993	<i>Hirundo rustica</i>	Swallow	<input type="checkbox"/>	<input type="checkbox"/>
03/04/1993	<i>Hirundo rustica</i>	Swallow	<input type="checkbox"/>	<input type="checkbox"/>
07/10/1991	<i>Hirundo rustica</i>	Barn Swallow	<input type="checkbox"/>	<input type="checkbox"/>
13/08/1991	<i>Hirundo rustica</i>	Barn Swallow	<input type="checkbox"/>	<input type="checkbox"/>
07/04/1991	<i>Hirundo rustica</i>	Barn Swallow	<input type="checkbox"/>	<input type="checkbox"/>
13/05/1990	<i>Hirundo rustica</i>	Swallow	<input type="checkbox"/>	<input type="checkbox"/>
14/05/1989	<i>Hirundo rustica</i>	Swallow	<input type="checkbox"/>	<input type="checkbox"/>
09/10/1985	<i>Hirundo rustica</i>	Swallow	<input type="checkbox"/>	<input type="checkbox"/>
12/09/1985	<i>Hirundo rustica</i>	Swallow	<input type="checkbox"/>	<input type="checkbox"/>
12/04/1985	<i>Hirundo rustica</i>	Swallow	<input type="checkbox"/>	<input type="checkbox"/>

30/09/1984	<i>Hirundo rustica</i>	Swallow	<input type="checkbox"/>	<input type="checkbox"/>
25/09/1984	<i>Hirundo rustica</i>	Swallow	<input type="checkbox"/>	<input type="checkbox"/>
22/08/1984	<i>Hirundo rustica</i>	Swallow	<input type="checkbox"/>	<input type="checkbox"/>
15/04/1984	<i>Hirundo rustica</i>	Swallow	<input type="checkbox"/>	<input type="checkbox"/>
10/02/2013	<i>Larus canus</i>	Common Gull	<input type="checkbox"/>	<input type="checkbox"/>
13/01/2013	<i>Larus canus</i>	Common Gull	<input type="checkbox"/>	<input type="checkbox"/>
15/06/1993	<i>Larus canus</i>	Common Gull	<input type="checkbox"/>	<input type="checkbox"/>
01/01/1991	<i>Larus canus</i>	Mew Gull	<input type="checkbox"/>	<input type="checkbox"/>
04/03/1984	<i>Larus canus</i>	Common Gull	<input type="checkbox"/>	<input type="checkbox"/>
25/09/2009	<i>Larus fuscus</i>	Lesser Black-Backed Gull	<input type="checkbox"/>	<input type="checkbox"/>
01/06/1993	<i>Larus fuscus</i>	Lesser Black-Backed Gull	<input type="checkbox"/>	<input type="checkbox"/>
19/09/1991	<i>Larus fuscus</i>	Lesser Black-backed Gull	<input type="checkbox"/>	<input type="checkbox"/>
13/03/1991	<i>Larus fuscus</i>	Lesser Black-backed Gull	<input type="checkbox"/>	<input type="checkbox"/>
19/05/1974	<i>Larus fuscus</i>	Lesser Black-Backed Gull	<input type="checkbox"/>	<input type="checkbox"/>
28/04/1991	<i>Larus glaucoides</i>	Iceland Gull	<input type="checkbox"/>	<input type="checkbox"/>
26/03/1991	<i>Larus glaucoides</i>	Iceland Gull	<input type="checkbox"/>	<input type="checkbox"/>
16/12/1993	<i>Larus marinus</i>	Great Black-Backed Gull	<input type="checkbox"/>	<input type="checkbox"/>
01/01/1991	<i>Larus marinus</i>	Great Black-backed Gull	<input type="checkbox"/>	<input type="checkbox"/>
01/01/1984	<i>Larus marinus</i>	Great Black-Backed Gull	<input type="checkbox"/>	<input type="checkbox"/>
29/04/2011	<i>Limosa lapponica</i>	Bar-Tailed Godwit	<input type="checkbox"/>	<input type="checkbox"/>
12/01/1993	<i>Lymnocyptes minimus</i>	Jack Snipe	<input type="checkbox"/>	<input type="checkbox"/>
06/12/1991	<i>Lymnocyptes minimus</i>	Jack Snipe	<input type="checkbox"/>	<input type="checkbox"/>
18/10/1991	<i>Lymnocyptes minimus</i>	Jack Snipe	<input type="checkbox"/>	<input type="checkbox"/>
01/04/1991	<i>Lymnocyptes minimus</i>	Jack Snipe	<input type="checkbox"/>	<input type="checkbox"/>
24/03/1991	<i>Lymnocyptes minimus</i>	Jack Snipe	<input type="checkbox"/>	<input type="checkbox"/>
19/01/1991	<i>Lymnocyptes minimus</i>	Jack Snipe	<input type="checkbox"/>	<input type="checkbox"/>
29/12/1985	<i>Lymnocyptes minimus</i>	Jack Snipe	<input type="checkbox"/>	<input type="checkbox"/>
14/02/1985	<i>Lymnocyptes minimus</i>	Jack Snipe	<input type="checkbox"/>	<input type="checkbox"/>
24/03/1984	<i>Lymnocyptes minimus</i>	Jack Snipe	<input type="checkbox"/>	<input type="checkbox"/>
14/09/1993	<i>Motacilla cinerea</i>	Grey Wagtail	<input type="checkbox"/>	<input type="checkbox"/>
28/03/1993	<i>Motacilla cinerea</i>	Grey Wagtail	<input type="checkbox"/>	<input type="checkbox"/>
28/07/1991	<i>Motacilla cinerea</i>	Grey Wagtail	<input type="checkbox"/>	<input type="checkbox"/>
21/04/1991	<i>Motacilla cinerea</i>	Grey Wagtail	<input type="checkbox"/>	<input type="checkbox"/>
18/07/1985	<i>Motacilla cinerea</i>	Grey Wagtail	<input type="checkbox"/>	<input type="checkbox"/>
23/03/1985	<i>Motacilla cinerea</i>	Grey Wagtail	<input type="checkbox"/>	<input type="checkbox"/>
21/11/1984	<i>Motacilla cinerea</i>	Grey Wagtail	<input type="checkbox"/>	<input type="checkbox"/>
07/11/1984	<i>Motacilla cinerea</i>	Grey Wagtail	<input type="checkbox"/>	<input type="checkbox"/>
04/11/1984	<i>Motacilla cinerea</i>	Grey Wagtail	<input type="checkbox"/>	<input type="checkbox"/>
23/10/1984	<i>Motacilla cinerea</i>	Grey Wagtail	<input type="checkbox"/>	<input type="checkbox"/>
06/10/1984	<i>Motacilla cinerea</i>	Grey Wagtail	<input type="checkbox"/>	<input type="checkbox"/>
30/09/1984	<i>Motacilla cinerea</i>	Grey Wagtail	<input type="checkbox"/>	<input type="checkbox"/>
10/09/1984	<i>Motacilla cinerea</i>	Grey Wagtail	<input type="checkbox"/>	<input type="checkbox"/>
06/05/1984	<i>Motacilla cinerea</i>	Grey Wagtail	<input type="checkbox"/>	<input type="checkbox"/>
15/09/1993	<i>Numenius arquata</i>	Curlew	<input checked="" type="checkbox"/>	<input type="checkbox"/>
14/09/1993	<i>Numenius arquata</i>	Curlew	<input checked="" type="checkbox"/>	<input type="checkbox"/>

15/08/1993	<i>Numenius arquata</i>	Curlew	✓	<input type="checkbox"/>
27/06/1993	<i>Numenius arquata</i>	Curlew	✓	<input type="checkbox"/>
08/06/1993	<i>Numenius arquata</i>	Curlew	✓	<input type="checkbox"/>
24/02/1993	<i>Numenius arquata</i>	Curlew	✓	<input type="checkbox"/>
29/07/1991	<i>Numenius arquata</i>	Eurasian Curlew	✓	<input type="checkbox"/>
26/07/1991	<i>Numenius arquata</i>	Eurasian Curlew	✓	<input type="checkbox"/>
19/07/1991	<i>Numenius arquata</i>	Eurasian Curlew	✓	<input type="checkbox"/>
24/04/1991	<i>Numenius arquata</i>	Eurasian Curlew	✓	<input type="checkbox"/>
11/03/1991	<i>Numenius arquata</i>	Eurasian Curlew	✓	<input type="checkbox"/>
09/03/1991	<i>Numenius arquata</i>	Eurasian Curlew	✓	<input type="checkbox"/>
16/04/1985	<i>Numenius arquata</i>	Curlew	✓	<input type="checkbox"/>
14/04/1985	<i>Numenius arquata</i>	Curlew	✓	<input type="checkbox"/>
12/04/1985	<i>Numenius arquata</i>	Curlew	✓	<input type="checkbox"/>
07/04/1985	<i>Numenius arquata</i>	Curlew	✓	<input type="checkbox"/>
02/03/1985	<i>Numenius arquata</i>	Curlew	✓	<input type="checkbox"/>
17/11/1984	<i>Numenius arquata</i>	Curlew	✓	<input type="checkbox"/>
08/08/1984	<i>Numenius arquata</i>	Curlew	✓	<input type="checkbox"/>
10/04/1984	<i>Numenius arquata</i>	Curlew	✓	<input type="checkbox"/>
24/03/1984	<i>Numenius arquata</i>	Curlew	✓	<input type="checkbox"/>
23/03/1984	<i>Numenius arquata</i>	Curlew	✓	<input type="checkbox"/>
11/05/1982	<i>Numenius arquata</i>	Curlew	✓	<input type="checkbox"/>
14/09/1993	<i>Oenanthe oenanthe</i>	Wheatear	<input type="checkbox"/>	<input type="checkbox"/>
04/04/1993	<i>Oenanthe oenanthe</i>	Wheatear	<input type="checkbox"/>	<input type="checkbox"/>
16/09/1991	<i>Oenanthe oenanthe</i>	Northern Wheatear	<input type="checkbox"/>	<input type="checkbox"/>
05/05/1991	<i>Oenanthe oenanthe</i>	Northern Wheatear	<input type="checkbox"/>	<input type="checkbox"/>
04/04/1991	<i>Oenanthe oenanthe</i>	Northern Wheatear	<input type="checkbox"/>	<input type="checkbox"/>
01/04/1989	<i>Oenanthe oenanthe</i>	Wheatear	<input type="checkbox"/>	<input type="checkbox"/>
09/09/1985	<i>Oenanthe oenanthe</i>	Wheatear	<input type="checkbox"/>	<input type="checkbox"/>
16/08/1985	<i>Oenanthe oenanthe</i>	Wheatear	<input type="checkbox"/>	<input type="checkbox"/>
30/03/1985	<i>Oenanthe oenanthe</i>	Wheatear	<input type="checkbox"/>	<input type="checkbox"/>
23/10/1984	<i>Oenanthe oenanthe</i>	Wheatear	<input type="checkbox"/>	<input type="checkbox"/>
02/09/1984	<i>Oenanthe oenanthe</i>	Wheatear	<input type="checkbox"/>	<input type="checkbox"/>
10/08/1984	<i>Oenanthe oenanthe</i>	Wheatear	<input type="checkbox"/>	<input type="checkbox"/>
05/05/1984	<i>Oenanthe oenanthe</i>	Wheatear	<input type="checkbox"/>	<input type="checkbox"/>
14/04/1984	<i>Oenanthe oenanthe</i>	Wheatear	<input type="checkbox"/>	<input type="checkbox"/>
02/04/1984	<i>Oenanthe oenanthe</i>	Wheatear	<input type="checkbox"/>	<input type="checkbox"/>
01/01/1982	<i>Oenanthe oenanthe</i>	Wheatear	<input type="checkbox"/>	<input type="checkbox"/>
24/09/1991	<i>Phoenicurus phoenicurus</i>	Common Redstart	<input type="checkbox"/>	<input type="checkbox"/>
06/05/1991	<i>Phoenicurus phoenicurus</i>	Common Redstart	<input type="checkbox"/>	<input type="checkbox"/>
13/04/2012	<i>Phylloscopus trochilus</i>	Willow Warbler	<input type="checkbox"/>	<input type="checkbox"/>
01/01/2004	<i>Phylloscopus trochilus</i>	Willow Warbler	<input type="checkbox"/>	<input type="checkbox"/>
01/01/2001	<i>Phylloscopus trochilus</i>	Willow Warbler	<input type="checkbox"/>	<input type="checkbox"/>
01/01/2001	<i>Phylloscopus trochilus</i>	Willow Warbler	<input type="checkbox"/>	<input type="checkbox"/>
29/09/1993	<i>Phylloscopus trochilus</i>	Willow Warbler	<input type="checkbox"/>	<input type="checkbox"/>
24/04/1993	<i>Phylloscopus trochilus</i>	Willow Warbler	<input type="checkbox"/>	<input type="checkbox"/>

04/04/1993	<i>Phylloscopus trochilus</i>	Willow Warbler	<input type="checkbox"/>	<input type="checkbox"/>
28/09/1991	<i>Phylloscopus trochilus</i>	Willow Warbler	<input type="checkbox"/>	<input type="checkbox"/>
08/05/1991	<i>Phylloscopus trochilus</i>	Willow Warbler	<input type="checkbox"/>	<input type="checkbox"/>
25/04/1991	<i>Phylloscopus trochilus</i>	Willow Warbler	<input type="checkbox"/>	<input type="checkbox"/>
17/09/1985	<i>Phylloscopus trochilus</i>	Willow Warbler	<input type="checkbox"/>	<input type="checkbox"/>
24/06/1985	<i>Phylloscopus trochilus</i>	Willow Warbler	<input type="checkbox"/>	<input type="checkbox"/>
22/04/1985	<i>Phylloscopus trochilus</i>	Willow Warbler	<input type="checkbox"/>	<input type="checkbox"/>
08/04/1985	<i>Phylloscopus trochilus</i>	Willow Warbler	<input type="checkbox"/>	<input type="checkbox"/>
28/08/1984	<i>Phylloscopus trochilus</i>	Willow Warbler	<input type="checkbox"/>	<input type="checkbox"/>
22/04/1984	<i>Phylloscopus trochilus</i>	Willow Warbler	<input type="checkbox"/>	<input type="checkbox"/>
21/04/1984	<i>Phylloscopus trochilus</i>	Willow Warbler	<input type="checkbox"/>	<input type="checkbox"/>
16/04/1984	<i>Phylloscopus trochilus</i>	Willow Warbler	<input type="checkbox"/>	<input type="checkbox"/>
25/07/1978	<i>Phylloscopus trochilus</i>	Willow Warbler	<input type="checkbox"/>	<input type="checkbox"/>
19/05/1977	<i>Phylloscopus trochilus</i>	Willow Warbler	<input type="checkbox"/>	<input type="checkbox"/>
06/07/2013	<i>Picus viridis</i>	Green Woodpecker	<input type="checkbox"/>	<input type="checkbox"/>
07/03/2013	<i>Picus viridis</i>	Green Woodpecker	<input type="checkbox"/>	<input type="checkbox"/>
10/10/2012	<i>Picus viridis</i>	Green Woodpecker	<input type="checkbox"/>	<input type="checkbox"/>
11/11/2011	<i>Picus viridis</i>	Green Woodpecker	<input type="checkbox"/>	<input type="checkbox"/>
25/09/2009	<i>Picus viridis</i>	Green Woodpecker	<input type="checkbox"/>	<input type="checkbox"/>
18/03/2009	<i>Picus viridis</i>	Green Woodpecker	<input type="checkbox"/>	<input type="checkbox"/>
01/01/1993	<i>Picus viridis</i>	Green Woodpecker	<input type="checkbox"/>	<input type="checkbox"/>
22/11/1991	<i>Picus viridis</i>	Green Woodpecker	<input type="checkbox"/>	<input type="checkbox"/>
01/01/1991	<i>Picus viridis</i>	Green Woodpecker	<input type="checkbox"/>	<input type="checkbox"/>
18/08/1985	<i>Picus viridis</i>	Green Woodpecker	<input type="checkbox"/>	<input type="checkbox"/>
02/03/1985	<i>Picus viridis</i>	Green Woodpecker	<input type="checkbox"/>	<input type="checkbox"/>
18/05/1984	<i>Picus viridis</i>	Green Woodpecker	<input type="checkbox"/>	<input type="checkbox"/>
19/08/2009	<i>Platalea leucorodia</i>	Spoonbill	<input type="checkbox"/>	<input checked="" type="checkbox"/>
18/08/2009	<i>Platalea leucorodia</i>	Spoonbill	<input type="checkbox"/>	<input checked="" type="checkbox"/>
09/10/2011	<i>Pluvialis squatarola</i>	Grey Plover	<input type="checkbox"/>	<input type="checkbox"/>
26/09/1993	<i>Pluvialis squatarola</i>	Grey Plover	<input type="checkbox"/>	<input type="checkbox"/>
17/09/1993	<i>Pluvialis squatarola</i>	Grey Plover	<input type="checkbox"/>	<input type="checkbox"/>
14/09/1993	<i>Pluvialis squatarola</i>	Grey Plover	<input type="checkbox"/>	<input type="checkbox"/>
13/09/1993	<i>Pluvialis squatarola</i>	Grey Plover	<input type="checkbox"/>	<input type="checkbox"/>
01/10/1991	<i>Pluvialis squatarola</i>	Grey Plover	<input type="checkbox"/>	<input type="checkbox"/>
01/03/1991	<i>Pluvialis squatarola</i>	Grey Plover	<input type="checkbox"/>	<input type="checkbox"/>
16/09/1984	<i>Pluvialis squatarola</i>	Grey Plover	<input type="checkbox"/>	<input type="checkbox"/>
25/09/2009	<i>Prunella modularis</i>	Dunnock	<input type="checkbox"/>	<input type="checkbox"/>
27/12/1993	<i>Prunella modularis</i>	Dunnock	<input type="checkbox"/>	<input type="checkbox"/>
01/12/1985	<i>Prunella modularis</i>	Dunnock	<input type="checkbox"/>	<input type="checkbox"/>
01/01/1984	<i>Prunella modularis</i>	Dunnock	<input type="checkbox"/>	<input type="checkbox"/>
01/01/2001	<i>Pyrrhula pyrrhula</i>	Bullfinch	<input type="checkbox"/>	<input type="checkbox"/>
09/11/1993	<i>Pyrrhula pyrrhula</i>	Bullfinch	<input type="checkbox"/>	<input type="checkbox"/>
10/11/1991	<i>Pyrrhula pyrrhula</i>	Common Bullfinch	<input type="checkbox"/>	<input type="checkbox"/>
20/10/1985	<i>Pyrrhula pyrrhula</i>	Bullfinch	<input type="checkbox"/>	<input type="checkbox"/>
15/01/1985	<i>Pyrrhula pyrrhula</i>	Bullfinch	<input type="checkbox"/>	<input type="checkbox"/>

19/05/1984	<i>Pyrrhula pyrrhula</i>	Bullfinch		
22/05/2011	<i>Recurvirostra avosetta</i>	Avocet	<input type="checkbox"/>	<input type="checkbox"/>
08/05/2011	<i>Recurvirostra avosetta</i>	Avocet	<input type="checkbox"/>	<input type="checkbox"/>
05/05/2011	<i>Recurvirostra avosetta</i>	Avocet	<input type="checkbox"/>	<input type="checkbox"/>
25/04/2011	<i>Recurvirostra avosetta</i>	Avocet	<input type="checkbox"/>	<input type="checkbox"/>
04/04/2011	<i>Recurvirostra avosetta</i>	Avocet	<input type="checkbox"/>	<input type="checkbox"/>
01/01/2005	<i>Recurvirostra avosetta</i>	Avocet	<input type="checkbox"/>	<input type="checkbox"/>
17/09/1993	<i>Riparia riparia</i>	Sand Martin	<input type="checkbox"/>	<input type="checkbox"/>
16/05/1993	<i>Riparia riparia</i>	Sand Martin	<input type="checkbox"/>	<input type="checkbox"/>
18/04/1993	<i>Riparia riparia</i>	Sand Martin	<input type="checkbox"/>	<input type="checkbox"/>
18/03/1993	<i>Riparia riparia</i>	Sand Martin	<input type="checkbox"/>	<input type="checkbox"/>
17/10/1991	<i>Riparia riparia</i>	Sand Martin	<input type="checkbox"/>	<input type="checkbox"/>
17/03/1991	<i>Riparia riparia</i>	Sand Martin	<input type="checkbox"/>	<input type="checkbox"/>
15/07/1985	<i>Riparia riparia</i>	Sand Martin	<input type="checkbox"/>	<input type="checkbox"/>
18/05/1985	<i>Riparia riparia</i>	Sand Martin	<input type="checkbox"/>	<input type="checkbox"/>
05/05/1985	<i>Riparia riparia</i>	Sand Martin	<input type="checkbox"/>	<input type="checkbox"/>
03/05/1985	<i>Riparia riparia</i>	Sand Martin	<input type="checkbox"/>	<input type="checkbox"/>
24/04/1985	<i>Riparia riparia</i>	Sand Martin	<input type="checkbox"/>	<input type="checkbox"/>
03/05/1984	<i>Riparia riparia</i>	Sand Martin	<input type="checkbox"/>	<input type="checkbox"/>
10/04/1984	<i>Riparia riparia</i>	Sand Martin	<input type="checkbox"/>	<input type="checkbox"/>
01/03/1978	<i>Riparia riparia</i>	Sand Martin	<input type="checkbox"/>	<input type="checkbox"/>
01/04/1991	<i>Rissa tridactyla</i>	Black-legged Kittiwake	<input type="checkbox"/>	<input type="checkbox"/>
26/03/1991	<i>Rissa tridactyla</i>	Black-legged Kittiwake	<input type="checkbox"/>	<input type="checkbox"/>
04/03/1991	<i>Rissa tridactyla</i>	Black-legged Kittiwake	<input type="checkbox"/>	<input type="checkbox"/>
04/03/1985	<i>Rissa tridactyla</i>	Kittiwake	<input type="checkbox"/>	<input type="checkbox"/>
14/09/1993	<i>Saxicola rubetra</i>	Whinchat	<input type="checkbox"/>	<input type="checkbox"/>
13/05/1993	<i>Saxicola rubetra</i>	Whinchat	<input type="checkbox"/>	<input type="checkbox"/>
04/09/1991	<i>Saxicola rubetra</i>	Whinchat	<input type="checkbox"/>	<input type="checkbox"/>
01/07/1991	<i>Saxicola rubetra</i>	Whinchat	<input type="checkbox"/>	<input type="checkbox"/>
22/07/1985	<i>Saxicola rubetra</i>	Whinchat	<input type="checkbox"/>	<input type="checkbox"/>
02/05/1985	<i>Saxicola rubetra</i>	Whinchat	<input type="checkbox"/>	<input type="checkbox"/>
26/04/1985	<i>Saxicola rubetra</i>	Whinchat	<input type="checkbox"/>	<input type="checkbox"/>
20/08/1984	<i>Saxicola rubetra</i>	Whinchat	<input type="checkbox"/>	<input type="checkbox"/>
05/07/1984	<i>Saxicola rubetra</i>	Whinchat	<input type="checkbox"/>	<input type="checkbox"/>
23/04/1984	<i>Saxicola rubetra</i>	Whinchat	<input type="checkbox"/>	<input type="checkbox"/>
01/01/1978	<i>Saxicola rubetra</i>	Whinchat	<input type="checkbox"/>	<input type="checkbox"/>
01/04/1989	<i>Scolopax rusticola</i>	Woodcock	<input type="checkbox"/>	<input type="checkbox"/>
21/08/2011	<i>Sterna hirundo</i>	Common Tern	<input type="checkbox"/>	<input type="checkbox"/>
12/05/1993	<i>Sterna hirundo</i>	Common Tern	<input type="checkbox"/>	<input type="checkbox"/>
17/10/1991	<i>Sterna hirundo</i>	Common Tern	<input type="checkbox"/>	<input type="checkbox"/>
10/07/1991	<i>Sterna hirundo</i>	Common Tern	<input type="checkbox"/>	<input type="checkbox"/>
20/05/1991	<i>Sterna hirundo</i>	Common Tern	<input type="checkbox"/>	<input type="checkbox"/>
28/04/1993	<i>Sterna paradisaea</i>	Arctic Tern	<input type="checkbox"/>	<input type="checkbox"/>
10/05/1991	<i>Sterna paradisaea</i>	Arctic Tern	<input type="checkbox"/>	<input type="checkbox"/>
13/09/1993	<i>Sterna sandvicensis</i>	Sandwich Tern	<input type="checkbox"/>	<input type="checkbox"/>

06/05/1993	<i>Sterna sandvicensis</i>	Sandwich Tern	<input type="checkbox"/>	<input type="checkbox"/>
08/05/2011	<i>Sylvia communis</i>	Whitethroat	<input type="checkbox"/>	<input type="checkbox"/>
01/01/2004	<i>Sylvia communis</i>	Common Whitethroat	<input type="checkbox"/>	<input type="checkbox"/>
28/09/1993	<i>Sylvia communis</i>	Whitethroat	<input type="checkbox"/>	<input type="checkbox"/>
12/05/1993	<i>Sylvia communis</i>	Whitethroat	<input type="checkbox"/>	<input type="checkbox"/>
20/04/1993	<i>Sylvia communis</i>	Whitethroat	<input type="checkbox"/>	<input type="checkbox"/>
24/04/1991	<i>Sylvia communis</i>	Common Whitethroat	<input type="checkbox"/>	<input type="checkbox"/>
12/09/1985	<i>Sylvia communis</i>	Whitethroat	<input type="checkbox"/>	<input type="checkbox"/>
19/05/1985	<i>Sylvia communis</i>	Whitethroat	<input type="checkbox"/>	<input type="checkbox"/>
04/05/1985	<i>Sylvia communis</i>	Whitethroat	<input type="checkbox"/>	<input type="checkbox"/>
05/07/1984	<i>Sylvia communis</i>	Whitethroat	<input type="checkbox"/>	<input type="checkbox"/>
26/04/1984	<i>Sylvia communis</i>	Whitethroat	<input type="checkbox"/>	<input type="checkbox"/>
25/09/2009	<i>Tachybaptus ruficollis</i>	Little Grebe	<input type="checkbox"/>	<input type="checkbox"/>
24/08/2009	<i>Tachybaptus ruficollis</i>	Little Grebe	<input type="checkbox"/>	<input type="checkbox"/>
01/01/2004	<i>Tachybaptus ruficollis</i>	Little Grebe	<input type="checkbox"/>	<input type="checkbox"/>
01/01/1999	<i>Tachybaptus ruficollis</i>	Little Grebe	<input type="checkbox"/>	<input type="checkbox"/>
27/03/1993	<i>Tachybaptus ruficollis</i>	Little Grebe	<input type="checkbox"/>	<input type="checkbox"/>
23/02/1991	<i>Tachybaptus ruficollis</i>	Little Grebe	<input type="checkbox"/>	<input type="checkbox"/>
13/05/1990	<i>Tachybaptus ruficollis</i>	Little Grebe	<input type="checkbox"/>	<input type="checkbox"/>
14/05/1989	<i>Tachybaptus ruficollis</i>	Little Grebe	<input type="checkbox"/>	<input type="checkbox"/>
01/04/1989	<i>Tachybaptus ruficollis</i>	Little Grebe	<input type="checkbox"/>	<input type="checkbox"/>
01/04/1988	<i>Tachybaptus ruficollis</i>	Little Grebe	<input type="checkbox"/>	<input type="checkbox"/>
23/11/1985	<i>Tachybaptus ruficollis</i>	Little Grebe	<input type="checkbox"/>	<input type="checkbox"/>
23/12/1984	<i>Tachybaptus ruficollis</i>	Little Grebe	<input type="checkbox"/>	<input type="checkbox"/>
22/10/1984	<i>Tachybaptus ruficollis</i>	Little Grebe	<input type="checkbox"/>	<input type="checkbox"/>
29/03/1984	<i>Tachybaptus ruficollis</i>	Little Grebe	<input type="checkbox"/>	<input type="checkbox"/>
18/03/1984	<i>Tachybaptus ruficollis</i>	Little Grebe	<input type="checkbox"/>	<input type="checkbox"/>
07/04/1975	<i>Tachybaptus ruficollis</i>	Little Grebe	<input type="checkbox"/>	<input type="checkbox"/>
06/07/2013	<i>Tadorna tadorna</i>	Shelduck	<input type="checkbox"/>	<input type="checkbox"/>
10/03/2013	<i>Tadorna tadorna</i>	Shelduck	<input type="checkbox"/>	<input type="checkbox"/>
10/02/2013	<i>Tadorna tadorna</i>	Shelduck	<input type="checkbox"/>	<input type="checkbox"/>
13/01/2013	<i>Tadorna tadorna</i>	Shelduck	<input type="checkbox"/>	<input type="checkbox"/>
14/10/1993	<i>Tadorna tadorna</i>	Shelduck	<input type="checkbox"/>	<input type="checkbox"/>
12/06/1993	<i>Tadorna tadorna</i>	Shelduck	<input type="checkbox"/>	<input type="checkbox"/>
31/03/1993	<i>Tadorna tadorna</i>	Shelduck	<input type="checkbox"/>	<input type="checkbox"/>
24/04/1991	<i>Tadorna tadorna</i>	Common Shelduck	<input type="checkbox"/>	<input type="checkbox"/>
10/04/1991	<i>Tadorna tadorna</i>	Common Shelduck	<input type="checkbox"/>	<input type="checkbox"/>
04/04/1991	<i>Tadorna tadorna</i>	Common Shelduck	<input type="checkbox"/>	<input type="checkbox"/>
29/03/1991	<i>Tadorna tadorna</i>	Common Shelduck	<input type="checkbox"/>	<input type="checkbox"/>
14/05/1989	<i>Tadorna tadorna</i>	Shelduck	<input type="checkbox"/>	<input type="checkbox"/>
01/04/1989	<i>Tadorna tadorna</i>	Shelduck	<input type="checkbox"/>	<input type="checkbox"/>
23/04/1985	<i>Tadorna tadorna</i>	Shelduck	<input type="checkbox"/>	<input type="checkbox"/>
01/01/1984	<i>Tadorna tadorna</i>	Shelduck	<input type="checkbox"/>	<input type="checkbox"/>
08/09/1984	<i>Tringa erythropus</i>	Spotted Redshank	<input type="checkbox"/>	<input type="checkbox"/>
21/08/1982	<i>Tringa erythropus</i>	Spotted Redshank	<input type="checkbox"/>	<input type="checkbox"/>

14/08/1982	<i>Tringa erythropus</i>	Spotted Redshank	<input type="checkbox"/>	<input type="checkbox"/>
10/03/2013	<i>Tringa ochropus</i>	Green Sandpiper	<input type="checkbox"/>	<input checked="" type="checkbox"/>
19/08/2011	<i>Tringa ochropus</i>	Green Sandpiper	<input type="checkbox"/>	<input checked="" type="checkbox"/>
14/08/2011	<i>Tringa ochropus</i>	Green Sandpiper	<input type="checkbox"/>	<input checked="" type="checkbox"/>
24/08/2009	<i>Tringa ochropus</i>	Green Sandpiper	<input type="checkbox"/>	<input checked="" type="checkbox"/>
15/09/1993	<i>Tringa ochropus</i>	Green Sandpiper	<input type="checkbox"/>	<input checked="" type="checkbox"/>
13/08/1993	<i>Tringa ochropus</i>	Green Sandpiper	<input type="checkbox"/>	<input checked="" type="checkbox"/>
29/06/1993	<i>Tringa ochropus</i>	Green Sandpiper	<input type="checkbox"/>	<input checked="" type="checkbox"/>
04/06/1993	<i>Tringa ochropus</i>	Green Sandpiper	<input type="checkbox"/>	<input checked="" type="checkbox"/>
19/04/1993	<i>Tringa ochropus</i>	Green Sandpiper	<input type="checkbox"/>	<input checked="" type="checkbox"/>
01/10/1991	<i>Tringa ochropus</i>	Green Sandpiper	<input type="checkbox"/>	<input checked="" type="checkbox"/>
15/08/1991	<i>Tringa ochropus</i>	Green Sandpiper	<input type="checkbox"/>	<input checked="" type="checkbox"/>
13/08/1991	<i>Tringa ochropus</i>	Green Sandpiper	<input type="checkbox"/>	<input checked="" type="checkbox"/>
27/06/1991	<i>Tringa ochropus</i>	Green Sandpiper	<input type="checkbox"/>	<input checked="" type="checkbox"/>
13/04/1991	<i>Tringa ochropus</i>	Green Sandpiper	<input type="checkbox"/>	<input checked="" type="checkbox"/>
11/03/1991	<i>Tringa ochropus</i>	Green Sandpiper	<input type="checkbox"/>	<input checked="" type="checkbox"/>
22/10/1990	<i>Tringa ochropus</i>	Green Sandpiper	<input type="checkbox"/>	<input checked="" type="checkbox"/>
26/07/1985	<i>Tringa ochropus</i>	Green Sandpiper	<input type="checkbox"/>	<input checked="" type="checkbox"/>
04/05/1985	<i>Tringa ochropus</i>	Green Sandpiper	<input type="checkbox"/>	<input checked="" type="checkbox"/>
31/03/1985	<i>Tringa ochropus</i>	Green Sandpiper	<input type="checkbox"/>	<input checked="" type="checkbox"/>
22/02/1985	<i>Tringa ochropus</i>	Green Sandpiper	<input type="checkbox"/>	<input checked="" type="checkbox"/>
22/02/1985	<i>Tringa ochropus</i>	Green Sandpiper	<input type="checkbox"/>	<input checked="" type="checkbox"/>
25/08/1984	<i>Tringa ochropus</i>	Green Sandpiper	<input type="checkbox"/>	<input checked="" type="checkbox"/>
05/08/1984	<i>Tringa ochropus</i>	Green Sandpiper	<input type="checkbox"/>	<input checked="" type="checkbox"/>
04/07/1984	<i>Tringa ochropus</i>	Green Sandpiper	<input type="checkbox"/>	<input checked="" type="checkbox"/>
17/06/1984	<i>Tringa ochropus</i>	Green Sandpiper	<input type="checkbox"/>	<input checked="" type="checkbox"/>
03/05/1984	<i>Tringa ochropus</i>	Green Sandpiper	<input type="checkbox"/>	<input checked="" type="checkbox"/>
21/04/1984	<i>Tringa ochropus</i>	Green Sandpiper	<input type="checkbox"/>	<input checked="" type="checkbox"/>
14/08/1982	<i>Tringa ochropus</i>	Green Sandpiper	<input type="checkbox"/>	<input checked="" type="checkbox"/>
07/08/1982	<i>Tringa ochropus</i>	Green Sandpiper	<input type="checkbox"/>	<input checked="" type="checkbox"/>
04/11/1977	<i>Tringa ochropus</i>	Green Sandpiper	<input type="checkbox"/>	<input checked="" type="checkbox"/>
02/11/1977	<i>Tringa ochropus</i>	Green Sandpiper	<input type="checkbox"/>	<input checked="" type="checkbox"/>
08/05/2011	<i>Tringa totanus</i>	Redshank	<input type="checkbox"/>	<input type="checkbox"/>
27/06/2009	<i>Tringa totanus</i>	Redshank	<input type="checkbox"/>	<input type="checkbox"/>
01/01/2004	<i>Tringa totanus</i>	Common Redshank	<input type="checkbox"/>	<input type="checkbox"/>
16/10/1993	<i>Tringa totanus</i>	Redshank	<input type="checkbox"/>	<input type="checkbox"/>
06/04/1993	<i>Tringa totanus</i>	Redshank	<input type="checkbox"/>	<input type="checkbox"/>
14/02/1993	<i>Tringa totanus</i>	Redshank	<input type="checkbox"/>	<input type="checkbox"/>
08/10/1991	<i>Tringa totanus</i>	Common Redshank	<input type="checkbox"/>	<input type="checkbox"/>
01/04/1991	<i>Tringa totanus</i>	Common Redshank	<input type="checkbox"/>	<input type="checkbox"/>
05/01/1991	<i>Tringa totanus</i>	Common Redshank	<input type="checkbox"/>	<input type="checkbox"/>
13/05/1990	<i>Tringa totanus</i>	Redshank	<input type="checkbox"/>	<input type="checkbox"/>
12/04/1990	<i>Tringa totanus</i>	Redshank	<input type="checkbox"/>	<input type="checkbox"/>
14/05/1989	<i>Tringa totanus</i>	Redshank	<input type="checkbox"/>	<input type="checkbox"/>
01/04/1989	<i>Tringa totanus</i>	Redshank	<input type="checkbox"/>	<input type="checkbox"/>

01/04/1985	<i>Tringa totanus</i>	Redshank	<input type="checkbox"/>	<input type="checkbox"/>
07/11/1984	<i>Tringa totanus</i>	Redshank	<input type="checkbox"/>	<input type="checkbox"/>
01/01/1984	<i>Tringa totanus</i>	Redshank	<input type="checkbox"/>	<input type="checkbox"/>
01/01/1983	<i>Tringa totanus</i>	Redshank	<input type="checkbox"/>	<input type="checkbox"/>
01/01/1982	<i>Tringa totanus</i>	Redshank	<input type="checkbox"/>	<input type="checkbox"/>
01/01/1981	<i>Tringa totanus</i>	Redshank	<input type="checkbox"/>	<input type="checkbox"/>
01/01/1978	<i>Tringa totanus</i>	Redshank	<input type="checkbox"/>	<input type="checkbox"/>
01/01/1977	<i>Tringa totanus</i>	Redshank	<input type="checkbox"/>	<input type="checkbox"/>
01/01/1976	<i>Tringa totanus</i>	Redshank	<input type="checkbox"/>	<input type="checkbox"/>
07/05/1975	<i>Tringa totanus</i>	Redshank	<input type="checkbox"/>	<input type="checkbox"/>
01/01/1975	<i>Tringa totanus</i>	Redshank	<input type="checkbox"/>	<input type="checkbox"/>
01/01/1974	<i>Tringa totanus</i>	Redshank	<input type="checkbox"/>	<input type="checkbox"/>
07/03/2013	<i>Turdus viscivorus</i>	Mistle Thrush	<input type="checkbox"/>	<input type="checkbox"/>
21/02/2013	<i>Turdus viscivorus</i>	Mistle Thrush	<input type="checkbox"/>	<input type="checkbox"/>
26/06/1993	<i>Turdus viscivorus</i>	Mistle Thrush	<input type="checkbox"/>	<input type="checkbox"/>
01/11/1991	<i>Turdus viscivorus</i>	Mistle Thrush	<input type="checkbox"/>	<input type="checkbox"/>
21/09/1985	<i>Turdus viscivorus</i>	Mistle Thrush	<input type="checkbox"/>	<input type="checkbox"/>
07/05/1984	<i>Turdus viscivorus</i>	Mistle Thrush	<input type="checkbox"/>	<input type="checkbox"/>
17/12/1993	<i>Tyto alba</i>	Barn Owl	<input type="checkbox"/>	<input checked="" type="checkbox"/>
05/12/1993	<i>Tyto alba</i>	Barn Owl	<input type="checkbox"/>	<input checked="" type="checkbox"/>
23/04/1993	<i>Tyto alba</i>	Barn Owl	<input type="checkbox"/>	<input checked="" type="checkbox"/>
04/04/1993	<i>Tyto alba</i>	Barn Owl	<input type="checkbox"/>	<input checked="" type="checkbox"/>
18/02/1993	<i>Tyto alba</i>	Barn Owl	<input type="checkbox"/>	<input checked="" type="checkbox"/>
13/10/1991	<i>Tyto alba</i>	Barn Owl	<input type="checkbox"/>	<input checked="" type="checkbox"/>
28/12/1985	<i>Tyto alba</i>	Barn Owl	<input type="checkbox"/>	<input checked="" type="checkbox"/>
27/03/1985	<i>Tyto alba</i>	Barn Owl	<input type="checkbox"/>	<input checked="" type="checkbox"/>
03/07/1978	<i>Tyto alba</i>	Barn Owl	<input type="checkbox"/>	<input checked="" type="checkbox"/>
02/02/1975	<i>Tyto alba</i>	Barn Owl	<input type="checkbox"/>	<input checked="" type="checkbox"/>



Enzygo specialise in a wide range of technical services:

- Property and Sites**
- Waste Planning**
- Waste Technologies and Renewables**
- Waste Technologies**
- Landscape Architecture**
- Environmental Co-ordination**
- Hydrology and Flood Risk**
- Waste Contract Procurement**
- Minerals Planning**
- Noise and Vibration**
- Permitting and Regulation**
- Environmental Planning**
- Ecology Services**
- Contaminated Land and Geotechnical**

BRISTOL OFFICE

The Granary
Woodend Lane
Cromhall
Bristol GL12 8AA
Tel: 01454 269237
Fax: 01454 269760

kevin.parr@enzygo.com

SHEFFIELD OFFICE

STEP Business Centre
Wortley Road
Deepcar
Sheffield S36 2UH
Tel: 0114 2903677
Fax: 0114 2903688

matt.travis@enzygo.com

MONMOUTH OFFICE, WALES

Singleton Court Business Park
Wonastow Road
Monmouth
Monmouthshire NP25 5JA
Tel: 01600 714611
Fax: 01600 716744

chris.formaggia@enzygo.com

Please visit our website for more information.

enzygo.com