

3 PROPOSED GROUND FLOOR PLAN FOR ANNEX
1 : 50

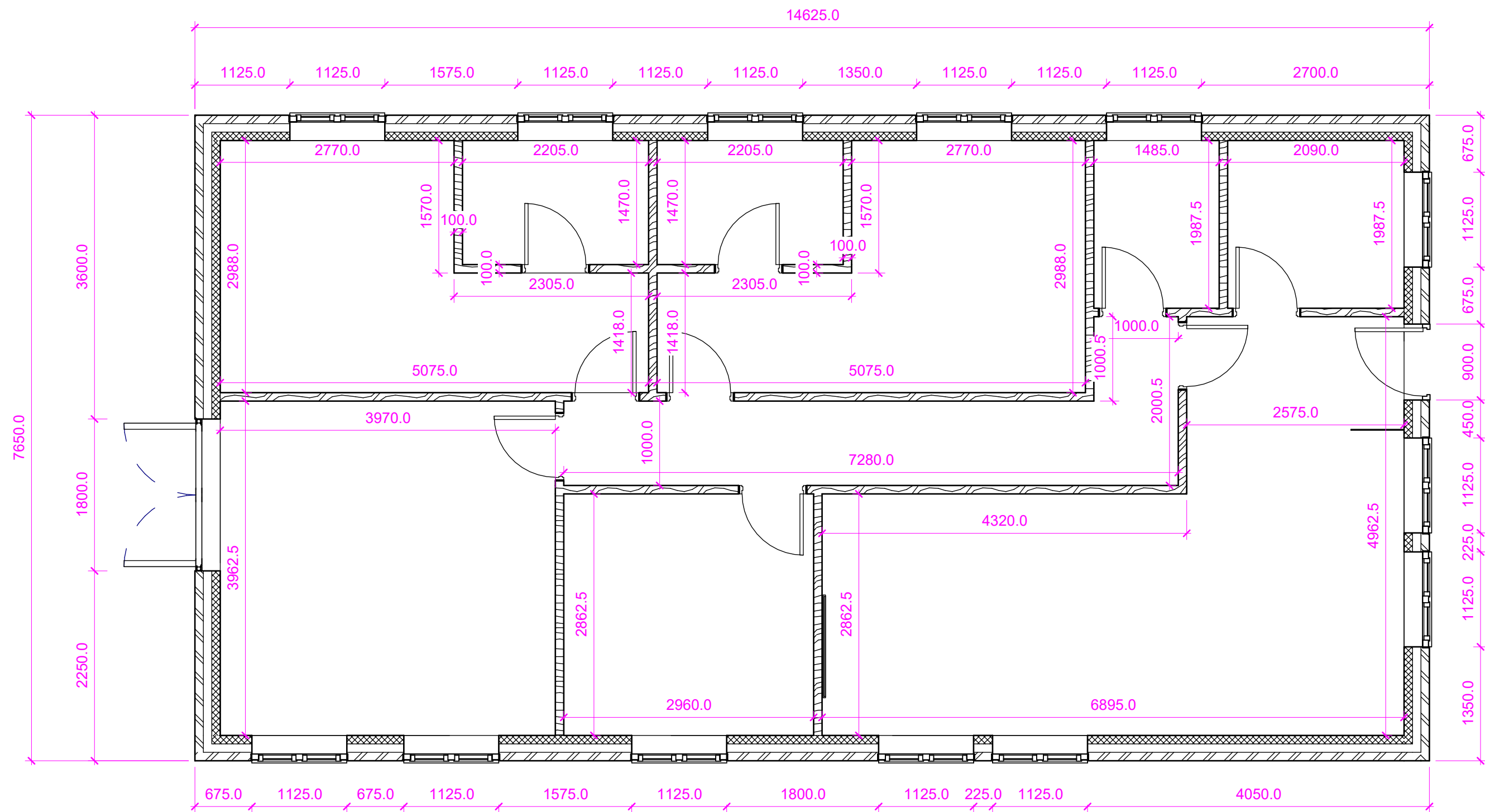

4 PROPOSED GROUND FLOOR PLAN FOR ANNEX
DIMENSIONS ONLY
1 : 50

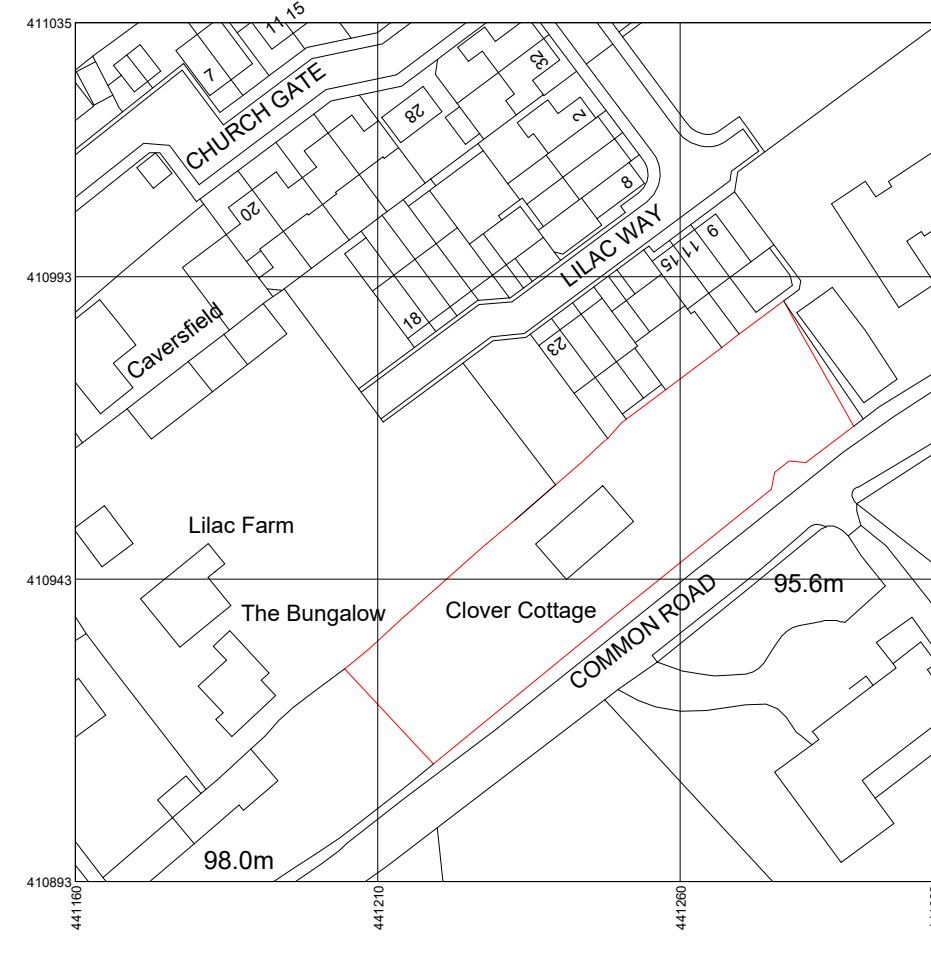

1 LOCATION PLAN
1 : 1250

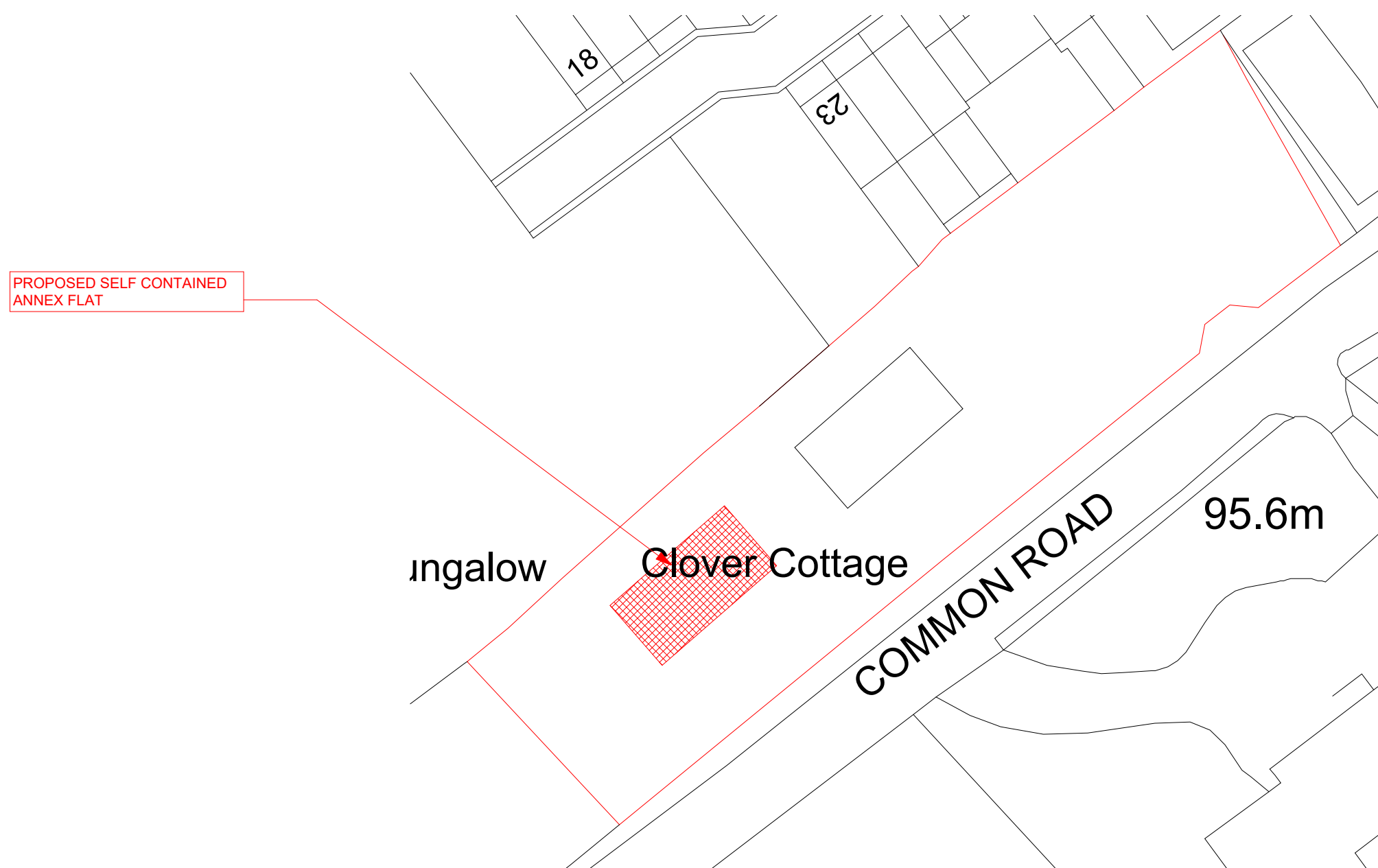

2 SITE PLAN
1 : 500

PROTECTED BY UK COPYRIGHT LAW

NOTE

1. ALL BUILDERS WORKS TO BE FULLY CHECKED WITH BUILDING REGULATIONS PRIOR TO CONSTRUCTION.
2. FINAL DRAINAGE POSITIONS TO BE CONFIRMED BETWEEN CLIENT AND BUILDER.
3. THESE PLANS ARE FOR BUILDING REGULATION APPROVAL ONLY, IF ANY DISCREPANCIES ARE FOUND ON SITE THEN THE CLIENT SHOULD CONTACT ENHANCED BUILDING PLANS OR THE ASSIGNED ENGINEER.
4. FINAL POSITION/SIZE OF DOOR AND WINDOW TO BE AGREED BETWEEN BUILDER AND CLIENT.
5. STEEL BEAM LENGTHS TO BE CHECKED ON SITE BY BUILDER.
6. ALL DIMENSIONS TO BE CHECKED BEFORE CONSTRUCTION COMMENCES.
7. ROOF PITCH TO BE CHECKED ON SITE BY BUILDER BEFORE ROOF TRUSS ARE ORDERED.
8. FINAL STAIRS POSITION AND MEASUREMENTS TO BE CHECKED AND CONFIRMED BY BUILDER.
9. ALL DIMENSIONS ARE TAKEN BEFORE PLASTERBOARD IS INSTALLED.

LEGEND

	BRICK
	BREEZE BLOCK
	TIMBER
	CONCRETE
	OUTLINE FOR STEEL BEAM
FD30	30 MINUTE FIRE DOOR
RWP	RAIN WATER PIPE
SVP	SOIL VENT PIPE
	UNDERGROUND DRAINAGE

ALL STEEL BEAMS TO BE SIZED BY A STRUCTURAL ENGINEER
ACTUAL LENGTH OF BEAM TO BE CONFIRMED ON SITE BEFORE ORDERING. THIS SHOULD INCLUDE THE SPAN AND THE PADSTONE SIZE CONFIRMED BY THE STRUCTURAL ENGINEER

REV	DESCRIPTION	DATE
-----	-------------	------

STATUS



Address: 95 Church Villas
South Kirkby
Pontefract
West Yorkshire
WF9 3 QR
Mobile: 07730666631
Email: scott@enhancedbuildingplans.co.uk
Web: www.enhancedbuildingplans.co.uk

PROJECT
CLOVER COTTAGE
COMMON ROAD
SOUTH BRIERLEY
S72 9EA

TITLE
PROPOSED BAY WINDOW AND SELF
CONTAINED ANNEX
LOCATION PLAN, SITE PLAN AND EXISTING AND
PROPOSED FLOOR PLANS

CLIENT
JAMES FULLARTON

DRAWN BY SS	CHECKED BY SS	DATE 22/11/23
----------------	------------------	------------------

SCALE AS INDICATED @ A1	PROJECT NUMBER 0174
----------------------------	------------------------

DRAWING NUMBER 0174-EBP-PL-001	REV
-----------------------------------	-----