

Area to be marked with paint as illustrated for Colleague access and Zebra crossing

Water

Proposed New 28x 1m high Steel Bollards for Protection.

Proposed new click and collect parking and canopy above finished in Red RAL 3020, supported on steel post of colour white RAL 9010 and 5x new bollards.
 Conopy area : 70.81 Sq.M
 Total Area : 168.48 Sq.M

Existing Dotcom Parking Zone re-configured with 2x additional Parking bays and access gate, Fence , Armco barriers with Charging Stations re-aligned as illustrated and 1x New Pedestrian Access gate.
 Area: 505.24 Sq.M

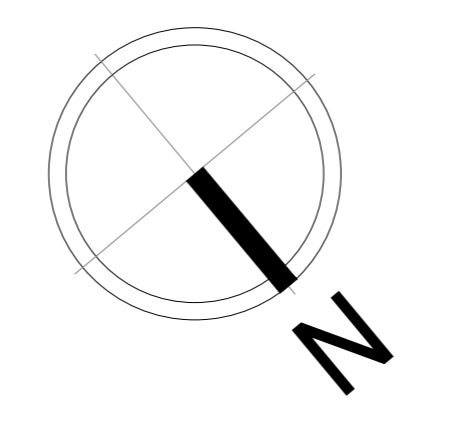
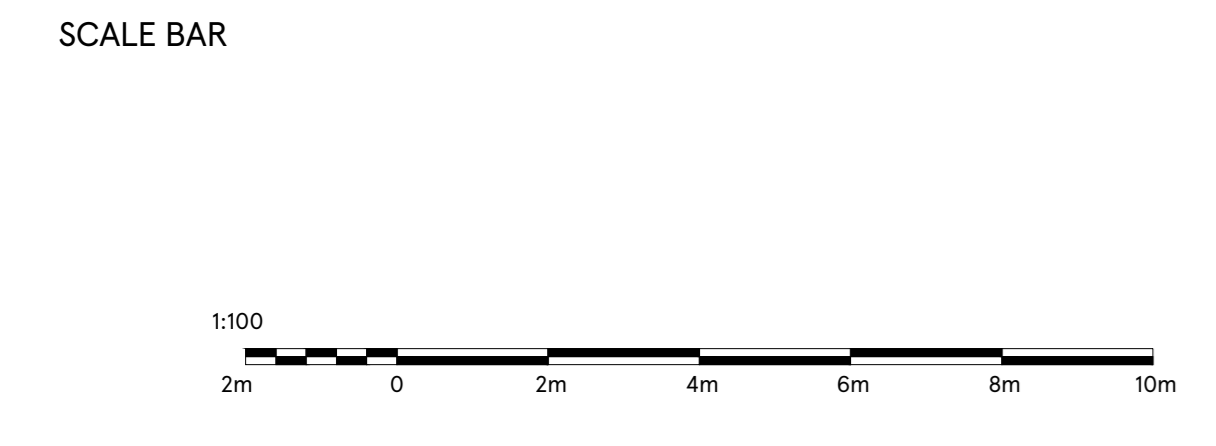
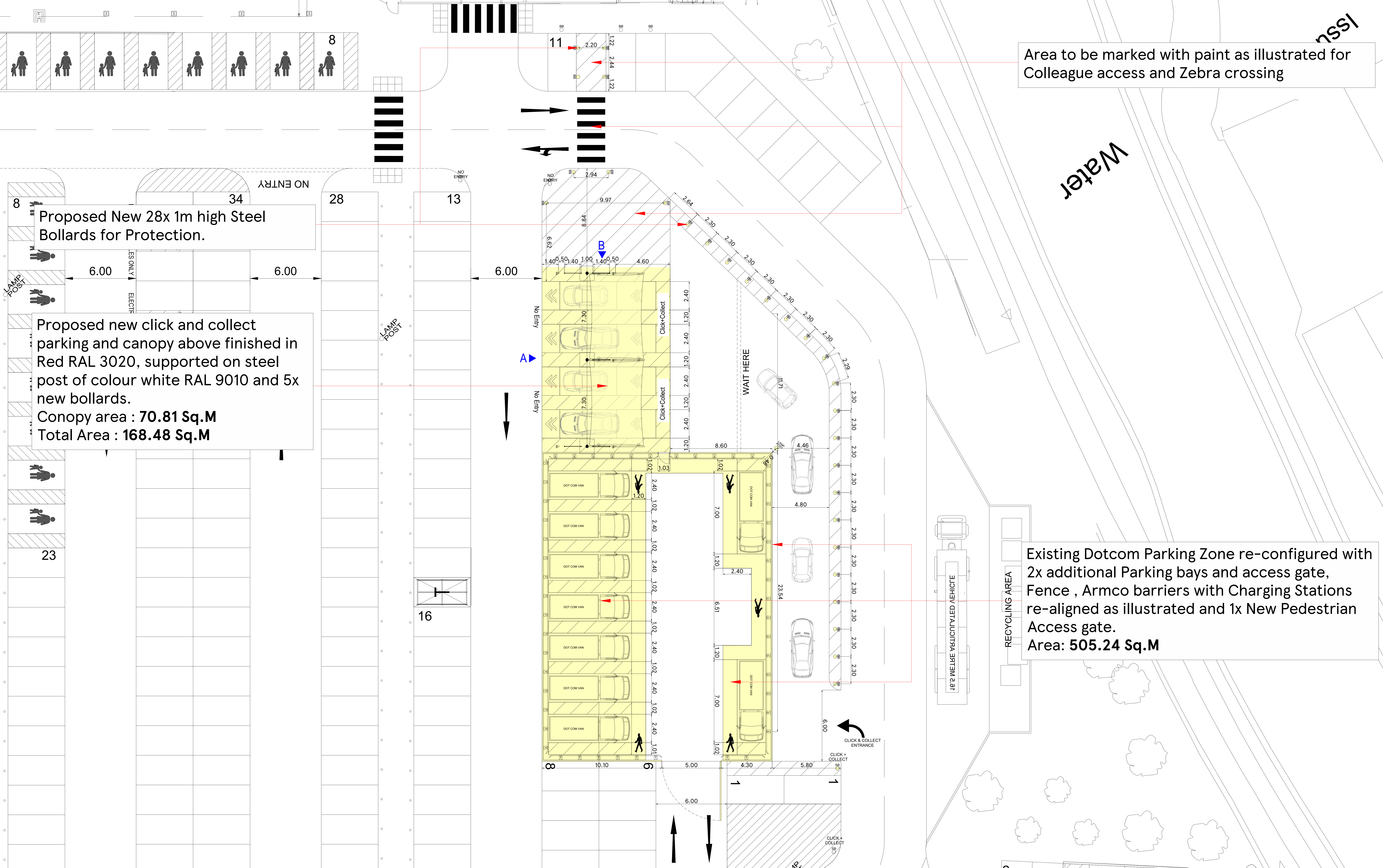

DRAWING NO
02_2071_02D

SCALE
1:100@A0

CHECKED BY
SHIKHA

DRAWN BY
DEEKSHA

DATE
28.06.2023

STORE TYPE
EXTRA

STORE NAME
BARNSELY

CONTENT
PROPOSED PART SITE PLAN_C&C

TESCO
 FEASIBILITY PLANNING
 STORE PLANNING DEPARTMENT
 PROPERTY SERVICES
 HIGHWOODS BUILDING, KESTRAL WAY
 WELWYN GARDEN CITY, HERTFORDSHIRE, AL7 1GB UK
 TELEPHONE : 01707 395150

THE COPYRIGHT AND ALL OTHER RIGHTS IN AND RELATING TO THE PUBLICATION BELONG TO AND ARE THE SOLE PROPERTY OF TESCO STORES LIMITED. ALL RIGHTS ARE RESERVED. NEITHER THE WHOLE NOR ANY PART OF THE PUBLICATION MAY BE REPRODUCED OR TRANSMITTED IN ANY FORM OR BY ANY MEANS, ELECTRONIC OR MECHANICAL, INCLUDING PHOTOCOPYING AND RECORDING OR FROM ANY RETRIEVAL SYSTEM WITHOUT THE PRIOR WRITTEN LICENCE FROM THE OWNER © 1997 TESCO STORES LIMITED