

DO NOT SCALE

FOR THE AVOIDANCE OF DOUBT, NO APPROVALS, REVIEWS, COMMENTS OR INDICATION OF SATISFACTION GIVEN BY ARC ENGINEERS IN TERMS OF SUBCONTRACT DRAWINGS, PRODUCTS OR PROPOSED MATERIALS SHALL REDUCE OR EXTINGUISH THE OBLIGATION OF THE SUB-CONTRACTOR OR SUPPLIER TO ADHERE TO THE SPECIFICATION GENERAL ARRANGEMENT DRAWINGS, STATUTORY REQUIREMENTS AND GOOD WORKING PRACTICE. ARC ENGINEERS ACCEPT NO LIABILITY FOR THE SELECTION OF MATERIALS OR WORKMANSHIP IN THE EXECUTION OF THE WORKS.





- GENERAL NOTES
- THESE NOTES ARE INTENDED TO AUGMENT DRAWINGS AND SPECIFICATIONS, WHERE CONFLICT OR REQUIREMENTS EXIST, THE ORDER OF PRECEDENCE SHALL BE AS SHOWN IN THE SPECIFICATIONS, OTHERWISE THE STRICTEST PROVISION SHALL GOVERN.
 - THE DRAWING IS TO BE READ IN CONJUNCTION WITH ALL OTHER RELEVANT ENGINEERS AND ARCHITECTS DRAWINGS.
 - DRAWINGS NOT TO BE SCALED.
 - ALL DIMENSIONS TO BE CHECKED ON SITE BY THE CONTRACTOR, ANY DISCREPANCIES TO BE NOTIFIED TO THE ENGINEER/ARCHITECT AND FURTHER INSTRUCTIONS OBTAINED BEFORE WORK IS COMMENCED.
 - THE STRUCTURE IS DESIGNED TO BE SELF-SUPPORTING AND STABLE AFTER THE BUILDING IS FULLY COMPLETE, IT IS THE CONTRACTOR'S SOLE RESPONSIBILITY TO DETERMINE THE ERECTION PROCEDURE AND SEQUENCE AND ENSURE THAT THE BUILDING AND ITS COMPONENTS ARE SAFE DURING ERECTION. THIS INCLUDES THE ADDITION OF WATERPROOFING, BRACING, GUYES OR TIE-DOWNS WHICH MAY BE NECESSARY. SUCH MATERIAL REMAINING THE PROPERTY OF THE CONTRACTOR UPON COMPLETION.
 - ALL WORK TO COMPLY TO CURRENT BUILDING REGULATIONS AND TO BE IN ACCORDANCE WITH THE RELEVANT BRITISH STANDARDS AND APPROPRIATE CODES OF PRACTICE.
 - FOR FURTHER NOTES REFER TO PROJECT SPECIFICATIONS.

SAFETY, HEALTH & ENVIRONMENTAL INFORMATION

In addition to the hazards/risks normally associated with the types of work detailed on this drawing, note the following risks and information.

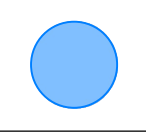
Risks listed here are not exhaustive. Refer to Risk Assessment Register: 24053

Construction:

-  Demolition
No Unusual hazards/risks
For information relating to Use, Cleaning and Maintenance see Health & Safety File
It is assumed that all works will be carried out by a competent contractor working, where appropriate, to an approved method statement
-  INDICATES A RESIDUAL RISK REQUIRING A COMPULSORY ACTION
-  INDICATES A RESIDUAL RISK FOR INFORMATION
-  INDICATES A RESIDUAL RISK REQUIRING PROHIBITIVE ACTION
-  INDICATES A RESIDUAL RISK AS A WARNING

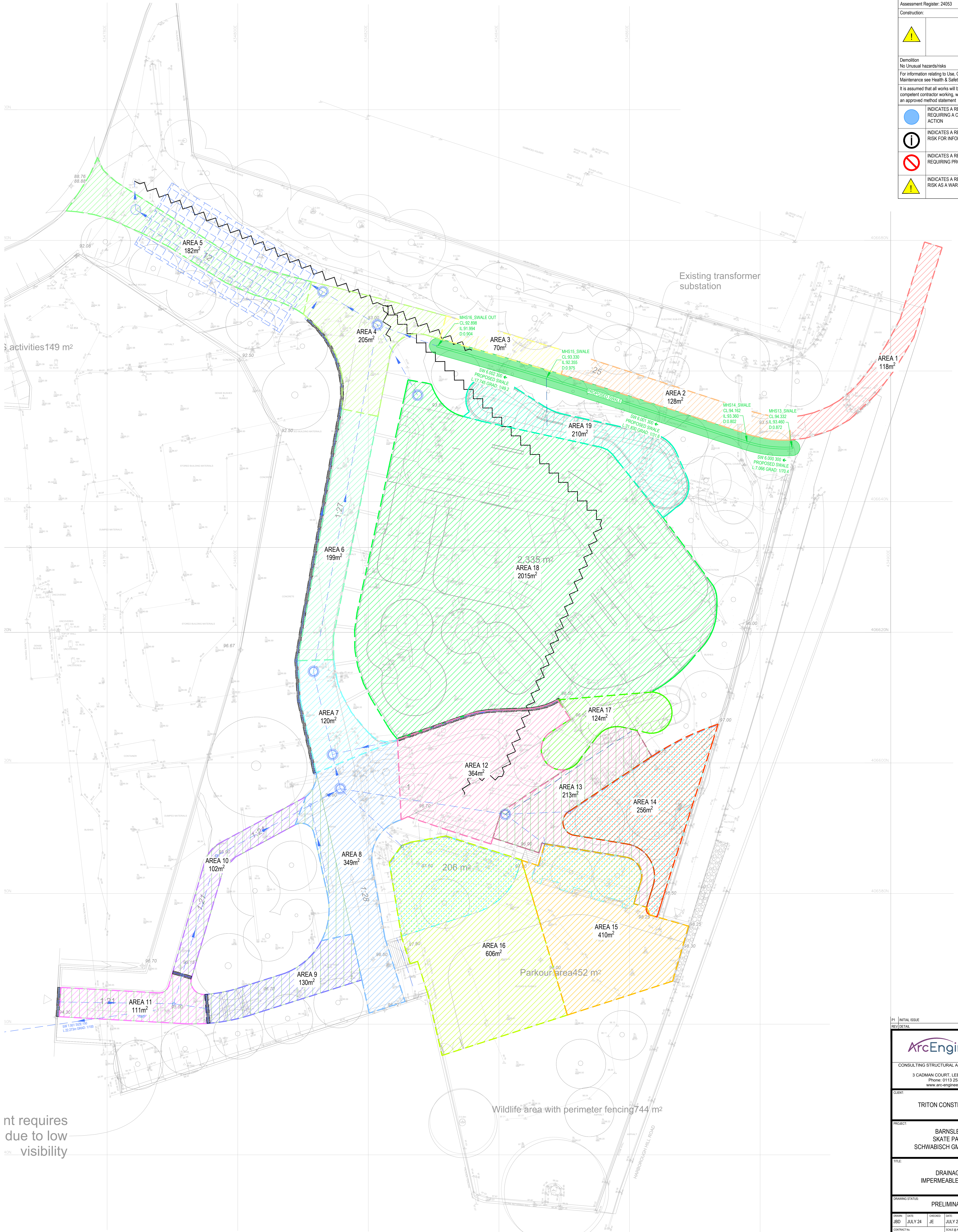

nt requires
due to low
visibility

1/ INITIAL ISSUE
REV/DRAWN
BY: JBD/AA
DATE: 15.07.24

ArcEngineers
CONSULTING STRUCTURAL AND CIVIL ENGINEERS
3 CADMAN COURT, LEEDS, LS27 0RX
Phone: 0113 253 3904
www.arc-engineers.co.uk

CLIENT: TRITON CONSTRUCTION

PROJECT: BARNESLEY SKATE PARK
SCHWABISCH Gmund WAY

TITLE: DRAINAGE IMPERMEABLE AREAS

DRAWING STATUS: PRELIMINARY

Drawn	Date	Checked	Date	Approved	Date
JBD	JULY 24	JE	JULY 24	AA	JULY 24

PROJECT NO: 24053
SCALE: 1:200
24053 - ARC - XX - XX - DR - D - 5003 - P1
© ARC ENGINEERS LTD 2024