

16th March 2016



J Flynn

Dryden Wilkinson Partnership
Norwood Barn, Norwood Farm
Lower Norwood Road
Norwood
LS21 2RA

Dear John,

PROPOSED RESIDENTIAL DEVELOPMENT – COTE LANE, THURGOLAND

Further to your request we have assessed the visibility splay requirements for an access proposal to serve a residential development on land adjacent to Cote Lane, Thurgoland. We have carried out the site visit and speed survey to assess the visibility splay provision and minimum requirement, and confirm that in our opinion acceptable visibility splays can be achieved within land under the applicant's control. The required visibility splays are shown on the enclosed drawing (number 1604201).

The general width of Cote Lane varies from 5.5m - 5.8m in width, bounded by a grass verge to the west of the carriageway. The verge varies in width from 1.2m – 1.5m. The existing pedestrian footway to the east varies in width from 1.5m – 1.7m and continues along the frontage of the application site. The visibility and access proposed on to Cote Lane does comply with guidance given within Manual for Streets 2, and the general traffic speeds.

A speed survey was undertaken on Cote Lane on the 12th of March 2016. The survey was carried out in accordance with *TA 22/81 Vehicle Speed Measurements on All Purpose Roads*, the results of which are enclosed. The 85thile wet weather speeds for the northbound and southbound vehicles are 34.7mph and 33.2mph respectively. Based on Manual for Streets (which we assume is acceptable in this location, but cannot be confirmed until the local authority have assessed), the required visibility splays to the left and right are 2.4m x 53m and 2.4m x 50m respectively. This is shown on the attached drawing and confirms that the splays can be achieved.

Yours sincerely,

Chris Yarrow

Director

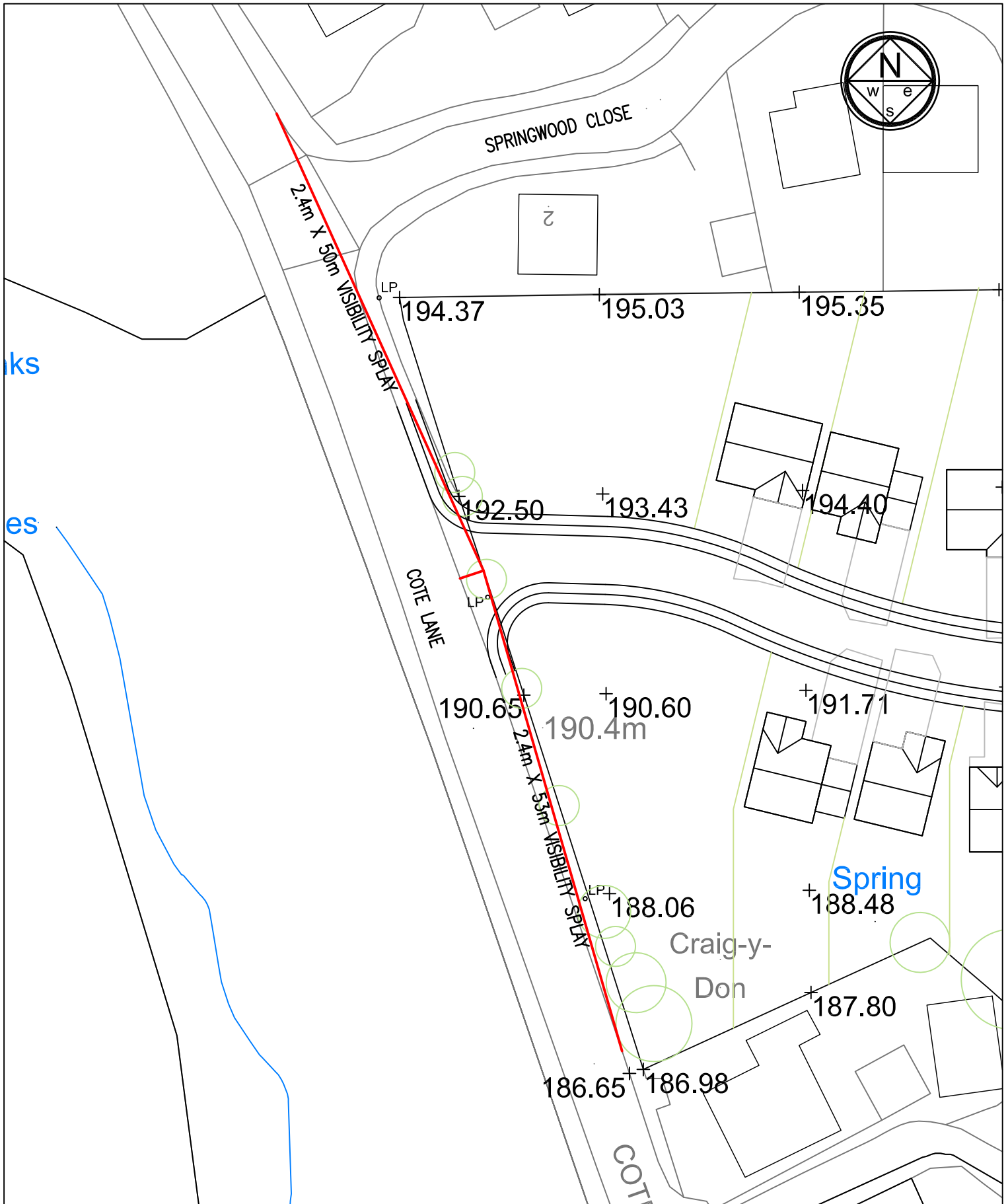

THIS DRAWING SHOWS THE PRELIMINARY DESIGN ONLY AND IS SUBJECT TO DETAILED DESIGN, TOPOGRAPHICAL SURVEY INFORMATION AND LOCAL AUTHORITY APPROVAL

HY CONSULTING Ltd

OFFICE 24
EVANS BUSINESS CENTRE
BURLEY ROAD
LEEDS LS4 2PU
tel: 0113 2883034
email: mail@hyconsulting.com

PROPOSED RESIDENTIAL
DEVELOPMENT

COTE LANE, THURGOLAND

VISIBILITY ASSESSMENT

SCALE
1:500 @A4

DATE
MARCH 2016

DRAWING No
1604201



SPEED SURVEY RESULTS

Location of Survey

Thurgoland

Project No.

16042

Direction of Travel

toward halifax road

Survey Date

12/03/16

Survey Start Time

12:45

Survey Finish Time

13:30

Recorded Speed	No. of Readings	Recorded Speed	No. of Readings	Recorded Speed	No. of Readings	Recorded Speed	No. of Readings
1		26	2	51		76	
2		27	3	52		77	
3		28	4	53		78	
4		29	6	54		79	
5		30	11	55		80	
6		31	10	56		81	
7		32	7	57		82	
8		33	9	58		83	
9		34	6	59		84	
10		35	5	60		85	
11		36	7	61		86	
12		37	8	62		87	
13		38	4	63		88	
14		39	4	64		89	
15		40		65		90	
16		41	1	66		91	
17		42	2	67		92	
18		43	1	68		93	
19		44	1	69		94	
20		45		70		95	
21		46	1	71		96	
22	2	47		72		97	
23	3	48		73		98	
24	2	49		74		99	
25	1	50		75		100	

10 100

Road = Dual C'way Y/N? n

Mean Speed of Vehicles = 32.59

Road = Single C'way Y/N? y

Standard Deviation = 4.90

Was Road Surface Wet Y/N? n

85 Percentile Dry Weather Speed = 37.49

85 Percentile Wet Weather Speed = 35.00 = Calculated Design Speed

Note: Please insert Y or N in boxes against road type and surface condition and then use appropriate Calculated Design Speed.



SPEED SURVEY RESULTS

Location of Survey	Thurgoland	Project No.	16042
Direction of Travel	from Halifax Road	Survey Date	12/03/16
		Survey Start Time	13:15
		Survey Finish Time	14:00

Recorded Speed	No. of Readings	Recorded Speed	No. of Readings	Recorded Speed	No. of Readings	Recorded Speed	No. of Readings
1		26	4	51		76	
2		27	8	52		77	
3		28	6	53		78	
4		29	9	54		79	
5		30	12	55		80	
6		31	6	56		81	
7		32	11	57		82	
8		33	7	58		83	
9		34	6	59		84	
10		35	2	60		85	
11		36	4	61		86	
12		37	5	62		87	
13		38	1	63		88	
14		39	3	64		89	
15		40	3	65		90	
16		41	2	66		91	
17		42		67		92	
18	1	43		68		93	
19	2	44		69		94	
20		45		70		95	
21		46		71		96	
22	1	47		72		97	
23	1	48		73		98	
24	1	49		74		99	
25	5	50		75		100	

10

Road = Dual C'way Y/N?

Mean Speed of Vehicles =

Road = Single C'way Y/N?

Standard Deviation =

Was Road Surface Wet Y/N?

85 Percentile Dry Weather Speed =

85 Percentile Wet Weather Speed = = Calculated Design Speed

Note: Please insert Y or N in boxes against road type and surface condition and then use appropriate Calculated Design Speed.