

431500 432000 432500 433000 433500

### General

- Specified Site
- Specified Buffer(s)
- Bearing Reference Point

### Estimated Soil Chemistry Cadmium

Cadmium Concentrations mg/kg

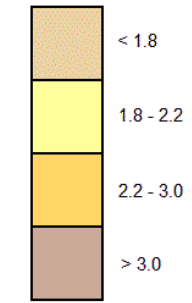

### Estimated Soil Chemistry Cadmium - Slice A

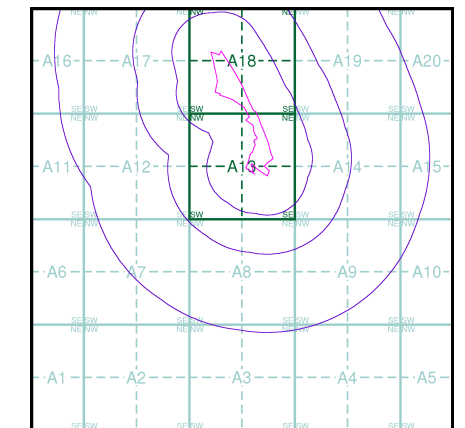

### Order Details

Order Details: 287411249\_1\_1  
 Customer Ref: 46631  
 National Grid Reference: 432390, 404990  
 Slice: A  
 Site Area (Ha): 7.84  
 Search Buffer (m): 1000

### Site Details

Site at 432420, 405250

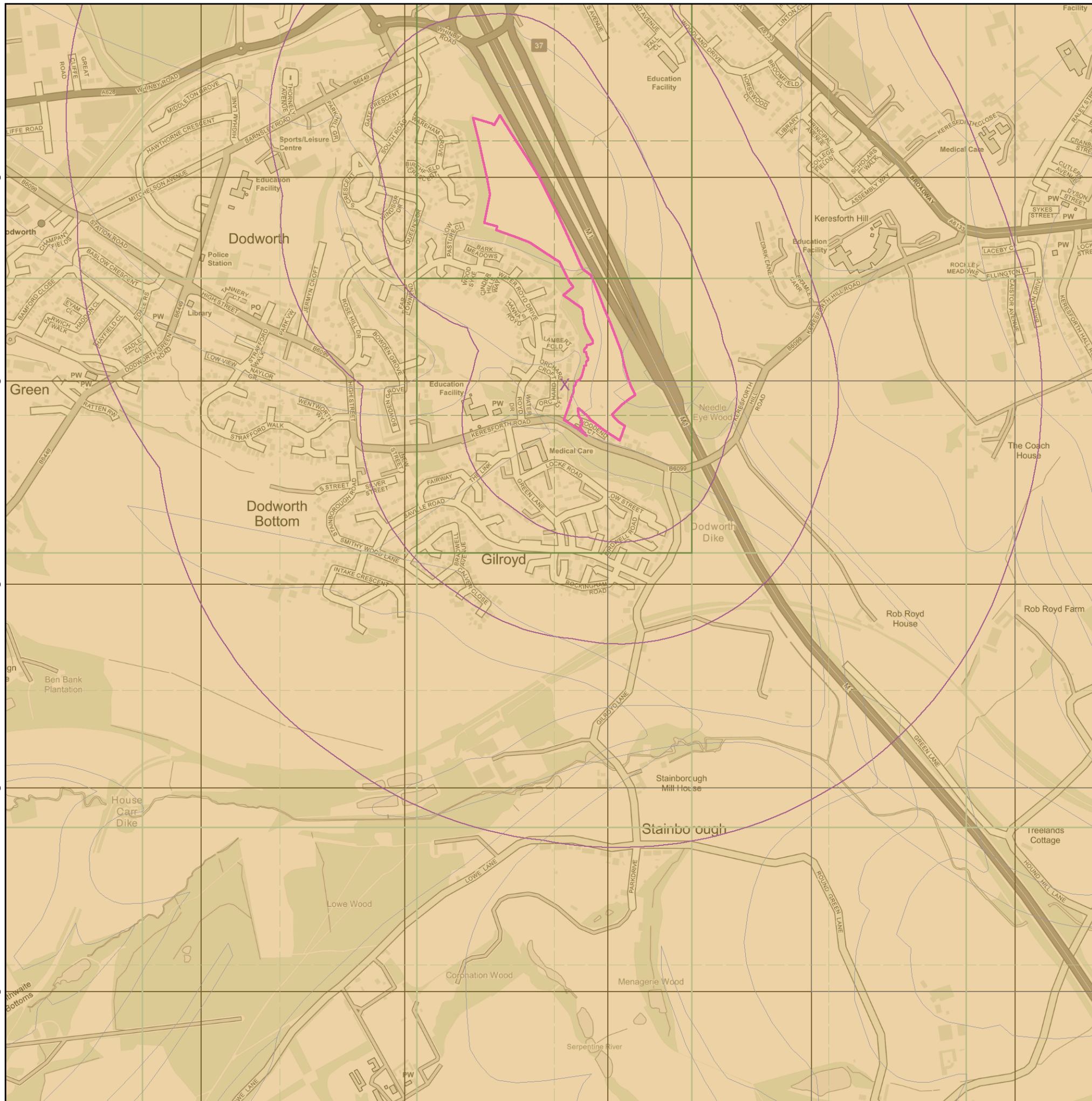

431500 432000 432500 433000 433500

### General

Specified Site Specified Buffer(s) Bearing Reference Point

### Estimated Soil Chemistry Chromium

Chromium Concentrations mg/kg

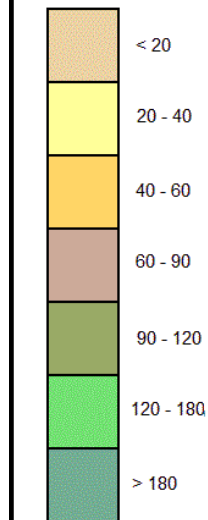

### Estimated Soil Chemistry Chromium - Slice A

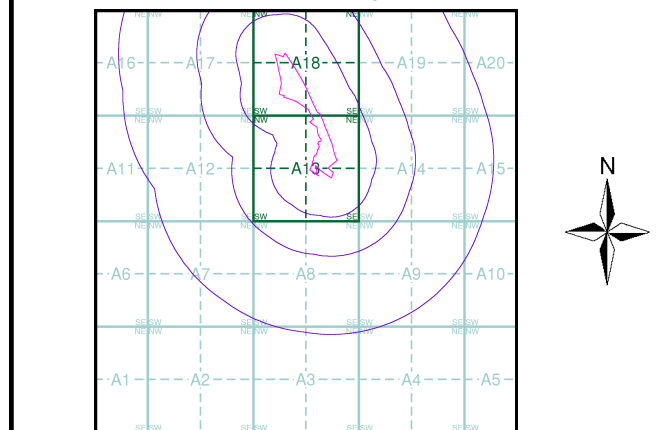

### Order Details

Order Details: 287411249\_1\_1  
 Customer Ref: 46631  
 National Grid Reference: 432390, 404990  
 Slice: A  
 Site Area (Ha): 7.84  
 Search Buffer (m): 1000

### Site Details

Site at 432420, 405250

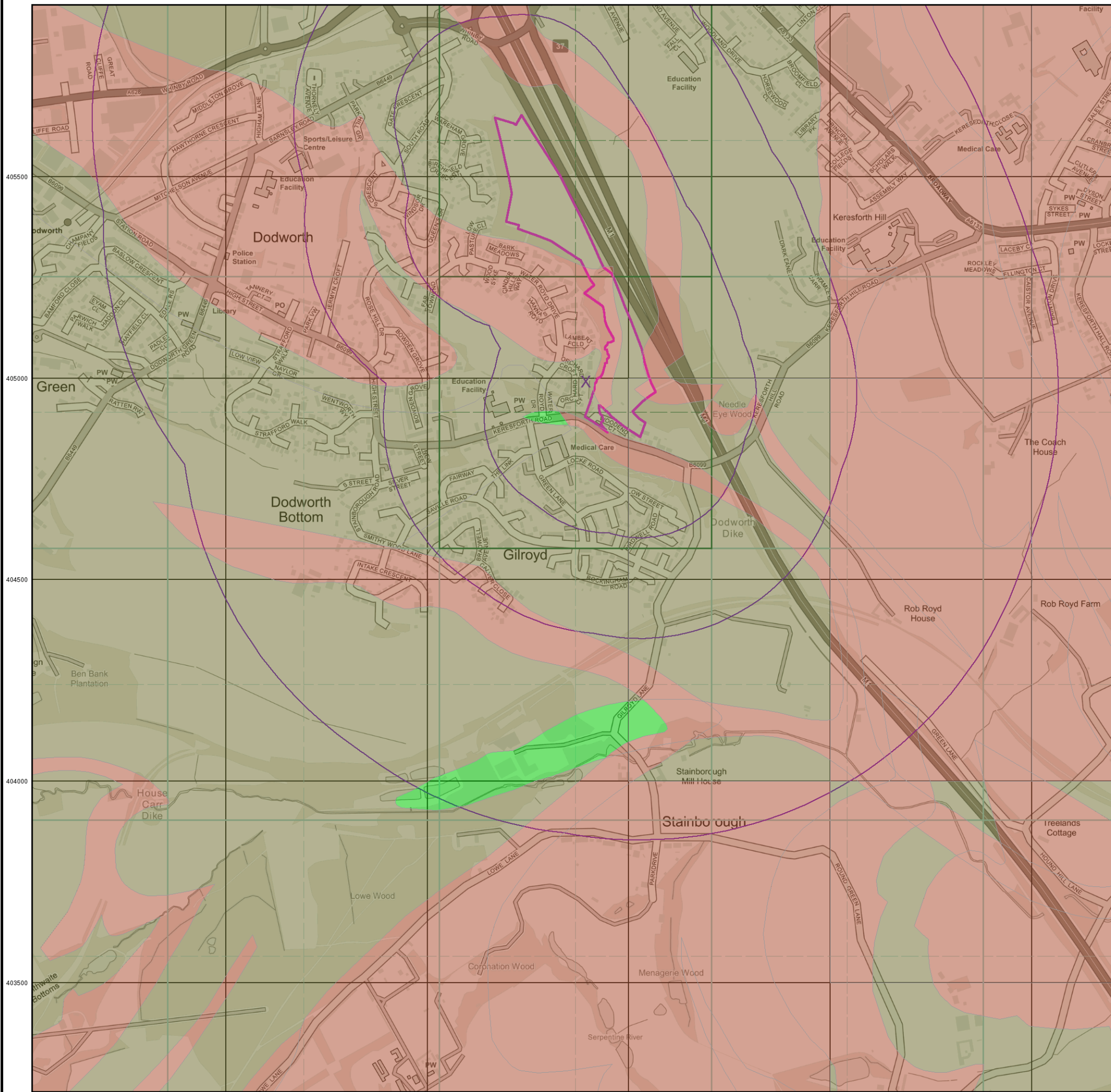

© Crown Copyright. All Rights Reserved. License Number 100022432.

A1 A2 A3 A4 A5

431500 432000 432500 433000 433500

### General

- Specified Site
- Specified Buffer(s)
- X Bearing Reference Point

### Estimated Soil Chemistry Lead

Lead Concentrations mg/kg

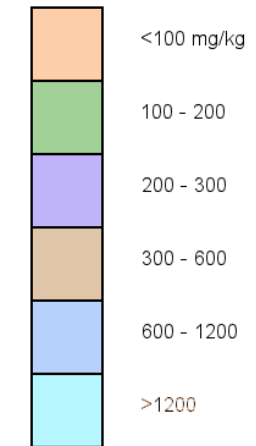

### Estimated Soil Chemistry Lead - Slice A

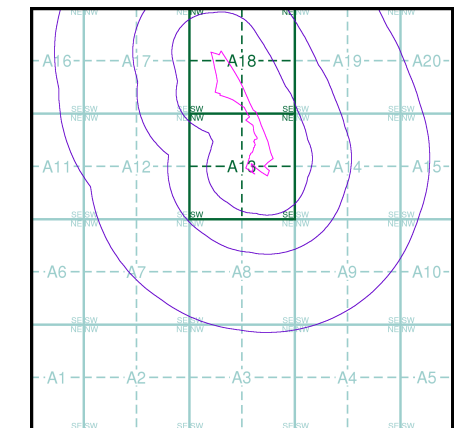

### Order Details

Order Details: 287411249\_1\_1  
 Customer Ref: 46631  
 National Grid Reference: 432390, 404990  
 Slice: A  
 Site Area (Ha): 7.84  
 Search Buffer (m): 1000

### Site Details

Site at 432420, 405250

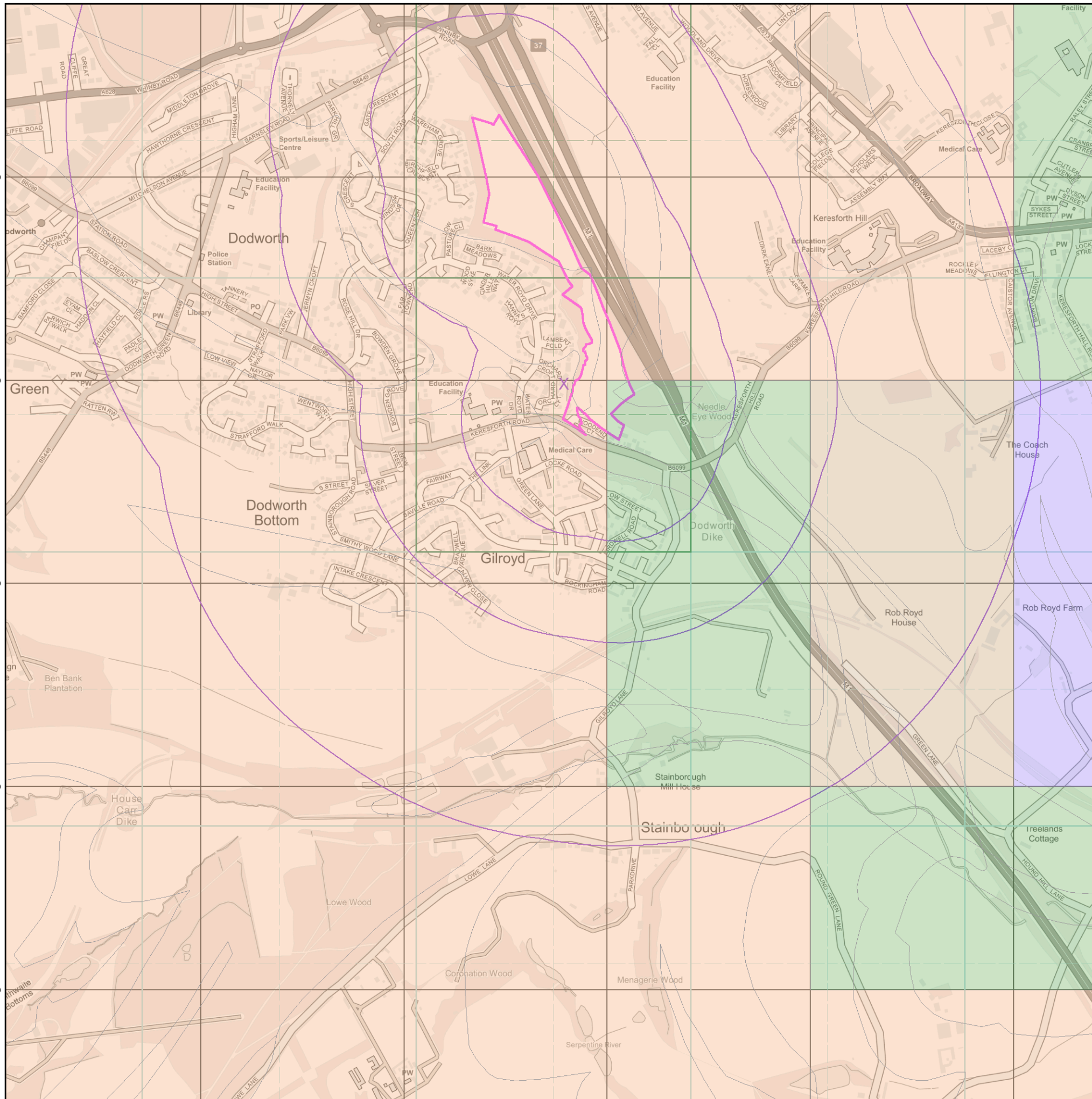

431500 432000 432500 433000 433500

### General

○ Specified Site    
 ○ Specified Buffer(s)    
 X Bearing Reference Point

### Estimated Soil Chemistry Nickel

Nickel Concentrations mg/kg

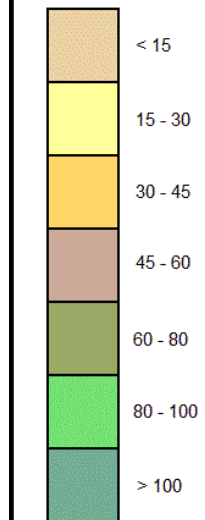

### Estimated Soil Chemistry Nickel - Slice A

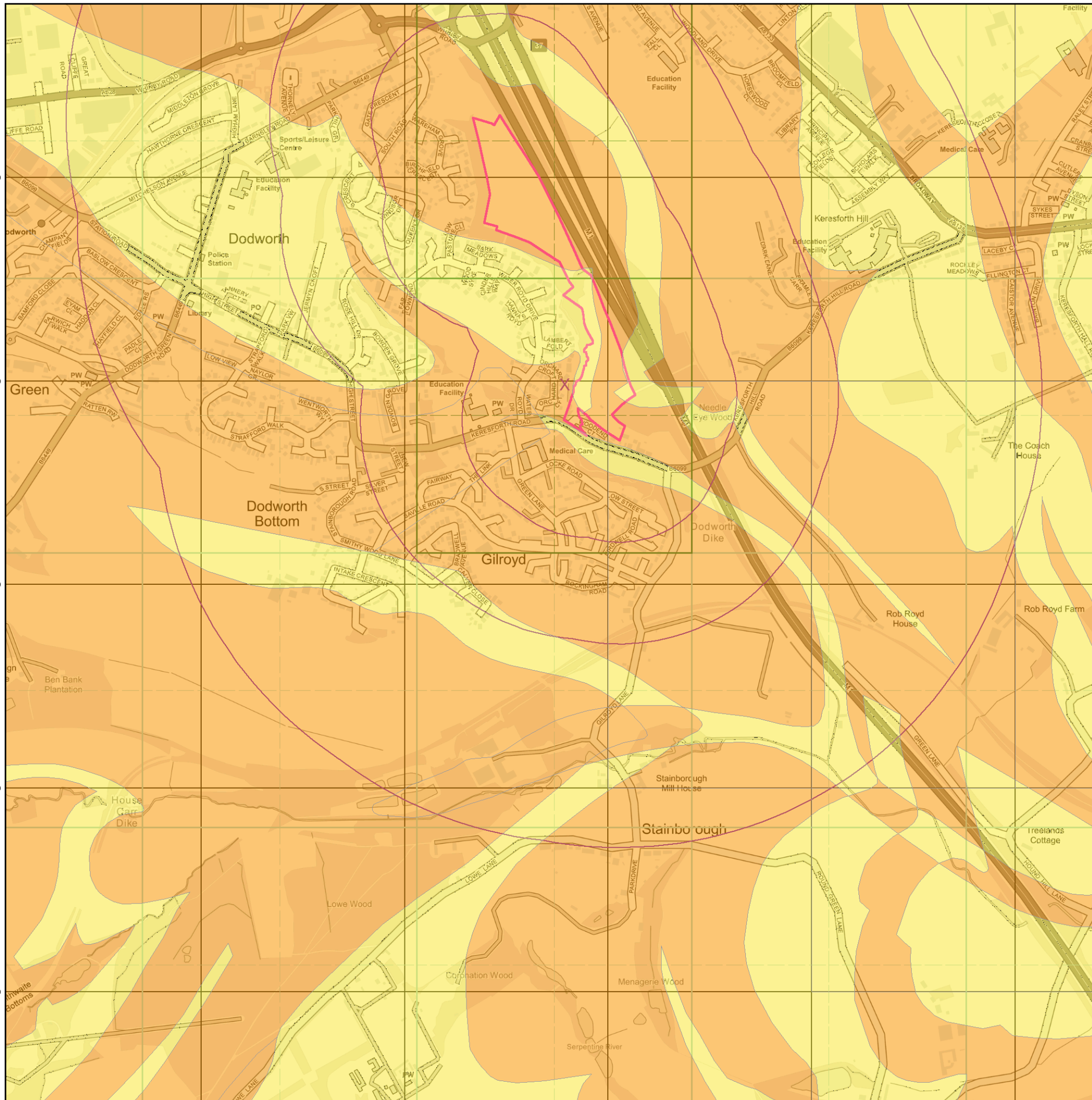
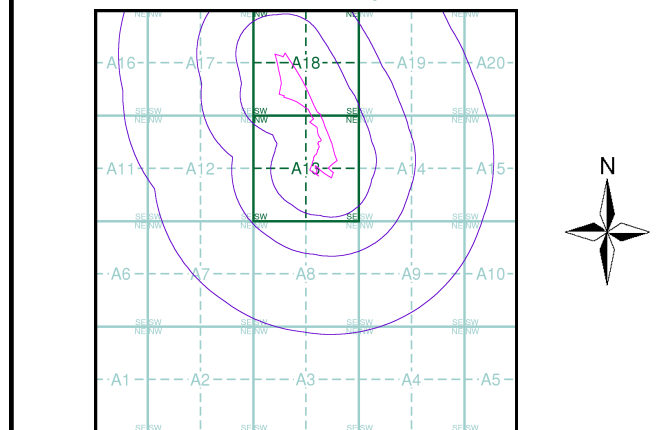

© Crown Copyright. All Rights Reserved. License Number 100022432.

A1 A2 A3 A4 A5

### Order Details

Order Details: 287411249\_1\_1  
 Customer Ref: 46631  
 National Grid Reference: 432390, 404990  
 Slice: A  
 Site Area (Ha): 7.84  
 Search Buffer (m): 1000

### Site Details

Site at 432420, 405250

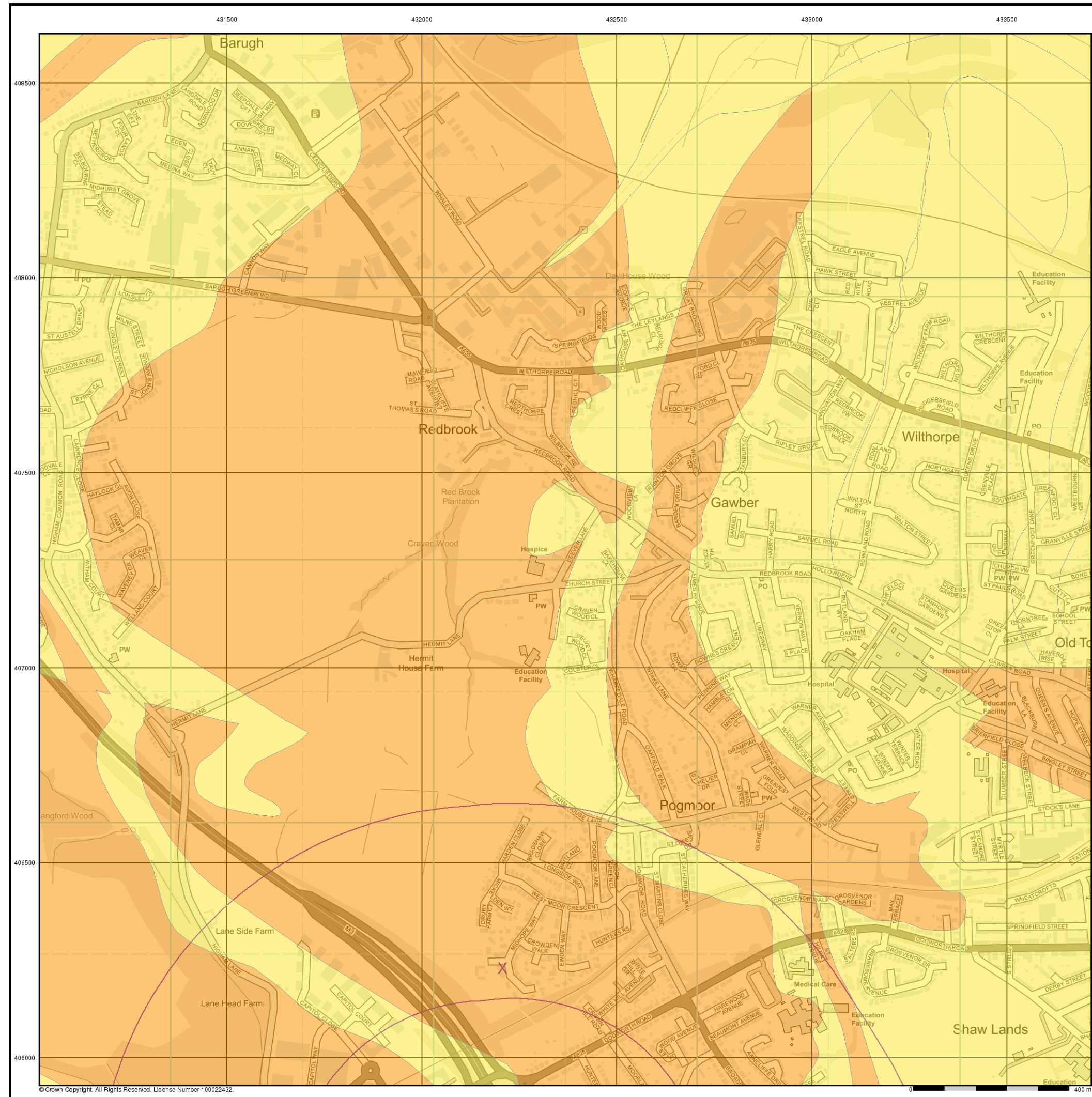

# Envirocheck®

LANDMARK INFORMATION GROUP®

## General

- X Specified Site
- Specified Buffer(s)
- X Bearing Reference Point

## Estimated Soil Chemistry Arsenic

Arsenic Concentrations mg/kg

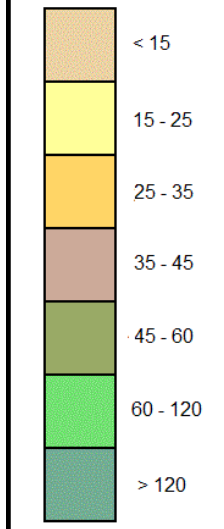

## Estimated Soil Chemistry Arsenic - Slice B

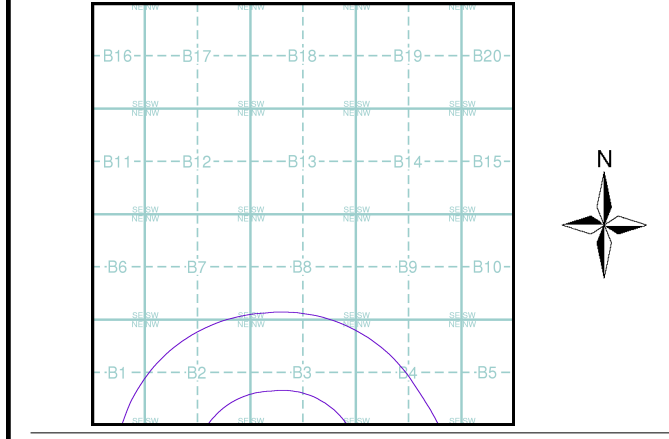

## Order Details

Order Details: 287411249\_1\_1  
 Customer Ref: 46631  
 National Grid Reference: 432210, 406230  
 Slice: B  
 Site Area (Ha): 7.84  
 Search Buffer (m): 1000

## Site Details

Site at 432420, 405250

**Landmark**  
 INFORMATION GROUP

Tel: 0844 844 9952  
 Fax: 0844 844 9951  
 Web: www.envirocheck.co.uk