

5.54x28.98x2.05=329.125cubic metres  
 grand total=say 330+675=1005 cubic metres

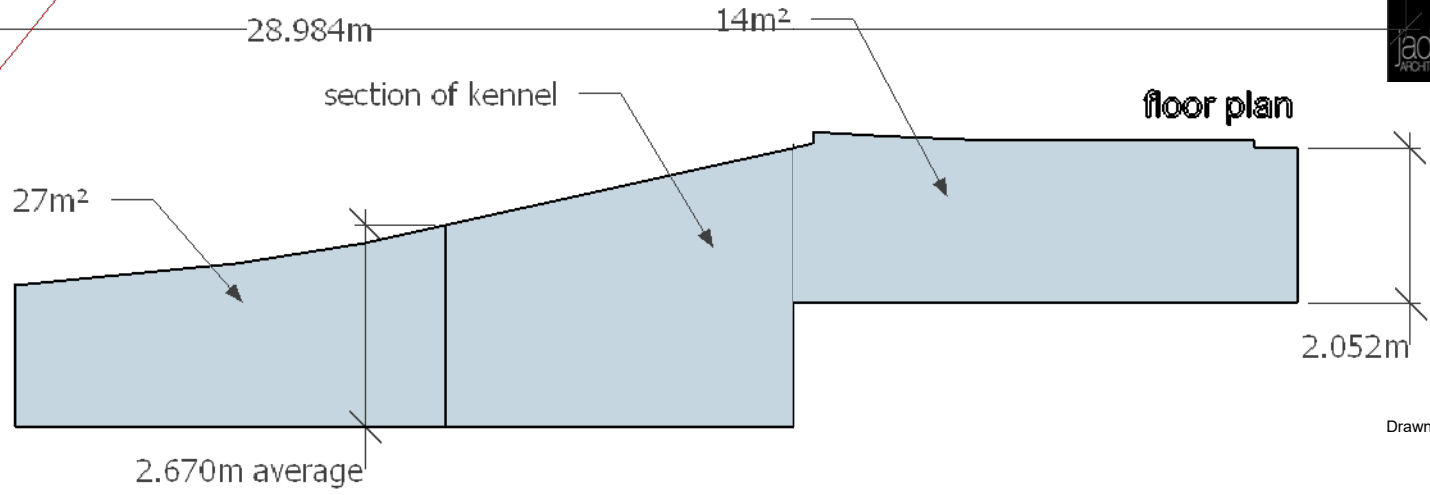

revisions  
 A 11-6-2024  
 updated



**Jade3 Architecture Ltd**

Jade3 Architecture Ltd, Studio 12, Silver Street, Wakefield WF1 1UY  
 Cellphone . 07535 740097 www.jade3architecture.co.uk

**Stancliffe House Farm  
 (former kennel site)  
 Woodhead Road  
 Wortley  
 Sheffield  
 S35 7DA**

Project No. 2023 Enquiry 76  
 Project Title existing floor of former kennel

Drawn By  
 Reviewed By **MC**  
 Scale **1:100 @A3 size**  
 Date **6/12/2023**

Drawn No. 117  
 Reviewed Title  
 Revision

**Important Notice**  
 Do not scale off this drawing. Critical dimensions should be checked on site prior to works commencing. Dimensional conflicts should be brought to the company's attention as soon as they become apparent. Failure to do so could render the contractor liable for subsequent losses. Copyright in this drawing and any work executed from this drawing remains the property of Jade3 Architecture Ltd.