

- ROOF CONSTRUCTION:
- DARK GREEN CORRUGATED METAL SHEETING
  - 25MM X 50MM SW TANALISED BATTENS ON BREATHABLE UNTEARABLE UNDERLAY FELT
  - ROOF TRUSSES AT 25 DEGREE PITCH
  - 75MM X 100MM SOFTWOOD WALLPLATE
  - HORIZONTAL CEILINGS IN ROOFSpace TO HAVE 300MM ROCKWOOL
  - 12.5MM PLASTERBOARD WITH 3MM SKIMMED FINISH.

- WALL CONSTRUCTION:
- 100MM BLOCKWORK WITH RENDER OR,
  - 100MM BLOCKWORK WITH TIMBER BATTENS AND CLADDING OR,
  - 100MM WHITE COLOURED BRICK. (SEE ELEVATIONS)
  - 50MM CLEAR CAVITY
  - 9MM OSB OR PLYWOOD SHEATHING (TO SUPPLIERS DETAILS).
  - 140MM TIMBER TIMBER FRAME TO BE FORMED WITH BREATHABLE MEMBRANE TO CAVITY SIDE.
  - INSULATE BETWEEN STUDS WITH 120MM PIR INSULATION
  - VAPOUR BARRIER TO TIMBER FRAME WITH 25MM PIR OVERLAID INSULATION
  - 35MM TIMBER BATTEN ALLOWING FOR SERVICES.
  - 12.5MM PLASTERBOARD WITH 3MM SKIMMED FINISH.

- INTERNAL WALLS:
- 38 x 89MM REGULARISED SOFTWOOD STUDS AT 400 TO 600 CENTRES ( TO TIMBER FRAME SUPPLIERS DETAILS)
  - FULL FILL ROCKWOOL
  - 12.5MM PLASTERBOARD WITH 3MM SKIMMED FINISH.

- FLOOR CONSTRUCTION:
- 75MM SCREED ENCASING UNDER FLOOR HEATING
  - 100MM KINGSPAN KOOLTHERM K103 INSULATION OR SIMILAR
  - 150MM CONCRETE BEAM AND BLOCK

ALL DRAWINGS TO BE CHECKED BY TIMBER FRAME SUPPLIER AND ENGINEER PRIOR TO BEING SENT OUT TO TENDER

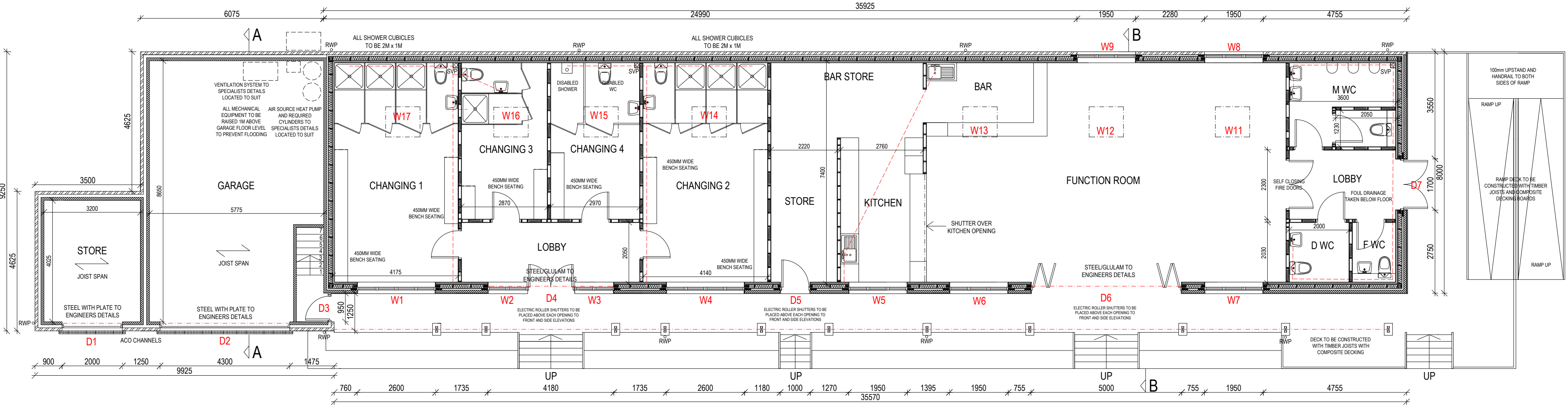

northern design partnership

Chartered Architects  
The Chapel, Millmoor Road,  
Meltham, Holmfirth, HD9 5JU

www.northerndesignpartnership.co.uk  
Instagram: @northerndesignp  
Telephone: (01484) 854848

client	PENISTONE CRICKET CLUB		
project	PROPOSED PAVILION PENISTONE CRICKET CLUB QUEEN STREET PENISTONE S36 6HD		
drawing	PRELIMINARY DETAILED DRAWINGS GROUND FLOOR AND ATTIC PLANS		
revision	notes	date	drawn
scale :	1:100 AT A1	11.23	MG
project no.	2280	drawing no.	06
		revision	