

# New EDCAU

Barnsley Hospital

---

Design & Access Statement

---

Barnsley Hospital NHS  
Foundation Trust

# DAY

**Studio 1**

Lancaster Building  
77 Deansgate  
Manchester  
M3 2BW  
0161 8349703

[www.day-architectural.com](http://www.day-architectural.com)

[info@day-architectural.com](mailto:info@day-architectural.com)

This Design and Access Statement has been produced by **DAY Architectural** on behalf of **Barnsley Hospital NHSFT** for the new **Emergency Department, Childrens Admissions Unit (EDCAU)** and submitted to Barnsley Council.

The design has been developed in conjunction with:

Barnsley NHSFT - Client  
Mott Macdonald - Civil and Structural Engineer  
Turner & Townsend - Cost Consultant

Version: REV P1  
Date issued: 21st August 2019

# DAY



00

Introduction &  
Overview

### 0.0 Introduction

The purpose of the report is to give an overview of the project from the early concept design stages, through the history and background of the development finishing with the final scheme.

We believe that good design stems from the underlying 'Big Idea' or KDP (Key Design Principles) which should be strong enough to drive the whole design process and create a framework for design decision making throughout the evolution of a scheme, creating a sense of consistency and completeness.

DAY's Key Design Principles for the **EDCAU** are just that; a catalyst from which the rest of the design stems. It should be a singular solution to the problems and opportunities identified through initial analysis of the brief, context and typology which will hold the design together throughout the process; a constant focus, regardless of the project stage, and a defender of the design solution.

#### **IMPORTANT:**

Please note that this application has been prepared in conjunction with the following:

- Phase 1 works of the EDCAU which has been granted to proceed as Permitted Development
- EDCAU Phase 2 Outline Planning application REF - APPLICATION NO. 2018/0918
- The previous Outline Planning application should be referenced with particular attention to the planning conditions relating to the drainage strategy.

### 0.1 Overview

The proposed EDCAU has been designed to support the bringing together of the Children's Emergency Department (ED) and Children's Assessment Unit (CAU) into a co-located integrated model of care to support the rapid turnaround of children using an assessment model in place of a traditional, predominantly inpatient based, model on behalf of Barnsley Hospital NHS Foundation Trust.

The paediatric offer in Barnsley has significant scope for modernisation and transformation. Ensuring appropriate ambulatory services are in place is a key enabler to the delivery of broader Integrated Care System (ICS) plans, which is a critical component of the future operating model of the district general hospital.

This initiative aims to deliver a better patient experience for children and families accessing urgent and emergency paediatric care at Barnsley Hospital. The proposed physical reconfiguration of the Emergency Department footprint, releasing additional adult ED capacity, will significantly strengthen the Trust's clinical strategy of consistently delivering urgent and emergency care within the 4 hour access standard.





# Introduction

## The Vision / EDCAU

### 0.2 Barnsley Hospital

Barnsley Hospital NHS Foundation Trust covers an area of approximately 8.2 hectares. The Hospital, built in the 1970s, provides approximately 380 beds and serves a population of 250,000 people within the boundaries served by Barnsley Metropolitan Borough Council.

The Hospital gained Foundation Trust status in 2005 and today provides a full range of district hospital services to the local community and surrounding area. These services include emergency and intensive care, medical and surgical care, elderly care, paediatric and maternity services, along with diagnostic and clinical support. The Trust also provides a number of specialised services, such as cancer and surgical services in partnership with other NHS organisations.

The Trust's principal commissioner is Barnsley Clinical Commissioning Group which is responsible for commissioning health services for the population of Barnsley.

### 03. Response to CQC Report

The October 2017 inspection rated the Trust as Good overall. The proposed development supports the delivery of some of the recommendations issued in the CQC report, specifically around caring for patients in adult ED and for patients with mental health care needs in both adult ED and children's services.

The extension of adult ED majors will support recommendations around the privacy and dignity of patients who have previously been cared for on corridors whilst waiting for admission in times of extremis.

This will be achieved by increasing majors capacity from 16 to 24 including an ambulatory area, reducing the excess of patients over cubicle space.

The report also recommended that patients with mental health needs are cared for in a safe environment which has been risk assessed in order to meet their needs in both children's and adult services.

Both of the above recommendations have been at the heart of the design of the new build and to the revisions proposed to the current ED setup.

### 04. Project Phasing Overview

The Children's Assessment Unit and Children's Emergency Department will be brought together into a new build co-located integrated model of care to support the rapid turnaround of children using an assessment model in place of a traditional, predominantly inpatient based model. This will relocate the current CAU from the eighth floor of KL Block onto the ground floor, adjacent to the existing emergency department.

#### Phase 1:

To enable this to happen, the existing ambulance entrance will be re-located from the North elevation fronting onto to Gawber Road, to the East elevation of the new build.

This will mean that essential adjacencies to resus and the bereavement suite will be retained, as will a single point of ambulance arrival and handover for both adults and children.

Once the external works are complete, a temporary ambulance will be created, and work on the new build will commence.

#### Phase 2:

When the new build is complete, the Paediatric emergency department and CAU will move in and occupy the new build, and work will commence on the adult majors expansion.

To compliment the reconfiguration, the existing inpatient ward, which is on ward 37 also on eighth floor of KL block, will move to O Block which is significantly closer to the new co-located children's emergency department and children's assessment unit.

### 05. Key Objectives for EDCAU

- **To reduce the number of patients being admitted for an inpatient stay** where they could be treated with less child and family disruption in a CAU located within a close proximity to children's ED. An increased focus on ambulatory and short stay pathways will at the heart of the clinical model
- **To extend the service opening hours from a 12 hour service Monday to Friday to a 24 hours a day 7 days a week service**, reducing potentially avoidable ward admissions when a CAU service is not operating. Importantly to match our service offer with changed demand
- **To increase capacity to meet forecasted demand** in both adult majors and for non-elective children's services
- **To improve the clinical relationship between**

---

**The New EDCAU aims to reduce the number of patients being admitted for an inpatient stay where they could be treated**

---

# 00

## Introduction

### The Vision / EDCAU

children' ED and CAU teams in order to more collaboratively manage medically unwell children

- **To reduce overall reliance on inpatient beds** and to improve the resilience of the service in managing within an established bed-base
- **To provide bespoke facilities for patient attending with mental health needs**
- **Ambulance handover will be more efficient due to the additional capacity in adult majors.** Patients who have previously required a period of supervision under the care of YAS colleagues at times of extreme pressure will be able to be handed over to BHNFT ED staff in a more timely fashion due to the extra space that will be available.
- **Patients will be treated in the vicinity of the emergency department for both their emergency department care and their CAU pathway** without the need for a more lengthy and disruptive transfer to the paediatric ward unless absolutely necessary. This makes both the patient and the family stay at the hospital shorter in most instances and ultimately less disruptive to family life.



01

Site Context &  
Analysis

# 01

## Site Context & Analysis

### Overview

#### 1.0 Overview

- The purpose of this document is to:
- Explain why the extension is required;
- Summarise the appraisal of context, the principles and factors that have informed the building's location and size; that has led to the proposal, including assessment, involvement, evaluation and design;
- Describe the key architectural, landscape and access parameters that have been considered as part of the design.

This Design and Access Statement should also be read in conjunction with the following appended documents:

- BFS/Trust Sustainable Development Standard (Trust equivalent to BREEAM)
- Flood risk assessment and drainage strategy
- Geotechnical and geoenvironmental report
- Barnsley Hospital CCTV Survey Report (13.02.19)
- Barnsley Hospital Utility Survey Report (13.02.19)
- MMD-397596-00-XX-DR-D-0002 Tree Removal Proposal



# 01

## Site Context & Analysis

Macro to Micro Scale



### 1.1.1 Macro Context

Barnsley is a town in South Yorkshire, England, located halfway between Leeds and Sheffield. Historically in the West Riding of Yorkshire, the town centre lies on the west bank of the Dearne Valley.



### 1.1.2 Meso Context

Barnsley is surrounded by several smaller settlements which together form the Metropolitan Borough of Barnsley, of which Barnsley is the largest and its administrative centre.



### 1.1.3 Micro Content

The hospital provides a full range of district services to the local community and surrounding area. These include emergency department services, outpatient clinics, inpatient services and maternity and children's services.



### 1.1.4 Proposed Site

The proposed site is to the North of the Hospital site fronting Gawber Road and sits directly in front of the existing Emergency Department and Main Entrance.

# 01

## Site Context & Analysis

### Site Context



- ① Barnsley Hospital
- ② Renal Dialysis Trust HQ
- ③ Mortuary
- ④ Estates and Facilities
- ⑤ Education Centre
- ⑥ Admin Block
- Ⓐ Staff Parking
- Ⓑ Public Parking
- Ⓒ Accessible Parking

# 01

## Site Context & Analysis

### Historic Analysis

#### 1.2 Historic Mapping

The following historic maps and images illustrate the development of the proposed site and the surrounding context for approximately 130 years. The maps show how the site has developed from a rural context to an urban one as well as the significant development of the Hospital Site.



1890

Barnsley Hospital has its origin in the infirmary wards of Barnsley workhouse. Barnsley Poor Law Union was formed in early 1850 but the town workhouse in St Mary's Place remained in use until new, purpose-built premises were built in 1852 in Gawber Road. Additions to the infirmary accommodation were made in 1875.

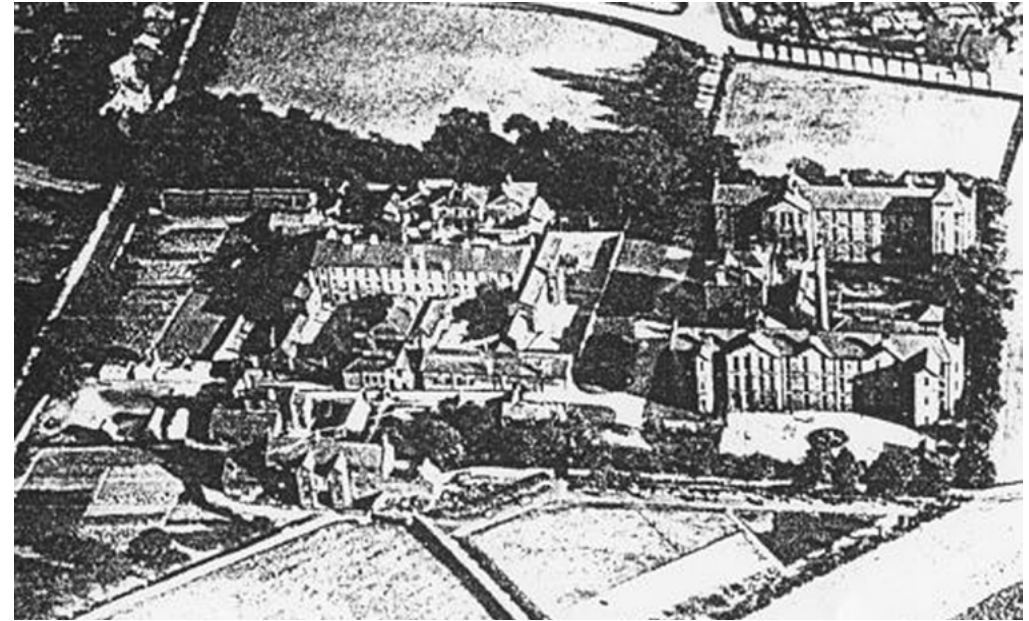

Barnsley North-West 1928

# 01

## Site Context & Analysis

### Historic Analysis



1950

It became Barnsley Municipal Hospital in 1930 but renamed St Helen Hospital in 1935 before joining the National Health Service in 1948.



1970

The old workhouse buildings used by the St Helen Hospital were demolished.



1980

There was a major redevelopment of the site to create Barnsley District General Hospital. This was completed in 1977. Stone from the demolished St Helen Hospital was recovered and used in the landscaping of the area around the main entrance of the new Barnsley District General Hospital.

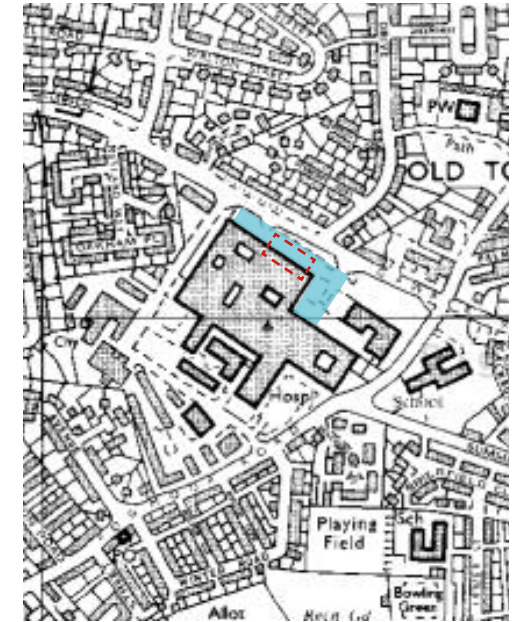

1990

Barnsley District General Hospital gained Trust status in 1993.



#### 1.3 Site Boundary



— Extents of hospital site boundary

— Extents of proposed site boundary

Aerial perspective of existing site

## Site Context & Analysis

Existing Surrounding Context



- Extents of hospital site boundary
- Extents of proposed site boundary



Aerial perspective of existing site

# 01

## Site Context & Analysis

### Existing Surrounding Context



-  Site Location
-  Renal Dialysis Trust HQ

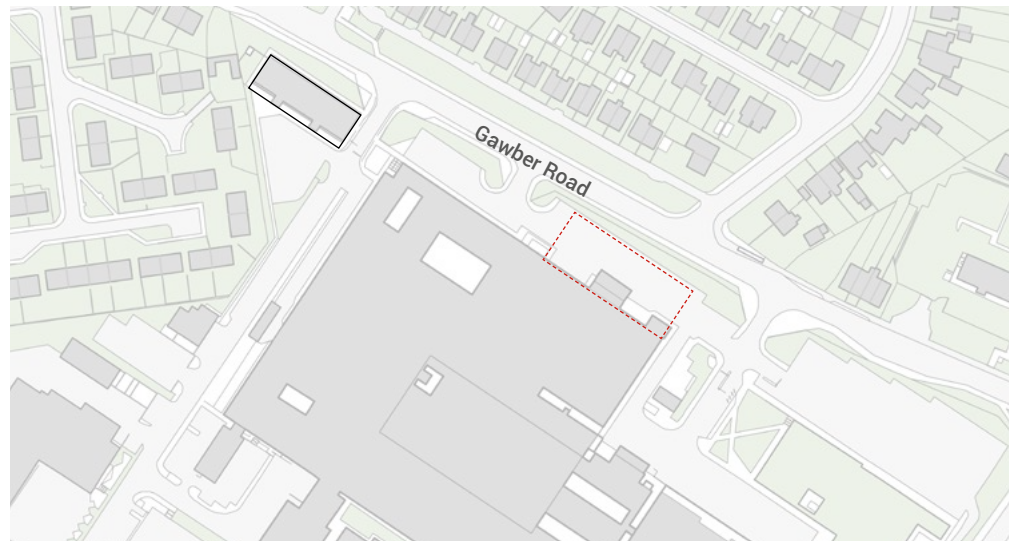

#### 1.4 Renal Dialysis Trust HQ

The existing Renal Dialysis Trust HQ is also prominent along Gawber Road and is one of the first buildings that can be seen on the approach to Barnsley Hospital.

This building has a strong modular appearance with a consistent vertical rhythm that runs along the facade. The proportions of this adjacent building to the site will need to be taken into consideration, the more prominent active facade topped with a solid banding.

# 01

## Site Context & Analysis

### Existing Surrounding Context

#### 1.5 Existing A&E Department Facade

The prominent horizontal banding divides the building facade. Large windows puncture the larger horizontal mass of the building. This break in the mass creates a lower plinth element that is treated differently to the upper facade.

The appearance of the existing building is very monolithic and heavy with its materiality with a mass of varied concrete textures throughout the existing facade. The facade is based on a relatively standardised grid however with the first floor and ground floor elevations reading slightly differently but still within the elevational grid.

North Facade & Demolition



Existing material palette



Engineering brick plinth



Vertical asbestos cladding



Concrete panel cladding

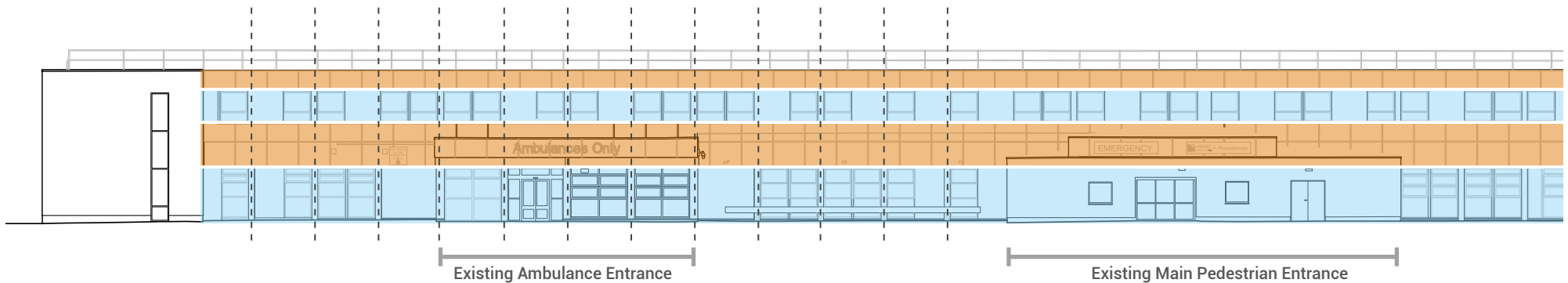

### 1.6 Building Heights

The building heights surrounding the site are all relatively of a similar nature. The Hospital site and the surrounding areas are all relatively low rise and of a domestic scale.

The only element that is much more prominent is the height of the existing tower block which is often used as a wayfinding element to locate the Hospital are not many high rise buildings within a large proximeter of the site.

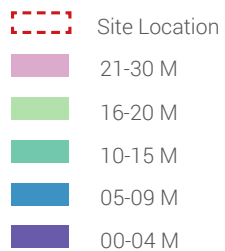
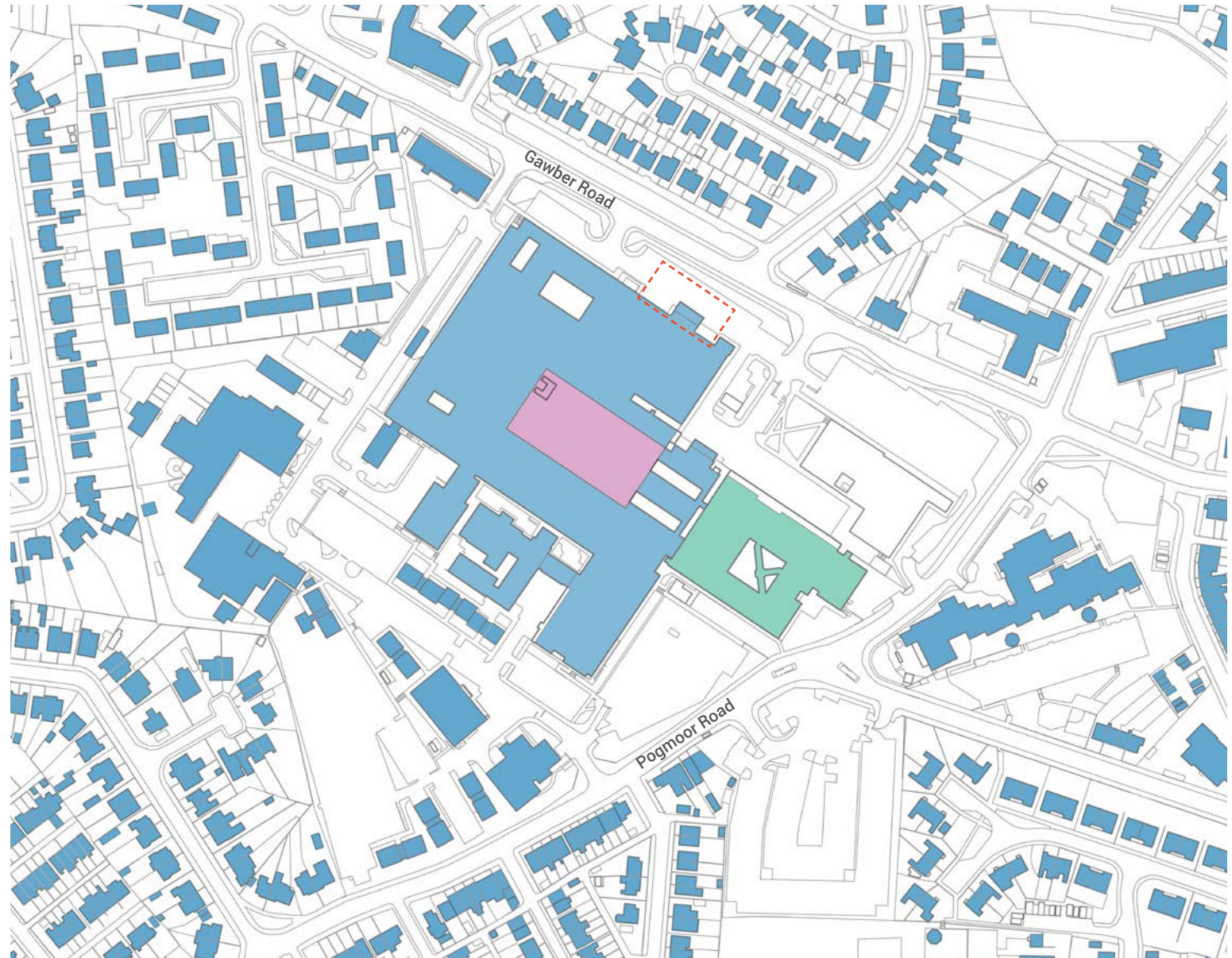



### 1.7 Land Use & Character

The existing Hospital Site is predominantly surrounded by Residential housing estates. The main area of consideration for the residential areas are the housing fronting Gawber Road adjacent to the proposed site, however these houses are located across the road and are sat at a lower level, this is demonstrated later on in the document on the proposed site section.

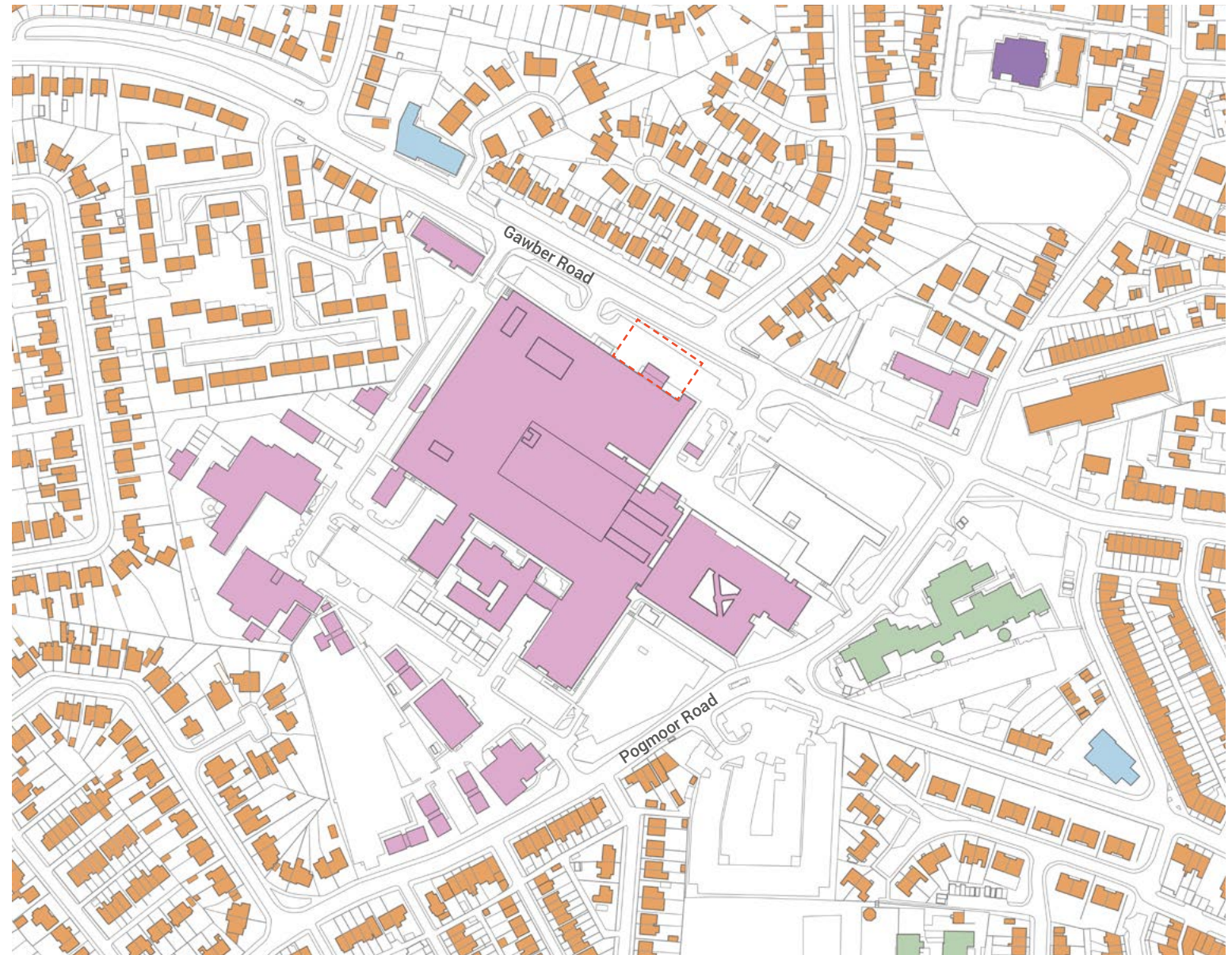



- Site Location
- Public Amenities
- Residential
- Education
- Religion
- Hospital

### 1.8 Open Space & Public Realm

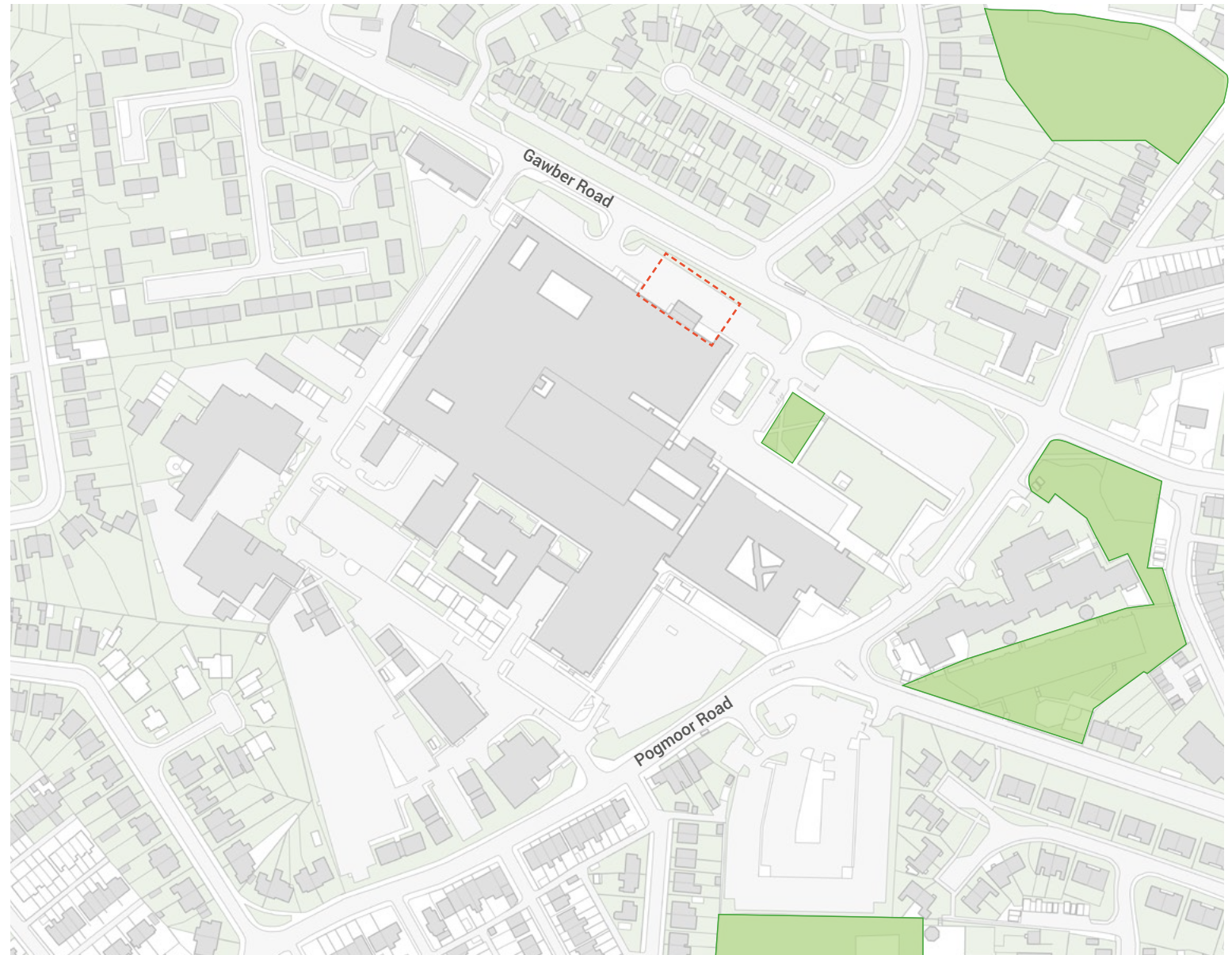
The existing green space is relatively minimal directly surrounding the site, it is mainly owned green space provided for nearby schools. The Hospital has a small dedicated green area to the North East of the Hospital site and a green boundary perimeter that is sited along Gawber Road that acts as a landscape buffer between the existing residential houses and the existing hospital site, this will also ensure more privacy within the proposed unit as the existing blossom trees are located along this green buffer strip.



-  Site Location
-  Open Space



#### 1.9 Vehicular Routes

The main approach to the site is along Gawber road, of which the proposed EDCAU will be fronting. This can be a very busy road as it is a key access road to the hospital.

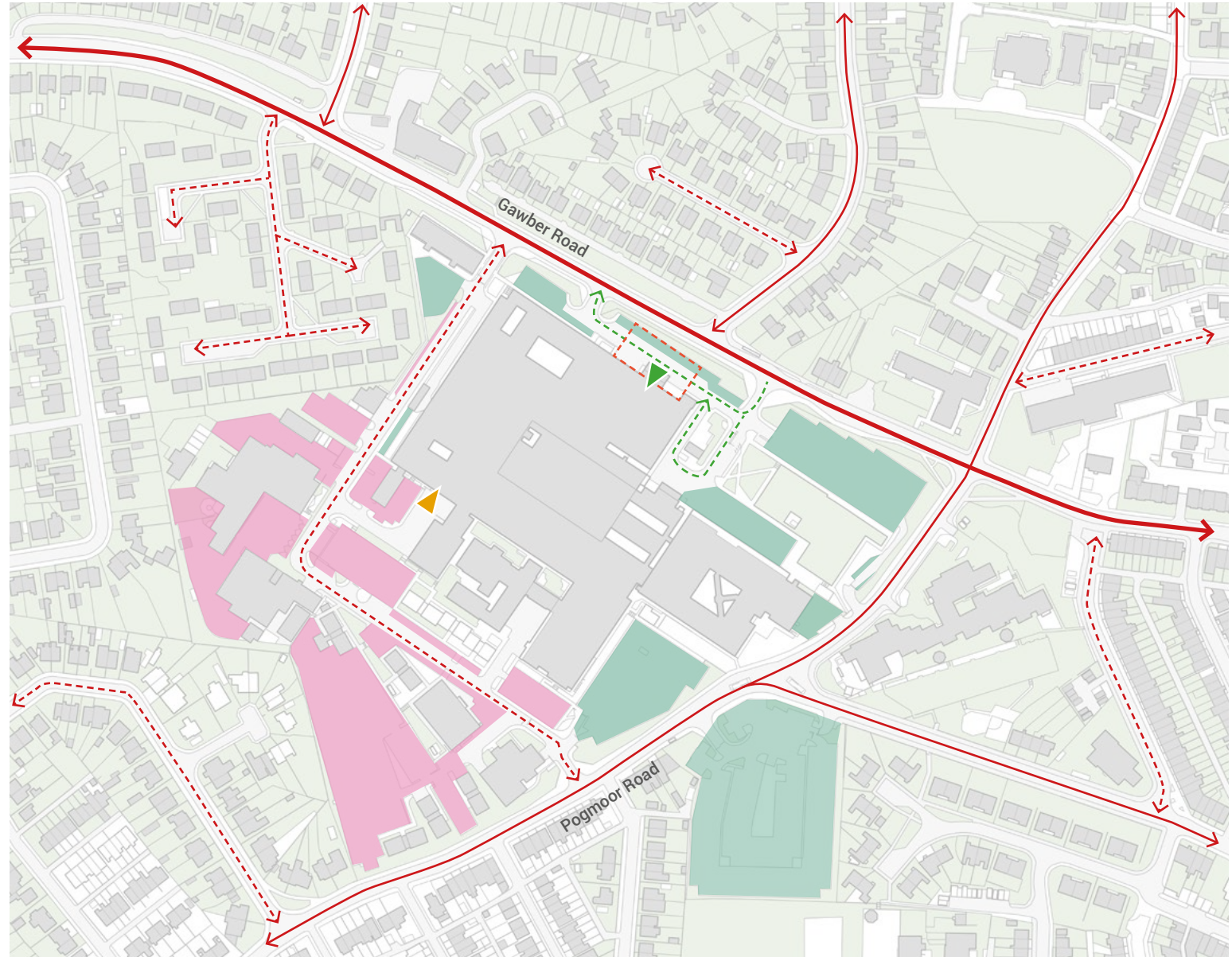

- Site Location
- ↔ Primary Roads
- ⇄ Secondary Roads
- ⇄ Tertiary Roads
- ⇄ Service Roads
- ⇄ Ambulance Route
- Car Park
- ▲ Deliveries
- ▲ Ambulance Access