

DO NOT SCALE

NOTES

- DESIGN NOTES
- ALL DESIGN AND WORKS TO COMPLY WITH CURRENT VERSION OF THE FOLLOWING DOCUMENTS:
 - DESIGN MANUAL FOR ROADS AND BRIDGES (DMRB);
 - SPECIFICATION FOR HIGHWAY WORKS (SHW);
 - MANUAL FOR STREETS (MFS); AND
 - BARNSELY METROPOLITAN BOROUGH COUNCIL (BMBC) DESIGN GUIDE AND SPECIFICATION.
 - ALL DIMENSIONS IN MILLIMETRES UNLESS STATED OTHERWISE.
 - READ IN CONJUNCTION WITH DRAWINGS:
 - 3062-100-002 TO 004;
 - 3062-100-200 SERIES;
 - 3062-700-001 TO 003; AND
 - 3062-1100-001 TO 003.
 - SURFACE COURSE IS TO BE LAID OVER THE NEW CONSTRUCTION CARRIAGEWAY AND THE ADJACENT PLANNED CARRIAGEWAY CONCURRENTLY, SO THERE WILL BE NO JOINTS ALONG THE LINE OF THE NEW CONSTRUCTION.
 - BITUMINOUS SPRAYS AND TACK COAT ARE TO ADHERE TO CLAUSE 920 MCHW.
 - HOT ROLLED ASPHALT MIXTURE IS TO COMPLY TO EN 13108-4, AND LAID WITHIN THE TOLERANCES SET OUT IN THE HIGHWAYS SPECIFICATION AND MCHW CLAUSE 702.
 - TYPE 1 SUB-BASE TO CLAUSE 803 OF MCHW.
 - IRONWORK IN THE CARRIAGEWAY SHOULD BE SET FLUSH TO THE NEW CARRIAGEWAY SURFACING.
 - FOR KERBING LAYOUT REFER TO DRG. NO. 3062-1100-01.
 - OVERLAY THICKNESS IS TO BE DETERMINED WITH NEW AND EXISTING LEVELS, EXISTING SURFACE TO BE PLANNED TO ALLOW FOR MINIMUM SURFACE AND BINDER COURSE.
 - FINISHED LEVEL OF TOPSOIL 25mm ABOVE TOP OF KERB/EDGING FOR SETTLEMENT.
 - FOR NEW PAVED AREAS, EXISTING GROUND LEVELS TO BE BROUGHT UP TO FORMATION LEVELS WITH 6F1 MATERIAL.
 - TYPES OF PROPOSED ROAD CONSTRUCTION ARE SUBJECT TO BMBC APPROVAL.

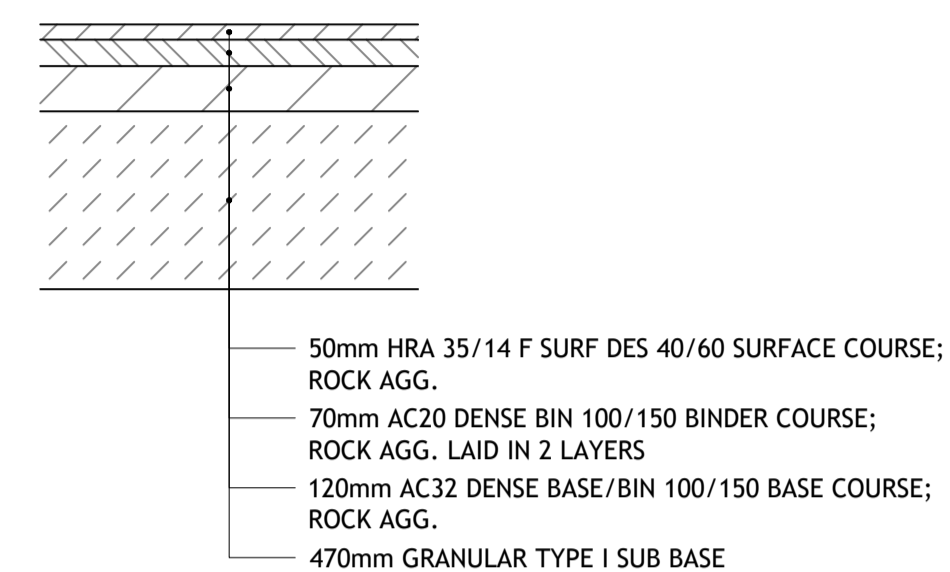

NEW CARRIAGEWAY - P01

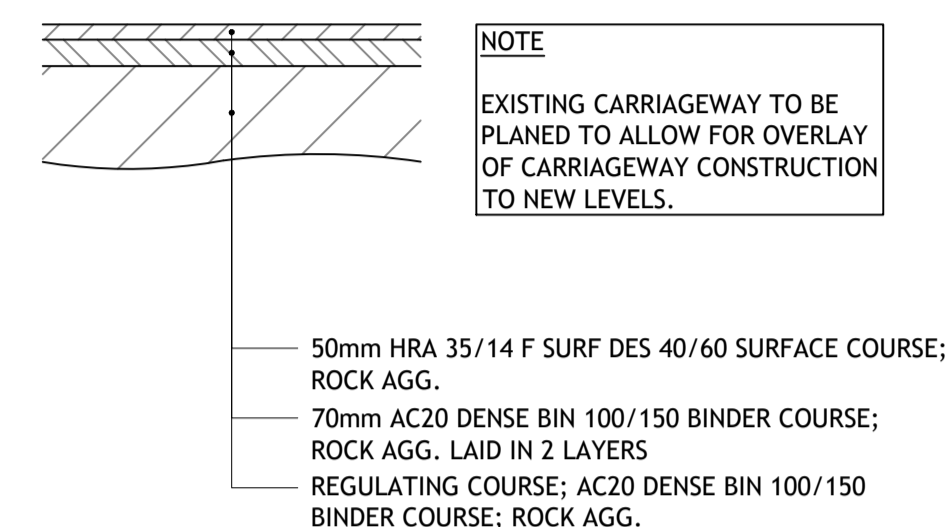

EXISTING CARRIAGEWAY RESURFACING- P02

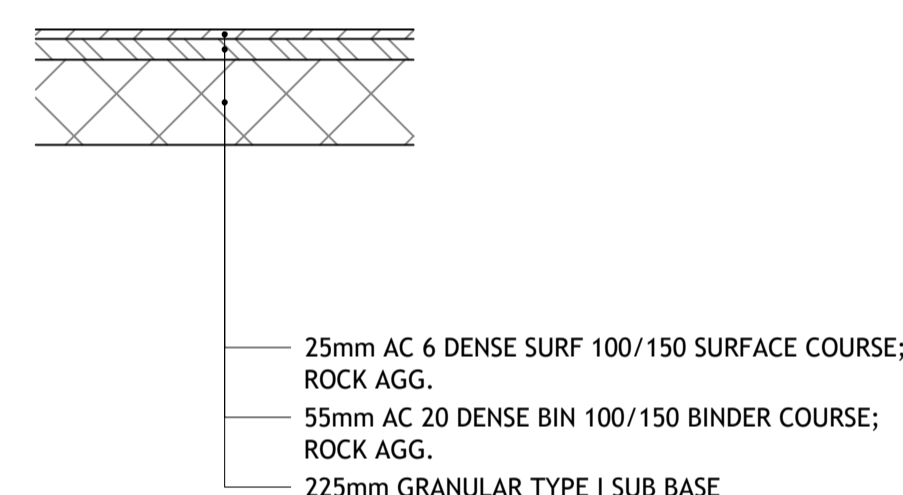

NEW FOOTWAY/TRAFFIC ISLAND- P03
(ALLOWANCE FOR LIGHT VEHICULAR TRAFFIC)

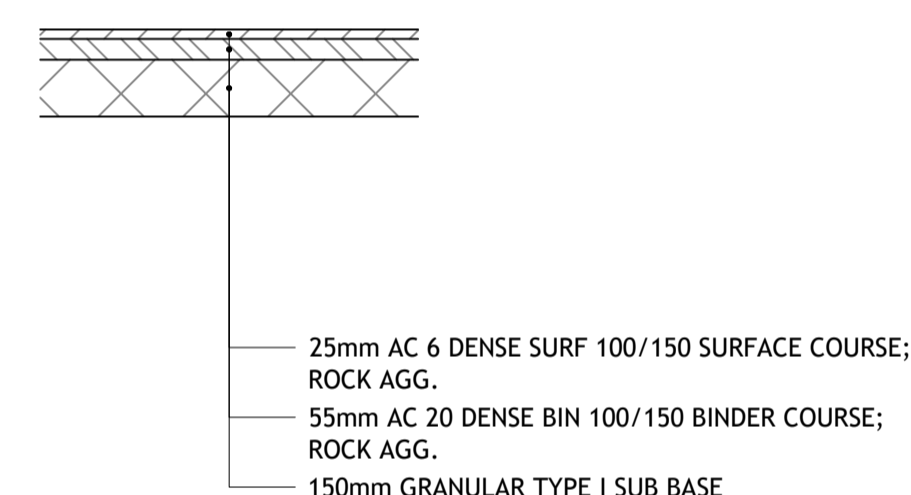

NEW FOOTWAY/CYCLEWAY - P04
(NO ALLOWANCE FOR VEHICULAR TRAFFIC)

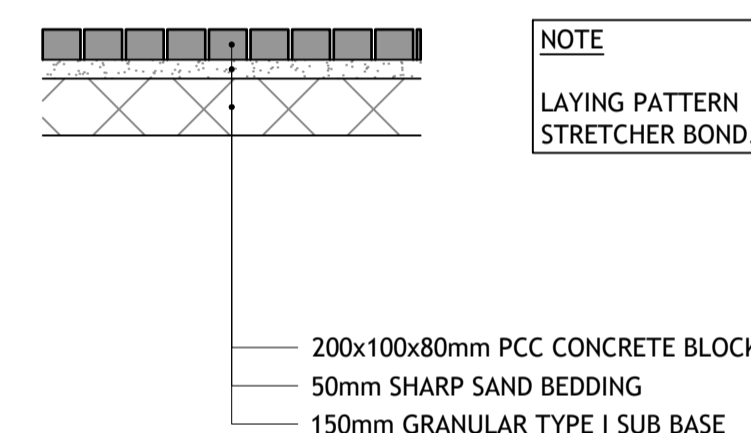

BLOCK PAVED MAINTENANCE STRIP - P05

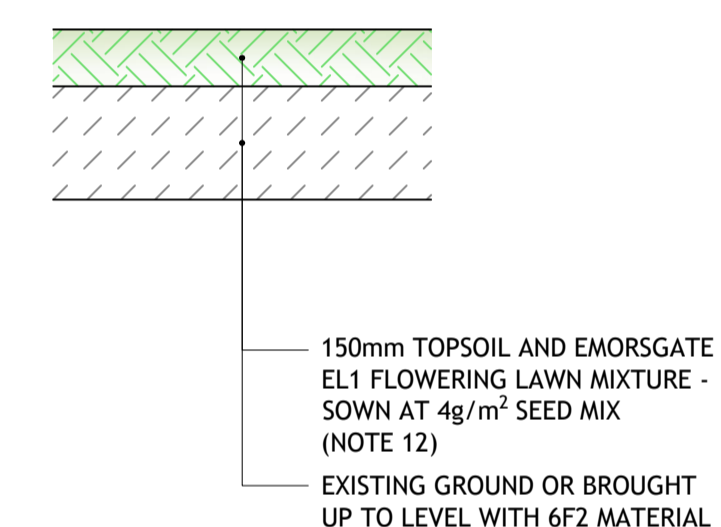

GRASS VERGE/LANDSCAPING - L01

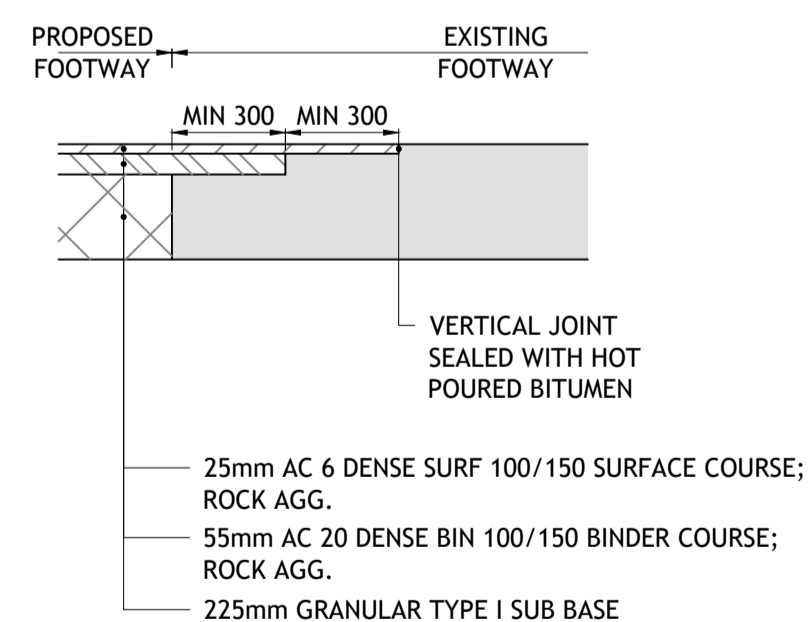

JOINTING INTO EXISTING FOOTWAY SURFACING

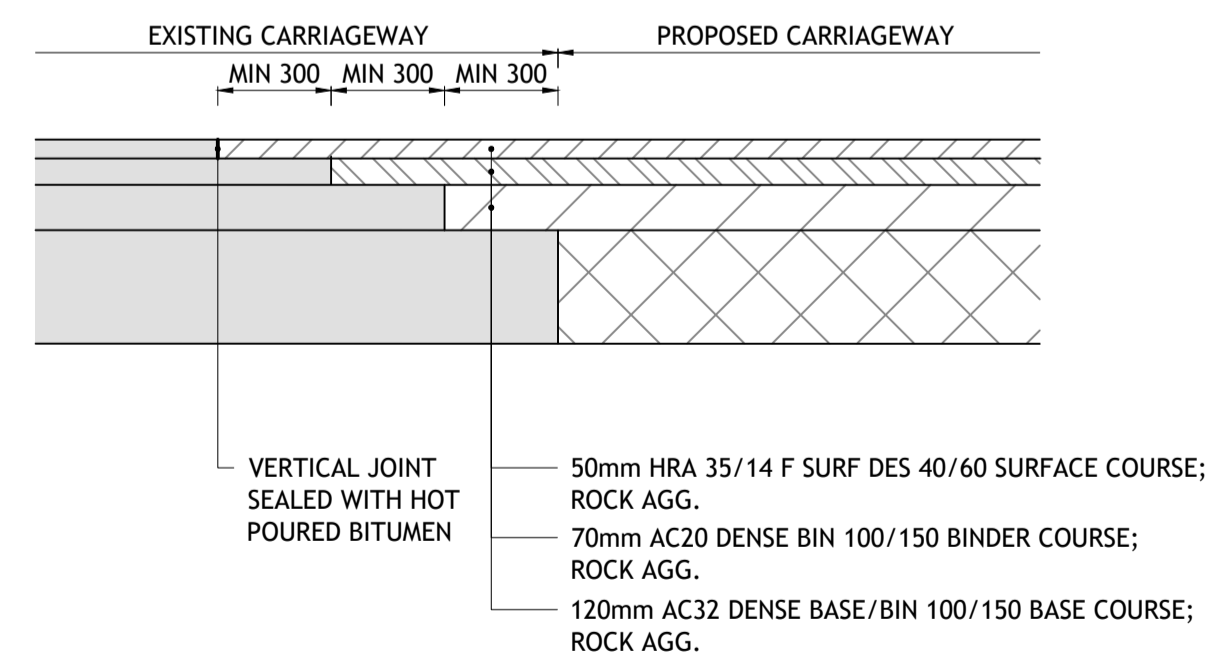

JOINTING INTO EXISTING ROAD SURFACING

REV	DESCRIPTION	DATE	BY
-----	-------------	------	----

Client:
STRATA STERLING BARNSELY WEST LTD

Project:
BARNSELY WEST LINK ROAD

Drawing Title:
STANDARD DETAILS ROAD CONSTRUCTION

PRELIMINARY

Fore Consulting Limited
1st Floor, 15 St Paul's Street
Leeds
LS1 2JG
0113 2460204
enquiries@foreconsulting.co.uk
www.foreconsulting.co.uk

Drawn by ML	Checked by PI	Issue Date 20.11.2023	Scale NTS	Format A1
Job Number 3062	Drawing Number SD-P-002	Revision -		