

THIS DRAWING IS COPYRIGHT, AND REMAINS THE PROPERTY OF HTC ARCHITECTS. IT MUST NOT BE REPRODUCED, USED, DISCLOSED OR TRANSMITTED TO THIRD PARTIES IN ANY FORM, IN WHOLE OR IN PART, WITHOUT PRIOR WRITTEN PERMISSION.

ALL DIMENSIONS SHOULD BE CHECKED ON SITE BEFORE WORK COMMENCES

DRAWING SUBJECT TO VEHICLE TRACKING CHECK

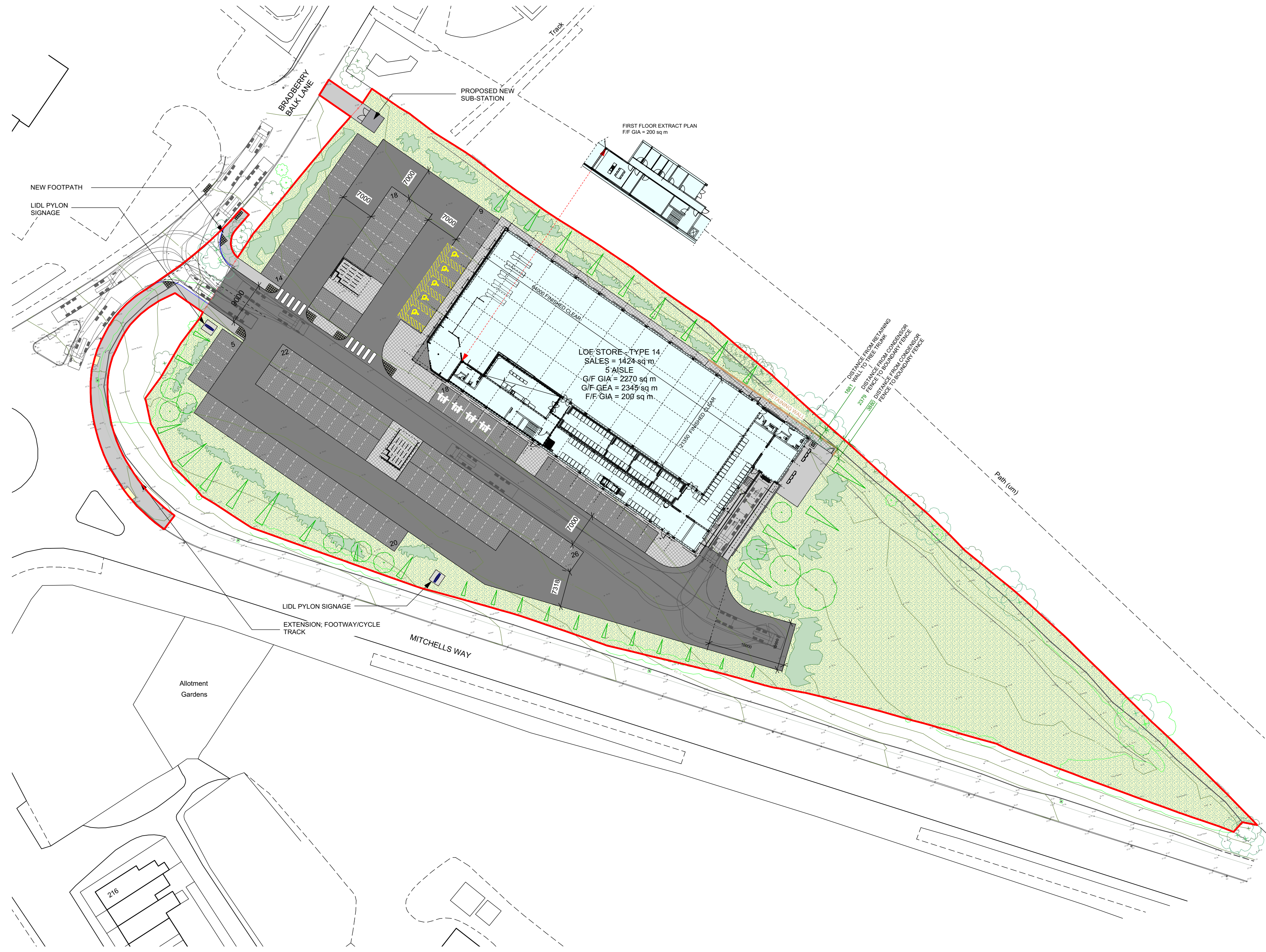
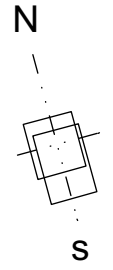

Site Area (sq m)	13,154.5 sq m
Store Type Reference	LOF Type 14 (19.03.15)
Sales Areas (sq m)	1,424 sq m
Number of Aisles	5 Aisle
G/F GIA (sq m)	2,270 sq m
G/F GEA (sq m)	2,345 sq m
F/F GIA (sq m)	200 sq m EST
Car Park Spaces	132

Rev	Date	Description	Drawn
Q	09.10.15	Minor amendment to condenser area	LS
P	23.09.15	Flagpole signage replaced with pylon signs	PC
N	30.07.15	Parking spaces reordered to include 5th disabled space inline with client instruction	DW
M	29.07.15	Boundary Amended inline with planning consultant comments to include highways works. Drawing size amended show all site area and scheme rotated.	DW
L	27.07.15	Updates in accordance with Highways Consultant	LS
K	23.07.15	Site Access amended in accordance with Highways Consultant	LS
J	21.05.15	Access into site widened to 9m. Flagpoles labelled. Tracking added. Scale changed to 1:500 @ A3	MH
H	13.05.15	Layout updated as per previous sketch.	NJV
G	13.05.15	Sketch - car park updated for discussion	MH
F	08.05.15	Retaining wall adjacent to Mitchells Way omitted. Parking layout amended accordingly.	DW
E	29.04.15	Scheme updated for planning issue	DW
D	27.04.15	FF added	LS
C	27.04.15	Sales area increased from 1421 to 1424 sq m	MH
B	23.04.15	Updated with proposed EGL's and retaining wall requirements	MH
A	13.04.15	2 Trolleybays + landscaping added	LS

htcarchitects

York Place Studio
8 Britannia Street
Leeds
LS1 2DZ

T: (0113) 244 3457

W: www.htcarchitects.co.uk
E: info@htcarchitects.co.uk

client
Lidl UK GmbH

project
**New Store
Mitchells Way, Wombwell,
Barnsley**

drawing title
Proposed Site Plan

date **April 2015**
status **Planning Issue**
scale **1:500 @ A2**
drawn **DW** checked **JH**
job no. **1849** dwg no. **10** rev. **Q**