

Drawing status

Notes	Status	Rev	Date
PRELIMINARY ISSUE	P	-	25.07.17
TENDER ISSUE	T	-	11.10.17
AMENDMENTS	T	A	23.11.17

Drawn by **KE** Size Scale **1:50**

- Location of existing drainage penetrations added

KEY

- DENOTES UNDER FLOOR DRAINAGE
- DENOTES SPOT FOR CORE DRILLING SLAB
- DENOTES ABOVE GROUND DRAINAGE
- AAV DENOTES STUB STACK WITH AIR ADMITTANCE VALVE IN IPS
- RE DENOTES RODDING EYE IN IPS

NOTE: PLEASE REFER TO (S-)04/(S-)05 FOR EXISTING SANITARY WARE STRIP OUT REQUIREMENTS

ANY CORE DRILLING TO BE DONE AT WEEKENDS WHEN THE GROUND FLOOR IS NOT IN USE

CORE DRILLING TO AVOID ALL RADIANT PANELS IN THE GROUND FLOOR CEILING.

ALL NEW WASTES PASSING THROUGH FIRE COMPARTMENT FLOORS OR WALLS ARE TO RECEIVE APPROPRIATE HILTI FIRE COLLARS

WASTE FROM W.C. TO BE 100mm DIAMETER
WASTE FROM WHB AND SINKS TO BE 50mm DIAMETER

ALL NEW SANITARY WARE IS TO BE FIXED IN STRICT ACCORDANCE WITH THE MANUFACTURERS INSTRUCTIONS

Drawing status annotation
P-Preliminary T-Tender D-Design (post preliminary) C-Construction

Client

BARNSELY HOSPITALS NHS FOUNDATION TRUST

Project title

O BLOCK REFURBISHMENT
RE-LOCATION OF NEONATAL

Project no
170/021

Drawing title

NEONATAL UNIT
PROPOSED DRAINAGE
PLAN
SHEET 1 OF 2

Drawing no
(52-)01

Status Revision
T A

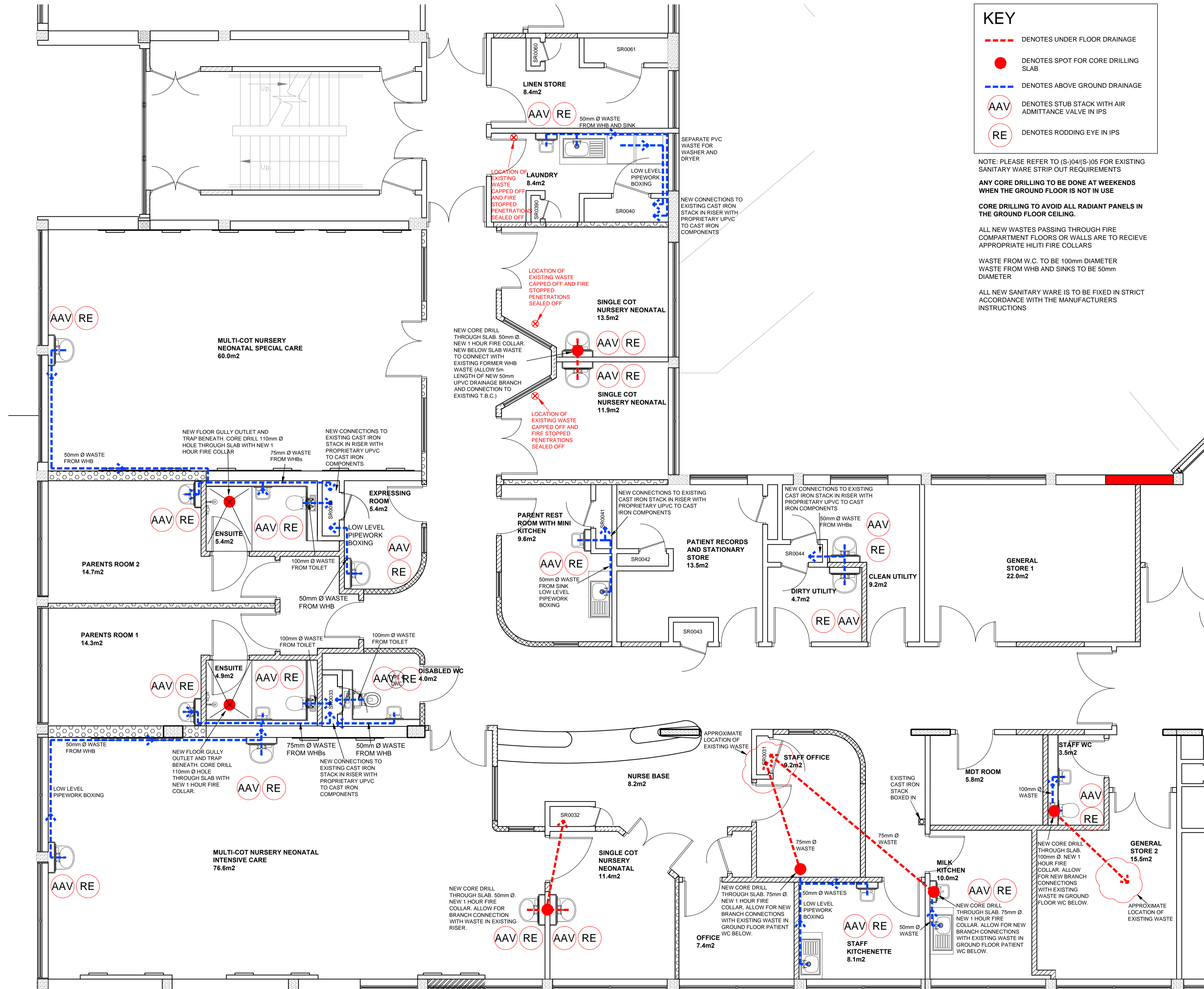

PROPOSED NEONATAL UNIT DRAINAGE PLAN
1:50