

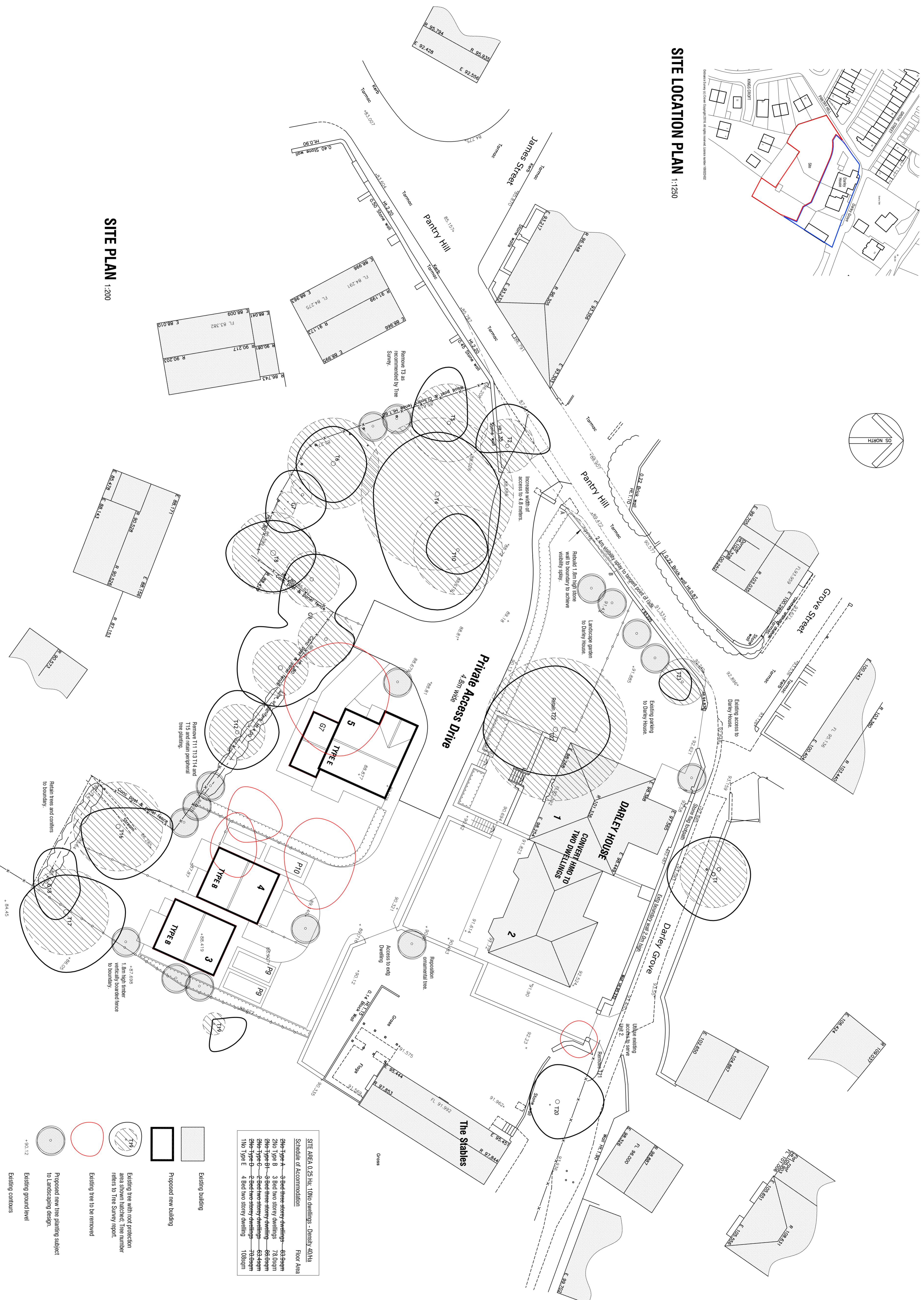

SITE LOCATION PLAN 1:1250

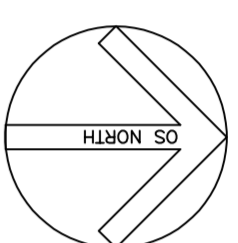

	Existing tree with not protection area shown hatched. Tree number refers to Tree Survey report.
	Existing tree to be removed
	Proposed new tree planting subject to Landscaping design.
	Existing ground level
	Existing contours

	Existing building
	Proposed new building

	210 Type A - 3 Bed three-storey dwellings - 65-69sqm
	210 Type B - 3 Bed two-storey dwellings - 72.0sqm
	210 Type C - 2 Bed three-storey dwellings - 65-69sqm
	210 Type D - 2 Bed two-storey dwellings - 65-69sqm
	110 Type E - 4 Bed two-storey dwelling - 108sqm

SITE AREA 0.25 Ha - 1000 dwellings - Density: 40/Ha
Schedule of Accommodation
Floor Area

H 31/07/2018 - Amend Planning Application red line site boundary.
 G 06/07/2018 - Further minor alterations for planning submission.
 F 04/07/2018 - Further minor alterations for planning submission.
 E 05/06/2018 - Redesign layout.
 Reduce numbers, retain protected trees, retain existing buildings at Darley House, amend access to re-plot highways comments.
 D 26/04/18 - Redesign layout.
 C 18/07/2018 - Amend Location Plan to exclude Darley House buildings at Darley House, amend Schedule of Accommodation.
 B 20/12/2017 - Amend layout, amend access, amend design of Units 1 and 2.
 A 02/10/17 - Amend access, add track; amend design of

RESIDENTIAL DEVELOPMENT
DARLEY HOUSE
PANTRY HILL
WORSBROUGH DALE
BARNSLEY

OUTLINE PROPOSALS
SITE PLAN

architectural design and building consultants

mbcohdesign
 Fairfield House
 Barnsley S70 2ET
 T: 01228 286266
 M: 07988 681800
 E: mcohdesign@btconnect.com

Scale: AS SHOWN @ A1 Drawn: MJB
 Date: 02/07/2017 Ref: 16/20

Dwg No: **P10** Rev: **H**

Drawn: [] Check: [] Issue: []
 Date: [] Scale: []
 Drawing for printing only. All copyright and liability reserved and accepted on this drawing.