

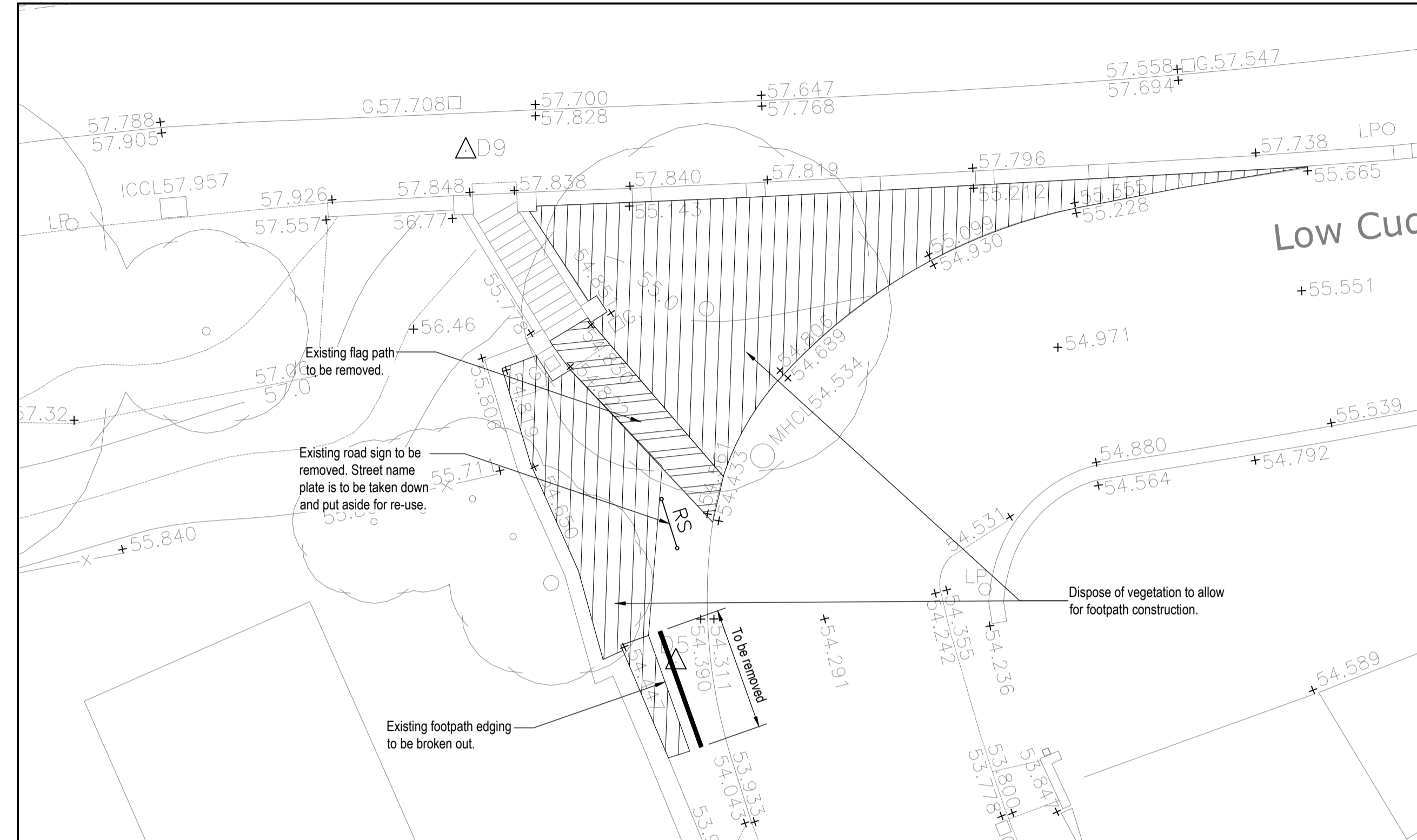

INFORMATION WITHIN THIS DRAWING IS NOT NECESSARILY PRODUCED TO SCALE.
ALWAYS USE FIGURED DIMENSIONS AND CO-ORDINATES - IF IN DOUBT, ASK.

Key	
	To be removed
	Kerbs to be broken out Existing kerbs, bed and backing to be broken out and removed. Waste materials to be disposed to a tip off site.
	Existing vegetation to be removed Existing overgrown vegetation and trees to be removed to prevent footway and street lighting obstruction. Waste materials to be disposed to a tip off site.
	Flag footpath to be removed Concrete paving flags to be removed and mortar bed to be broken out. Waste materials to be disposed to a tip off site.



**LOW CUDWORTH GREEN
(NEAR JUNCTION WITH WHITE CROSS ROAD)**

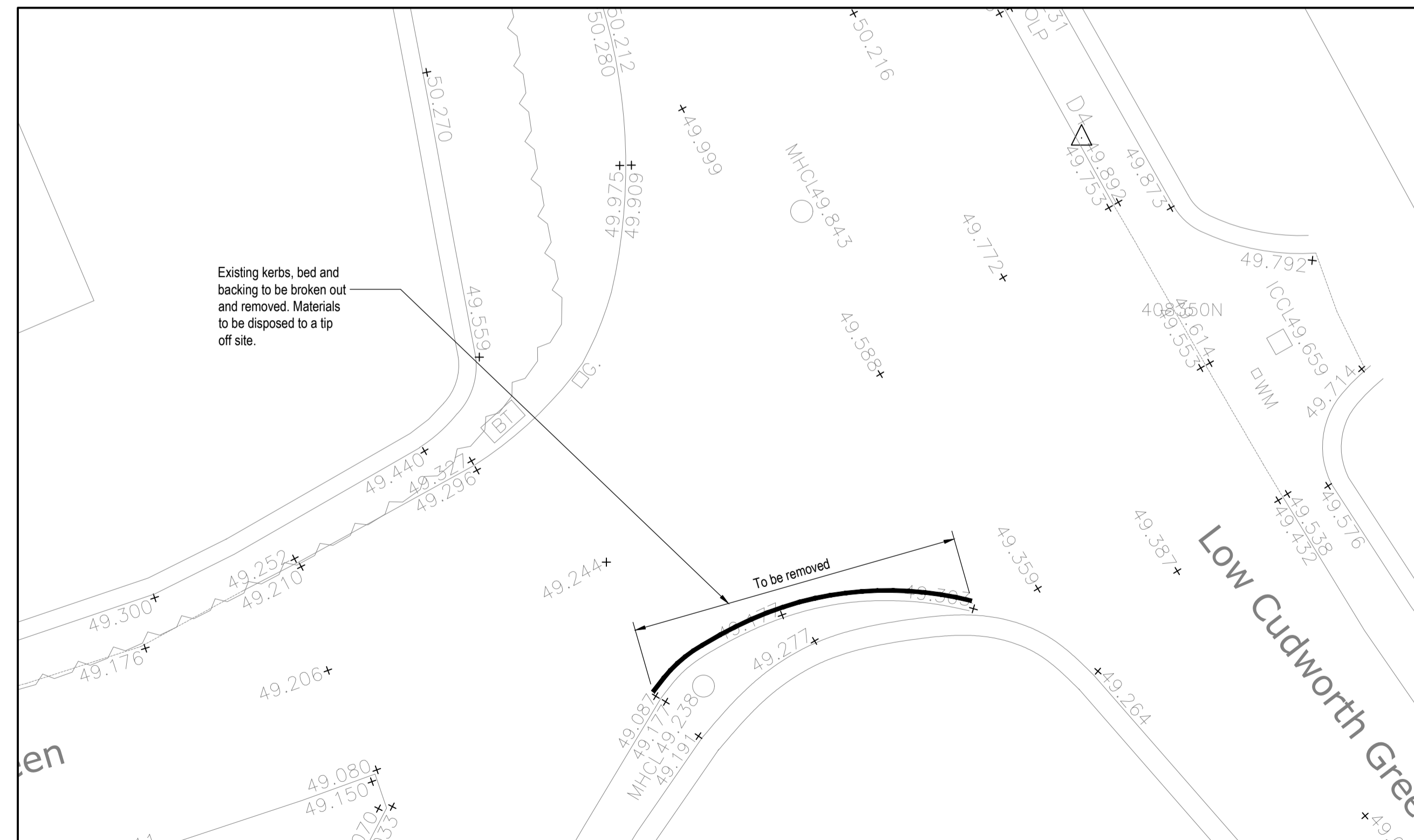

**LOW CUDWORTH GREEN
(NEAR JUNCTION WITH CARRS LANE)**

- NOTES**
- All works shall be carried out in accordance with the Specification for Highway Works unless otherwise instructed by Local Authority Highways Inspecting Officer/Engineer.
 - All Statutory Undertakers covers and frames to be lifted to suit new carriageway and footway levels prior to surfacing.
 - The contractor shall obtain all necessary road opening notices and licenses before the commencement of the works on the highway and should be maintained throughout the duration of the works.
 - Final surfacing should not be laid until all the works by Statutory Undertakers are completed and the drainage CCTV surveys required by Barnsley MBC along with any relevant remedial works are completed to the Local Authority Highways Inspection Officer/Engineers satisfaction.
 - All services are to be located on site before any works are carried out.
 - The contractor is to hand dig any trial pits to locate any services which may be affected by the proposed works.
 - All existing electrical disconnections and any works involving electrical equipment is to be carried out by a qualified, approved electrical engineer.
 - Extents of carriageway tie in to be agreed with Highway Authority Engineer on site.
 - The contractor shall contact the Local Authority Highways Inspecting Officer/Engineer at least 24 hours prior to the commencement of cold milling operations to arrange a site meeting. The extent of carriageway tie-in to be agreed. Costs to be borne by the Developer.
 - After planning operations carriageway is to be jointly inspected and the extents of any additional deep patching/ planning to be agreed with Highway Authority Engineer on site prior to surfacing. Costs to be borne by the Developer.
 - Prior to commencement of construction work, the setting out lines are to be agreed with the Local Authority Highway Inspecting Officer/Engineer on site.
 - Traffic management to be in accordance with the Safety at Streetworks and Road works - A Code of Practice (2nd impression) and is the Contractors responsibility to implement and maintain.
 - The Contractor is to provide and maintain a pedestrian route through the works at all locations at all times.
 - All paving details to tie into existing level.
 - All carriageway and footway ironwork to be class D400.
 - All carriageway ironwork to be bedded on M60 epoxy mortar.
 - All damaged kerbs, channeling and edging to be replaced as directed by Highway Authority Inspecting Officer/Engineer.
 - voids formed in the existing carriageway by the removal of kerbs etc., where compaction is difficult to achieve (up to 750mm width) shall be filled with ST4 concrete up to binder course level.
 - All damaged or worn carriageway and footway iron work to be replaced.
 - Existing gullies and connections within the extents of the works are to be cleaned of debris and jetted through.
 - Cationic bituminous emulsion shall be applied to all surfaces receiving bituminous materials.
 - Tack coats to be applied to all planned surfaces and binder course. The rate of spread of tack coats shall be in accordance with clause 920.8 and BS 5948:7.
 - Ensure low spots are not created in the carriageway channels in the vicinity of pedestrian crossings.
 - Roads to be swept regularly, application of weedkiller and removal of all weeds to be maintained throughout the duration of the works.

B	Updated to suit S278 comments rec'd 03.09.20	GH	CH	28.09.20
A	First Issue.			
REV	DESCRIPTION	SIG	CHK	DATE

**BARRATT & DAVID WILSON HOMES
YORKSHIRE WEST**

**LAND OFF CARRS LANE, CUDWORTH,
BARNSELY, SOUTH YORKSHIRE**

**S278 SITE CLEARANCE PLAN
(SHEET 2 OF 2)**

Eastwood & Partners
CONSULTING ENGINEERS

St. Andrew's House
23 Kingfield Road
Sheffield
S11 9AS
Tel 0114 255 4554
Fax 0114 255 4330

mail@eastwoodandpartners.com
www.eastwoodandpartners.com

SCALE WHEN PLOTTED AT A1 1:100			DRAWING STATUS APPROVAL	
DRAWN	CHECKED	DATE	DRAWING NUMBER	REV
GH	CH	21.12.18	39094/089	B