

This drawing is the copyright of Rosetta Landscape Design and cannot be reproduced in any form without the express consent of the company. Written and scaled dimensions to be checked on site, any discrepancies reported prior to work commencing. **If in doubt please ask.**

This drawing has been prepared for the purpose of planning approval.

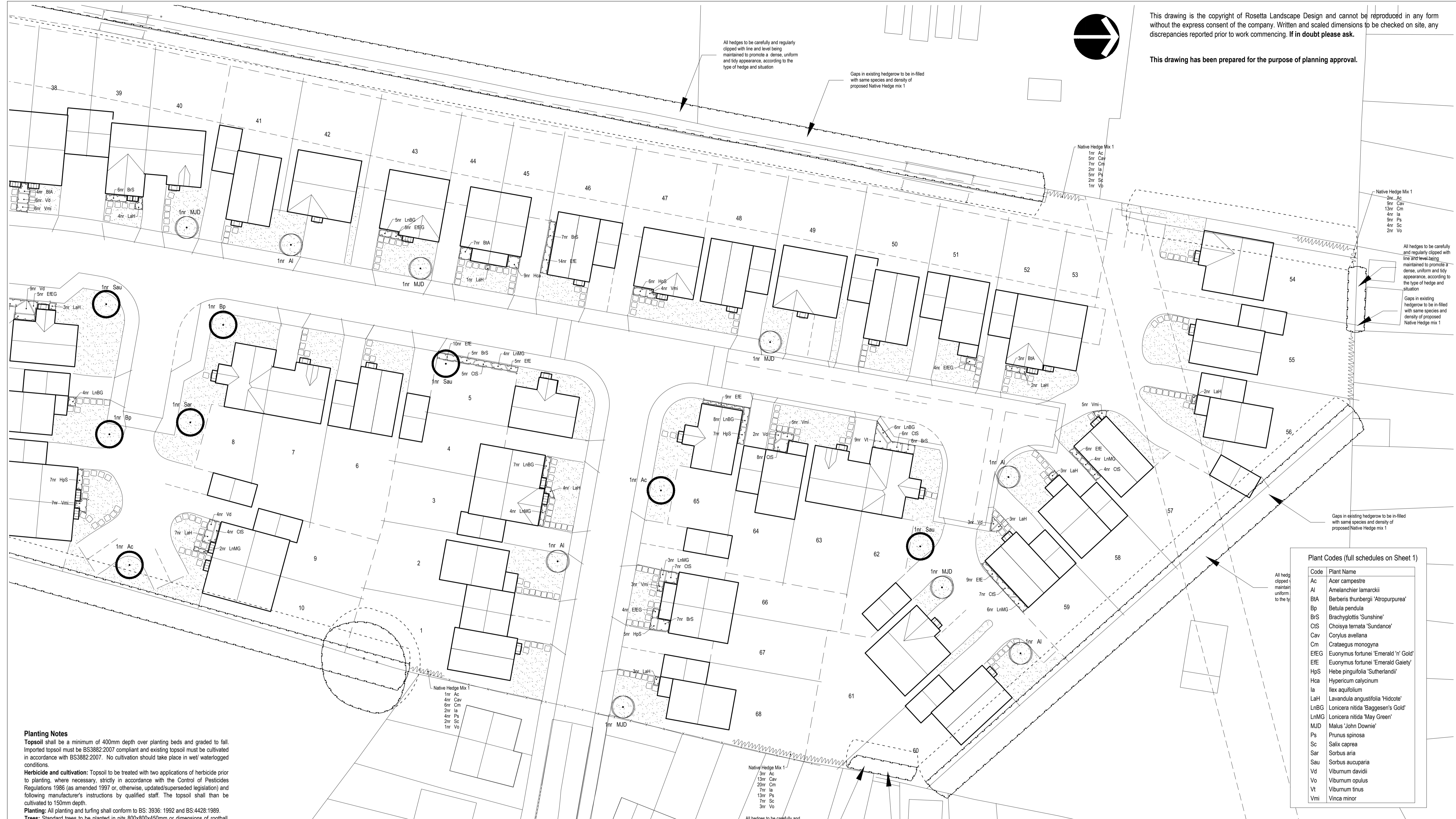
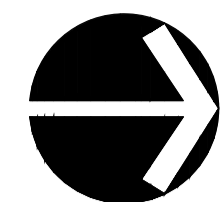

Planting Notes
Topsoil shall be a minimum of 400mm depth over planting beds and graded to fall. Imported topsoil must be BS3882:2007 compliant and existing topsoil must be cultivated in accordance with BS3882:2007. No cultivation should take place in wet/waterlogged conditions.
Herbicide and cultivation: Topsoil to be treated with two applications of herbicide prior to planting, where necessary, strictly in accordance with the Control of Pesticides Regulations 1986 (as amended 1997 or otherwise, updated/superseded legislation) and following manufacturer's instructions by qualified staff. The topsoil shall than be cultivated to 150mm depth.
Planting: All planting and turfing shall conform to BS: 3936: 1992 and BS:4428:1989.
Trees: Standard trees to be planted in pits 800x800x450mm or dimensions of rootball, whichever is greater. Tree to be supported by 1Nr stake (1500mm long, per tree, 600mm above ground, 75mm diameter) and 1Nr bio-degradable tie. Alignure soil improver and 150g Enmag (or equivalent) to be incorporated into the soil of all new tree pits. Trees to be planted centrally within a tree pit.
Container grown shrubs, transplants and whips: Shrubs and transplants shall be planted in pits 300x300x400mm depth, and the backfill shall include 3 litres of peat-free tree and shrub compost. Where two or more shrub species are indicated within a single bed each species shall be randomly mixed throughout the bed in groups of 3/5.
Native hedge: To be planted as a double row.
Herbicide: Spot treat with herbicide throughout the maintenance period in accordance with the manufacturer's instructions.
Mulch: Planting beds to receive 75mm depth pulverized ornamental bark mulch. Native woodland/edge plants to be planted with 800g flax fibre mulch mat pinned to soil. Native hedgerow to be planted through 800g flax fibre mulch roll, edges tucked. Ensure the top of the mulch layer is a minimum of 15mm below adjacent pavements and other surfaces, to prevent spillage.
Plant position: Final position of trees and shrubs subject to confirmation of service location and approval of statutory undertakers.
Grass: All turfseeded areas to be cultivated and levelled as required removing any stones, rubble, subsoil, general construction waste.
Planting Season: Bare-root plants to be planted between mid-November and mid-March dependant upon the planting season.

LEGEND

	Existing tree to be retained		Existing hedge to be retained		Proposed tree Standard (Light)		Proposed native hedge mix
	Existing tree to be removed		Existing hedge to be trimmed back		Proposed shrub bed		
	Existing tree (to be trimmed back)		Proposed tree Standard		Proposed grass		

Plant Codes (full schedules on Sheet 1)

Code	Plant Name
Ac	Acer campestre
Al	Amelanchier lamarckii
BIA	Berberis thunbergii 'Atropurpurea'
Bp	Betula pendula
BrS	Brachyglottis 'Sunshine'
CIS	Choisya ternata 'Sundance'
Cav	Corylus avellana
Cr	Crataegus monogyna
EIEG	Euonymus fortunei 'Emerald 'n' Gold'
EIE	Euonymus fortunei 'Emerald Gaiety'
HpS	Hebe pinguifolia 'Sutherlandii'
Hca	Hypericum calycinum
la	Ilex aquifolium
LaH	Lavandula angustifolia 'Hidcote'
LnBG	Lonicera nitida 'Baggesen's Gold'
LnMG	Lonicera nitida 'May Green'
MJD	Malus 'John Downie'
Ps	Prunus spinosa
Sc	Salix caprea
Sar	Sorbus aria
Sau	Sorbus aucuparia
Vd	Viburnum davidii
Vo	Viburnum opulus
Vt	Viburnum tinus
Vmi	Vinca minor

Rev C: Hedging note added in line with feedback 08Sep22 (RP)
 Rev B: Revised to 1014/3J, received 11Apr22 - 21 Apr22 (MP/jr)
 Rev A: Revised to 1014/3C received 14Oct20 - 15Oct20 (MP/jr)
 Base: Richard Ward Design, 'Planning Layout', 1014/3B

PROJECT Barnburgh View, Goldthorpe Ph 3
 TITLE Detailed Landscape Proposals (2 of 2)
 CLIENT Gleeson Homes and Regeneration
 DATE 05 Oct 20 SCALE 1 : 250 SHEET A0
 DRAWN MP/jr DRAWING NO 3627/3
 CHECKED MP REVISION C

ROSETTA
 LANDSCAPE DESIGN
 Chartered Landscape Architects
 Swallow's Nest, Main Street
 Askham Richard, York, YO26 5NA
 Telephone +44 (0)1904 500410
 Email design@rosettalandscapedesign.co.uk
 Web www.rosettalandscapedesign.co.uk