

Reproduced from Ordnance Survey digital map data © Crown copyright 2009. All rights reserved. License number 100048606

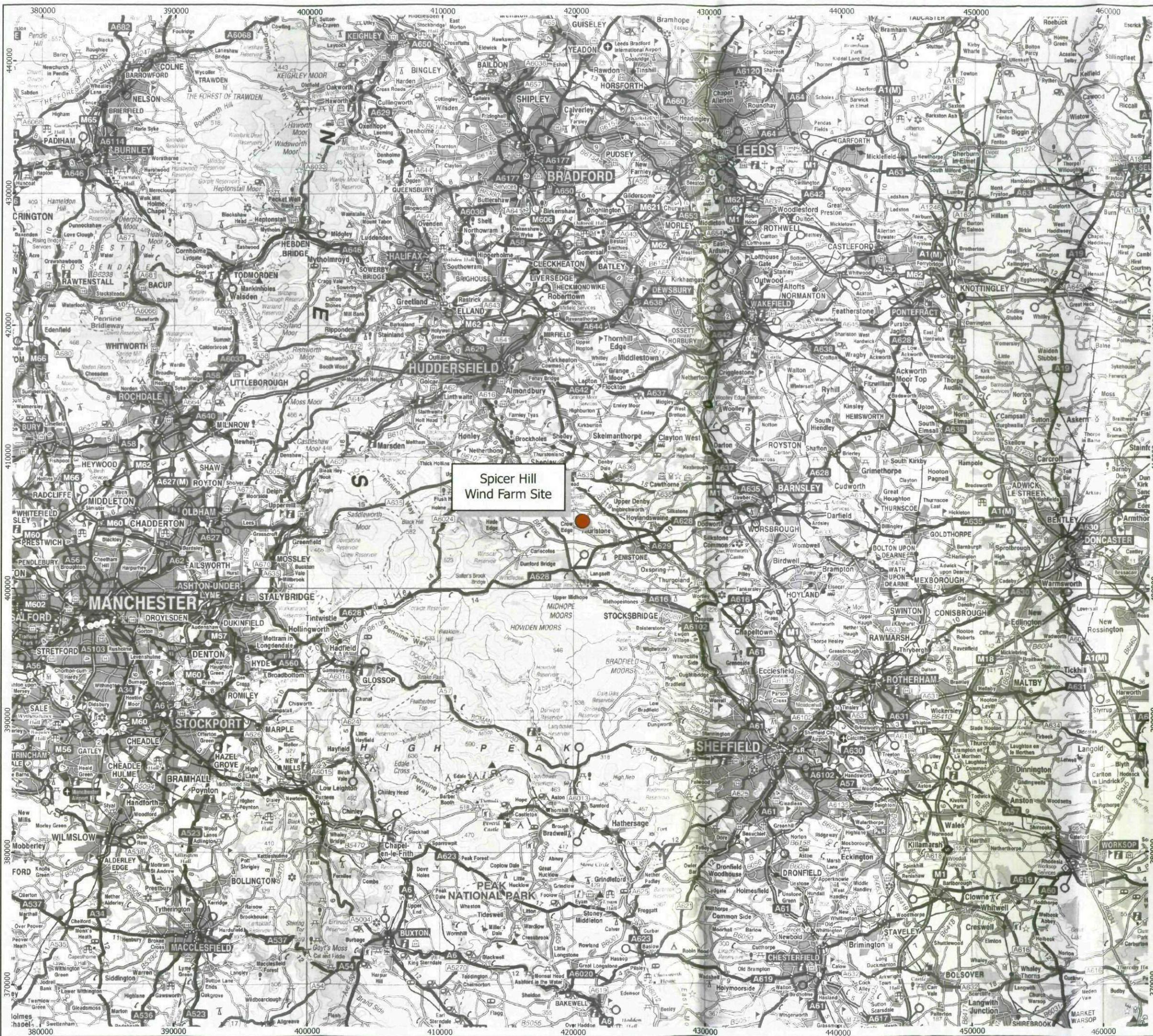

Spicer Hill
Wind Farm Site

J G PEARS LTD



1:275,000 Scale @ A3

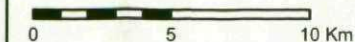

Produced By: SC

Approved By: CS

Ref: 190/PA/001

Revision: A

Date: 22/04/2009

Site Location
Drawing PA1

Spicer Hill Wind Farm
Planning Application

NOTES:

1. All dimensions are in metres unless stated otherwise.

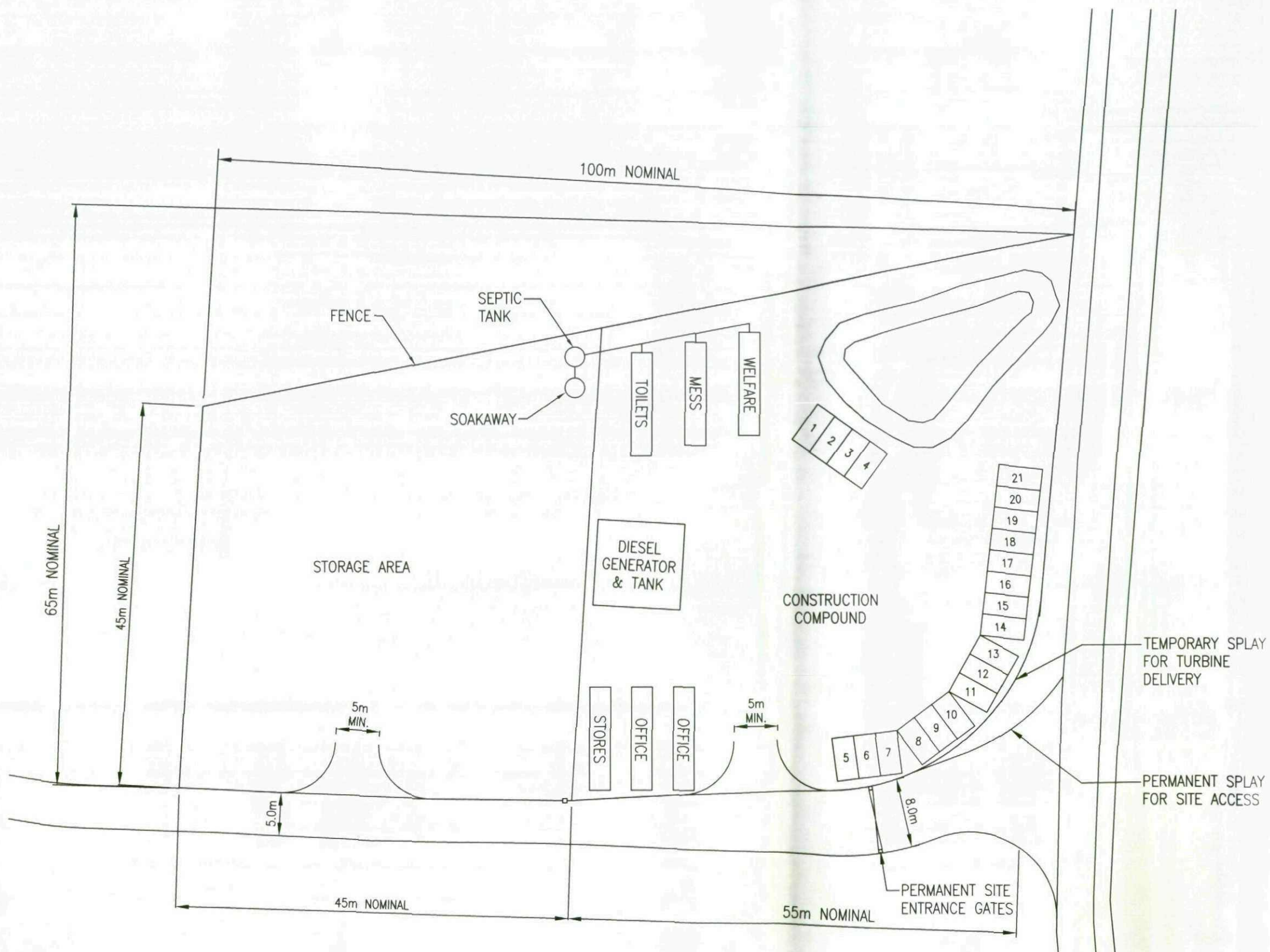

PLAN VIEW
SCALE = 1:500

NOT FOR CONSTRUCTION

Produced By: SC
Approved By: CS

Ref: 190/PA/012
Date: 17/03/2009

Revision: A

**Indicative Temp. Const.
Compound
Drawing PA12**

**Spicer Hill Wind Farm
Planning Application**

NOTES:

1. All dimensions are in millimetres unless stated otherwise.
2. All levels are in metres unless stated otherwise.
3. Foundation details are subject to confirmation following full site investigation relating to known locatoins, ground levels and to final loading information from turbine manufacturer.

NOT FOR CONSTRUCTION

Produced By: SC
Approved By: CS

Ref: 190/PA/011	Revision: A
Date: 16/02/2009	

**Typical Meteorological Mast
Drawing PA11**

**Spicer Hill Wind Farm
Planning Application**

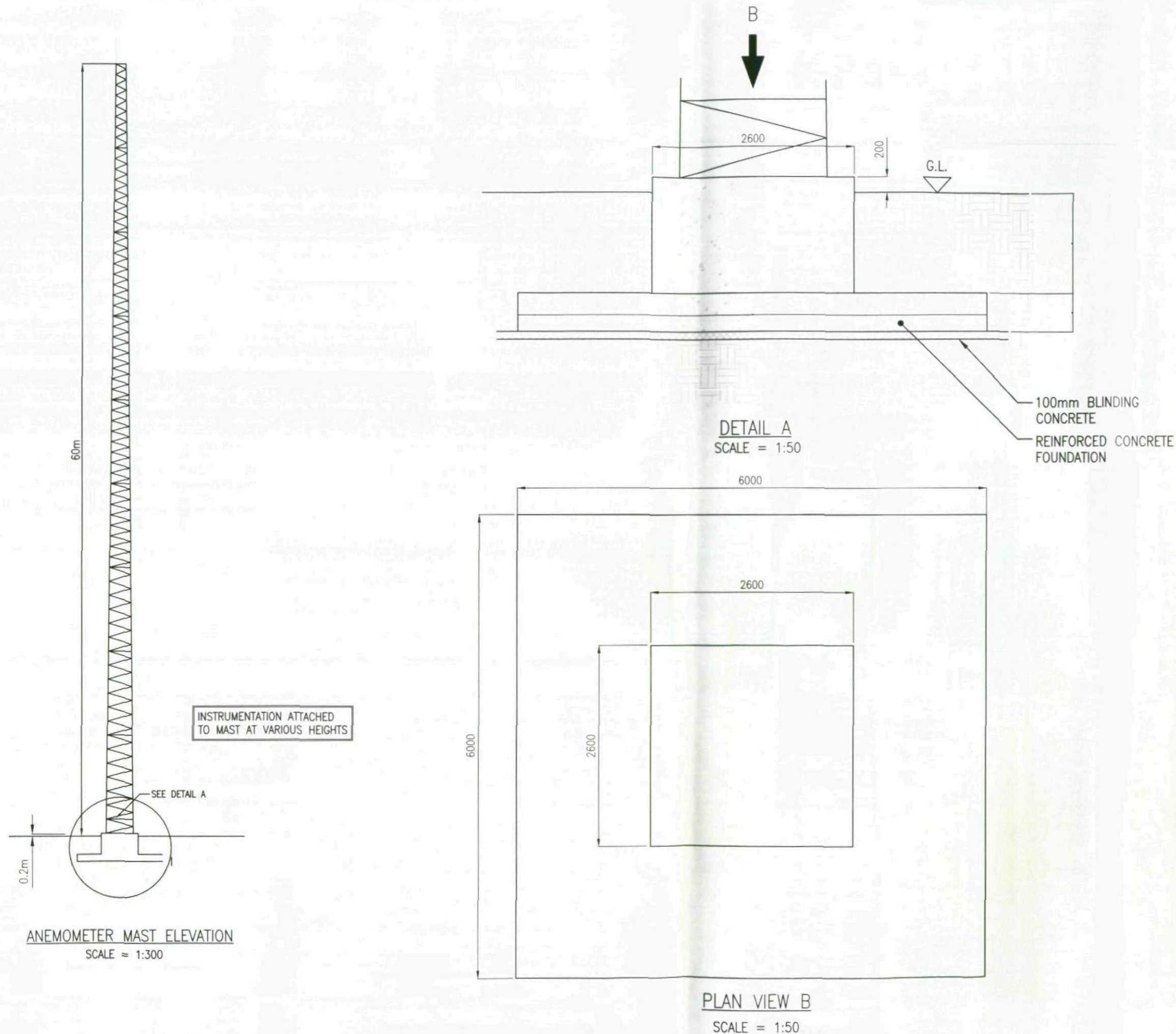

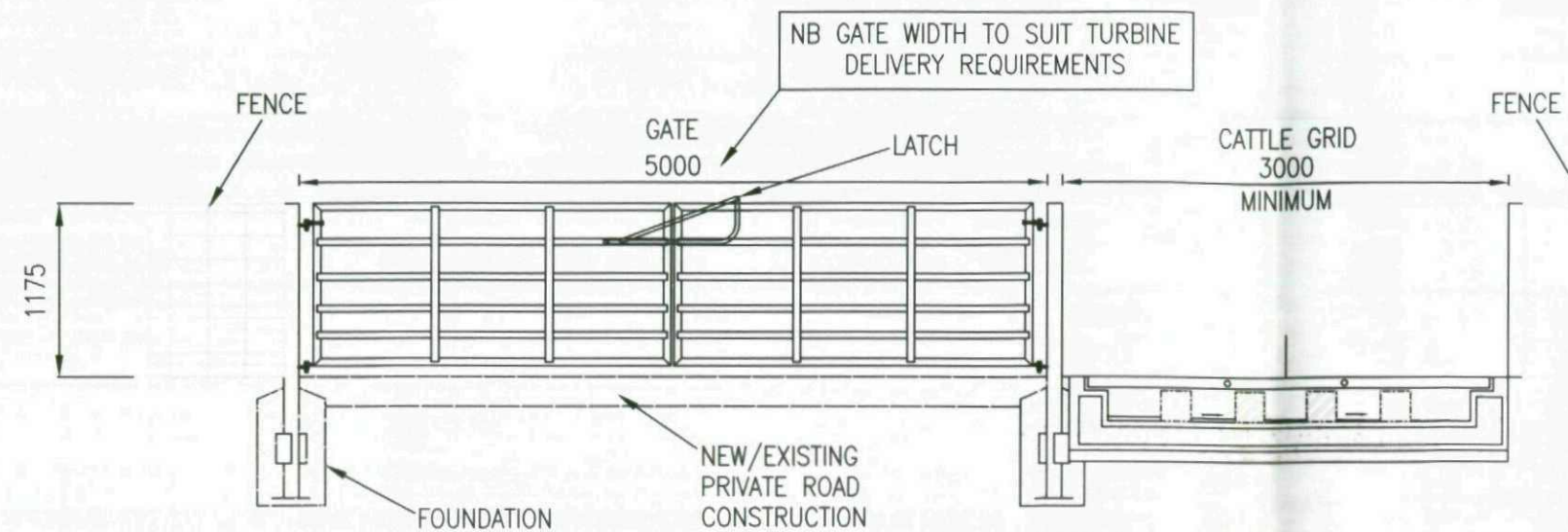

ELEVATION
(SCALE 1:50)

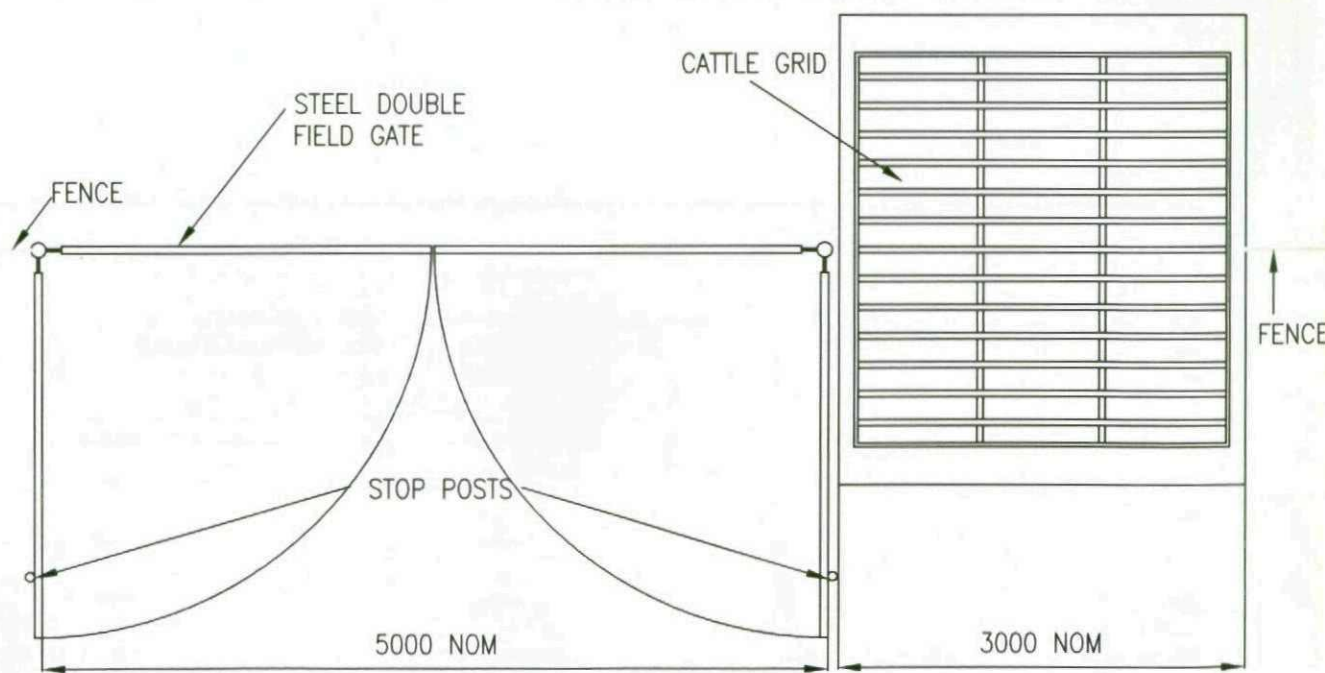

PLAN
(SCALE 1:50)

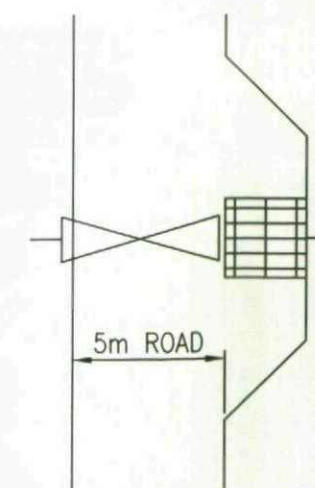

(SCALE 1:250)

NOTES:

1. All dimensions are in millimetres unless stated otherwise.
2. Gates shall comply with BS 3470.
3. All metal fittings and bolts shall be galvanised steel.
4. Gate width to suit requirements for turbine delivery: width to be confirmed.

NOT FOR CONSTRUCTION

Produced By: SC
Approved By: CS

Ref: 190/PA/010

Revision: A

Date: 22/04/2009

Access Gate and Cattle Grid
Drawing PA10

Spicer Hill Wind Farm
Planning Application

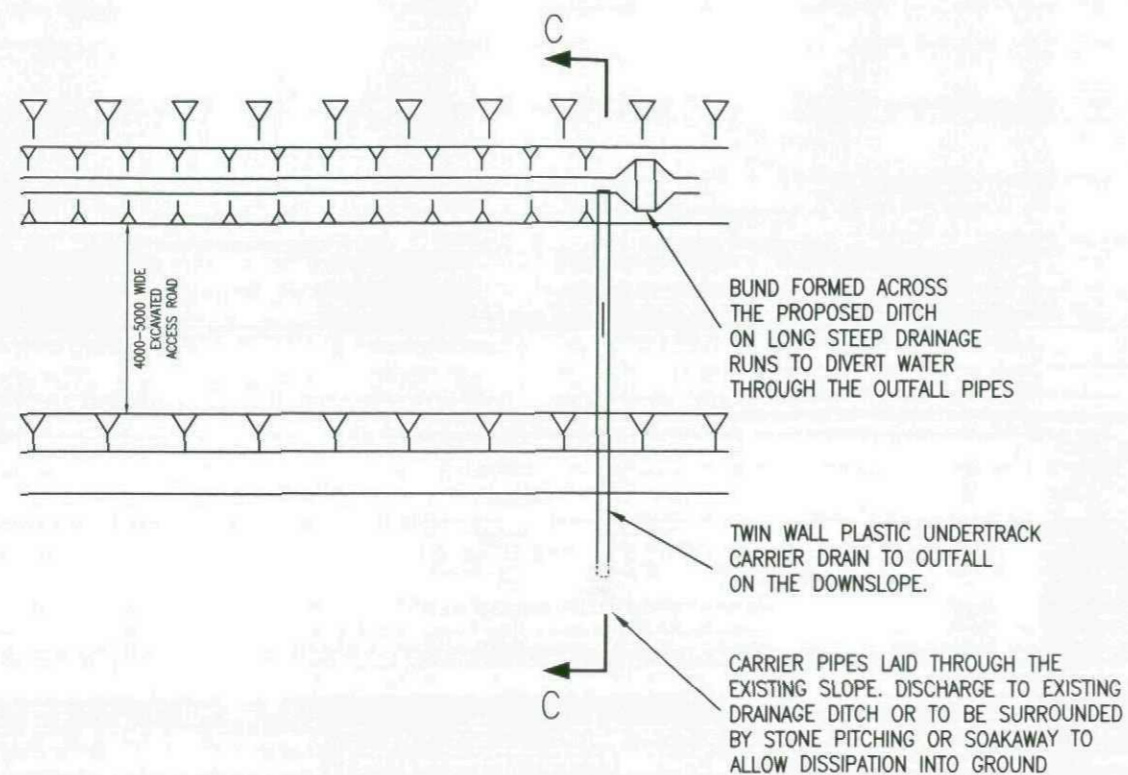

PLAN OF EXCAVATED ROAD ON SIDE SLOPE
SCALE 1:200

NOTE:
SILT MANAGEMENT TO BE ADOPTED IF REQUIRED TO TREAT SURFACE WATER RUN-OFF FROM ROADS DURING CONSTRUCTION TO PREVENT POLLUTION OF WATER COURSES:
FILTERS IN DITCHES OR STILLING LAGOONS AS REQUIRED.

NOTES:

1. All dimensions are in millimetres unless stated otherwise.
2. All levels are in metres unless stated otherwise.
3. Cover to the pipes shall be a minimum 1200mm wherever possible. Where the achievable cover is restricted, 900mm may be adopted following consultation with the designer. In areas where cover needs to be reduced further, an absolute minimum cover of 600mm may be adopted subject to suitable protection being designed for the pipe (i.e concrete surrounds).

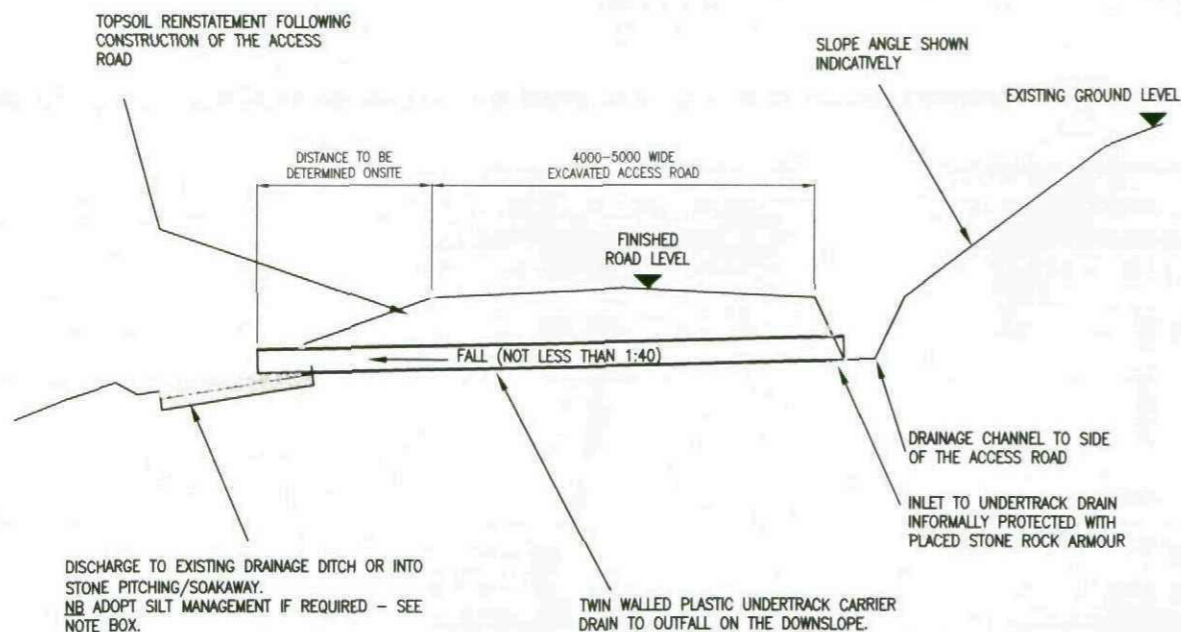

TYPICAL CROSS SECTION C-C
THROUGH ROAD CONSTRUCTION
SCALE 1:100

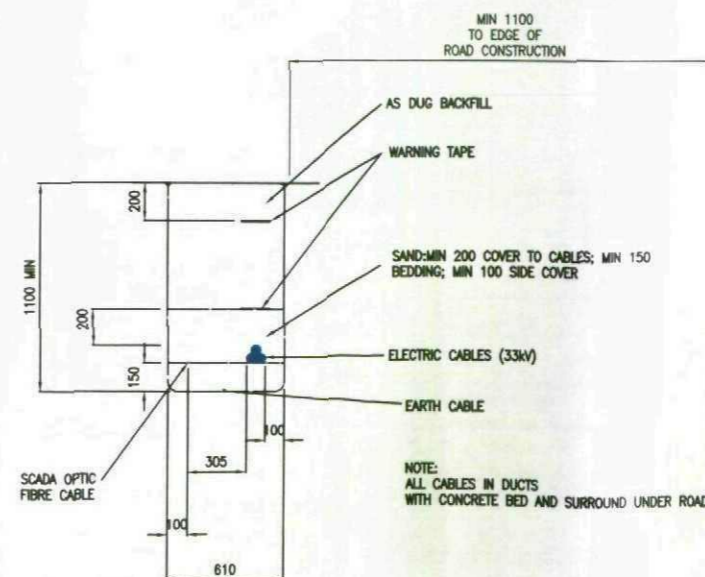

CABLE TRENCH DETAIL
1:40

NOT FOR CONSTRUCTION

Produced By: SC
Approved By: CS
Ref: 190/PA/009
Date: 22/04/2009

Revision: A

**Cable Trench and
Drainage Details**
Drawing PA9

**Spicer Hill Wind Farm
Planning Application**

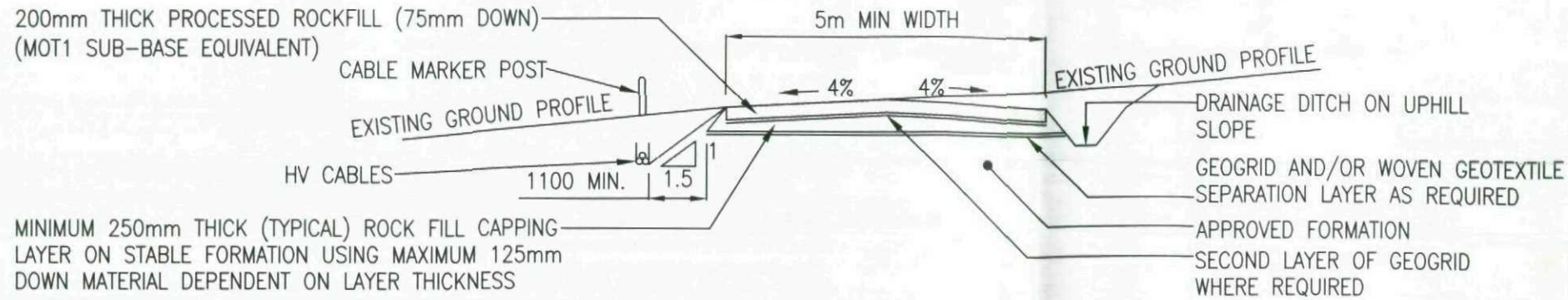

TYPICAL SECTION THROUGH EXCAVATED ROAD (1:100)

(WHERE PEAT DEPTH GENERALLY LESS THAN 1.2m OR WHERE SIDE SLOPE >1:12 GRADIENT)

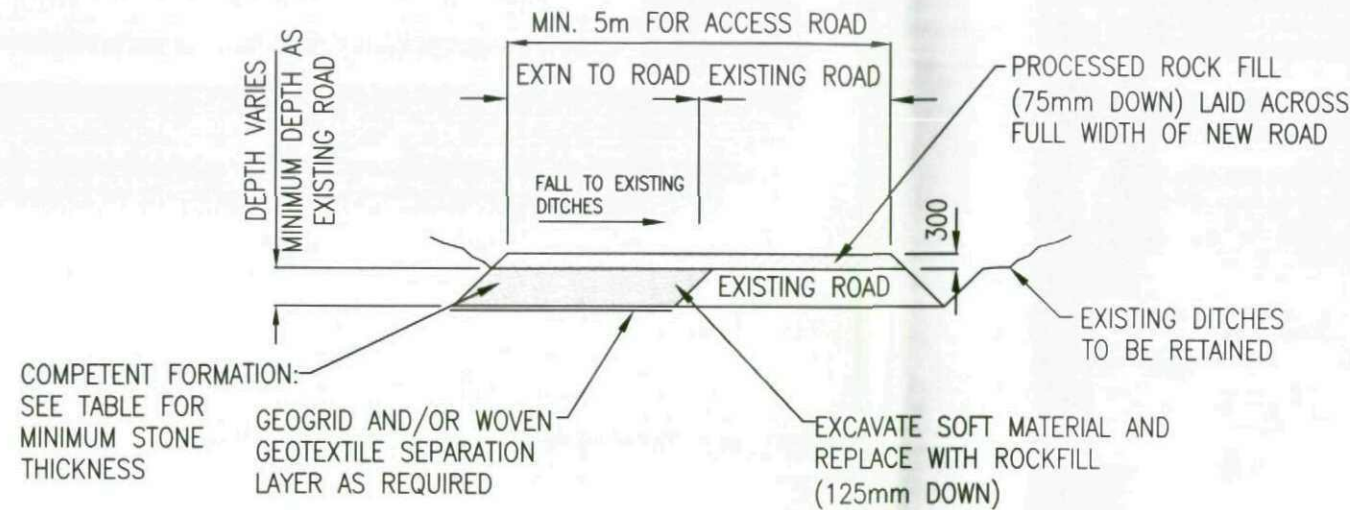

TYPICAL SECTION WIDENING OF EXISTING CUT ROAD (1:100)

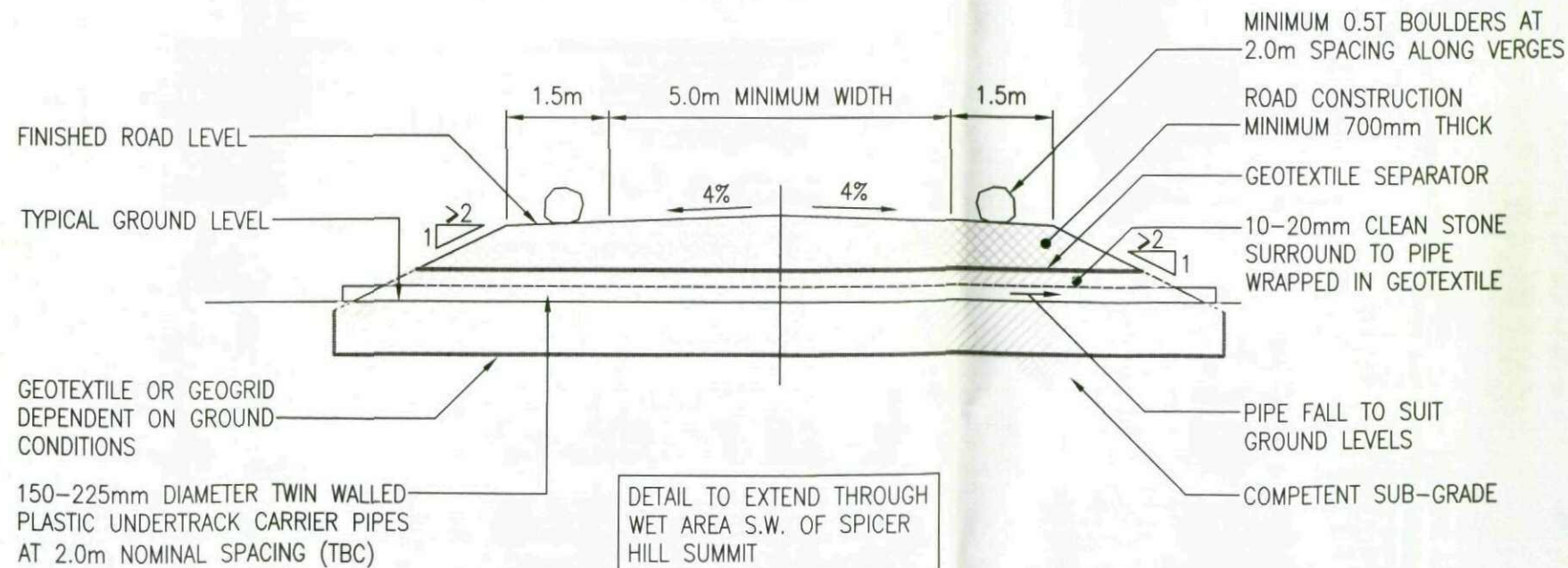

SECTION: CROSSING OF WET AREA (1:100)

NOTES:

1. All dimensions are in millimetres unless stated otherwise.
2. All levels are in metres unless stated otherwise.

NOT FOR CONSTRUCTION

Produced By: SC
Approved By: CS

Ref: 190/PA/008

Revision: A

Date: 16/02/2009

Road Cross Section: Excavated, Widening and Wet Area Crossing
Drawing PA8

Spicer Hill Wind Farm
Planning Application

NOTES:

1. All dimensions are in metres unless stated otherwise.

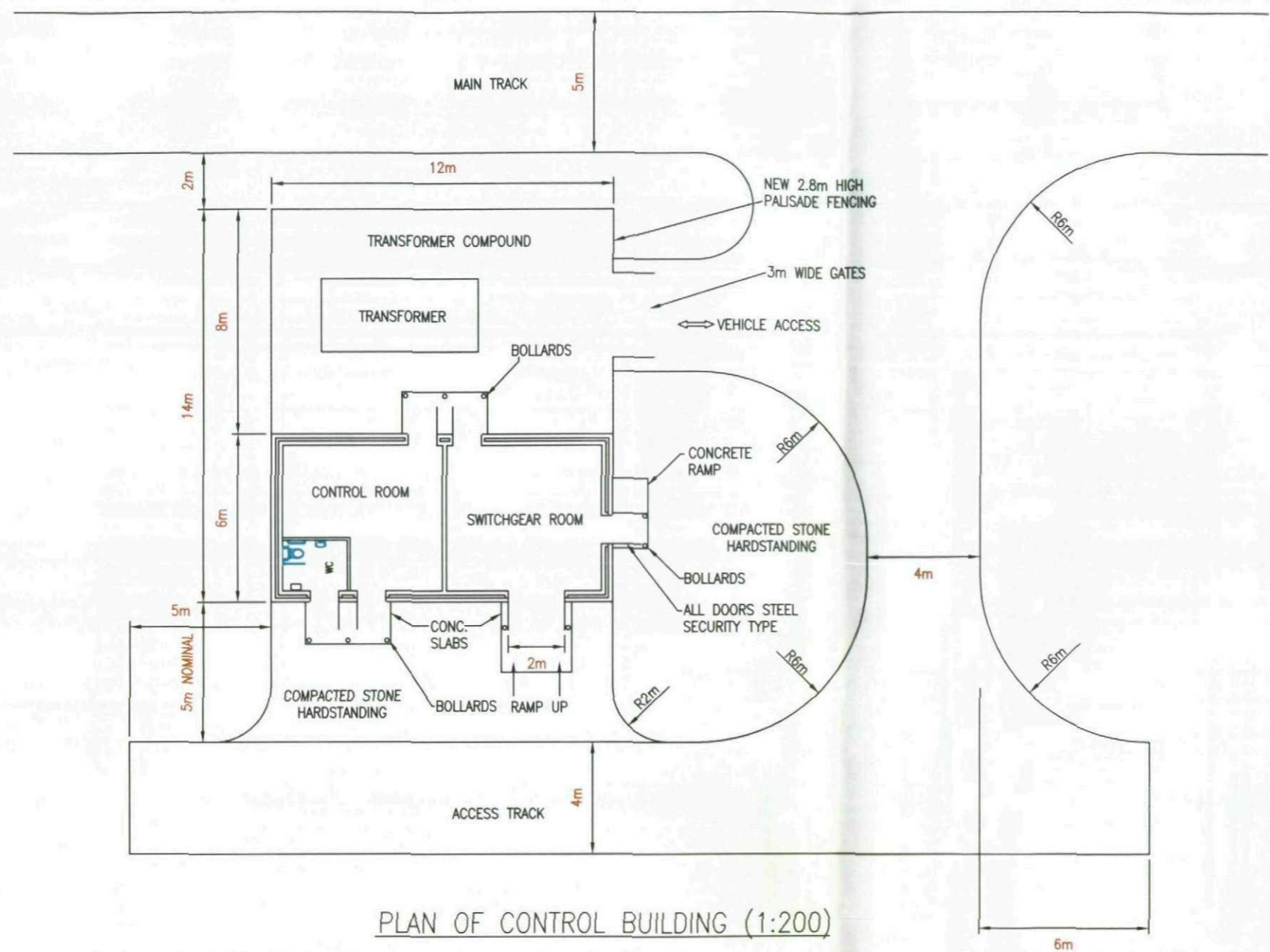

PLAN OF CONTROL BUILDING (1:200)

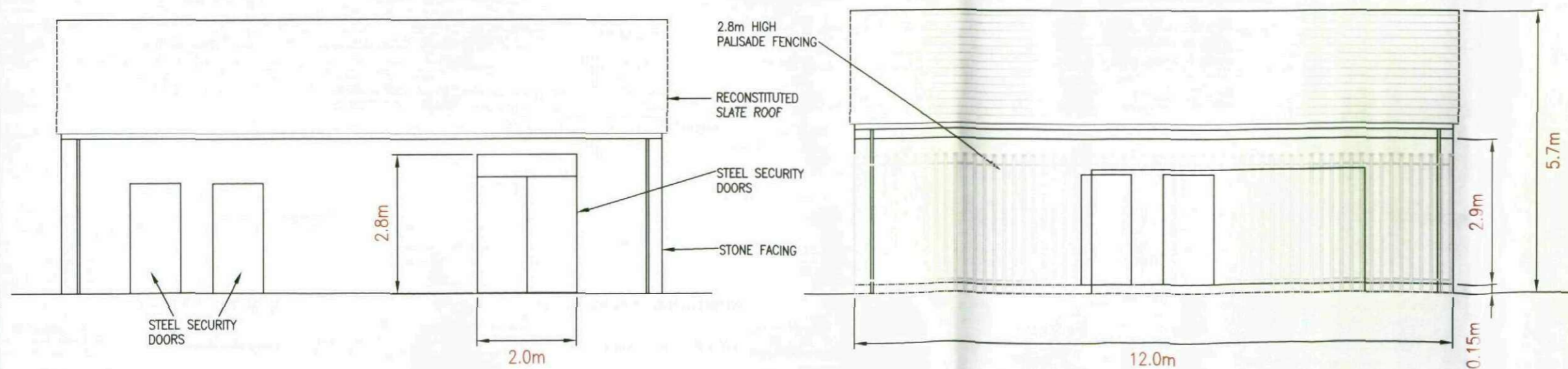

FRONT ELEVATION (1:100)

REAR ELEVATION (1:100)

NOT FOR CONSTRUCTION

Produced By: SC	Revision: A
Approved By: CS	
Ref: 190/PA/007	
Date: 17/03/2009	

Control Building - Plan & Elevation
Drawing PA7

Spicer Hill Wind Farm
Planning Application

NOTES:

1. All levels are in metres unless stated otherwise.

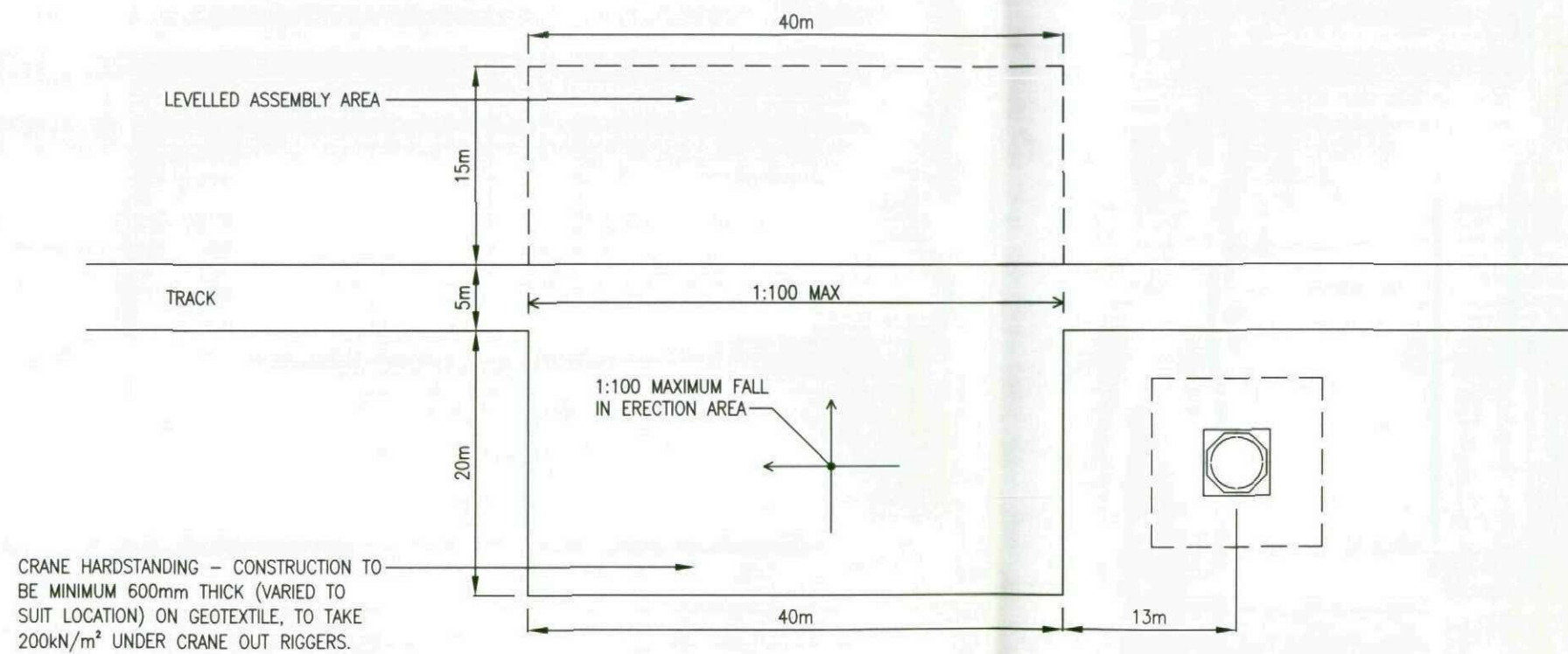

LAYOUT
CRANE HARDSTANDING JOINED TO ACCESS ROAD
SCALE 1:500

NOT FOR CONSTRUCTION

Produced By: SC
Approved By: CS

Ref: 190/PA/006

Revision: A

Date: 16/02/2009

Turbine Erection Area
Drawing PA6

Spicer Hill Wind Farm
Planning Application

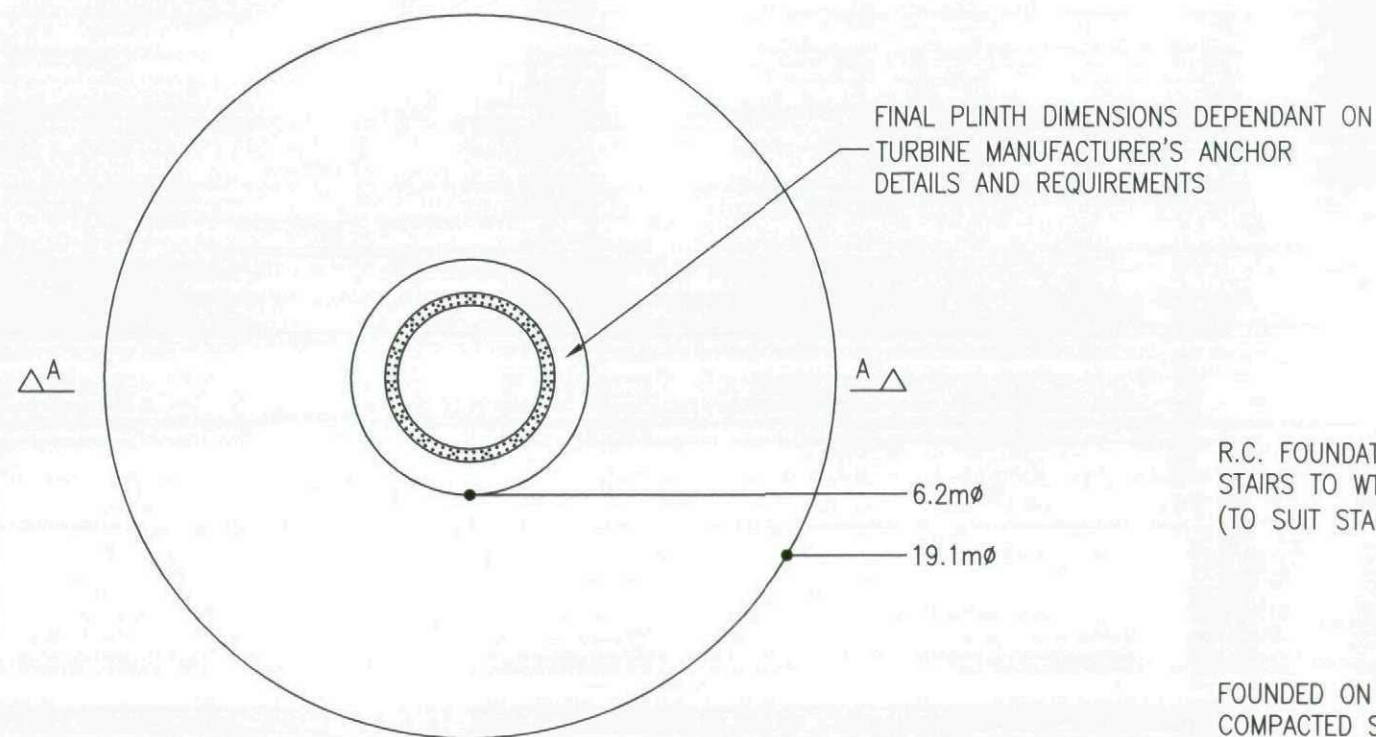

PLAN ON TYPICAL TURBINE BASE (1:200)

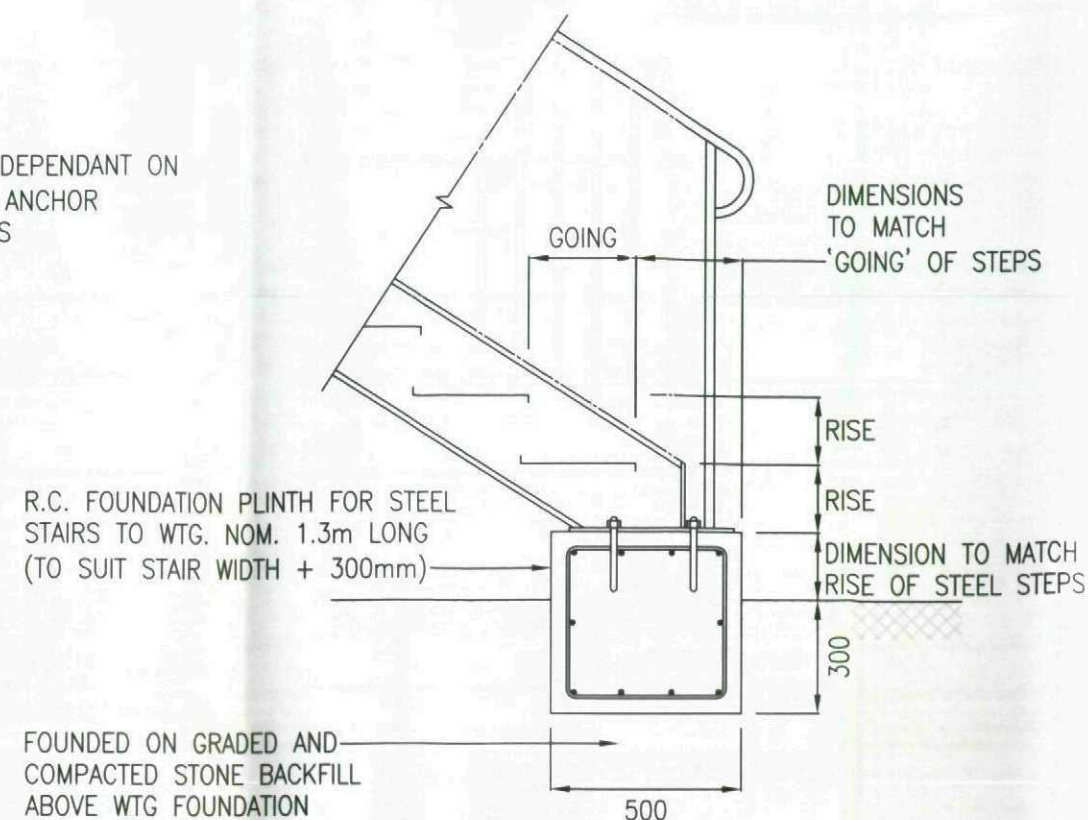

STAIRCASE BASE DETAIL (1:20)

NOTES:

1. All dimensions are in metres unless stated otherwise.

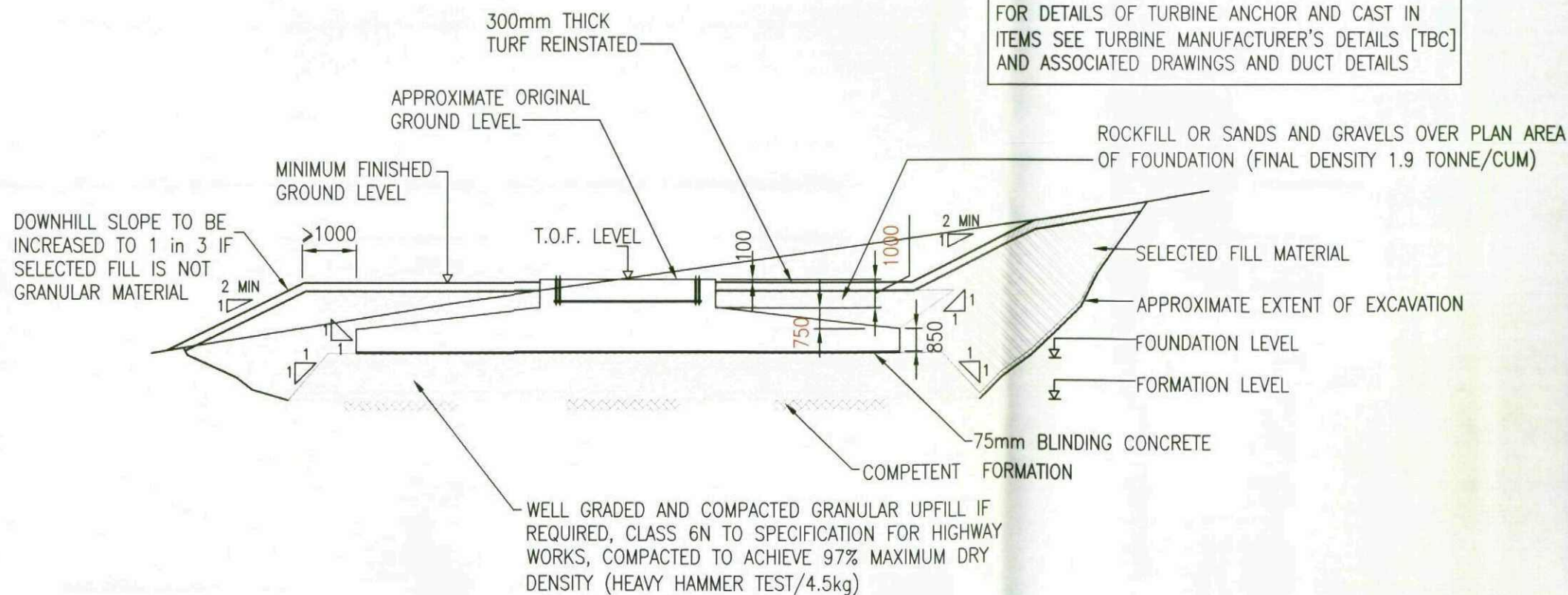

SECTION A-A THROUGH TYPICAL TURBINE BASE (1:200)

NOT FOR CONSTRUCTION

Produced By: SC	Approved By: CS
Ref: 190/PA/005	Revision: A
Date: 17/03/2009	

Indicative Temp. Const. Compound
Drawing PA5

Spicer Hill Wind Farm
Planning Application

NOTES:

- 1. All dimensions are in metres unless stated otherwise.

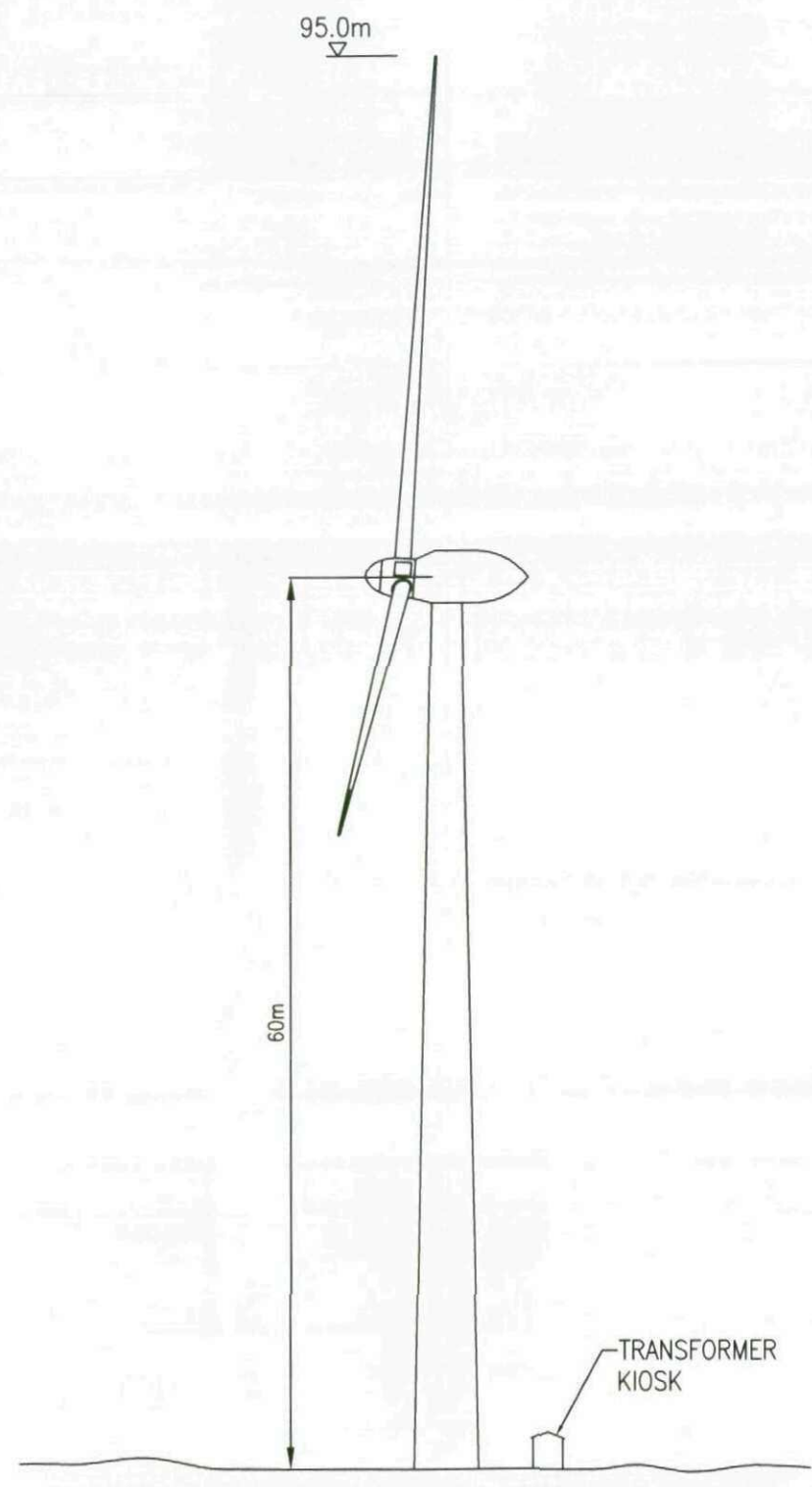

SIDE ELEVATION
SCALE = 1:500

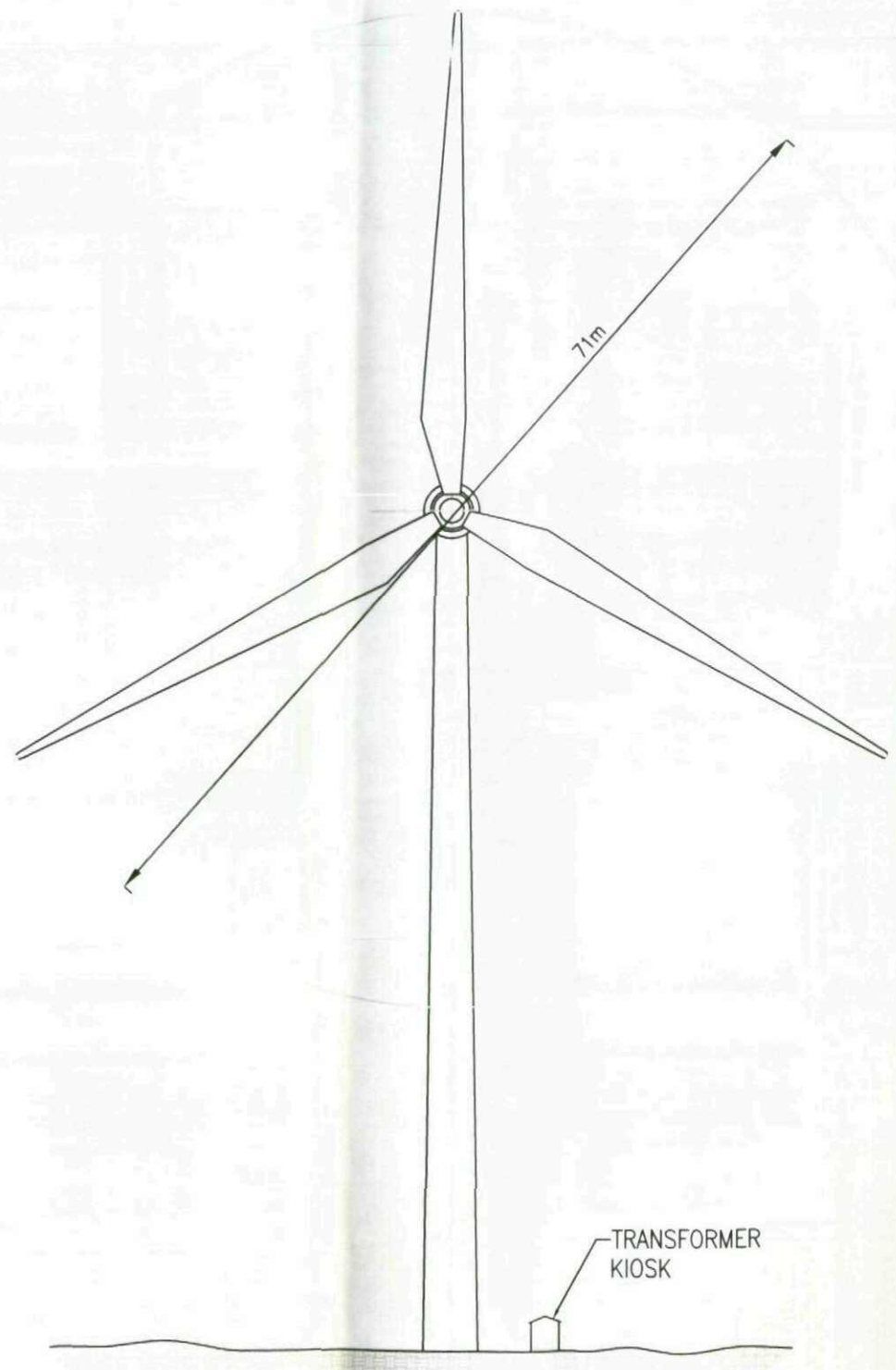

FRONT ELEVATION
SCALE = 1:500

NOT FOR CONSTRUCTION

Produced By: SC
Approved By: CS

Ref: 190/PA/004

Revision: A

Date: 20/03/2009

Typical Turbine
Drawing PA4

Spicer Hill Wind Farm
Planning Application

NOTES:

1. Access track alignment shown is indicative and subject to further detailed design.
2. Grass verges within the visibility splays to be maintained to a height of 600mm.
3. Visibility splay Y-distance of 215m for derestricted single carriageway as per DMRB TD42/95.

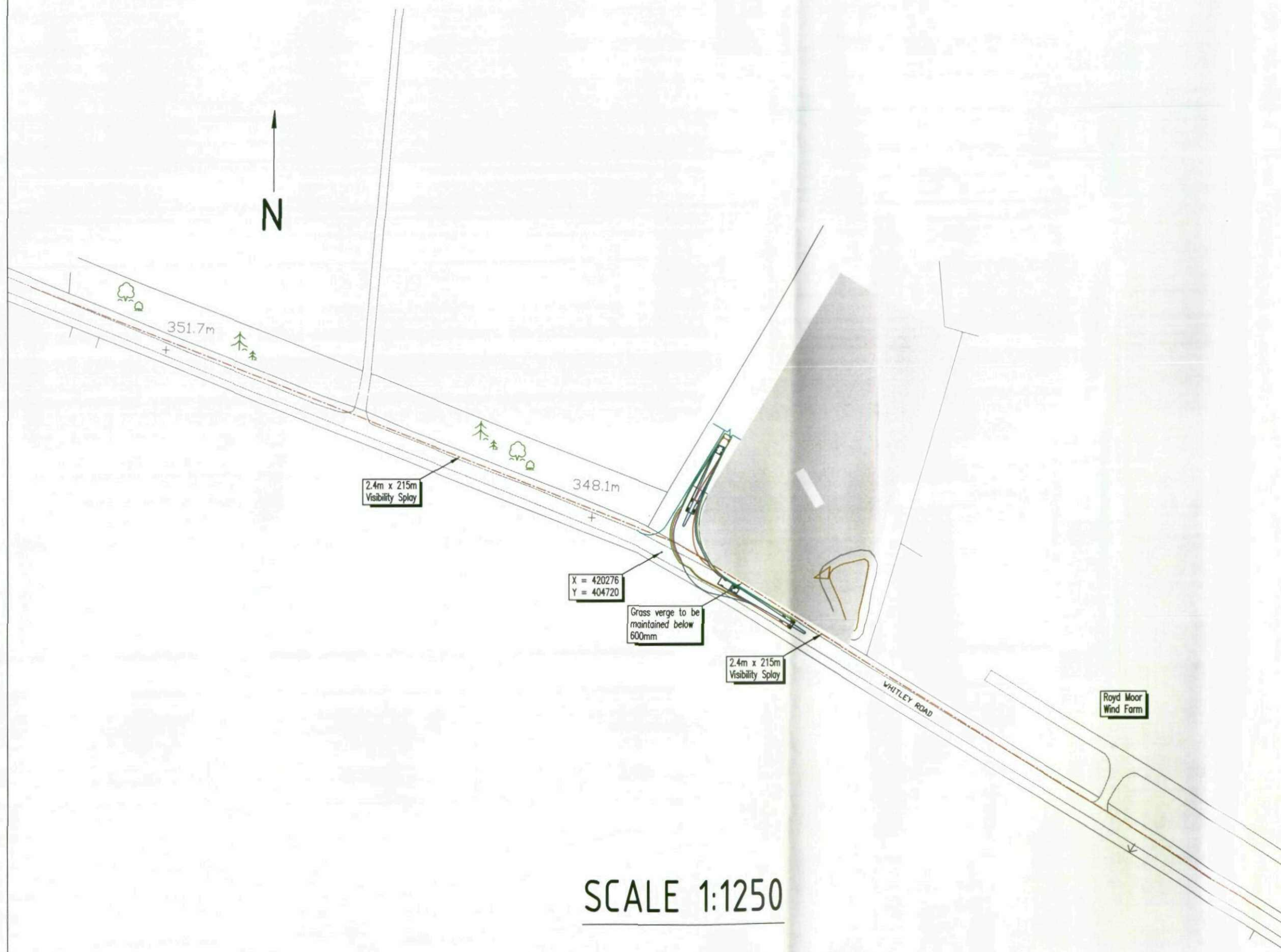

SCALE 1:1250

NOT FOR CONSTRUCTION

Produced By: SC
Approved By: CS

Ref: 190/PA/003
Date: 16/02/2009

Revision: A

Site Access Details
Drawing PA3

Spicer Hill Wind Farm
Planning Application