

OLD SCHOOL

OLD SCHOOL
SCHOOL
YARD

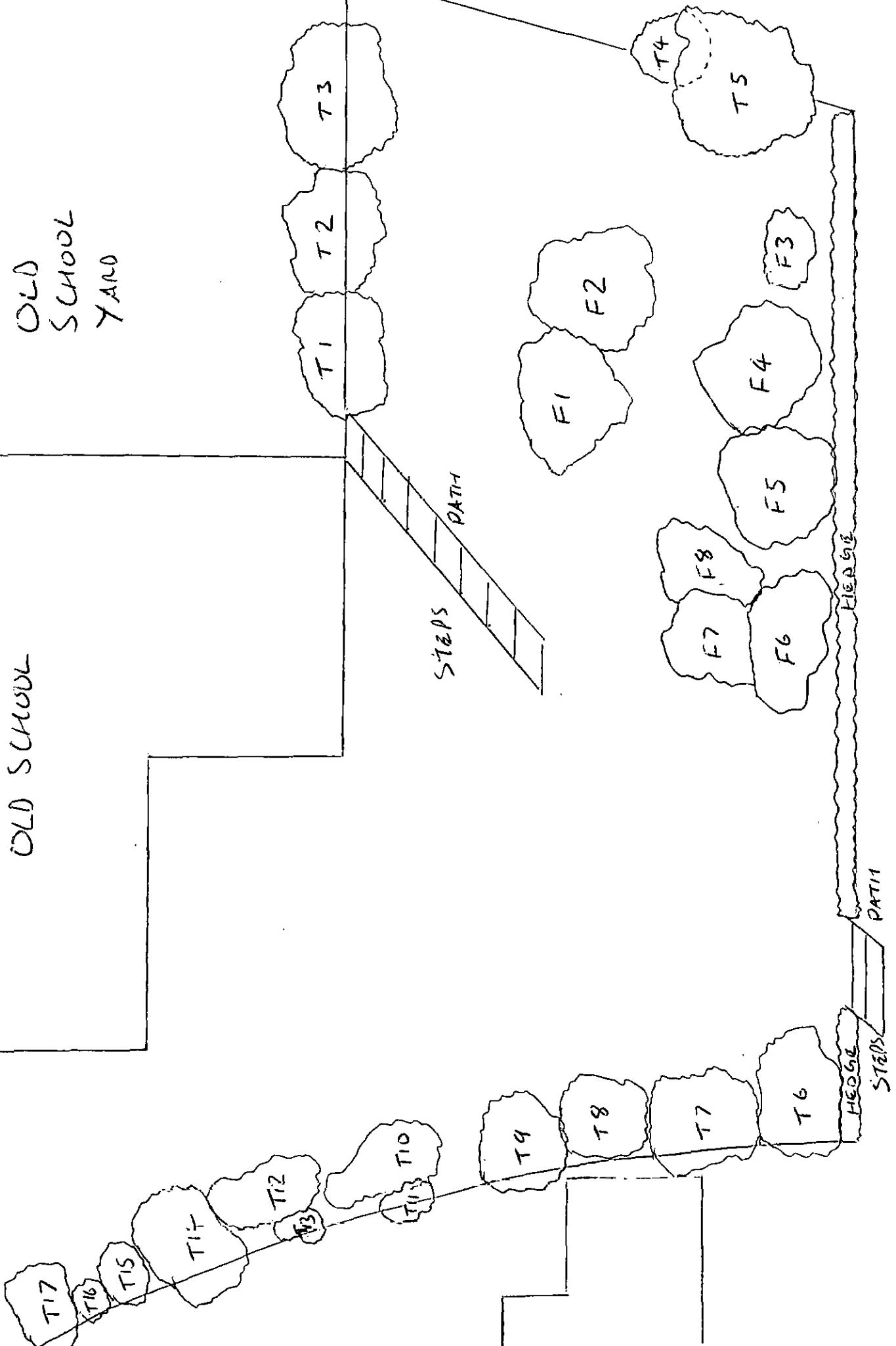

PARK AVENUE

The overall reason for tree works is to bring the trees in this area back into management. The trees have grown close to each other and are growing over 3 boundaries. The plan is to crown lift and crown reduce to alleviate stress to the trees themselves and to let in more light and increase airflow to help maintain this area for the future.

T1 – Yew – crown lift to 4m

T2 – Yew – crown lift to 4m

T3 – Yew – crown lift to 4m

T4 – Sycamore – Remove due to being suppressed by larger tree and causing it to grow in poor form. Tree has no amenity value. No need to plant a tree in its place as the area is well stocked with trees.

T5 – Sycamore – crown lift over neighbouring property.

T6 – Rhododendron – Hard prune back to stumps to allow re-growth.

T7 – Yew – crown reduce / crown lift

T8 – Yew – crown reduce / crown lift

T9 – Holly – crown reduce / crown lift

T10 – Yew – crown reduce / crown lift

T11 – Yew – crown reduce / crown lift

T12 – Laburnum – Remove due to poor form and non-native.

T13 – Yew – crown reduce / crown lift

T14 – Laurel – crown reduce / crown lift

T15 – Holly – crown reduce / crown lift

T16 – Holly – crown reduce / crown lift

T17 – Yew – crown reduce / crown lift

F1 – Sycamore – no work required

F2 – Sycamore – no work required

F3 – Holly – no work required

F4 – Sycamore – no work required

F5 – Sycamore – no work required

F6 – Holly – no work required

F7 – Holly – no work required

F8 – holly – no work required