

Repointing around window and doors - refer to window/door repair schedules

Drawing to be read in conjunction with:

- EFAS-PUR-13-XX-DR-A-3000-3004 Elevation Repairs
- EFAS-PUR-13-RF-DR-A-3005 Roof Repairs
- EFAS-PUR-00-XX-SH-A-0007 Window Repairs
- EFAS-PUR-00-XX-SH-A-0006 Door Repairs
- Architectural Specification
- Structural Engineer's information

Redecoration

Redecorate all existing cast iron rainwater goods as M60/131

Redecorate all timber eaves brackets as M60/130

Notes: 22/09/2023 18:19:07

Drawings are based on survey data and may not accurately represent what is physically present.

Do not scale from this drawing. All dimensions are to be verified on site before proceeding with the work.

All dimensions are in millimeters unless noted otherwise.

Purcell shall be notified in writing of any discrepancies.

Key Plan
not to scale

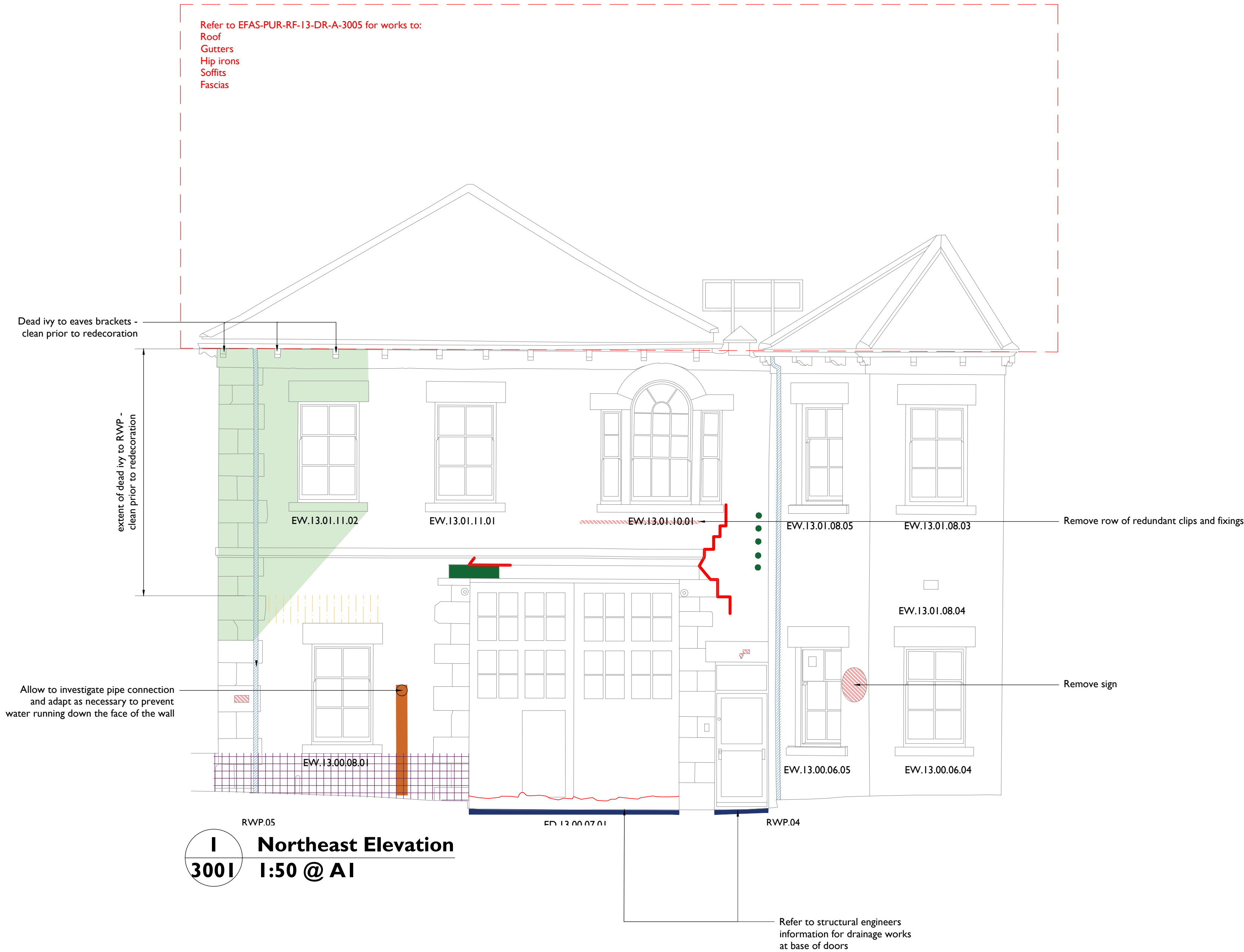

I
3001

Northeast Elevation
1:50 @ A1

- Key**
- Replacement ashlar as C41/111
Partially indicated on drawings, allow 7no. total, exact locations to be confirmed when access is provided
 - Replacement moulded stonework as C41/111
 - Mortar repair as C41/116
Partially indicated on drawings, allow 35no. total, exact locations to be confirmed when access is provided
 - Allow 100% rake out and repoint as C41/126
Partially indicated on drawings, allow 49m², exact locations to be confirmed when access is provided
 - Allow to defrass as C41/411 and 50% rake out and repoint as C41/126
 - Repoint crack/open joint as C41/126
 - Extent of DPC. Allow to remove and repoint as C41/136
 - Allow to remove redundant fixtures and fittings and repoint as C41/136.
Large fittings noted on drawing, allow to also remove other minor redundant fittings such as clips and brackets, allow 40no. total. Redundancy of M+E fittings to be confirmed by M+E contractor, terminated and removed as necessary.
 - Remove remnants of dead ivy as C40/110
 - Treat staining with Doff as C40/121
 - Replacement apron flashing as H71/411
Generally all lead installation to LSTA standard details.
 - Replacement eaves bracket as G20/276
Additionally allow repairs to 20no. eaves brackets, exact locations to be confirmed when access is provided.
 - Water test all rainwater goods as R10/900. Allow to reseal joints as R10/360



C01	22/09/2023	TW	TW	.	
REV	DATE	BY	CHK	DESCRIPTION	

CLIENT

Barnsley MBC

PROJECT

Elsecar - Forging Ahead

JOB NUMBER

241992

TITLE

Building 13

Repairs Northeast Elevation

SIZE	SCALE	LAST REVISED	DRAWN	CHECKED
A1L		22/09/2023	TW	TW
REV	SUITABILITY/REASON FOR ISSUE			
C01	A - Tender			
DRAWING NAME				
EFAS-PUR-13-XX-DR-A-3001				