

\*For the purposes of Planning Consent the following applies to any copy of this drawing made by the Local Authority:  
 This copy has been made by and with the authority of the person required to make the plan and drawing open to public inspection pursuant to Section 47 of the Copyright, Designs and Patents Act 1988. Unless that Act provides a relevant exception to copyright, the copy must not be copied without the prior permission of the copyright owner. If any copy is made under the authority only the whole drawing including the copyright holder's name and this notice, is to be copied.\*

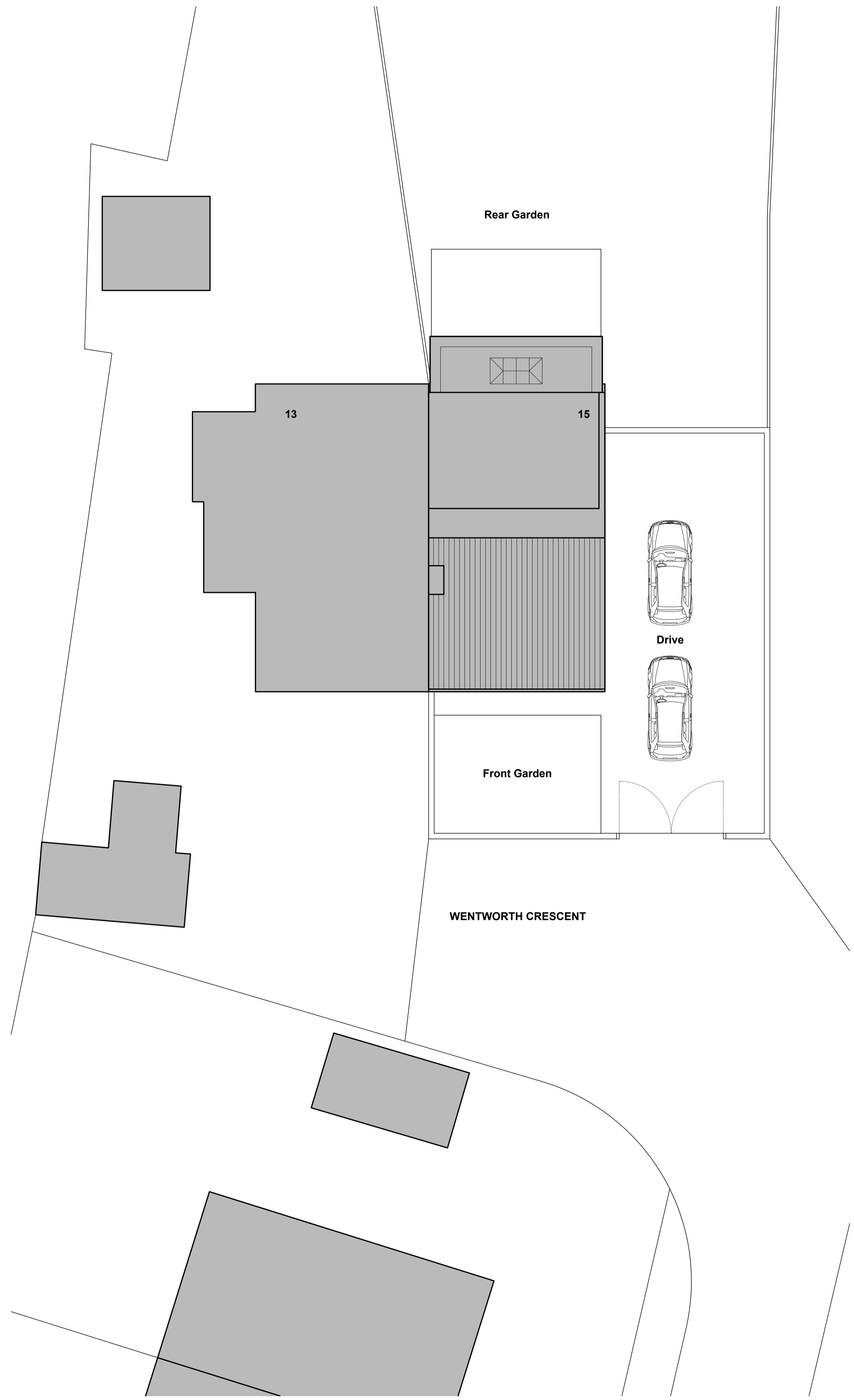
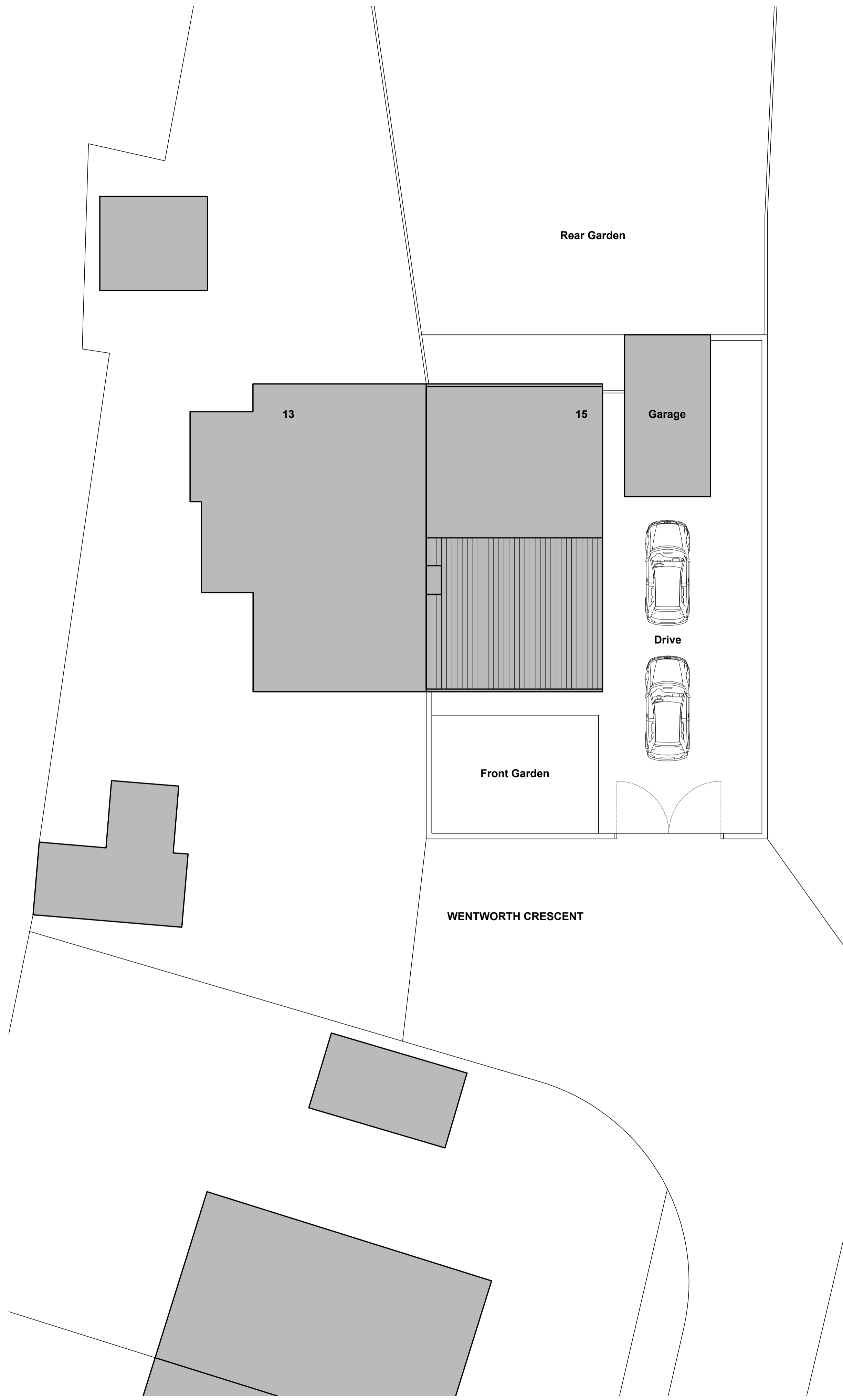
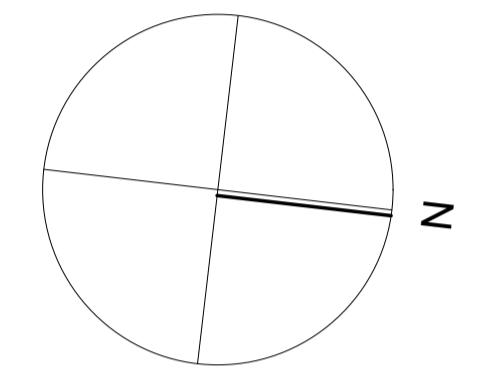
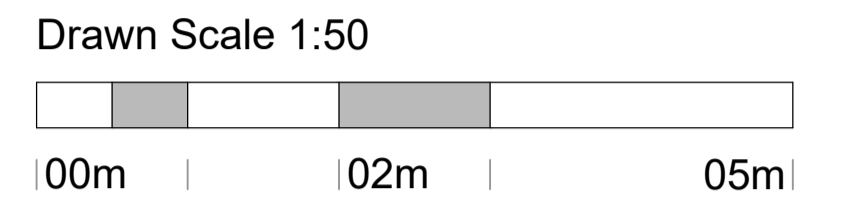
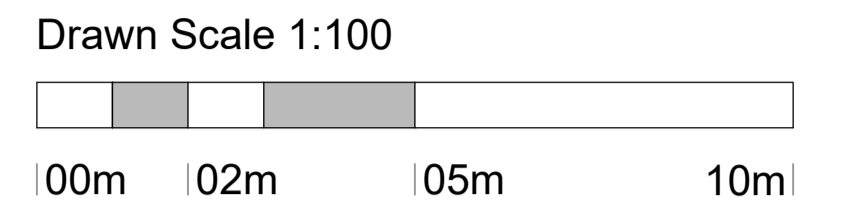

EXISTING SITE PLAN 1:100 @ A1

PROPOSED SITE PLAN 1:100 @ A1

**Issue Purpose: PLANNING APPLICATION**

AHJ architects  
 The Courtyard 1 | 07968944840  
 12a Commercial Road e | info@ahjarchitects.co.uk  
 Skelmanthorpe  
 Huddersfield  
 HD8 9AA  
 www.ahjarchitects.co.uk



Client Martin and Vicky  
 Project 2657 : 15 Wentworth Crescent : Domestic Extension  
 Title Existing and Proposed Site Plans

Issued From  
 Date May 2026  
 Scale 1:100 @ A1  
 Drawn BH Auth BH

Drawing Number 2657 - D - 20 - 002 -  
 Revision  
 Do not scale from this drawing. Work to original dimensions, and any discrepancy to be reported to the Architect.  
 Refer to larger scale drawings where available.