

Wakefield Road, Athersley, Smithies, Barnsley

All plots to be built to M4(1) compliance only

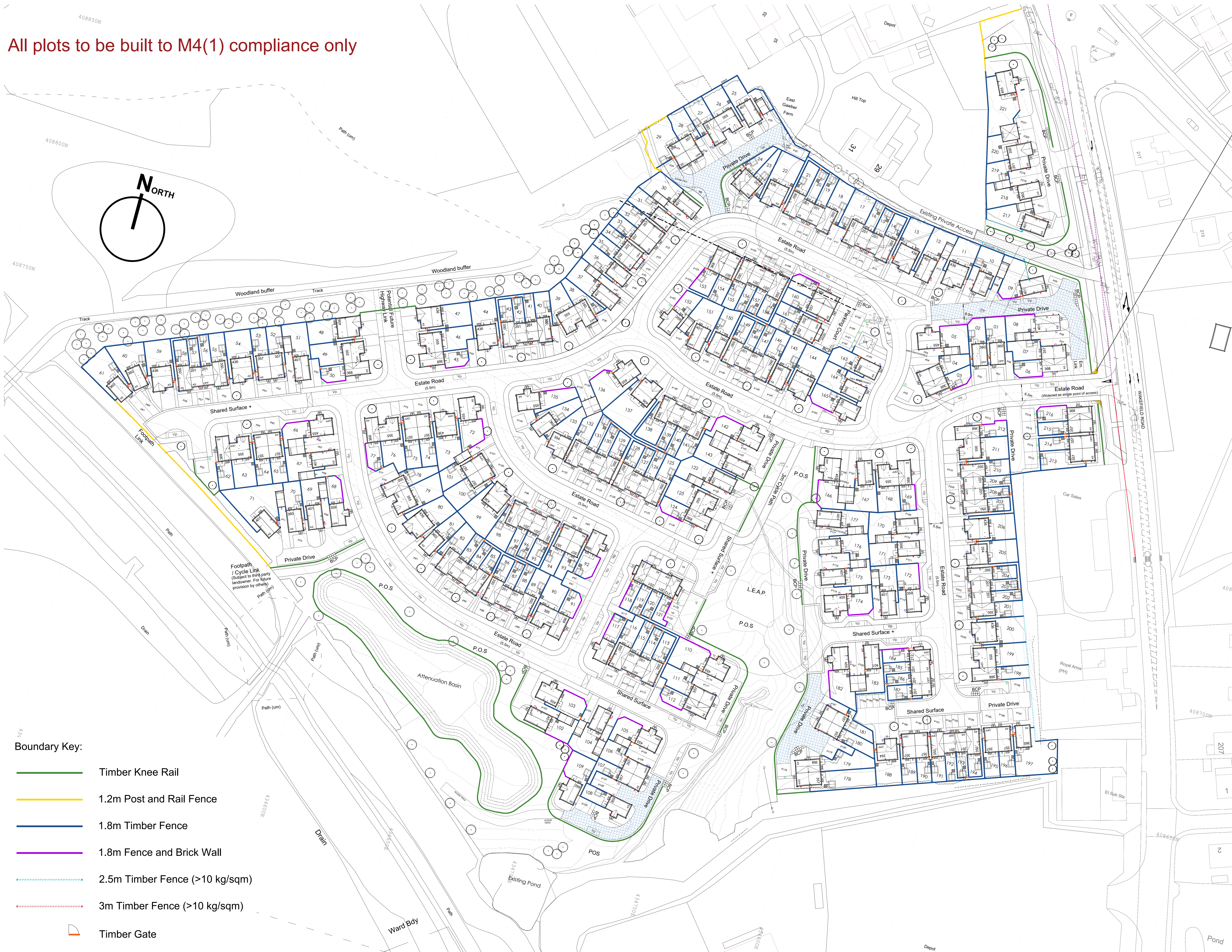

Safeguarded Highway Land Protected for future works to Wakefield Road.

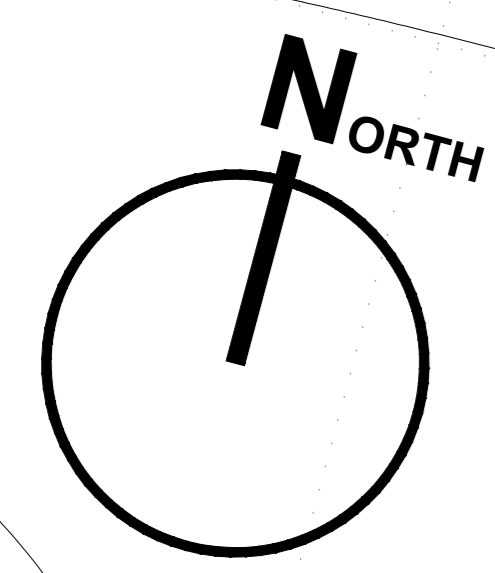

- Boundary Key:**
- Timber Knee Rail
 - 1.2m Post and Rail Fence
 - 1.8m Timber Fence
 - 1.8m Fence and Brick Wall
 - 2.5m Timber Fence (>10 kg/sqm)
 - 3m Timber Fence (>10 kg/sqm)
 - Timber Gate

Rev	By	Note	Date
P	ML	Sewer easement shown.	01.04.26
O	ML	Sales relocated to northern area of site, plots 6-8, 217-221 changed. Northern fence line amended due to easement. Attenuation basin design confirmed and updated. House type 351 renamed to 368.	24.03.26
N	PB	Parking amended to areas at plots 188-197 & 213-216.	22.08.24
M	SH	Safeguarded highway land highlighted at site entrance.	02.08.24
L	PB	External highways amended.	27.06.24
K	SH	Highway and drive amends following tracking.	26.04.24
J	SH	Visitor parking bays to southern estate road removed due to engineering constraints.	24.04.24

Status	Planning
Sketch	Planning Tender Construction As Built

PRA Architecture
 55 The Tannery · Lawrence Street · York · YO10 3WH T:01904 653772
 E:mail@pra-architecture.com W: www.pra-architecture.com

PROJECT Smithies, Barnsley

TITLE Proposed Site Layout - Boundary Treatments

CLIENT Gleeson

DATE 25.05.22 SCALE 1:500@A0

DRAWING 1225.10 REVISION P

DRAWN SH CHECKED SH

Do not scale from this drawing except for planning purposes. This drawing and any designs thereon are the copyright of PRA Architecture Ltd.

Proposed Site Layout - Boundary Treatments

